

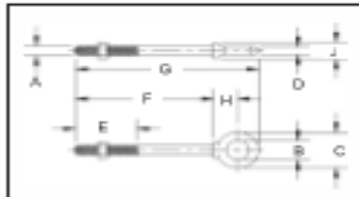

Campbell-Mack Supply (1985) Ltd.

Eye Bolts

S277 SHOULDER NUT EYE BOLTS



ITEM NO.	SHANK DIAMETER & LENGTH (IN.)	WORKING LOAD LIMIT* (LBS.)	WEIGHT PER 100 PCS (LBS.)	DIMENSIONS (IN.)								
				A	B	C	D	E	F	G	H	J
S277-1402	1/4 X 2	650	6.60	0.25	0.50	0.88	0.19	1.50	2.00	2.94	0.50	0.47
S277-1404	1/4 X 4	650	9.10	0.25	0.50	0.88	0.19	2.50	4.00	4.94	0.50	0.47
S277-516214	5/16 X 2-1/4	1200	12.50	0.31	0.62	1.12	0.25	1.50	2.25	3.50	0.69	0.56
S277-516414	5/16 X 4-1/4	1200	18.80	0.31	0.62	1.12	0.25	2.50	4.25	5.50	0.69	0.56
S277-38212	3/8 X 2-1/2	1550	21.40	0.38	0.75	1.38	0.31	1.50	2.50	3.97	0.78	0.66
S277-38412	3/8 X 4-1/2	1550	25.30	0.38	0.75	1.38	0.31	2.50	4.50	5.97	0.78	0.66
S277-12314	1/2 X 3-1/4	2600	42.60	0.50	1.00	1.75	0.38	1.50	3.25	5.12	1.00	0.91
S277-1206	1/2 X 6	2600	56.80	0.50	1.00	1.75	0.38	3.00	6.00	7.88	1.00	0.91
S277-5804	5/8 X 4	5200	68.60	0.62	1.25	2.25	0.50	2.00	4.00	6.14	1.31	1.12
S277-5806	5/8 X 6	5200	102.40	0.62	1.25	2.25	0.50	3.00	6.00	8.44	1.31	1.12
S277-34412	3/4 X 4-1/2	7200	144.50	0.75	1.50	2.75	0.62	2.00	4.50	7.44	1.56	1.38
S277-3406	3/4 X 6	7200	167.50	0.75	1.50	2.75	0.62	3.00	6.00	8.94	1.56	1.38
S277-7805	7/8 X 5	10600	225.00	0.88	1.75	3.25	0.75	2.50	5.00	8.46	1.84	1.56
S277-0106	1 X 6	13300	366.30	1.00	2.00	3.75	0.88	3.00	6.00	9.97	2.09	1.81
S277-0109	1 X 9	13300	422.50	1.00	2.00	3.75	0.88	4.00	9.00	12.97	2.09	1.81
S277-11408	1-1/4 X 8	21000	650.00	1.25	2.50	4.50	1.00	4.00	8.00	12.72	2.47	2.28
S277-11412	1-1/4 X 12	21000	795.00	1.25	2.50	4.50	1.00	4.00	12.00	16.72	2.47	2.28
S277-11415	1-1/4 X 15	24000	1425.00	1.50	3.00	5.50	1.25	6.00	15.00	20.75	3.00	2.75

S279 SHOULDER TYPE MACHINERY EYE BOLTS

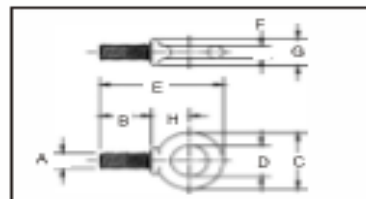

ITEM NO.	SHANK DIAMETER & LENGTH (IN.)	WORKING LOAD LIMIT* (LBS.)	WEIGHT PER 100 PCS (LBS.)	DIMENSIONS (IN.)							
				A	B	C	D	E	F	G	H
S279-1401	1/4 X 1	650	5.10	0.25	1.00	0.88	0.50	1.94	0.19	0.47	0.50
S279-516118	5/16 X 1-1/8	1200	6.20	0.31	1.13	1.12	0.62	2.38	0.25	0.56	0.69
S279-38114	3/8 X 1-1/4	1550	12.50	0.38	1.25	1.38	0.75	2.72	0.31	0.66	0.78
S279-12112	1/2 X 1-1/2	2600	25.00	0.50	1.50	1.75	1.00	3.38	0.38	0.91	1.00
S279-58134	5/8 X 1-3/4	5200	50.00	0.63	1.75	2.25	1.25	4.19	0.50	1.12	1.31
S279-3402	3/4 X 2	7200	87.50	0.75	2.00	2.75	1.50	4.94	0.62	1.38	1.56
S279-78214	7/8 X 2-1/4	10600	157.20	0.88	2.25	3.25	1.75	5.72	0.75	1.56	1.84
S279-01212	1 X 2-1/2	13300	218.00	1.00	2.50	3.75	2.00	6.47	0.88	1.81	2.09
S279-11403	1-1/4 X 3	21000	380.00	1.25	3.00	4.50	2.50	7.72	1.00	2.28	2.47
S279-112312	1-1/2 X 3-1/2	24000	700.00	1.50	3.50	5.50	3.00	9.25	1.25	2.75	3.00

ULTIMATE LOAD IS 5 TIMES THE WORKING LOAD LIMITS