

Port Aligner



These Port Aligners enable the distance and angular relationship between two flanges to be adjusted. They are offered with three different but widely used CF standard flanges. Each type provides ± 5 mm axial length adjustment, with $\pm 3^\circ$ angular tilt motion.

Specification

- ✓ Welded Bellows Seal with SS 316
- ✓ Mounted in any orientation
- ✓ Bakeable to 200°C
- ✓ Working Pressure: 10^{-11} mbar to 1 bar
- ✓ $\pm 3^\circ$ Angular Tilt
- ✓ Through Hole Flanges on Both Sides

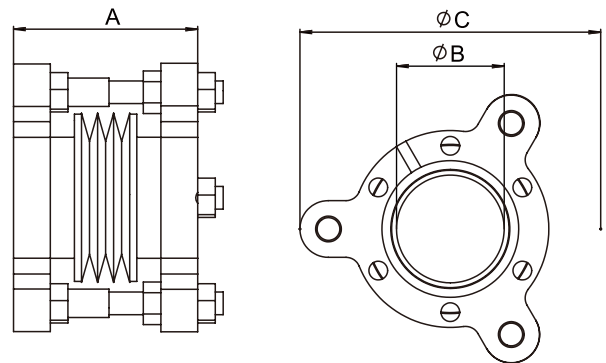

| Flange OD | | Axial Adjustments | A Extended | A Compressed | B | C | Weight (Kg) | Part Number |
|-----------|------|-------------------|------------|--------------|-----|-----|-------------|-------------|
| mm | inch | | | | | | | |
| 34 | 1.33 | ± 5 | 57 | 47 | 16 | 58 | 0.3 | PA16 |
| 70 | 2.75 | | 70 | 60 | 38 | 106 | 0.9 | PA38 |
| 114 | 4.5 | | 84 | 74 | 65 | 166 | 2.7 | PA63 |
| 152 | 6.0 | | 110 | 100 | 102 | 206 | 4.6 | PA100 |
| 203 | 8.0 | | 133 | 123 | 150 | 290 | 6.1 | PA150 |