

# ISO Fittings

## ISO-K 45° ELBOWS

\*Material: SS 304L

\*Tube Finish: Bead Blast

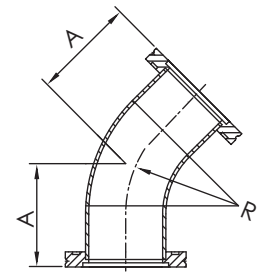

Part Number	Flange Size	A	R
ISOK-45EL-63	ISO63	82.30	95.25
ISOK-45EL-80	ISO80	100.00	114.30
ISOK-45EL-100	ISO100	128.50	152.40

## ISO-K 90° ELBOWS

\*Material: SS 304L

\*Tube Finish: Bead Blast

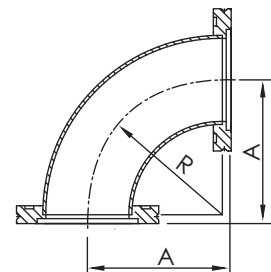

Part Number	Flange Size	A	R
ISOK-90EL-63	ISO63	101.60	95.25
ISOK-90EL-80	ISO80	120.60	114.30
ISOK-90EL-100	ISO100	158.70	152.40

## ISO-K 90° MITERED ELBOWS

\*Material: SS 304L

\*Tube Finish: Bead Blast

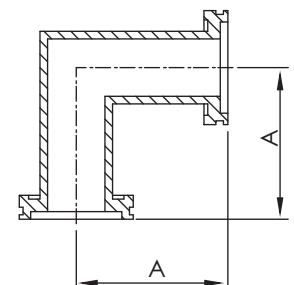

Part Number	Flange Size	A
ISOK-90MEL-63	ISO63	82.60
ISOK-90MEL-63-1	ISO63	87.93
ISOK-90MEL-80	ISO80	88.90
ISOK-90MEL-80-1	ISO80	108.00
ISOK-90MEL-100	ISO100	104.90
ISOK-90MEL-100-1	ISO100	108.00
ISOK-90MEL-160	ISO160	138.00
ISOK-90MEL-160-1	ISO160	160.20

\*Note: SS 316L Material Available on Request.

\*Note: Polished and Electro- Polished Tube Finishes Available on Request.

ISO  
NW