

B.M. 100.0-R.R. SPIKE BASE  
OF 1 1/2 IN. ELM. TREE.  
WATER SURFACE ELEV. = 95.4  
1/24/47

INSTITUTE FOR FISHERIES RESEARCH  
DIVISION OF FISHERIES MICHIGAN CONSERVATION DEPT.

LAKE INVENTORY MAP  
**OXBOW LAKE**

AREA 270 ACRES  
MARGINAL SURVEY AND SOUNDINGS 1/22,23,24/47

OAKLAND COUNTY

T. 3 N., R. 8 E., SEC'S. 22, 23, 26, 27

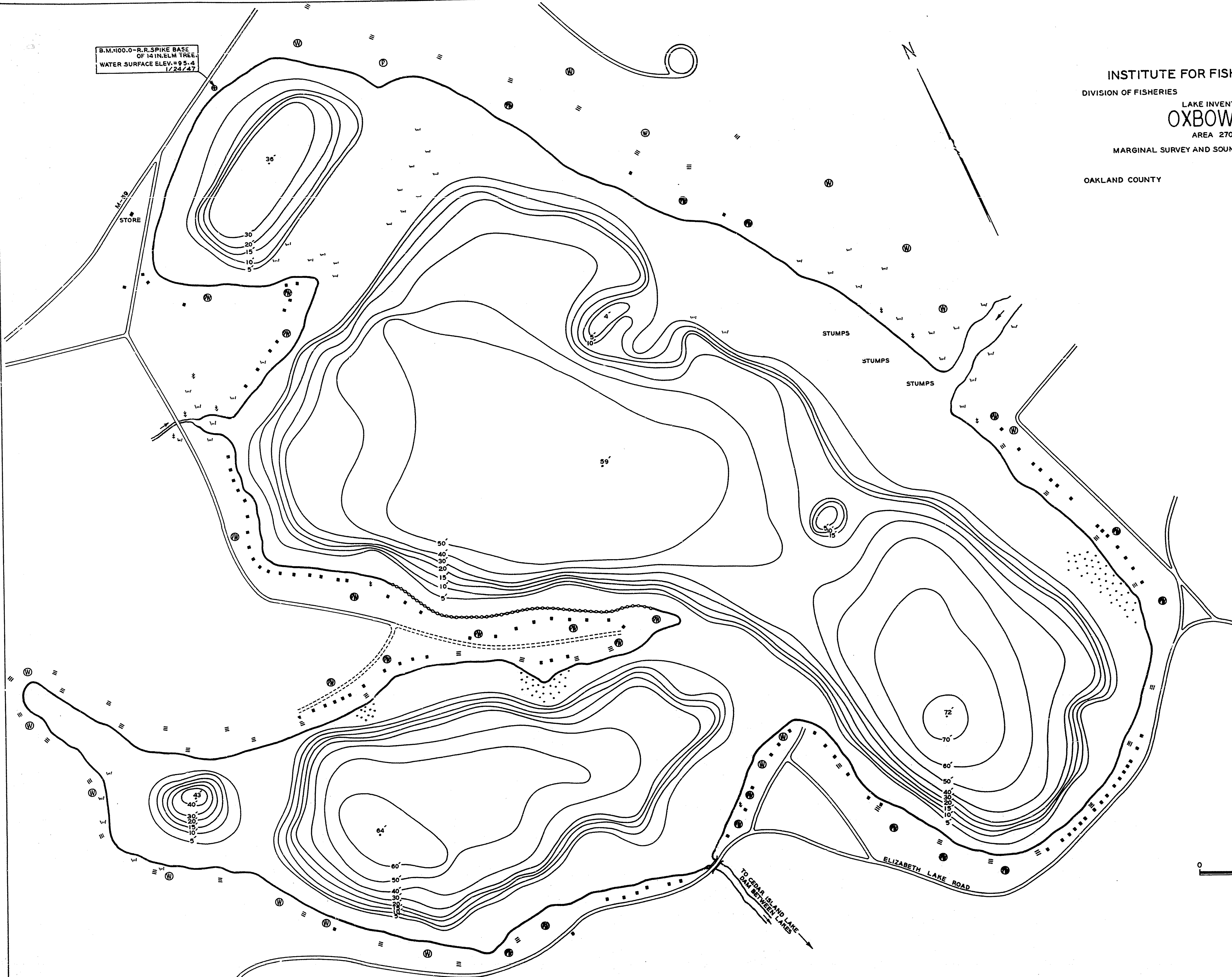

**BOTTOM**

- Sand
- Marl
- Pulpy peat
- Fibrous peat
- ⊙ Gravel

**OUTLINE & CONTOURS**

- Shoreline
- 5- Contours

**SHORE FEATURES**

- Cottage
- ▨ Slope
- Unimproved road
- == Improved road
- ⌒ Marsh
- + Brush
- ≡ Bridge
- ⊖ Breakwater
- ⊙ Pasture
- ⊙ Wooded
- ⊙ Partly wooded
- ⊙ Outlet
- ⊙ Inlet

