

UNICA

PARTS LIST

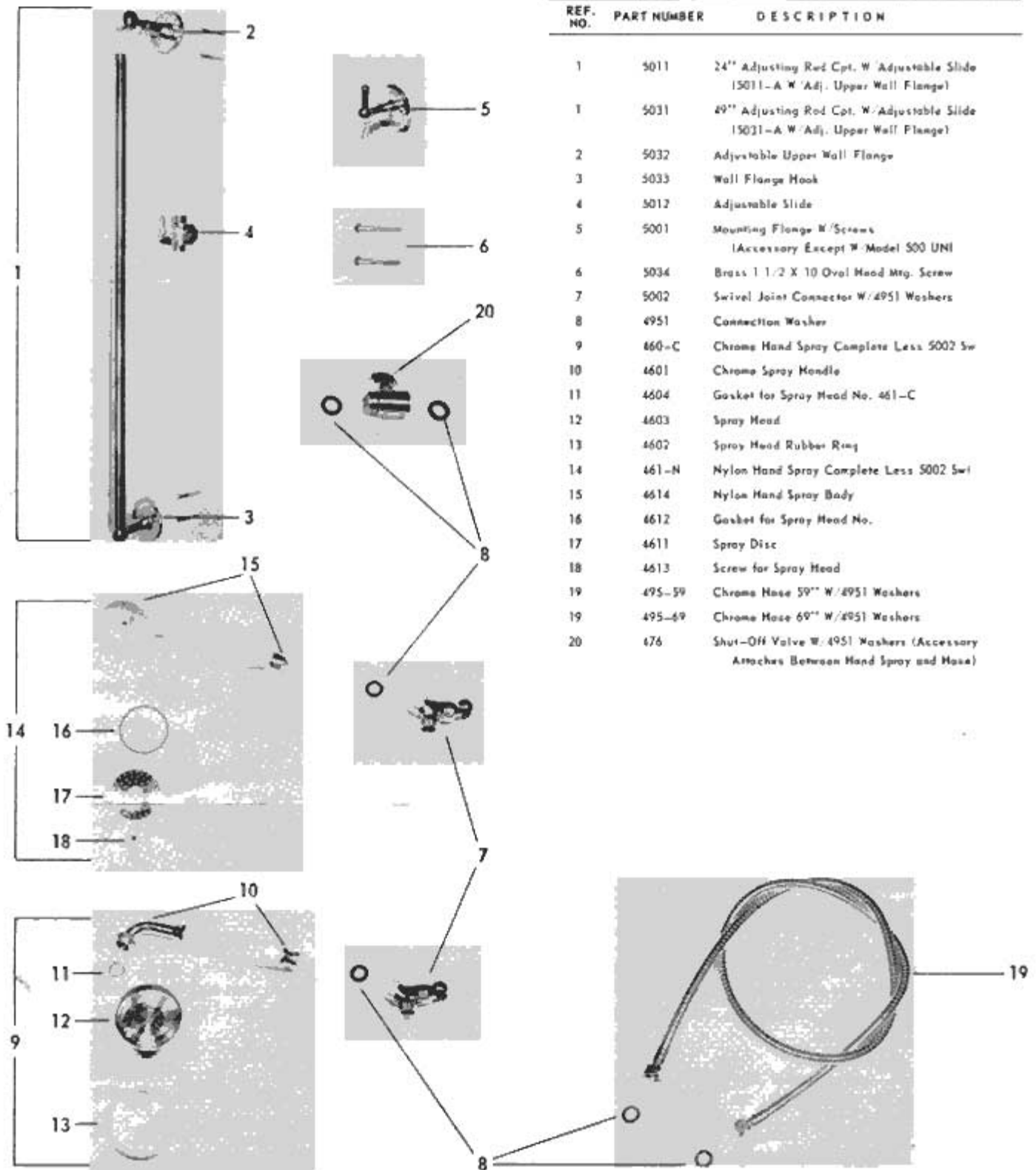

REF. NO.	PART NUMBER	DESCRIPTION
1	5011	24" Adjusting Rod Cpt. W/ Adjustable Slide (5011-A W/ Adj. Upper Wall Flange)
1	5031	49" Adjusting Rod Cpt. W/ Adjustable Slide (5031-A W/ Adj. Upper Wall Flange)
2	5032	Adjustable Upper Wall Flange
3	5033	Wall Flange Hook
4	5012	Adjustable Slide
5	5001	Mounting Flange W/ Screws (Accessory Except W/ Model 500 UNI)
6	5034	Brass 1 1/2 X 10 Oval Head Mtg. Screw
7	5002	Swivel Joint Connector W/ 4951 Washers
8	4951	Connection Washer
9	460-C	Chrome Hand Spray Complete Less 5002 Sw
10	4601	Chrome Spray Handle
11	4604	Gasket for Spray Head No. 461-C
12	4603	Spray Head
13	4602	Spray Head Rubber Ring
14	461-N	Nylon Hand Spray Complete Less 5002 Swi
15	4614	Nylon Hand Spray Body
16	4612	Gasket for Spray Head No.
17	4611	Spray Disc
18	4613	Screw for Spray Head
19	495-59	Chrome Hose 59" W/ 4951 Washers
19	495-69	Chrome Hose 69" W/ 4951 Washers
20	476	Shut-Off Valve W/ 4951 Washers (Accessory Attaches Between Hand Spray and Hose)

UNICA...THE MOST VERSATILE SHOWER MADE

UNICA

INSTALLATION INSTRUCTIONS ALL MODELS

CONGRATULATIONS! You have purchased the finest, most versatile, shower fixture available. To assure the utmost satisfaction it is recommended that the following installation instructions be observed.

PLACEMENT OF ADJUSTING BAR The adjusting bar (2) should be mounted in a vertical position near the water supply. The top of the bar should be about 74 inches from the floor. For use with a bathtub, the adjusting bar is normally centered at the head of the tub above the spout. If it is impractical to mount the adjusting bar at the head, mount it on the side wall, but as close as practical to the water supply. The exact placement will be determined by the location of the faucet handles, etc. Mount the bar so the stud on the adjustable slide points upwards.



Model 501P illustrated

- 1 Hand spray assembly
- 2 Adjusting Bar
- 3 Hose

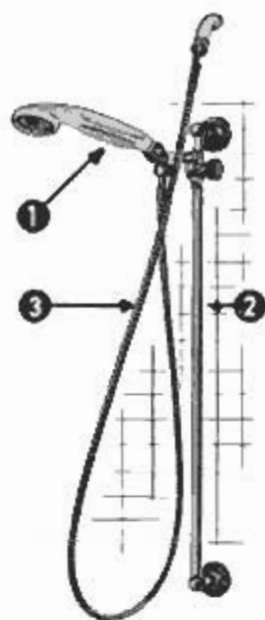

NOTE: With Model 501A and 503A series, you can compensate for the thickness of wall tile that doesn't extend to the ceiling by changing the length of the upper adjustable wall flange. Loosen the lock screw located in the rear of the mounting flange before adjusting the bracket to proper length, then retighten the lock screw.



WATER SUPPLY The Supply Hose (3) for the UNICA fits $\frac{1}{2}$ " pipe. It may be connected in the following ways:

ORIGINAL INSTALLATIONS When the UNICA is to be used in new construction a regular shower arm installed in the normal manner is recommended for the water supply. The shower arm should be about 6" above the adjusting bar to permit centering the bar under it.

WHEN REPLACING ORIGINAL SHOWER Simply remove the original shower head from the supply pipe and screw the UNICA supply hose on in its place. Note the above installation.

WHEN ADDING A SHOWER TO YOUR BATH Replace your present spout or valve assembly with our Model 1000-L Adapto-Spout or 1050 Valve. The Adapto-Spout is designed to replace nearly all spouts except those on leg type tubs with $4\frac{1}{2}$ " center connections for which the 1050 Valve is made. When tightening the Adapto-Spout you may avoid damaging its fine chrome finish by using a "Pin Wrench" in the spout opening. A large screw driver, punch, or similar object will effectively serve as a "pin wrench" for this purpose. Be sure to remove the brass bushing from the rear of the spout and apply pipe joint sealer to it as well as the male threads of the supply pipe to assure a water tight connection. Without this bushing the spout fits regular $\frac{3}{4}$ " pipe.



1000-L Adapto-Spout

MAKING FINAL CONNECTIONS Attach one end of the flexible metal hose to the water supply. Attach the other end to the swivel joint which connects with the main body of the hand spray. Use the gaskets provided in both ends of the supply hose and between the swivel joint and the hand spray body.

SPECIAL NOTE Damage may result if the hose connections are made with too great force; apply only a moderate amount of pressure. The supply hose is designed for long life and you can expect years of service unless the hose is deliberately damaged due to forcing it into a coil smaller than its intended radius limit (4") or by hard pulls or jerks.

GUARANTEE Your UNICA Shower Fixture is fully guaranteed for one year from date of installation. Gaskets or parts may be purchased from your UNICA dealer or, you may order direct from Alsons Products Corporation.

UNICA...THE MOST VERSATILE SHOWER MADE

ALSONS

PRODUCTS CORP., 90 W. FAYETTE STREET HILLSDALE, MICHIGAN