



ABN 82 621 800 673  
(GITC: Q-6463)

QAssure number: 16810

### The AV King

27 O'Neil Street,  
Moorooka, QLD-4105  
Tel: 07 3170 3706  
W: [www.theavking.com.au](http://www.theavking.com.au)  
E: [sales@theavking.com.au](mailto:sales@theavking.com.au)

Electrical licence # 113595

## G-View Mobile Stand Build Guide

---  
Account Manager: Millin Bear  
AV King / AV Pro Education  
[www.avpeducation.com.au](http://www.avpeducation.com.au)

Below slide shows that you know the 'front' of the base, as the section with only 4"/10cm to the first beam (the back has a 6"/15cm spacing) – [this 4" spacing is shown with the green & red arrows below]:



[Above shows base – this is 22"/55cm from front to back]

--

This slide shows the front 'locking' wheels (A) and the back 'normal' wheels (B) with the positions to assemble them in:



[Above shows base – this is 43.5"/110cm wide]

**PAGE-2 of 5:**

This slide shows all of the 'parts':

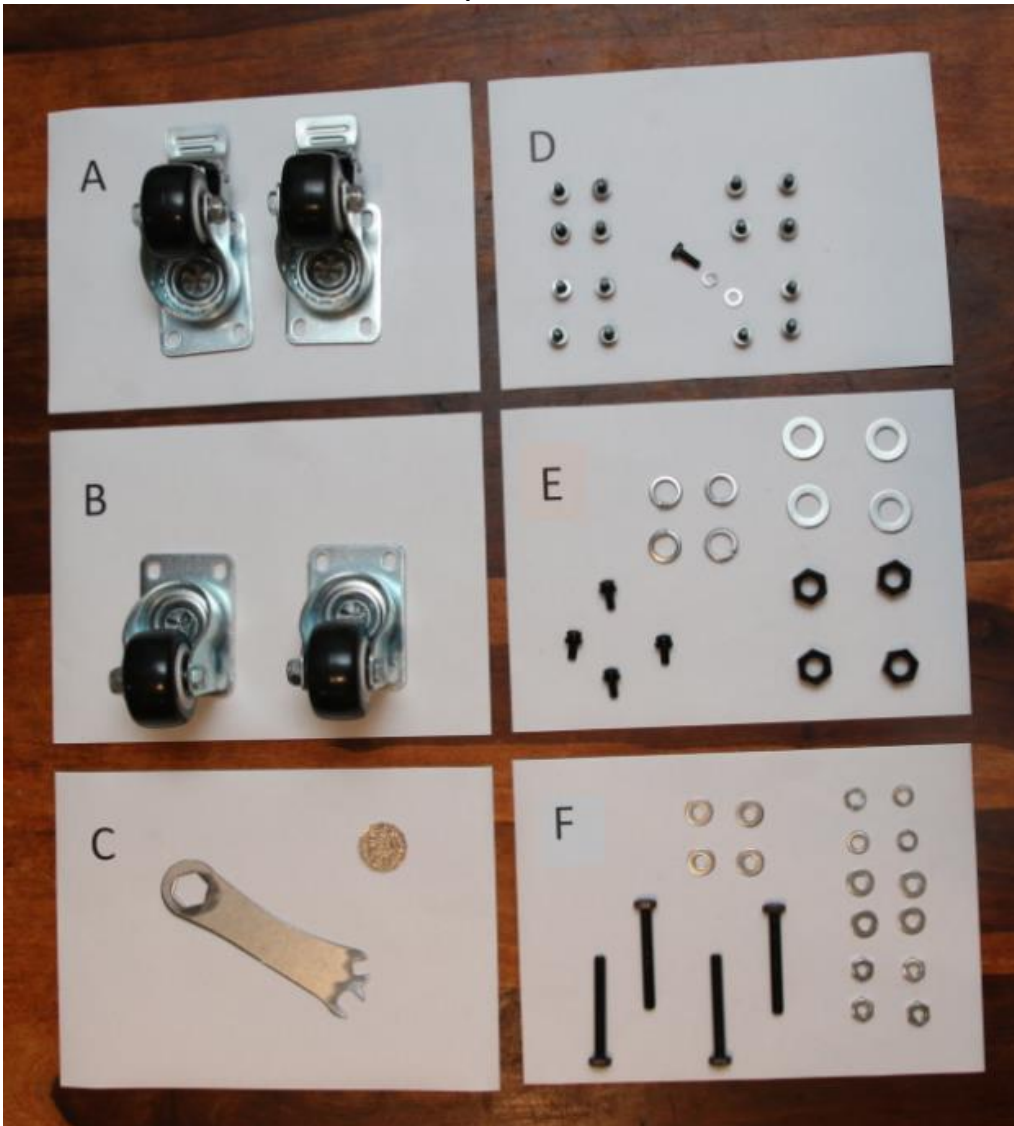

A: Front Locking Wheels

B: Back 'normal' Wheels

C: 'Tool'

D: All parts to assemble the wheels

E: Nuts for the 'main struts' & Screws for the shelf

F: Nuts and bolts for the 'screen frame'

**PAGE-3 of 5:**

This slide shows the 'front curved section of the main strut' – facing the front 'locking wheel':

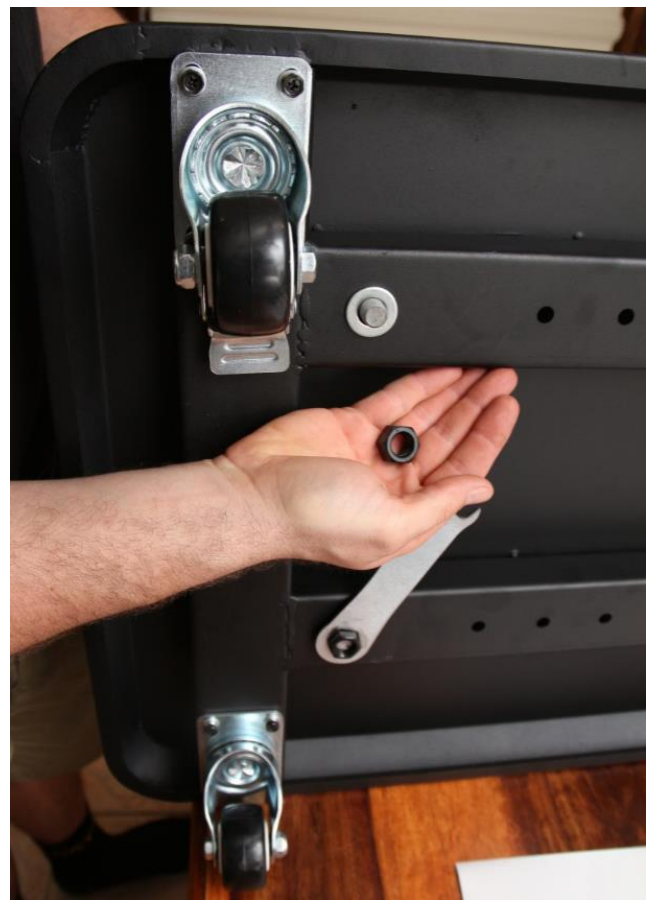

(Red arrow shows the hole that the bolt slides in to – the GREEN arrows show that the 'shelf screw hols' are facing inwards on this 'Left' hand 'main strut')

**PAGE-4 of 5:**

Below shows (H) the 16.5"/42cm deep shelf – and the position and type of screws for assembly.



Below slide (G) shows the 'Left and Right' hand side – main struts (as you see them facing the front of the finished stand) – **the screw hold that the above shelf screw into are shown facing up here:**

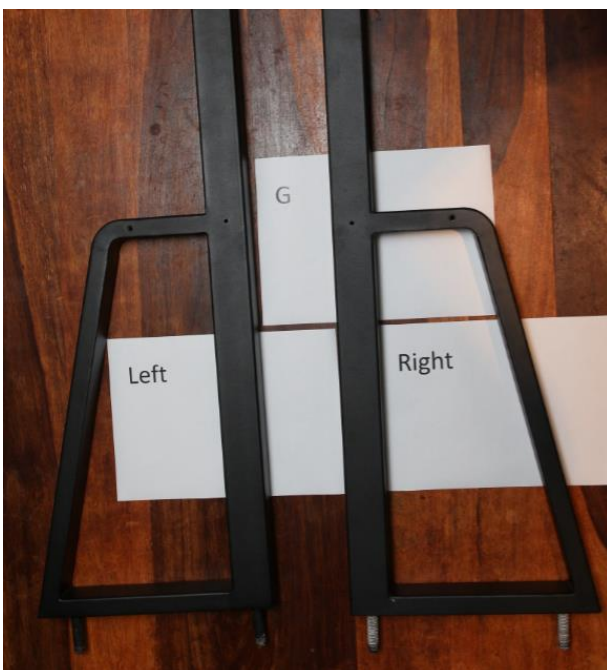

**PAGE-5 of 5:**

The below slides (I) shows the parts of the 'screen frame';



**NOTE: The edge marked above with the 50c coin NEEDS TO FACE UP!!!**

-

When correctly assembled, this mobile system can support an 86" touch-screen up-to 135KG.

NOTE: Tensioning and 'washers' – it is recommended that a professional AV installer (with pro tools) assemble and tensions this system and it's bolts/screws, as some screens and screen frame bolts may require modification, or use of alternate bolts and washers for maximum safety and the best securing of the screen to this mobile stand. (if your screen is under 30KG, the 'risk' of 'self-assembly' is much lower)

Finished stand:



ABOVE: Left: 75" / Right: 65"

Shelf (16.5"/42cm deep x 27.5"/70cm Wide):

