



# AVION

BY **FLEETWOOD**<sup>®</sup>

*America's Finest Travel Trailer*



## WELCOME ABOARD TO AVION CLASS TRAVEL

*Full timing?  
Retiring? Want the  
most sought after  
vacation home on the  
road today? The  
Avion travel trailer  
by Fleetwood offers  
the quality, durability  
and luxury you desire  
for you and your  
family.*

**A** Avion travel trailers are available with double or twin beds as shown. The Sealy® mattress is standard equipment.

**B** Step aboard on Avion's durable steel double step that has rounded corners and non-skid edges for your personal safety. Convenient night lights are also included.

**C** Abundant, functional storage is found throughout the Avion. From the large wardrobes, overhead cabinets and storage beneath convertible furnishings, you travel comfortably equipped. Dovetail construction reflects the craftsmanship found within. Like residential cabinetry, drawers are sanded satin smooth and sealed.

**D** Avion's new galley reflects careful planning with the larger overhead storage cabinets. The double bowl residential quality porcelain sink is equipped with single mix faucet plus purified fresh water dispenser faucet. Magic Chef® microwave oven and 4-burner range/oven provide all of the cooking versatility needed. The microwave is optional in Model 25H. Also, the purified water system is not available in Model 25H.



**E** You'll dine in total comfort while seated on the 5" thick Superfoam cushions. Upholstery is *Scotchgard*® protected for durability and easy maintenance. Beneath each seat, a generous storage compartment for less frequently used items. The Avion dinette easily converts to additional sleeping quarters for an overnight guest. A convenient map pocket/magazine rack is included in dinette models.

**F** The front overhead cabinet contains the AM/FM/Cassette stereo tuner. The tuner is equipped with "seek and scan" and is all electronic. Four 4-way speakers are included in the sound system. Convenient storage for tapes has been included.

**G** Avion's new monitor panel contains a 12 Volt disconnect switch to power down all 12V circuits when not in use. Other functions include analog clock, LP gas reserve, battery condition, barometer, thermometer and hygrometer (humidity).

**H** An all aluminum LPG tank cover protects the LP tanks from road hazards. The hinged ABS top allows for quick inspection of the visual gas reserve gauge. Not available on Model 25H.

**I** The TV table is designed for the contemporary, portable TV. The shelf recesses out of the way when not in use. TV antenna and wiring for the park cable TV coaxial cable is standard.

**J** The bath vanity countertop is covered with self-edged high-impact marble finish laminate for durability and elegance. A residential quality single-mix faucet is standard.

**K** All Avion models are equipped with a large tub/shower for personal convenience and comfort. Rear baths include a cast-in shower seat.

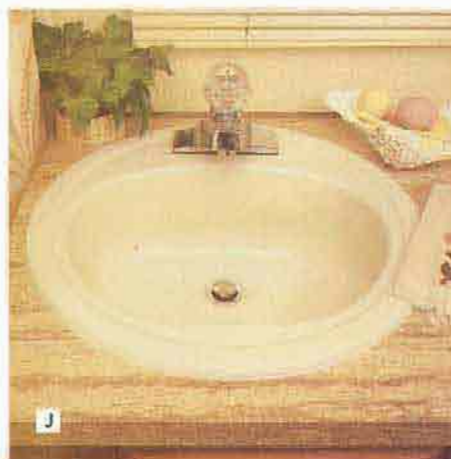





Avion's new living room features deluxe, highly durable furnishings for personal comfort and lasting style. Tasteful front storage cabinets and overhead shelving complete the residential feeling.

# AVION MODEL SELECTOR

## MODEL 25H

This all new tandem axle model features the front sofa bed and extension table living area. No charge option includes the double bed.

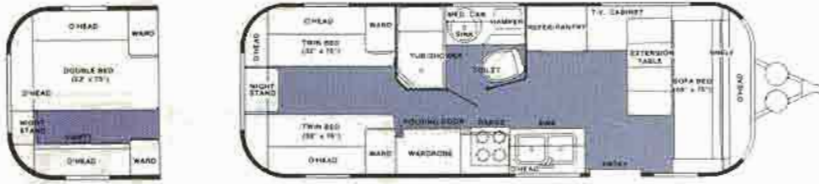

**Options — 25' Model:** Doorside and window awnings, 12V power jack, Dometic 10 cu. ft. (rated) auto 3-way refrigerator, microwave oven, spare tire, aluminum LPG tanks - 40 lbs.

## MODEL 30P

This tandem axle model features the side sofa bed and twin swivel chairs. No charge options include a double bed and a front sofa bed with side mounted extension table and swivel chair. Living room and bath are the same size as in Model 34V.

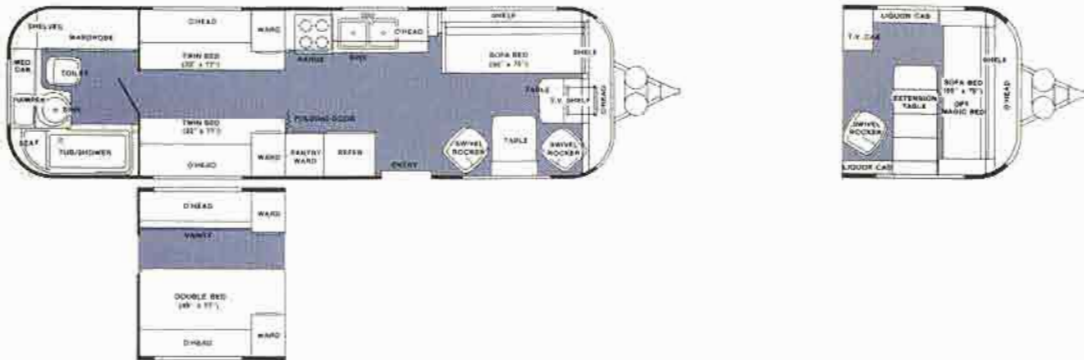

## MODEL 30R

This tandem axle plan offers center bath convenience and rear bedroom privacy. No charge options include a double bed and front sofa bed with side mounted extension table and swivel chair. Center bath has full size tub/shower.

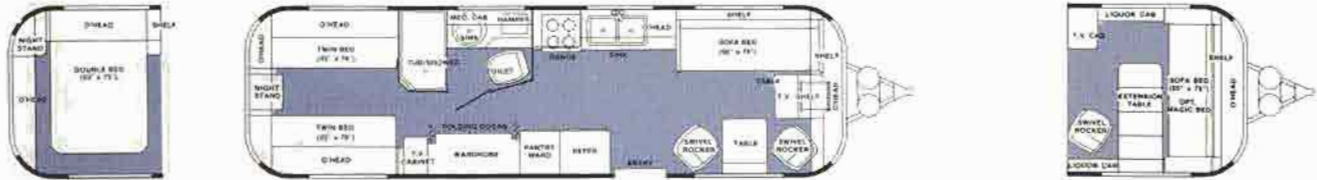

## MODEL 34V

This highly popular Avion model offers the traditional features the discriminating family desires. No charge options include a front sofa bed with a side mounted extension table and swivel chair; double bed and vanity, oversized doorside wardrobe. Has tri-axle suspension.



**Options — 30' and 34' Models:** The only extra charge factory installed options available are (1) long length doorside awning (2) roadside/rear awning combination for living room, galley, bedroom and bath windows (3) magic bed as shown.

## MODEL 34V

This thirty-four foot tri-axle model has large center bath with an exclusive full tub/shower and rear bedroom. It features the side sofa bed, tables and swivel chairs. No charge options include a double bed and front sofa bed with a side mounted extension table and swivel chair.



# 1986 Avion Specifications

	25H	30P	30R	34V	34W
<b>Weights, Measures</b>					
Length, including hitch	25'10"	30'1"	30'1"	34'11"	34'11"
Width	7'11"	7'11"	7'11"	7'11"	7'11"
Height (including roof air)	10'0"	10'0"	10'0"	10'0"	10'0"
GVWR - lbs.	7,000	8,550	8,550	9,500	9,500
Gross dry weight - lbs.	4,975	5,840	5,800	7,084	6,875
Hitch dry weight - lbs.	725	630	610	765	720
<b>Livability Systems</b>					
Fresh water - gals.	40	65	65	65	65
Manual water fill - spout w/lock	•	•	•	•	•
Dual holding tanks - waste/grey gals.	40/30	40/30	40/30	40/30	40/30
Dual LP tanks, sight gauge - lbs.	30	40	40	40	40
Everpure™ water purifier	—	•	•	•	•
13.5M BTU roof air, heat strip	†	•	•	•	•
LPG auto changeover regulator	•	•	•	•	•
Ducted furnace w/thermostat (M-BTU's)	24M	30M	30M	34M	34M
Electronic ignition water heater - gals.	6	6	6	6	6
<b>Construction</b>					
Riveted aluminum ribs and stringers	•	•	•	•	•
Bright anodized aluminum exterior	•	•	•	•	•
2" x 6" tubular steel chassis*	—	•	•	•	•
2" x 5" tubular steel chassis**	•	—	—	—	—
Adjust-A-Ride™ suspension	•	•	•	•	•
Riveted vinyl coated alum. interior	•	•	•	•	•
Hand finished solid wood cabinetry	•	•	•	•	•
Heavy duty rear bumper	•	•	•	•	•
Steel wheels, deluxe covers	•	•	•	•	•
Full size alum. entry/screen door	•	•	•	•	•
Thermo-X™ insulation	•	•	•	•	•
Code approved wiring, plumbing	•	•	•	•	•
Insulated sandwich panel subfloor	•	•	•	•	•
Vinyl foam sealant tape	•	•	•	•	•
Electric brakes, all wheels	•	•	•	•	•
Tires, H78 x 15 ST - load range	C	C	C	C	C
<b>Electrical</b>					
Dual 12 volt battery container	•	•	•	•	•
Omnipower 110V converter/charger	•	•	•	•	•

†Heat strip not included with 25H.

\*Includes additional 2" x 4" tubular steel reinforcement at load bearing points.

\*\*Includes additional 2" x 5" tubular steel reinforcement at load bearing points.

	25H	30P	30R	34V	34W
<b>Electrical (con't.)</b>					
Utility compartment 110V outlet	•	•	•	•	•
Extra long H.D. 110V shore line	•	•	•	•	•
Prewired for cable TV	•	•	•	•	•
Switch controlled interior/ exterior lighting	•	•	•	•	•
<b>Travel/Camping Conveniences</b>					
Front window rockguard/sunshade	•	•	•	•	•
Heavy duty power hitch jack	—	•	•	•	•
Retractable entry step w/hinged cover, night lights	•	•	•	•	•
Multiple exterior storage compartments	•	•	•	•	•
Stabilizing jacks	•	•	•	•	•
Exterior convenience lights, hitch, utilities	•	•	•	•	•
Awning rails, both sides	•	•	•	•	•
Water hose compartment	•	•	•	•	•
Concealed drain hose valve	•	•	•	•	•
Spare tire	—	•	•	•	•
Backup lights	•	•	•	•	•
Emergency egress, fire extinguisher	•	•	•	•	•
Rear hose storage compartment	•	•	•	•	•
Large tinted glass torque windows	•	•	•	•	•
RV systems monitor w/12V failsafe	•	•	•	•	•
<b>Personal Conveniences</b>					
Adjustable reading lights	•	•	•	•	•
AM/FM/Cassette stereo and speakers	•	•	•	•	•
Braund Skyliner™ VHF/UHF TV antenna w/amplifier	•	•	•	•	•
Dometic™ auto 3-way refrigerator (cu. ft. rated)	7	10	10	10	10
Magic Chef™ microwave oven	—	•	•	•	•
Microwave oven ready	•	—	—	—	—
Sealy mattress(es)	•	•	•	•	•
Lighted/fan powered range vent	•	•	•	•	•
Deluxe ceiling vents with fans	•	•	•	•	•
5" thick superfoam cushions	•	•	•	•	•
Removable deep pile carpet	•	•	•	•	•

Product information and photography included in this brochure was as accurate as possible at the time of publication. Subsequent refinements may be evident in the actual product. Prices and specifications are subject to change without notice. Selected decorator items shown in the photographs are not part of the product unless specified. All fuel and liquid capacities are approximate and dimensions are nominal.

## **Adjust-A-Ride™ Suspension**

Patented in February 1980, this exclusive suspension system absorbs the "G" forces created by irregular roads. Each wheel has its own axle, spring and shock absorber. Adjust-A-Ride offers more protection for personal goods and provides effortless, smooth towing.

### **Other Features Include:**

- Anodized aluminum aircraft type construction
- Up to 11 exterior storage compartments
- 2" x 6" reinforced tubular steel chassis (2" x 5" on Model 25H)
- Braund™ Skyliner TV antenna
- Residential duct heating
- 13.5M BTU roof air conditioner with heat strip
- Omnipower electric system

### **Ownercare Warranty**

Avion travel trailers are protected by a full, one-year Ownercare Warranty. It is Fleetwood's commitment to owner satisfaction. Your Avion dealer has complete details.

**Avion Travel Trailers are manufactured by this subsidiary of Fleetwood Enterprises, Inc.**

**Avion Coach Corporation**  
1300 E. Empire Avenue  
Benton Harbor, Michigan 49022

### **International Travel Club**

Membership in the Avion International Travelcade Club is available to all Avion owners. Highlights include professionally planned Travelcades, three International Rendezvous as well as State Unit Rallys. The club offers the ideal opportunity to make new friends and enjoy the comraderie found with Avion ownership. For complete details, contact:  
Executive Secretary  
Avion Travelcade Club, Box 236  
DeBary, Florida 32713.

Your Local Avion Dealer Is:

**AVALON R.V. CENTER, INC.**  
1604 MEDINA RD.  
MEDINA, OHIO 44256

**FLEETWOOD®**

**FLEETWOOD ENTERPRISES, INC.**

P.O. Box 7638  
Riverside, California 92523

The Official Travel Trailer at Fort Wilderness  
Campground at the **Walt Disney World®** Resort