

Techn. Data: Nice

Log length (W x D): 300 x 575 cm

Wall size(outside): 280 x 555 cm · Log thickness: 40 mm

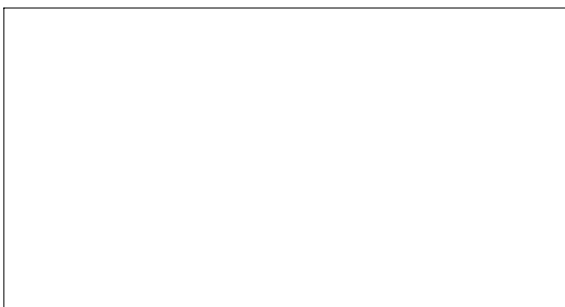
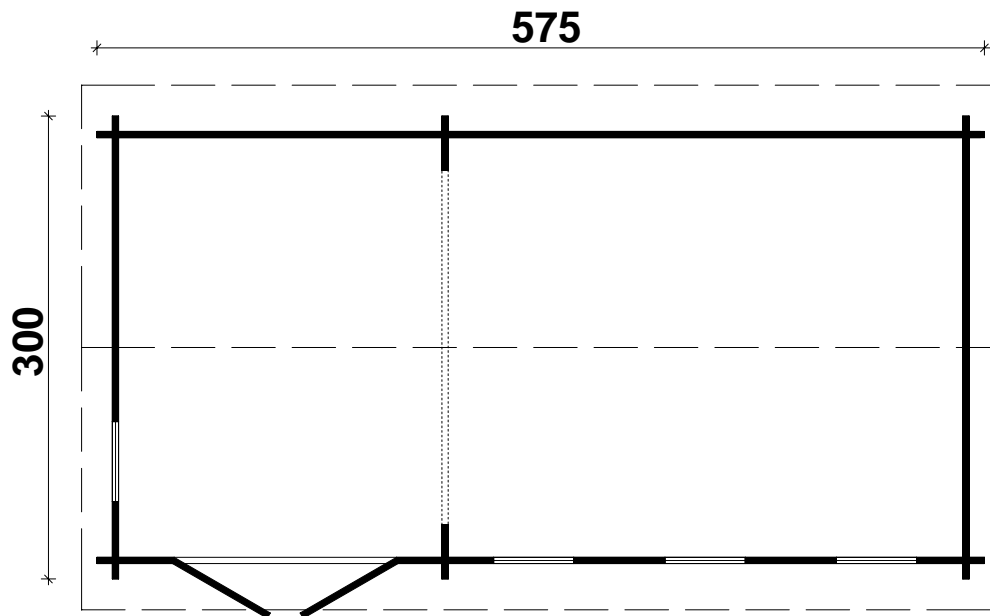

Note: All dimensions are approximate !

Specification - Nice 40 mm / 300 x 575 cm

Nr.	Description	Profile mm	Length mm	Quantity	
001	Foundation beams		2790	2	
002			5400	6	
003			474	6	
004			5750	1	
005			500	1	
006			3810	1	
007			3000	21	
008			3000	1	
009			3000	1	
010			5750	19	
011			1980	16	
012			500	33	
013			440	17	
014			350	34	
015			630	17	
016			590	34	
017			550	2	
018	Gable 			3000	3
019				5950	2(1+1)
020				5950	1
021			5950	2	
022	Double door ca. 1425 x 1955mm - 40 mm / 4mm			1	
023	Window ca. 515 x 1890mm - 40 mm / 4mm			4	
024	Floor board		2717	64+1	
025	Baseboard		ca. 25,0 m		
026	Roofing felt		6050	5	
027	Roof board		1770	136+2	
028	Facia board		1810	4	
029	Eave edging		1810	4	
030	Roof edge reinforcement		3725	4	
031	Roof edge reinforcement		3725	4	
032	Diamond			2	
033	Storm braces		2150	8	
034	Bolt M 8 x 70, nut, washer			18	
035	Nails 2,2 x 50			1 Bag	
036	Roofing nails 2.8 x 15			1 Bag	
037	Screws 4,0 x 40; 5,0 x 70			1 Bag	
038	Hit block		300-400		

Nice 40 mm / 300 x 575 cm

Walls

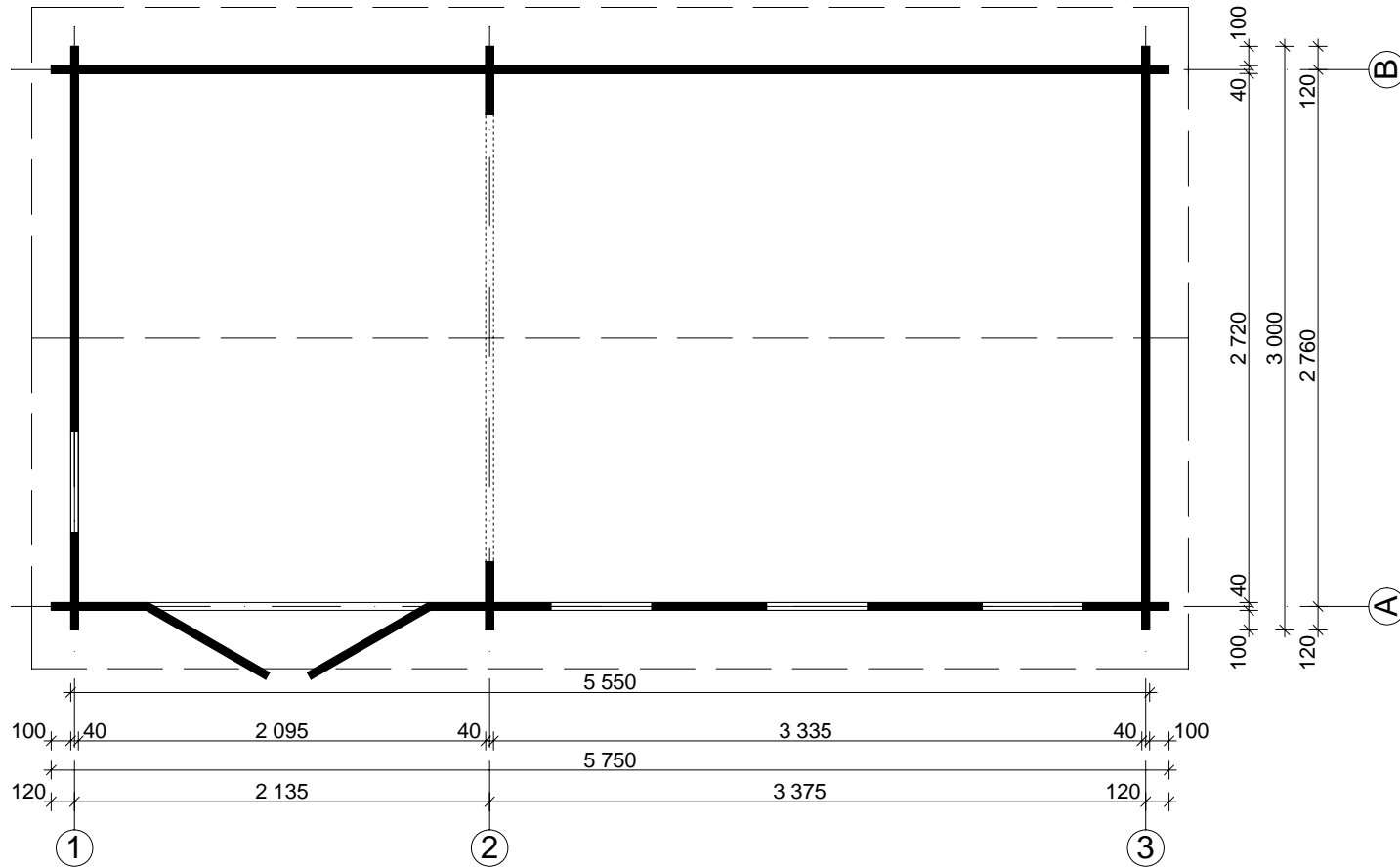

Nice 40 mm / 300 x 575 cm

Foundation beams

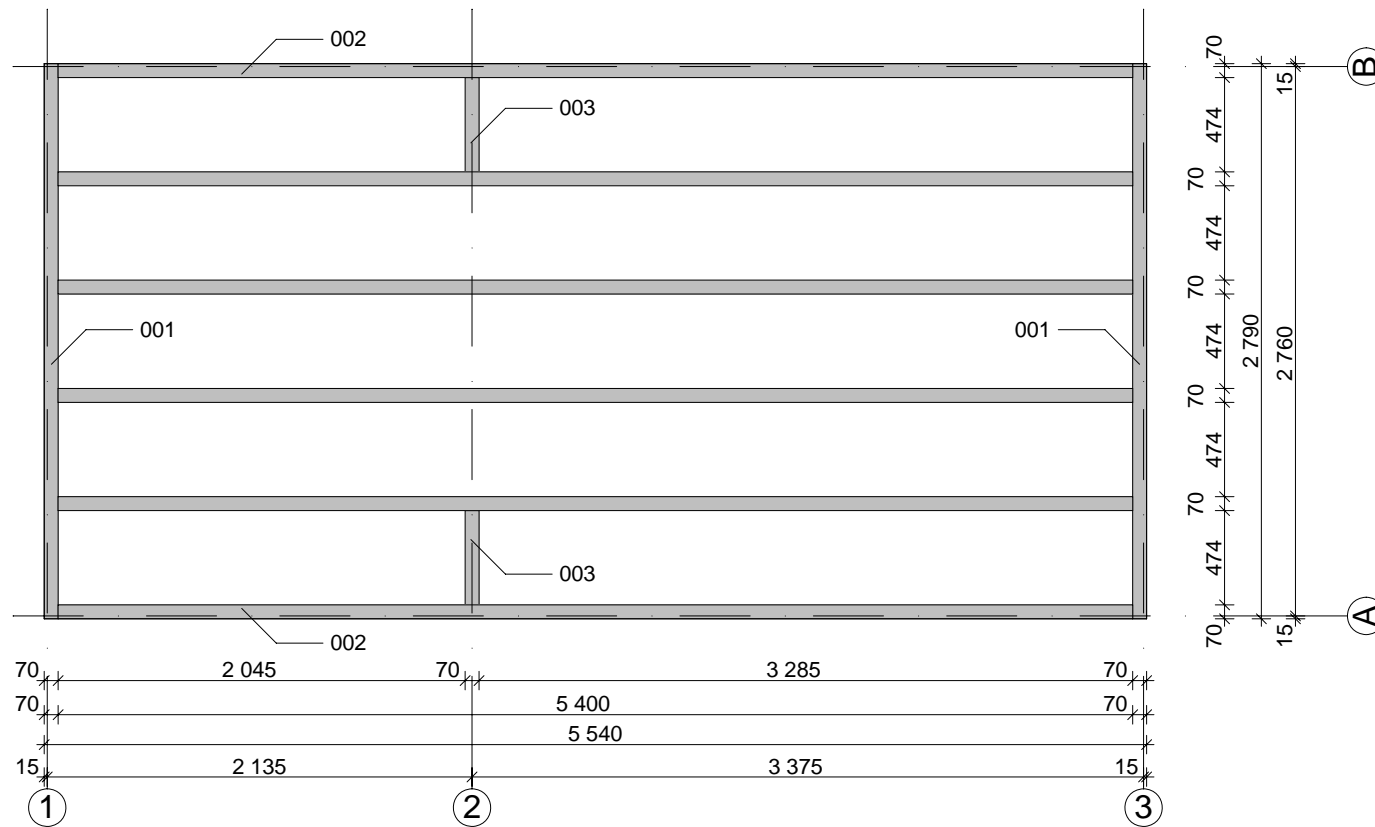

Nice 40 mm / 300 x 575 cm

A

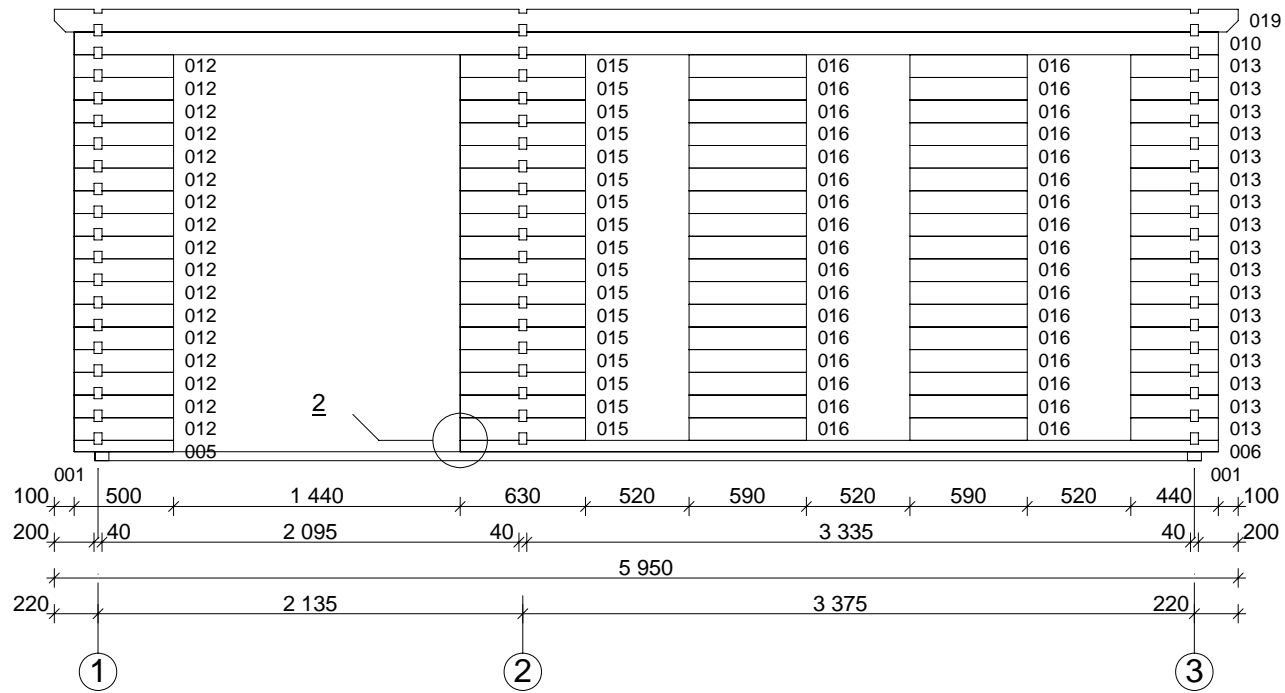
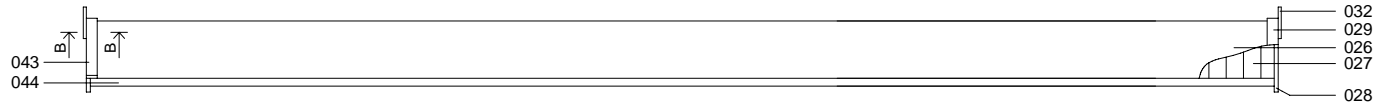

A-A

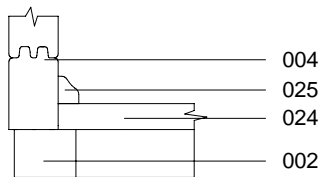

B-B

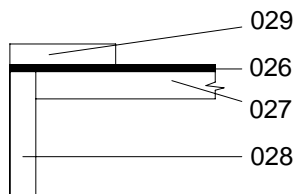

1

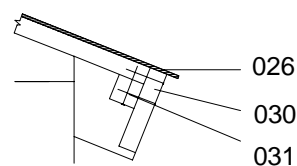

2

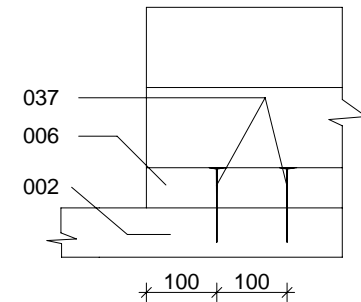

Nice 40 mm / 300 x 575 cm

B

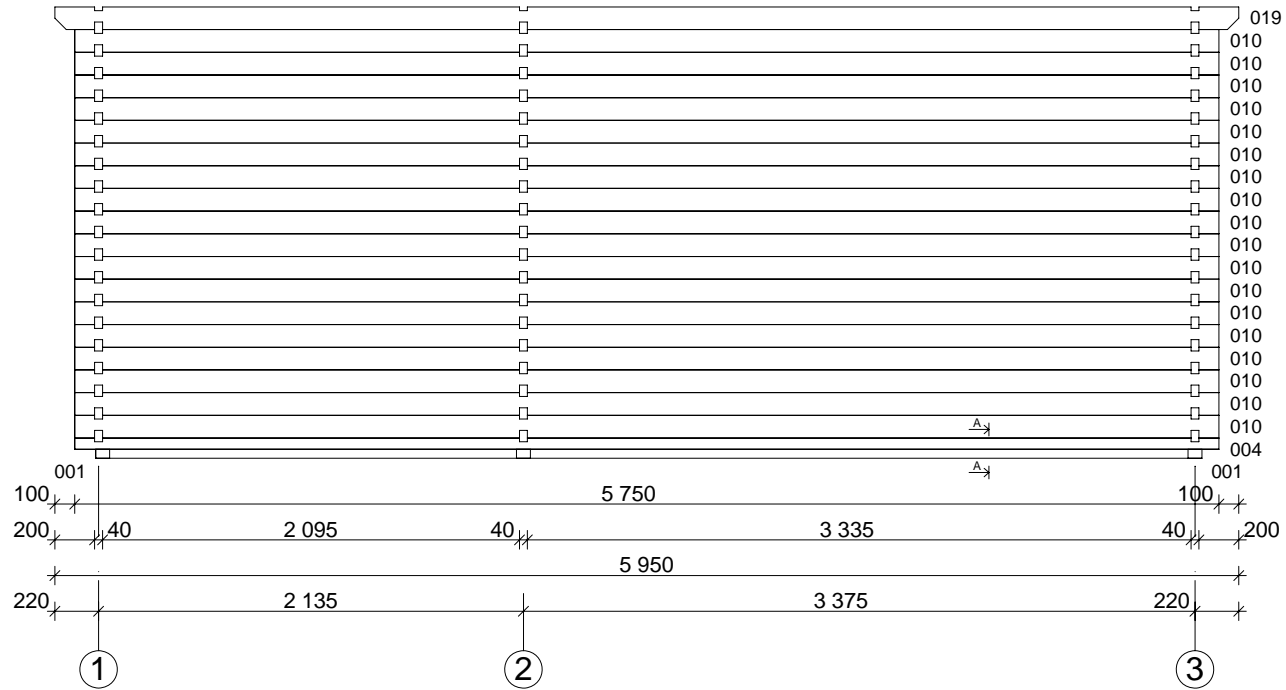

Nice 40 mm / 300 x 575 cm

1

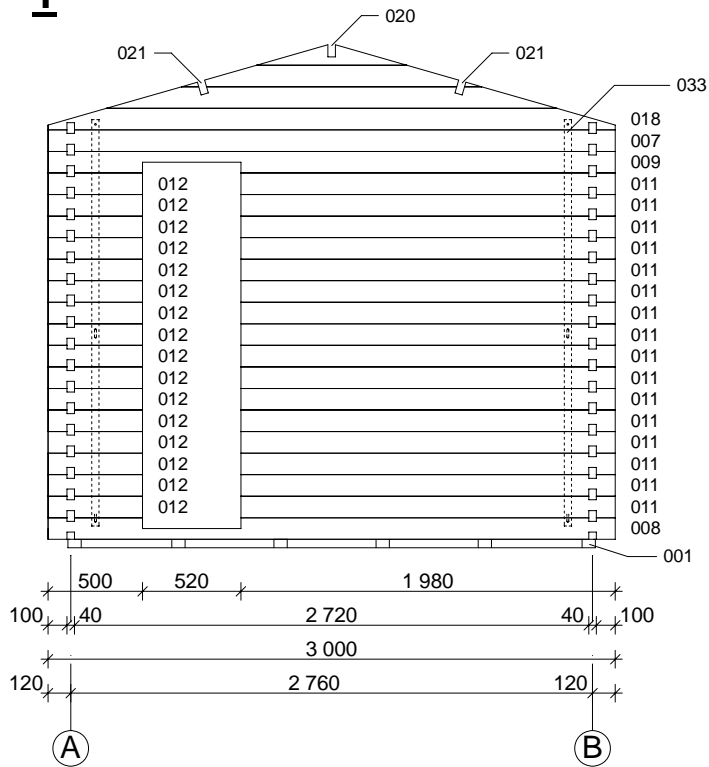

2

