

WASHINGTON MASONIC NATION

SPIRIT OF ANTICHRIST GOVERNING THE NEW ATLANTEAN CAPITAL

The pyramid configuration is off by 6° and is interwoven by the snake that appears to hold the whole complex together. This would render the symbology of Lucifer, the Dragon from whom the coming AntiChrist and False Prophet derive their power. In the ancient pyramid complexes, the buildings like that of Chechen Itza were directly associated with the descending Shining Serpent. The pyramids were 9 steps in height as is the main pyramid of the Masonic Memorial to Washington; it incorporates the same principle of the 'Phoenix' running down the stairs of the pyramid. What the recurring them and dates of this is to occur on is the Year of Light 5776. This is when the Temple, the capstone comes down from Heaven to complete their Temple of Light. The Masonic Memorial has a mural of the Ark of the Covenant and how the Luciferians are salivating to have it be in their possession to present it to their Dark Lord Lucifer to sit on in the very Holy of Holies that the Memorial is constructed to represent, the anthropomorphic man of the Temple of Solomon.

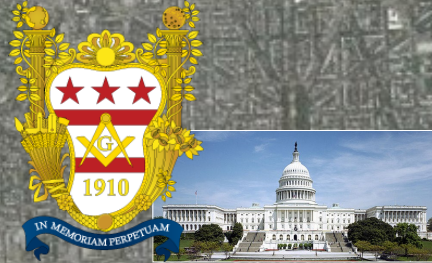

Capitol Hill

333 arcseconds
5.55 nautical



Washington Monument

5,555 smoots



House of the Temple

233 arcseconds
(322code)
6.9 km
444 miles



Pentagon

Eyes of Lucifer

In gambling, snake eyes is the outcome of rolling the dice in a game and getting only one pip on each die. The pair of pips resembles a pair of eyes, which is appended to the term 'snake' because of the long-standing association of this word with treachery and betrayal. The dictionary of etymology traces that use of the term back to 1929, although it may be traced all the way back to the ancient Roman dice games, where 'Dogs' represented two ones. They referred to this as "the dog throw". In modern parlance, it refers to such a roll in any game involving dice. Because this is the lowest possible roll, and will often be a loser in many dice games, such as Craps, the term has been employed in a more general usage as a reference to bad luck. The odds of rolling snake eyes on two six-sided dice are 1-in-36. In some board games, such as Monopoly, house rules may decide that this roll earns the player a bonus due to it being rare and otherwise disadvantageous.'



Statue of Liberty



Temple to Zeus, Baalbek

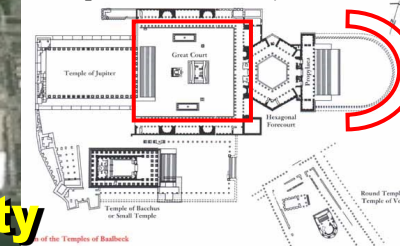

The Kaabah, Mecca

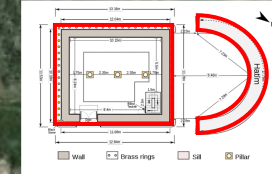

House of the Temple

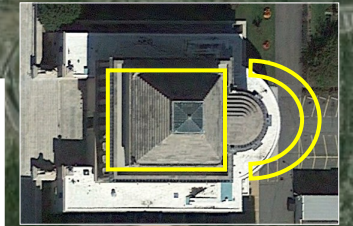

Washington Masonic Memorial

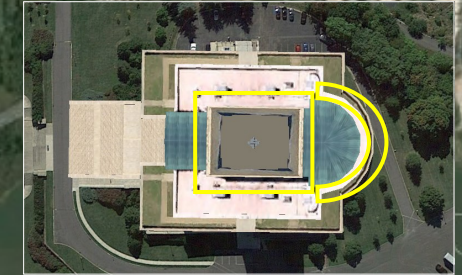

The pyramid configuration is off by 6° and is interwoven by the snake that appears to hold the whole complex together. This would render the symbology of Lucifer, the Dragon from whom the coming AntiChrist and False Prophet derive their power. The pyramid of the Memorial tower has 9 step like that of most ancient pyramids found in various parts of the world. All inclusive is 13 steps that is depicted in the reverse Seal of the USA.

332 km
180 nautical miles
116 arcseconds to
Ground Zero (911)
2.23 miles (322)
3.60 km (360day/

From Mecca to Memorial
=6,632 miles



Washington Masonic Memorial



The pyramid configuration is off by 6° and is interwoven by the snake that appears to hold the whole complex together. This would render the symbology of Lucifer, the Dragon from whom the coming AntiChrist and False Prophet derive their power. In the ancient pyramid complexes, the buildings like that of Chechen Itza were directly associated with the descending Shining Serpent. The pyramids were 9 steps in height as is the main pyramid of the Masonic Memorial to Washington; it incorporates the same principle of the 'Phoenix' running down the stairs of the pyramid. What the recurring them and dates of this is to occur on is the Year of Light 5776. This is when the Temple, the capstone comes down from Heaven to complete their Temple of Light. The Masonic Memorial has a mural of the Ark of the Covenant and how the

© Composition & Some Graphics by
LUIS B. VEGA
vegapost@hotmail.com
www.PostScripts.org

MAIN SOURCES
Chabad.org
GoogleEarth.com
TimeandDate.com
Wikipedia.org

FOR ILLUSTRATION PURPOSES ONLY