

# RADHA KRISHNA TEMPLE

## LOT 1, BLOCK A - RADHA ADDITION

### PAVING, DRAINAGE & UTILITY IMPROVEMENTS

#### CITY OF ALLEN, TEXAS

OWNER:  
 RADHA KRISHNA TEMPLE  
 7405 STONEY POINT DRIVE  
 PLANO, TEXAS 75025  
 SHREYA BHAT  
 (972) 527-6195

ENGINEER:  
 HELMBERGER ASSOCIATES, INC.  
 1525 BOZMAN ROAD  
 WYLIE, TEXAS 75098  
 RANDALL T. HELMBERGER, PE  
 (972) 442-7459 TBPE REG. No. F-000756

ARCHITECT:  
 SHASHI D. PATEL, AIA NCARB  
 ARCHITECTS AND PLANNERS  
 442 EAST END AVE, SUITE 8  
 PITTSBURG, PA 15221  
 SHASHI PATEL  
 (412) 760-5928

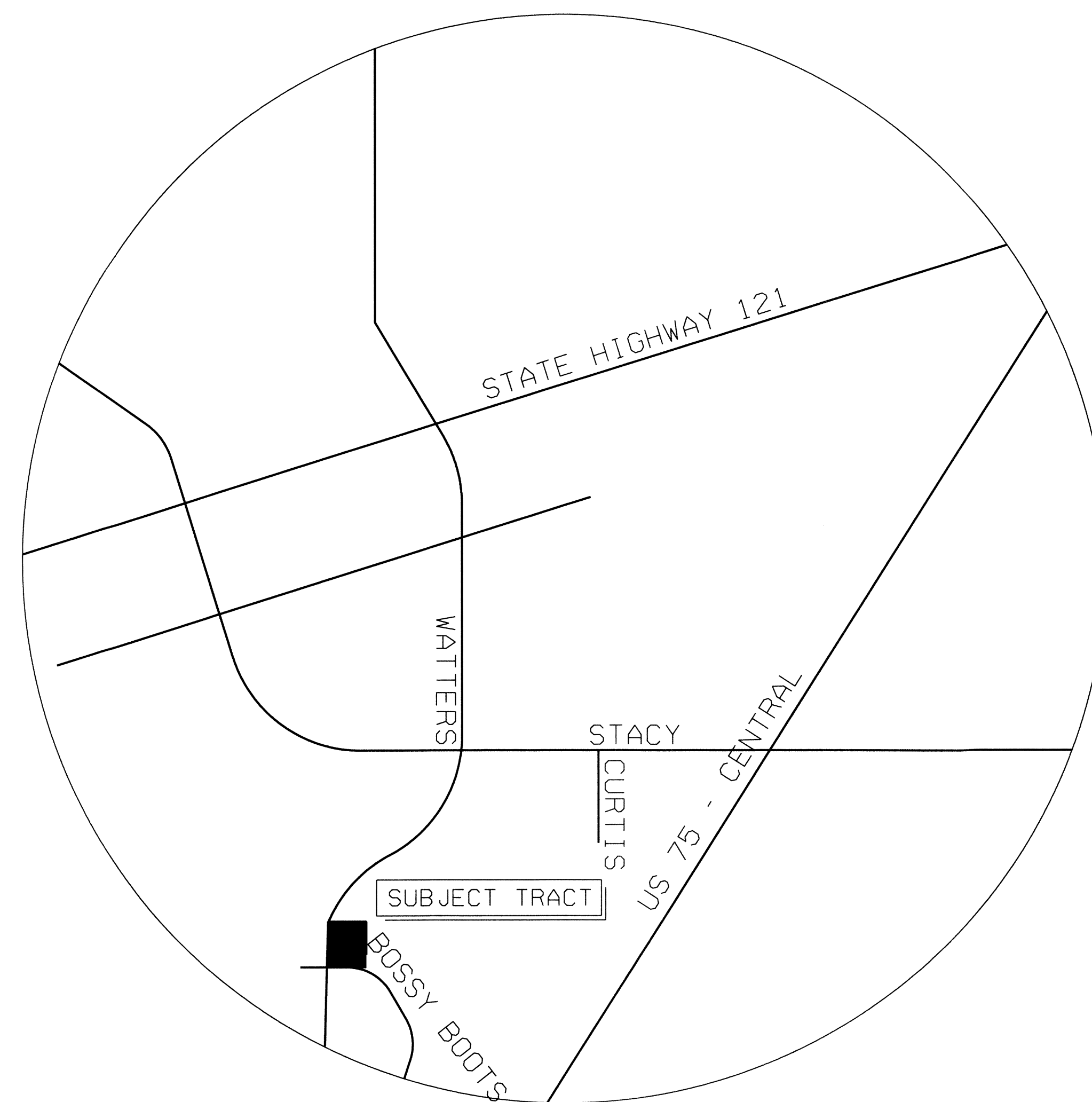

LOCATION MAP  
 MAPSCO PAGE 459-M

| SHEET INDEX                       |             |
|-----------------------------------|-------------|
| COVER                             |             |
| FINAL PLAN                        | FP1         |
| SITE PLAN                         | C1          |
| PAVING AND DIMENSION CONTROL PLAN | C2          |
| DECELERATION LANE                 | C2A         |
| TRAFFIC CONTROL PLAN              | TCP(1-4)-12 |
| UTILITY PLAN                      | C3          |
| GRADING AND DRAINAGE PLAN         | C4          |
| EROSION CONTROL PLAN              | C5          |
| LANDSCAPE PLAN                    | L1          |
| LANDSCAPE PLAN NOTES              | L2          |
| IRRIGATION PLAN                   | L3          |
| PEDESTRIAN FACILITIES CURB RAMPS  | PED-12A-1   |
| PEDESTRIAN FACILITIES CURB RAMPS  | PED-12A-2   |
| PEDESTRIAN FACILITIES CURB RAMPS  | PED-12A-3   |
| PEDESTRIAN FACILITIES CURB RAMPS  | PED-12A-4   |



RADHA KRISHNA TEMPLE