

Soils Map

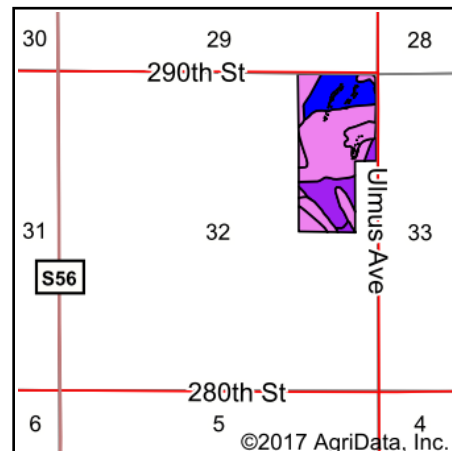

State: **Iowa**
 County: **Cerro Gordo**
 Location: **32-97N-19W**
 Township: **Falls**
 Acres: **67.58**
 Date: **9/16/2017**

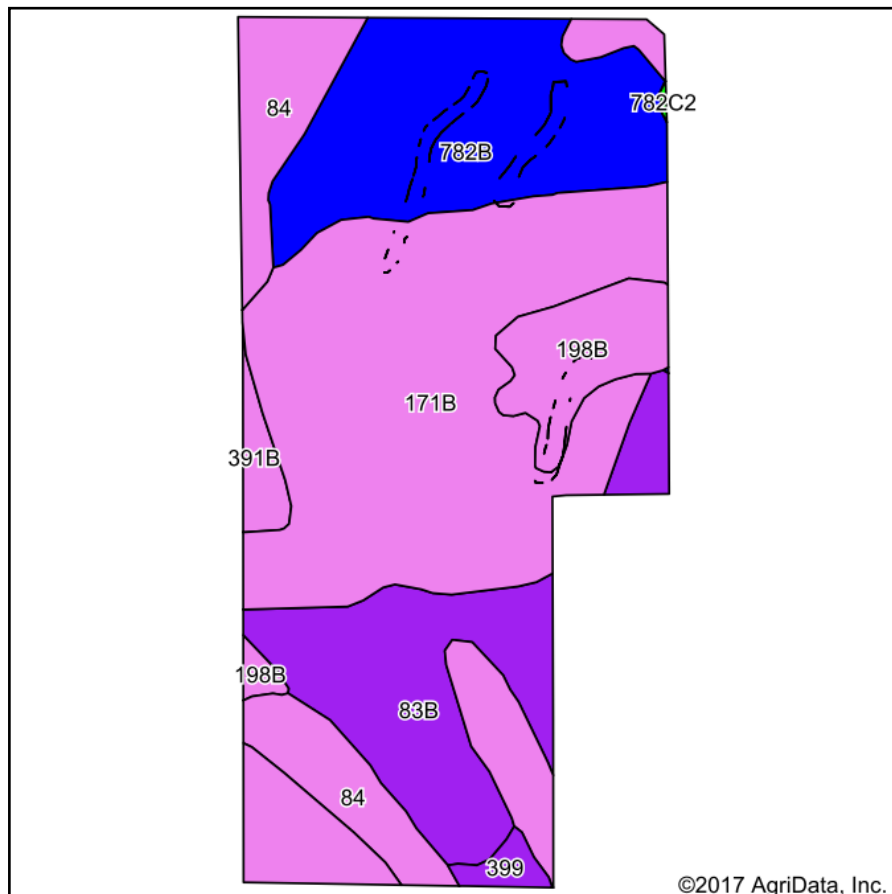

Maps Provided By:



© AgriData, Inc. 2017

www.AgriDataInc.com



Area Symbol: IA033, Soil Area Version: 19

Code	Soil Description	Acres	Percent of field	CSR2 Legend	Non-Irr Class *c	CSR2**	CSR	Corn	Soybeans
171B	Bassett loam, 2 to 5 percent slopes	27.93	41.3%		Ile	85	78	215	62
782B	Donnan loam, 2 to 5 percent slopes	13.24	19.6%		Ile	62	50		
83B	Kenyon loam, 2 to 5 percent slopes	10.80	16.0%		Ile	90	83	210	61
84	Clyde silty clay loam, 0 to 3 percent slopes	9.76	14.4%		Ilw	88	78	193.5	56
198B	Floyd loam, 1 to 4 percent slopes	4.14	6.1%		Ilw	89	78		
391B	Clyde-Floyd complex, 1 to 4 percent slopes	1.06	1.6%		Ilw	87	78		
399	Readlyn loam, 1 to 3 percent slopes	0.65	1.0%		Iw	91	88		
Weighted Average						82.1	73.4	150.4	43.5

**IA has updated the CSR values for each county to CSR2.

*c: Using Capabilities Class Dominant Condition Aggregation Method

Soils data provided by USDA and NRCS.