

# Soils Map

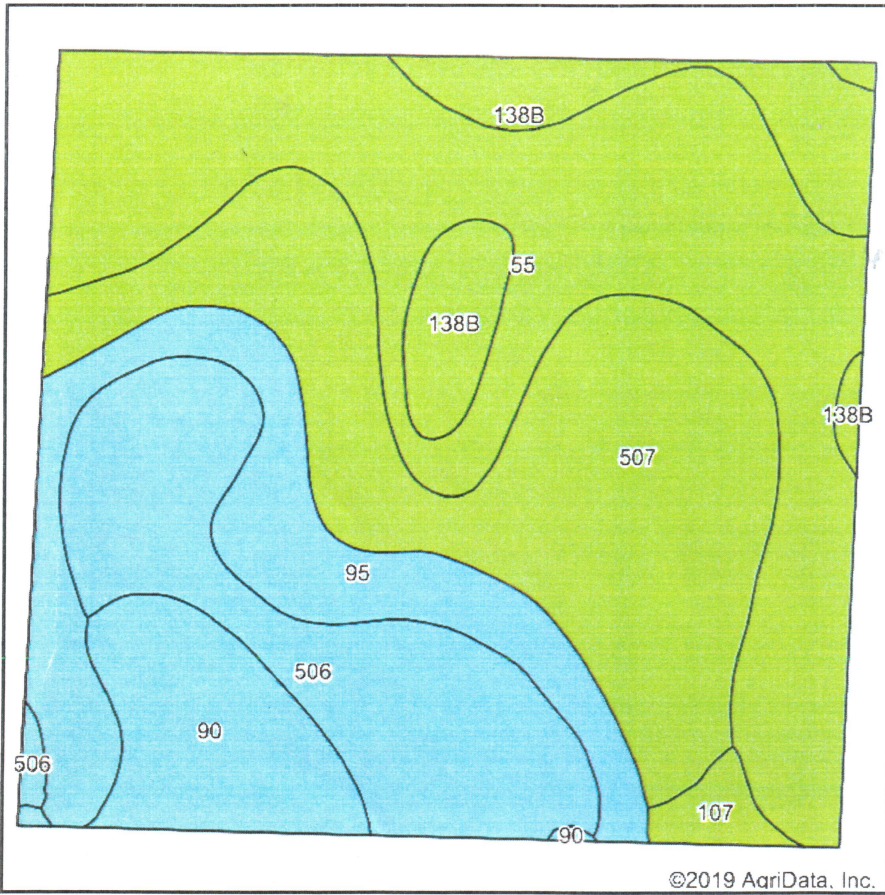

Soils data provided by USDA and NRCS.

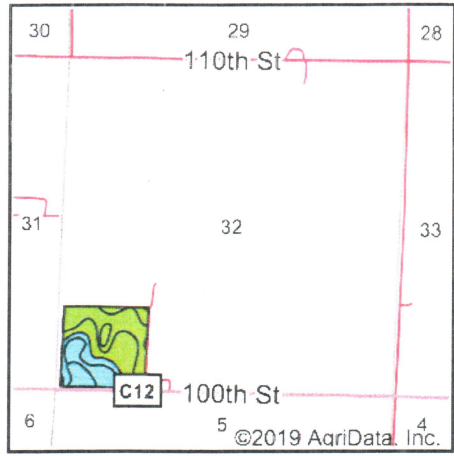

State: **Iowa**  
 County: **Kossuth**  
 Location: **32-94N-27W**  
 Township: **Lu Verne**  
 Acres: **37.49**  
 Date: **2/20/2019**



## Area Symbol: IA109, Soil Area Version: 24

Code	Soil Description	Acres	Percent of field	CSR2 Legend	Water Table	Restrictive Layer	Septic Limits	Foundation Limits	Non-Irr Class *c	CSR2**	CSR	*n NCCPI Soybeans
55	Nicollet clay loam, 1 to 3 percent slopes	12.14	32.4%		3.7ft.	> 6.5ft.	very limited	very limited	lw	89	85	78
507	Canisteo clay loam, 0 to 2 percent slopes	9.23	24.6%		2ft.	> 6.5ft.	very limited	very limited	llw	84	75	79
506	Wacousta silty clay loam, 0 to 1 percent slopes	5.59	14.9%		0ft.	> 6.5ft.	very limited	very limited	lllw	74	72	91
95	Harps clay loam, 0 to 2 percent slopes	4.49	12.0%		2.6ft.	> 6.5ft.	very limited	very limited	llw	72	60	77
138B	Clarion loam, 2 to 6 percent slopes	2.85	7.6%		2.9ft.	> 6.5ft.	very limited	somewhat limited	lle	89	77	83
90	Okoboji mucky silt loam, 0 to 1 percent slopes	2.74	7.3%		0ft.	> 6.5ft.	very limited	very limited	lllw	56	56	75
107	Webster clay loam, 0 to 2 percent slopes	0.45	1.2%		0ft.	> 6.5ft.	very limited	very limited	llw	86	80	80
<b>Weighted Average</b>										<b>81</b>	<b>74.8</b>	<b>*n 80.2</b>

\*IA has updated the CSR values for each county to CSR2.

n: The aggregation method is "Weighted Average using major components"

c: Using Capabilities Class Dominant Condition Aggregation Method

Soils data provided by USDA and NRCS.