

Board of Directors Karl Nurse, Sandra Murman, Dave Eggers, Pat Gerard, Ken Hagan, Jack Mariano, Rob Marlowe, Charlie Miranda, Ron Oakley

General Manager Matthew W. Jordan

General Counsel Barrie S. Buenaventura, Conn & Buenaventura, P.A.

2575 Enterprise Road, Clearwater, FL 33763-1102

Phone: 727.796.2355 / Fax: 727.796.2388

www.tampabaywater.org



April 25, 2017

CANTERBURY GLEN HOMEOWNERS ASSOC INC  
PO BOX 877  
ODESSA, FL 33556-0877

**Re: Tampa Bay Water Pipeline Condition Assessment**

Dear Resident:

Tampa Bay Water will soon begin a project to assess the condition of a drinking water pipeline near your neighborhood. We are assessing a six-mile portion of the South Pasco Transmission Main that runs along Van Dyke Road between Whirley Road and Gunn Highway, and south along Gunn Highway to Race Track Road into the Cosme Water Treatment Plant (map included). This pipeline is part of Tampa Bay Water's regional water supply system that delivers potable water to Hillsborough County and the City of St. Petersburg.

The South Pasco Transmission Main was installed in 1971 and is due for inspection. These pipelines typically have a useful life of 50-75 years, and inspections can prolong the life of the pipeline by finding areas in need of replacement or repair.

The assessment will begin in early May and continue through the end of May. During this time, residents may see digging equipment and work trucks. All activities are planned to take place on weekdays during daylight hours when possible.

To minimize impacts to surrounding residents, Tampa Bay Water will use devices that flow through the pipeline to detect leaks and wear.

We will install sensors at select locations along the pipeline to track the detection devices. In most cases, there is no impact to residents as we will use existing manholes to install sensors. In areas where manhole access is unavailable, we will dig three-foot diameter holes to attach sensors to the pipeline. Each installation should take approximately three hours.

If digging is required near residents' yards or nearby streets, we will contact those residents directly or through their homeowners association.



If you have questions regarding the assessment, please contact our dedicated construction information hotline at 1-866-INFO-H2O (1-866-463-6426), or email Brandon Moore, Tampa Bay Water's public communications manager, at [bmoore@tampabaywater.org](mailto:bmoore@tampabaywater.org).

Sincerely,

A handwritten signature in black ink that reads "Suzannah J. Folsom". The signature is written in a cursive style with a large, sweeping flourish at the end.

Suzannah J. Folsom, PE  
Senior Professional Engineer  
Tampa Bay Water

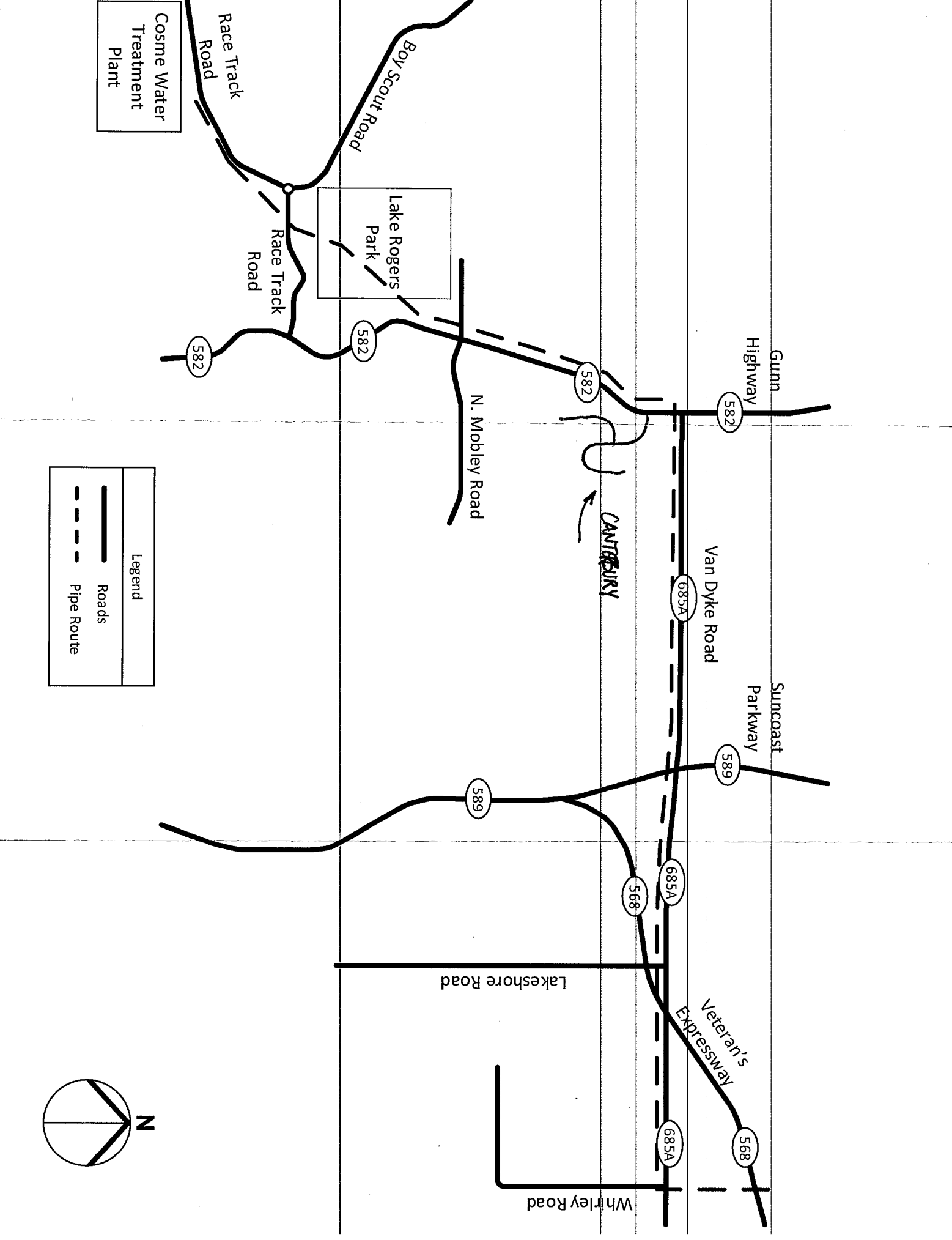

Cosme Water Treatment Plant

Lake Rogers Park

CANTABURY

Legend

Roads

Pipe Route

N

