

RYERSON REALTY LLC

2761 Country Lane Circle
 Eagle Grove, IA 50533-0877
Phone 515-448-3079
 Fax 515-448-5028
 ryerson@goldfieldaccess.net
www.ryersonauctionrealtyltd.com



Deborah D Vance, Broker 515-689-3715 **Michael Ryerson, Sales 515-689-3728**
Todd Swalin 515-689-8987

Property Location: 1403 SW 1st Eagle Grove, IA
Legal Description: LOT 11 & E 8' OF LOT10 SAD/K
Price: \$159,000
Approximate Age: 1968
Style: Ranch

Bedrooms: 5+
Siding: Brick
Roof Age: Unk
Lot Size: 96X160
House Sq Ft: 1,708
Garage: Att 2 car 22X22
3 season: 10X20 Small fenced area
Deck: Front 16x30
Living Room Flooring: Vinyl
Family Room: main level w/fire place carpet 14X22

Bathrooms: Main 3/4 & full Basement 3/4
 Basement: 1,400 sq ft + 308' raised storage
Furnace: Forced air RUDD
Central Air: yes
24 Mo. Ave. Gas/Elec: \$160.00
Terms of Sale/Possessor: Cash/Upon Final Settlement

Kitchen Details:
Cabinets: oak
Counters: laminate
Stove: Elec yes
Frig: yes
Dishwasher: yes
Flooring: oak
Garbage disposal: yes

Dining Room: yes/off kitchen
Laundry Location: Basement
Dryer: Elec no
Washer: no
Water Heater: gas
Elec. Panel: Breakers

Net Taxes: 21-22 \$3,732.00

This is a great family home with open concept living, tons of living space & storage. Parimary BR 3/4 bath, 2 more BR's on main with full bath. Family room with fireplace off kitchen. Large Family/Game room basement 2 more BR's 1 w/egress & spacious office or den, laundry w/sink & 14X22 raised storage. 3 season room off family room & small area fenced in spacious yard.

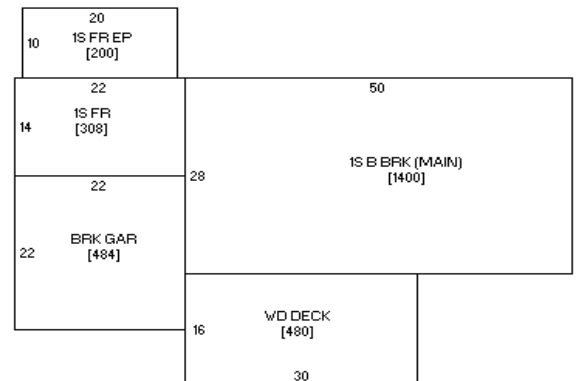

The following information, although believed to be accurate, is not guaranteed to be so.

We assume no liability. The measurements are estimates only.

Buyer should do his own inspections to be sure, estate no disclosure.

This info is subject to change without notice. The seller does not warrant appliances past day of listing.

The greatest compliment we can receive is a personal referral, please tell your friends about us