

TRUE NORTH AT THE 74°30'  
MERIDIAN OF WEST LONGITUDE





LIMIT OF ROADWAY REHABILITATION

TEMPORARY CONCRETE BARRIER

TEMPORARY CONCRETE BARRIER

LIMIT OF ROADWAY REHABILITATION

TEMPORARY CONCRETE BARRIER

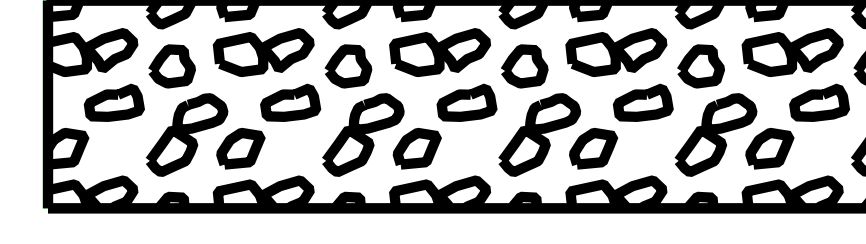
-  - TEMPORARY DETOUR LOCATION
-  - TURF RESTORATION
-  - GROUTED RIPRAP

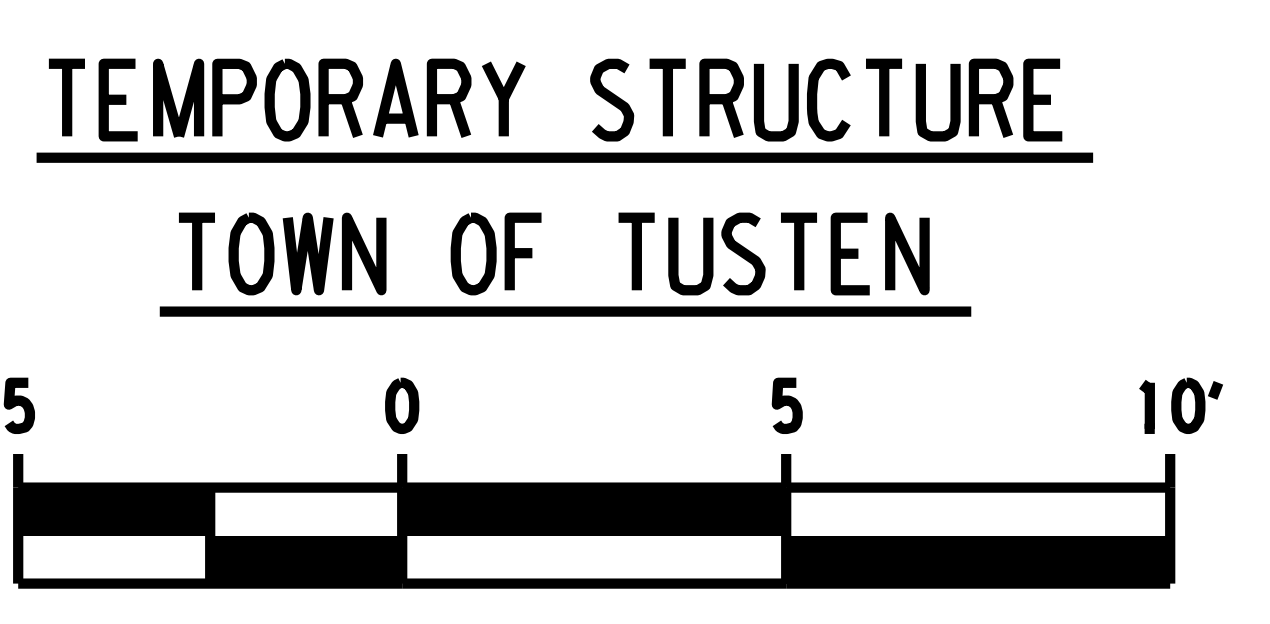

DATE: MARCH 23, 2020

MAIN STREET CULVERT REPLACEMENT  
PIN 9754.85/LD036076