



# *Mayflower*

CRUISES & TOURS

# Portugal and the Douro River Cruise

---

# The Portugal and the Douro River Cruise



11 Days • 23 Meals



# The Portugal and the Douro River Cruise



*MS Emerald Radiance – 7 nights onboard*

**Mayflower**  
CRUISES & TOURS



# *MS Emerald Radiance*

**Built:** 2017 **Speed:** 15.5 mph **Staterooms:** 52 **Suites:** 4 **Length:** 292 ft. **Crew:** 37



## **Public Areas and Ship Amenities**

- Dining Room
- Lounge
- Sun Deck featuring deck chairs and walking track
- Elevator
- Outdoor swimming pool and bar
- Fitness room, hairdresser, massage therapy room
- Voltage: 220V
- Complimentary WiFi

*MS Emerald Radiance – 7 nights onboard*

# The Portugal and the Douro River Cruise

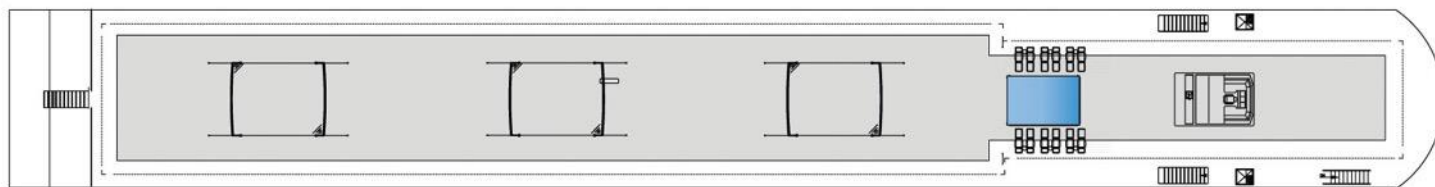

HORIZON DECK

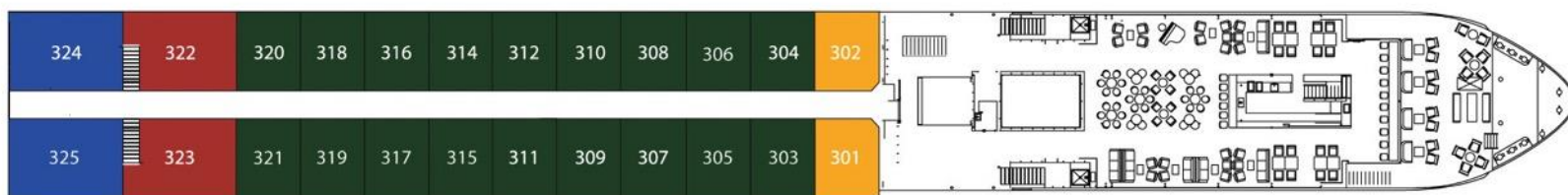

VISTA DECK

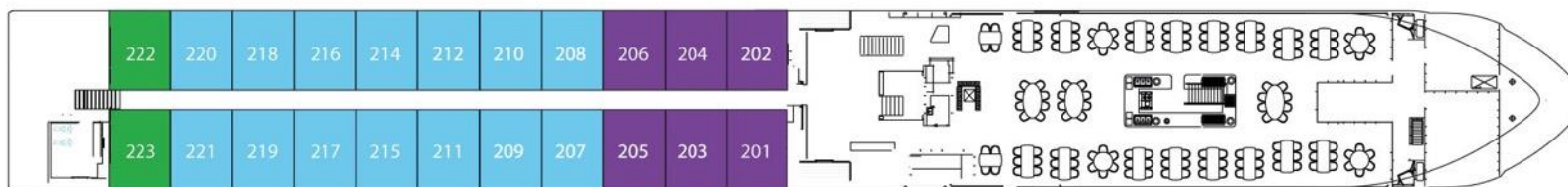

RIVIERA DECK

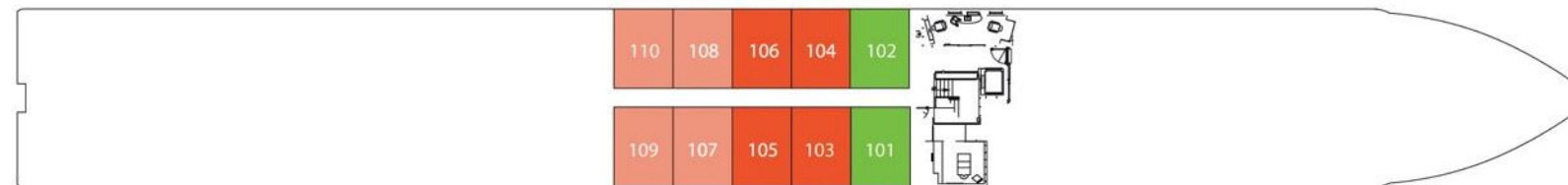

# The Portugal and the Douro River Cruise



*Emerald Stateroom – Riviera Deck*



# The Portugal and the Douro River Cruise

RIVIERA DECK

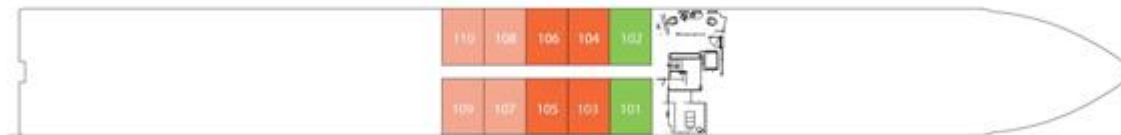

## ***RIVIERA DECK - \$4799***

- 153-170 sq feet (Based on ship location)
- Lowest deck
- Picture window (doesn't open)
- Bathroom with shower and hair dryer
- Two twin beds that can be put together
- Dresser
- Closet
- Safe
- Flat screen TV
- Mini-fridge

*Emerald Stateroom – Riviera Deck*



# The Portugal and the Douro River Cruise

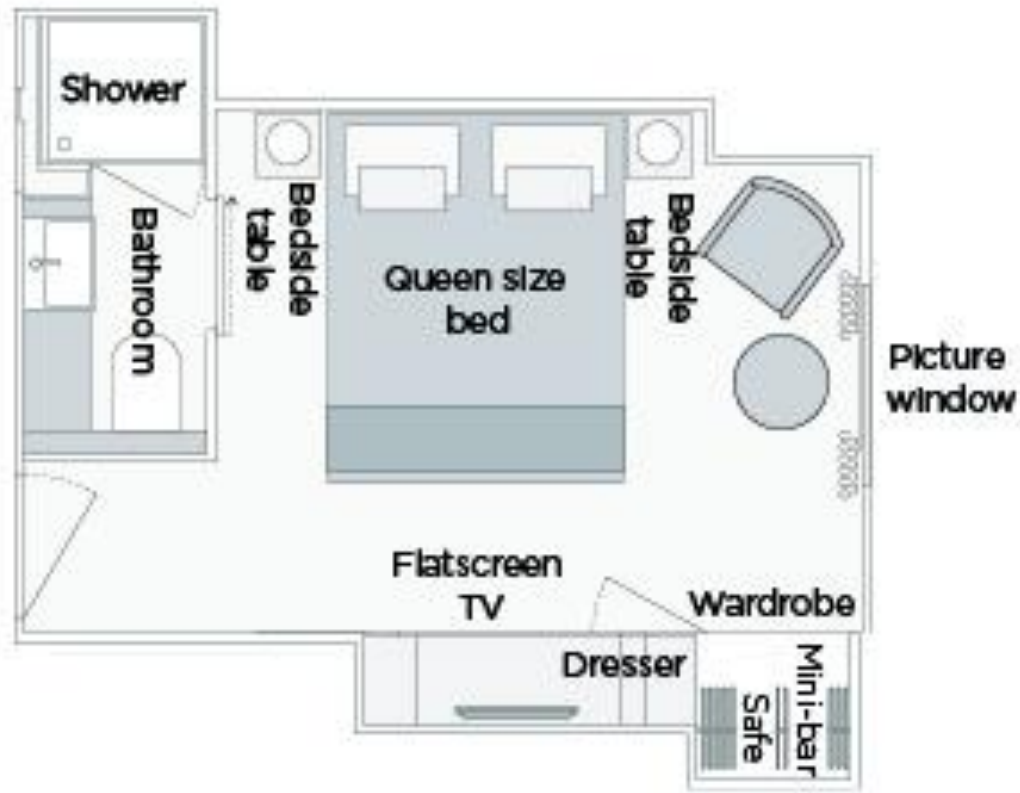

*Emerald Stateroom – Riviera Deck*

# The Portugal and the Douro River Cruise



*Emerald Panorama Balcony Suite – Vista & Horizon Decks*



# The Portugal and the Douro River Cruise

## VISTA DECK

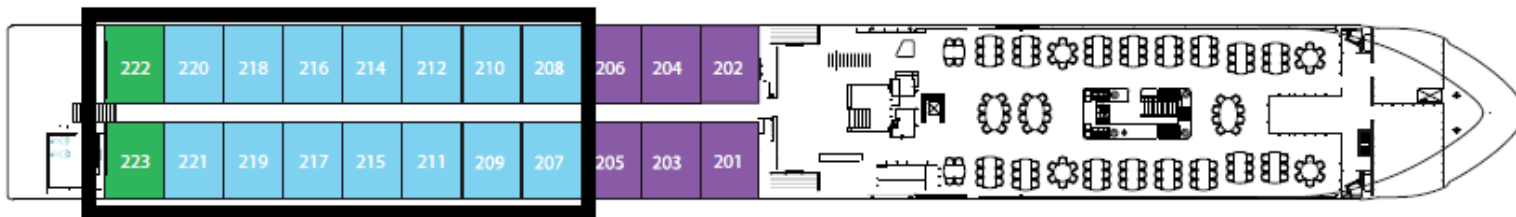

## ***VISTA DECK CAT B - \$5199***

- 160 sq feet
- Middle deck
- Indoor balcony with open-air system
- Bathroom with shower and hair dryer
- Two twin beds that can be put together
- Dresser
- Closet
- Safe
- Flat screen TV
- Mini-fridge

*Emerald Stateroom – Vista Deck*

# The Portugal and the Douro River Cruise

## VISTA DECK

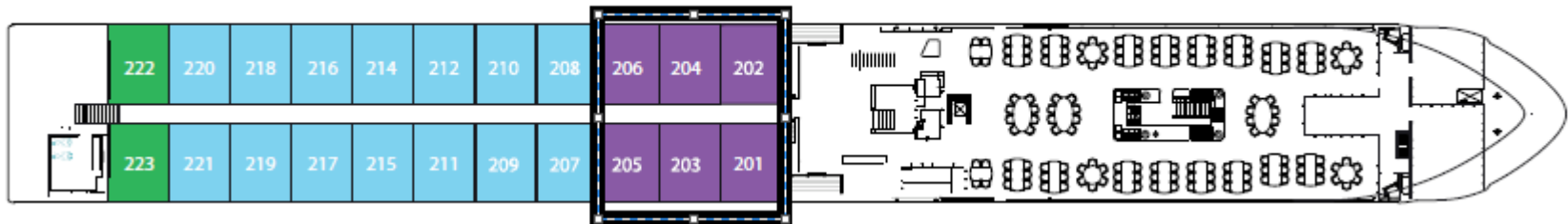

## ***VISTA DECK CAT R - \$5599***

- 188 sq feet
- Middle deck
- Indoor balcony with open-air system
- Bathroom with shower and hair dryer
- Two twin beds that can be put together
- Dresser
- Closet
- Safe
- Flat screen TV
- Mini-fridge

*Emerald Stateroom – Vista Deck*



# The Portugal and the Douro River Cruise

## HORIZON DECK

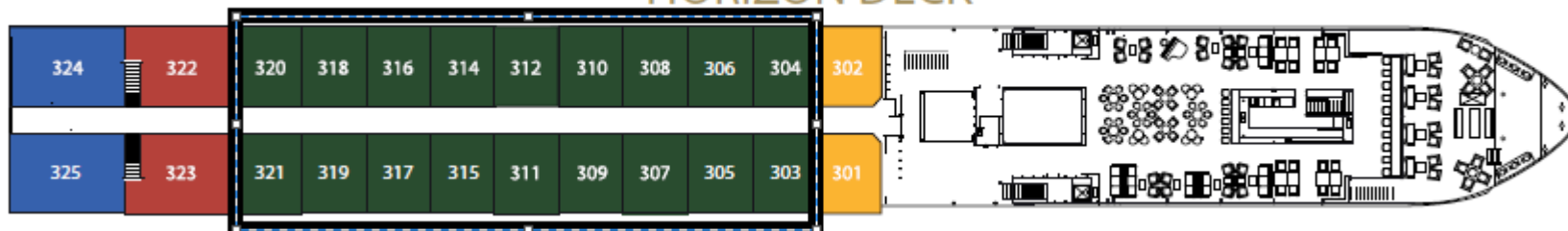

## ***HORIZON DECK CAT A – \$5,799***

- 160 sq feet
- 3<sup>rd</sup> level, highest deck with cabins
- Indoor balcony with open-air system
- Bathroom with shower and hair dryer
- Two twin beds that can be put together
- Dresser
- Closet
- Safe
- Flat screen TV
- Mini-fridge



*Emerald Stateroom – Horizon Deck*

# The Portugal and the Douro River Cruise

## HORIZON DECK



## ***HORIZON DECK CAT P – \$5,899***



- 170 sq feet
- 3<sup>rd</sup> level, highest deck with cabins
- Indoor balcony with open-air system
- Bathroom with shower and hair dryer
- Two twin beds that can be put together
- Dresser
- Closet
- Safe
- Flat screen TV
- Mini-fridge

## *Emerald Stateroom – Horizon Deck*



# The Portugal and the Douro River Cruise



Panorama Balcony Suite CAT P | CAT A | CAT R | CAT B

# The Portugal and the Douro River Cruise



*Emerald One Bedroom Owners Suite – Horizon Deck*



# The Portugal and the Douro River Cruise

## HORIZON DECK

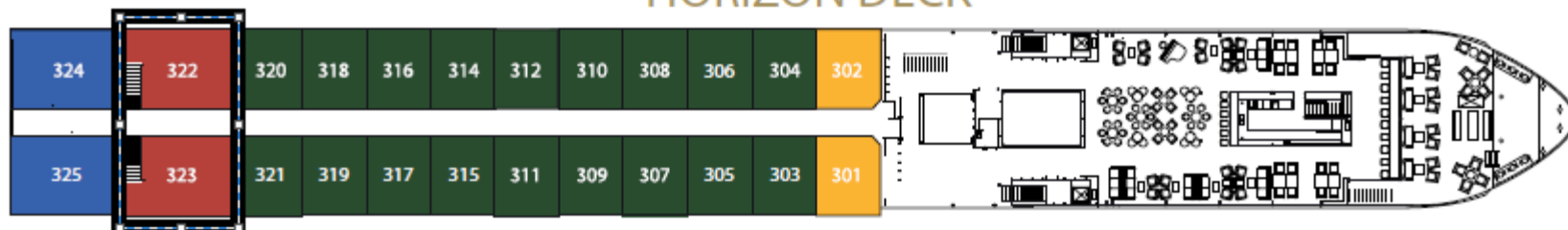

### ***OWNER'S ONE BEDROOM SUITE – \$6,299***



- 285 sq feet
- 3<sup>rd</sup> level, highest deck with cabins
- Floor-to-ceiling windows
- Sitting area
- Indoor balcony with open-air system
- Bathroom with shower and hair dryer
- Two twin beds that can be put together
- Dresser
- Walk-in Closet
- Safe
- Flat screen TV
- Mini-fridge

*Emerald Stateroom – Owner's Suite*

# The Portugal and the Douro River Cruise

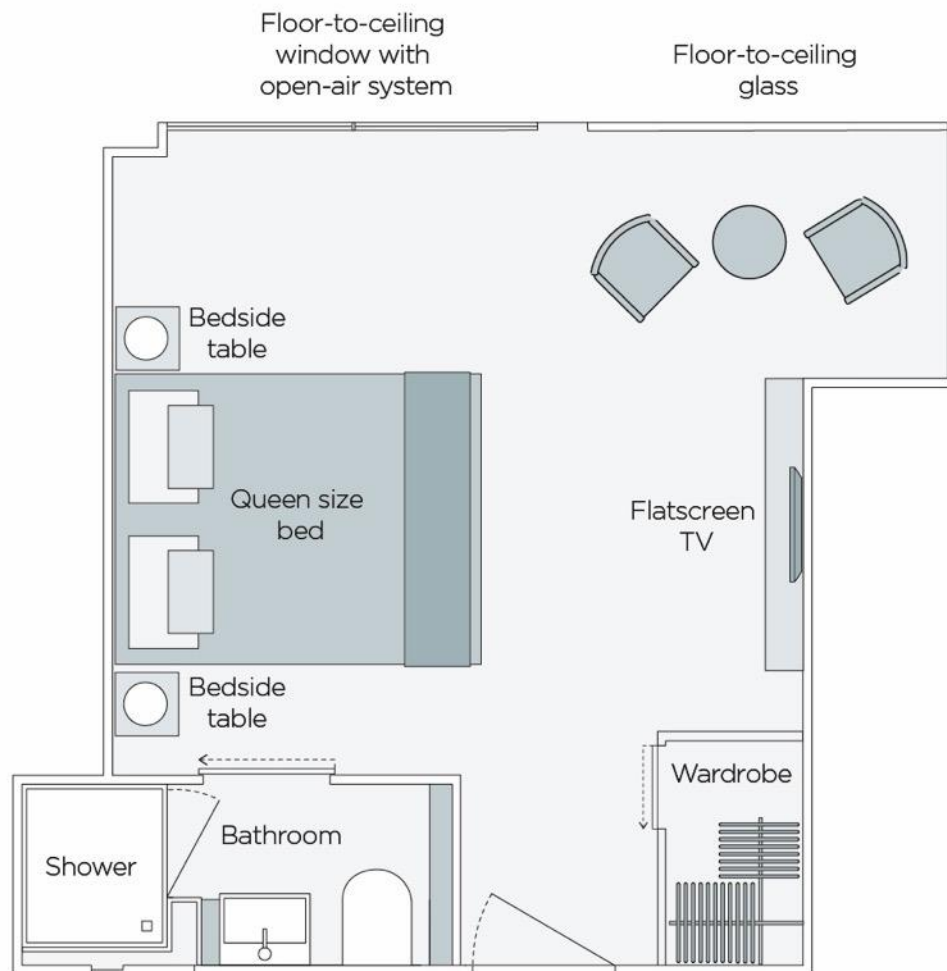

## Owner's One-Bedroom Suite

# The Portugal and the Douro River Cruise



*Riverview Suite*



# The Portugal and the Douro River Cruise

## HORIZON DECK

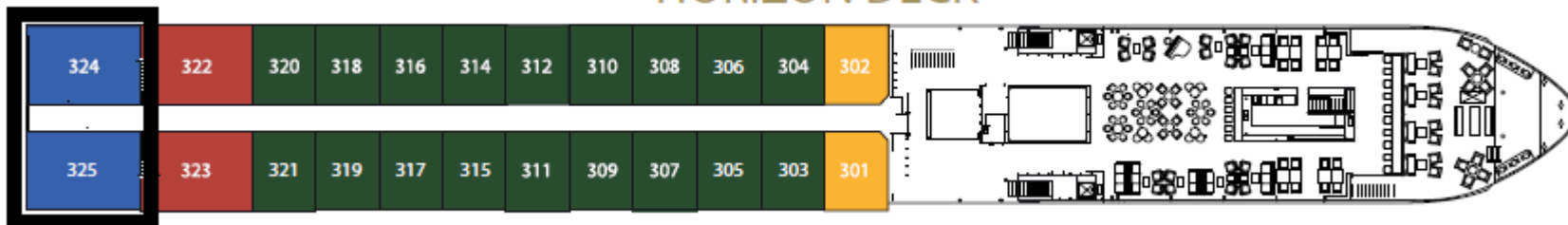

## ***RIVERVIEW SUITE – \$6,499***



- 300 sq feet
- 3<sup>rd</sup> level, highest deck with cabins
- Floor-to-ceiling windows
- Separate bedroom and lounge area with sofa/chair
- Indoor balcony with open-air system
- Bathroom with tub and separate shower
- Two twin beds that can be put together
- Dresser
- Walk-in Closet
- Flat screen TV
- Mini-fridge

*Emerald Stateroom – Riverview Suite*

# The Portugal and the Douro River Cruise

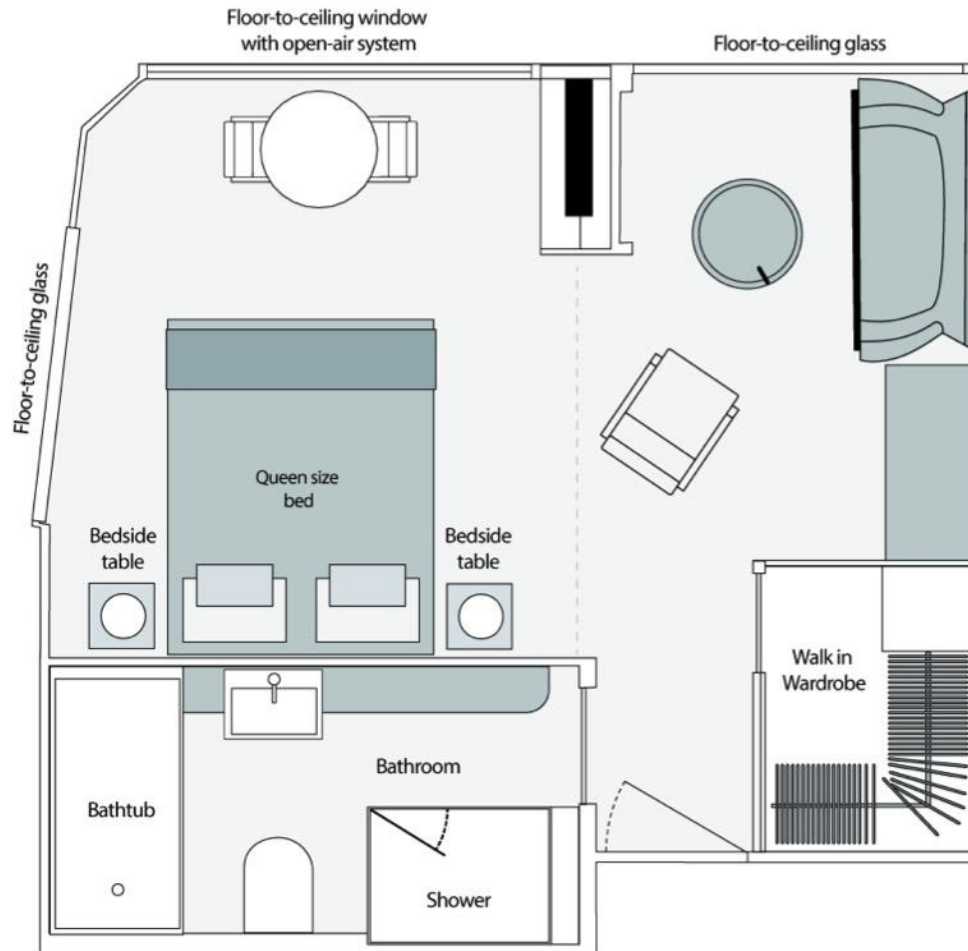

Emerald Riverview Suite

# The Portugal and the Douro River Cruise



*MS Emerald Radiance*

**Mayflower**  
CRUISES & TOURS



# The Portugal and the Douro River Cruise

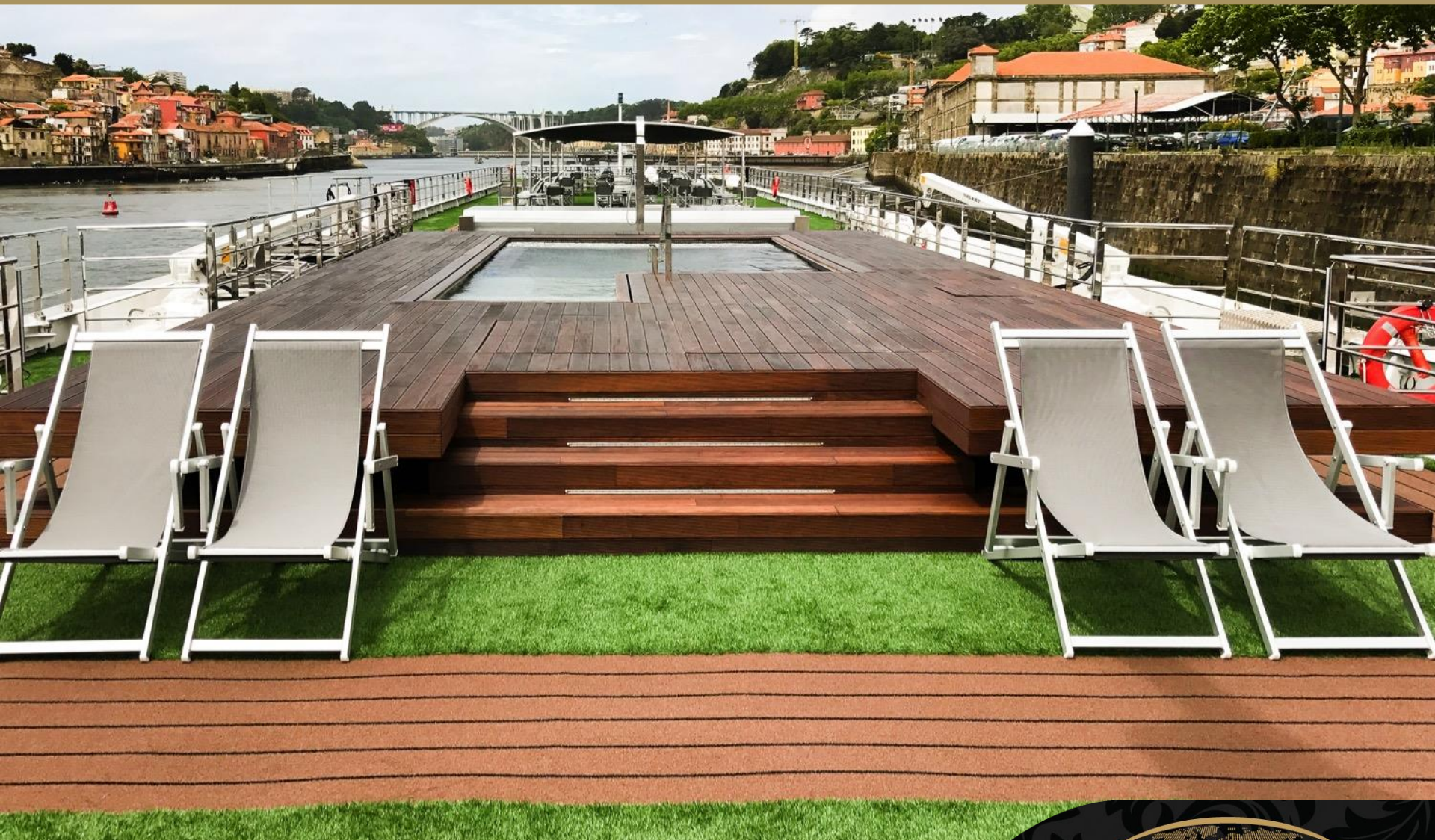

*MS Emerald Radiance*

**Mayflower**  
CRUISES & TOURS





# The Portugal and the Douro River Cruise

| <u>Category</u>      | <u>Per Person Twin</u> | <u>Single Room Add</u> |
|----------------------|------------------------|------------------------|
| Riviera Deck         | \$4799                 | \$3119                 |
| Vista Deck (CAT B)   | \$5199                 | \$3379                 |
| Vista Deck (CAT R)   | \$5599                 | \$3639                 |
| Horizon Deck (CAT A) | \$5799                 | \$3769                 |
| Horizon Deck (CAT P) | \$5899                 | \$3839                 |
| Owners Suite         | \$6299                 | N/A                    |
| Riverview Suite      | \$6499                 | N/A                    |

| <u>Barcelona Extension</u>                | <u>Per Person Twin</u> | <u>Single Room Add</u> |
|---|------------------------|------------------------|
| *Includes airfare from Porto to Barcelona | \$1489                 | \$789                  |

***FREE AIRFARE IF BOOKED BY OCTOBER 1<sup>st</sup>, 2018!***

*\*Includes taxes/fees and transfers to and from airport*