



# Quick - connects

SQC Series, SFQC Series



[www.SuperlokUSA.com](http://www.SuperlokUSA.com)

5777 Olivas Park Dr Unit#G  
Ventura, CA 93003

805-658-2043

[sales@superlokusa.com](mailto:sales@superlokusa.com)

# INSTRUMENTATION QUICK - CONNECTS

## SQC SERIES



### FEATURES

- Simple push-pull action to connect and disconnect lines-no tools required.
- Plug and body are available valved or unvalved. Valves automatically open when connected and shut off when disconnected to minimize the loss of liquids or gases.

### TABLE OF DIMENSIONS

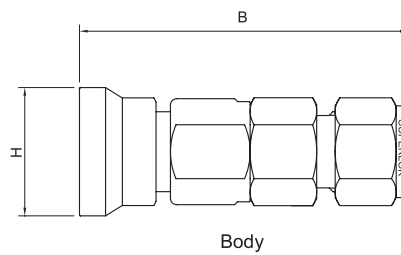
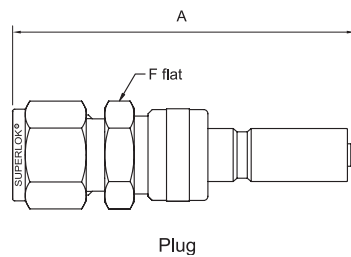

Unit : mm

Unit : mm

Ordering Number		Cv		End Connection		A		F	Ordering Number		End Connection		B	H	
Plug Series	Part no.	SO	DO	Type	SO	DO	Body Series		Part no.	Type					
SO	DO														
SQC1- SO-PG	SQC1- DO-PG	S	2	0.08	0.08	1/8" Superlok	70.4	15.9	SQC1-BY	S	2	1/8" Superlok	57.4	23.1	
			4			1/4" Superlok	61.5				4	1/4" Superlok	58.4		
			6M			6mm Superlok					6M	6mm Superlok			
	M	2N	0.4	0.2	1/8" Male NPT	54.1	M			2N	1/8" Male NPT	51.1			
		4N(R)			1/4" Male NPT(PT)	57.9				4N(R)	1/4" Male NPT(PT)	56.9			
		F			2N	1/8" Female NPT				52.6	F	2N	1/8" Female NPT		
4N(R)	1/4" Female NPT(PT)		58.9	4N(R)	1/4" Female NPT(PT)	61.5									
SQC2- SO-PG	SQC2- DO-PG	S	6	1.5	0.5	3/8" Superlok	67.1	19.1	SQC2-BY	S	6	3/8" Superlok	65.5	26.2	
			10M			10mm Superlok	70.4				10M	10mm Superlok	68.1		
			4N			1/4" Male NPT	61.9				4N	1/4" Male NPT	60.5		
	M	6N(R)	1.6	0.5	3/8" Male NPT(PT)		M			6N(R)	3/8" Male NPT(PT)	60.5			
		F	4N	1.5	0.5	1/4" Female NPT				62.7	F	4N	1/4" Female NPT		64.5
			6N(R)	1.6	0.5	3/8" Female NPT(PT)				22.2		6N(R)	3/8" Female NPT(PT)		65.3
SQC3- SO-PG	SQC3- DO-PG	S	8	3.3	1.5	1/2" Superlok	80.3	23.8	SQC3-BY	S	8	1/2" Superlok	78.5	30.7	
			12M			12mm Superlok						12M			12mm Superlok
	M	8N(R)	3.1	1.3	1/2" Male NPT(PT)	77.2	M			8N(R)	1/2" Male NPT(PT)	75.4			
		F			8N(R)	1/2" Female NPT(PT)				76.7	F	8N(R)	1/2" Female NPT(PT)		81.8

• SO : Single shutoff type      • DO : Double shutoff type

**MATERIALS OF CONSTRUCTION**

Component	Material	
Body	316 SS	
Housing		
Double shut off stem		
Double shut off stem retainer		
Body valve		
Body insert		
Single shut off stem retainer		
O-ring		Viton
Spring		304 SS
Body sleeve		316 SS
Plug sleeve		
Locking Balls		

**INSERTION DEPTH**

Series	Depth, in.(mm)	
	SO	DO
SQC - 01	1.09(27.7)	1.15(29.2)
SQC - 02	1.18(30.0)	1.30(33.0)
SQC - 03	1.48(37.6)	1.68(42.7)

**SPILLAGE**

Spillage is the amount of system fluid that escapes when a quick-connect is uncoupled (double shut off only)

Series	SPILLAGE
SQC 1	0.3 cm <sup>3</sup>
SQC 2	1.0 cm <sup>3</sup>
SQC 3	3.0 cm <sup>3</sup>

**ORDERING INFORMATION**

**SQC - DO - PG - S - 6 - SS**

1
2
3
4

**1 Body Series**

SQC1 - BY  
SQC2 - BY  
SQC3 - BY

**Plug Series**

SQC1 - SO - PG / SQC1 - DO - PG  
SQC2 - SO - PG / SQC2 - DO - PG  
SQC3 - SO - PG / SQC3 - DO - PG  
• SO : Single shutoff type • DO : Double shutoff type

**2 End Connection**

S : SUPERLOK Tube Fitting  
F : Female Thread  
M : Male Thread

**3 End Connection Size**

- Tube O.D Designation

Tube O.D (inch)	1/4	3/8	1/2
Designation	4	6	8
Tube O.D (mm)	6	10	12
Designation	6M	10M	12M

- Pipe Thread Designation

Size (inch)	1/8	1/4	3/8	1/2
Screwed BSPT	2R	4R	6R	8R
Screwed NPT	2N	4N	6N	8N

**4 Body Material**

SS : 316 Stainless Steel  
B : Brass

**PRESSURE-TEMPERATURE RATINGS**

Temperature °F (°C)	316 SS with Fluorocarbon FKM O-ring		
	SQC 1	SQC 2	SQC 3
	Pressure Rating, coupled, psig (bar)		
70 (20)	3000 (206)	1500 (103)	750 (51.6)
400 (204)	250 (17.2)		

**MAXIMUM FLOW RATE**

water at 70°F(20°C)

Series	SQC 1	SQC 2	SQC 3
U.S gal/min	4	6	10
L/min	15	22	37

**OVERALL LENGTH**

To calculate overall length in the coupled position, subtract the insertion depth from any overall plug and body combination length

**OPTION**

**BODY & PLUG PROTECTOR**

Body & Plug Protectors guard against damage and contaminants when bodies and plug are uncoupled.

Series	Ordering Number	
	Body Protector	Plug Protector
SQC 1	SQC1 - BP	SQC1 - PP
SQC 2	SQC2 - BP	SQC2 - PP
SQC 3	SQC3 - BP	SQC3 - PP

# FULL FLOW QUICK - CONNECTS

## SFQC SERIES



### FEATURES

- Proven ball - lock mechanism provides positive connection.
- Simple push - pull action to connect and disconnect lines - no tools required.
- Compact coupling offers full flow without orifice restrictions.
- O-ring is easily replaced without disassembling body.

### TABLE OF DIMENSIONS

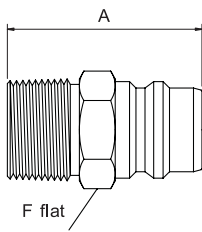

Plug

Unit : mm

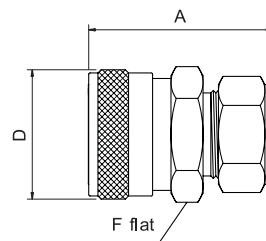

Body

Unit : mm

Ordering Number		End Connection		Cv	Min Orifice	A	F
Body Series	Part no.	Type					
SFQC2-PG	S	4	1/4 " Superlok		2.2	4.8	14.3
	S	6	3/8 " Superlok				17.5
	M	4N(R)	1/4 " Male NPT		1.7	6.1	14.3
	M	6N(R)	3/8 " Male NPT(PT)				17.5
	M	4G	1/4 " Male PF		40.6	19.1	
	F	4N(R)	1/4 " Female NPT(PT)		42.4	22.2	
	F	6N(R)	3/8 " Female NPT(PT)		40.6	19.1	
	F	4G	1/4 " Female PF				
SFQC3-PG	S	6	3/8 " Superlok		2.9	7.1	47.8
	S	8	1/2 " Superlok		13.0	10.4	50.5
	M	6N(R)	3/8 " Male NPT(PT)		7.1	10.4	41.9
	M	8N(R)	1/2 " Male NPT(PT)		11.5	12.7	46.7
	M	8G	1/2 " Male PF		11.5	12.7	46.2
	F	6N(R)	3/8 " Female NPT(PT)		7.1	11.9	40.4
	F	8N(R)	1/2 " Female NPT(PT)		11.5	12.7	46.2
	F	8G	1/2 " Female PF		11.5	12.7	46.2
SFQC4-PG	S	12	3/4 " Superlok		26.0	15.7	54.6
	M	12N(R)	3/4 " Male NPT(PT)		23.6	18.3	51.6
	F	12N(R)	3/4 " Female NPT(PT)				52.8
SFQC5-PG	S	16	1 " Superlok		45.0		62.2
	M	16N(R)	1 " Male NPT(PT)		39.0	22.4	59.7
	F	16N(R)	1 " Female NPT(PT)				63.2

Ordering Number		End Connection		Min Orifice	A	D	F
Body Series	Part no.	Type					
SFQC2-BY	S	4	1/4 " Superlok		4.8	45.7	17.5
	S	6	3/8 " Superlok		7.1	46.0	
	M	4N(R)	1/4 " Male NPT		6.4	40.0	22.2
	M	6N(R)	3/8 " Male NPT(PT)		9.4	40.0	
	M	4G	1/4 " Male PF		6.1	45.7	19.1
	F	4N(R)	1/4 " Female NPT(PT)			38.1	22.2
	F	6N(R)	3/8 " Female NPT(PT)		9.7	41.4	19.1
	F	4G	1/4 " Female PF			38.1	
SFQC3-BY	S	6	3/8 " Superlok		7.1	55.1	27.0
	S	8	1/2 " Superlok		11.9	56.6	
	M	6N(R)	3/8 " Male NPT(PT)		10.4	46.5	33.0
	M	8N(R)	1/2 " Male NPT(PT)		12.7	52.8	
	M	8G	1/2 " Male PF		11.9	43.9	27.0
	F	6N(R)	3/8 " Female NPT(PT)		15.0		
	F	8N(R)	1/2 " Female NPT(PT)		16.0		
	F	8G	1/2 " Female PF				
SFQC4-BY	S	12	3/4 " Superlok		15.7	62.2	38.1
	M	12N(R)	3/4 " Male NPT(PT)		18.3	59.2	
	F	12N(R)	3/4 " Female NPT(PT)		22.4	48.0	
SFQC5-BY	S	16	1 " Superlok		22.4	70.0	44.5
	M	16N(R)	1 " Male NPT(PT)		22.4	67.3	
	F	16N(R)	1 " Female NPT(PT)		26.9	53.8	

Dimensions are for reference only and are subject to change.

# FULL FLOW QUICK - CONNECTS

## SFQC SERIES

### MATERIALS OF CONSTRUCTION

Component	Material	
	316 SS	Brass
Body	316 SS	Brass
Sleeve		
Locking ball		
Spring		
Sanp ring		
O - ring	Viton	NBR
Plug	316 SS	Brass

### PRESSURE-TEMPERATURE RATINGS

Temperature °F (°C)	316 SS with Viton O - ring				Brass with NBR O - ring			
	SFQC 2	SFQC 3	SFQC 4	SFQC 5	SFQC 2	SFQC 3	SFQC 4	SFQC 5
	Pressure Rating, coupled, psig (bar)							
70 (20)	6000 (413)		4000 (275)		4000 (275)	3000 (206)		2000 (137)
250 (121)					100 (6.8)			
400 (204)	100 (6.8)							

### INSERTION DEPTH

Series	Depth, in (mm)
SFQC2	0.78 (19.8)
SFQC3	0.81 (20.6)
SFQC4	0.90 (23.0)
SFQC5	0.94 (23.9)

### OPTION

#### BODY & PLUG PROTECTOR

Body & Plug Protectors guard against damage and contaminants when bodies and plug are uncoupled.

Series	Ordering Number	
	Body Protector	Plug Protector
SFQC 2	SFQC2 - BP	SFQC2 - PP
SFQC 3	SFQC3 - BP	SFQC3 - PP
SFQC 4	SFQC4 - BP	SFQC4 - PP
SFQC 5	SFQC5 - BP	SFQC5 - PP

### ORDERING INFORMATION

SQC4 - BY - M - 12N - SS

1 2 3 4

- 1 Body Series**
- SFQC2 - BY
  - SFQC3 - BY
  - SFQC4 - BY
  - SFQC5 - BY
- Plug Series**
- SFQC2 - PG
  - SFQC3 - PG
  - SFQC4 - PG
  - SFQC5 - PG

- 2 End Connection**
- S : SUPERLOK Tube Fitting
  - F : Female Thread
  - M : Male Thread

- 3 End Connection Size**
- Tube O.D Designation

Tube O.D (inch)	1/4	3/8	1/2	3/4	1
Designation	4	6	8	12	4
Tube O.D (mm)	6	10	12	20	25
Designation	6M	10M	12M	20M	25M

- Pipe Thread Designation

Size (inch)	1/4	3/8	1/2	3/4	1
Screwed BSPT	4R	6R	8R	12R	16R
Screwed NPT	4N	6N	8N	12N	16N
Screwed BSPP	4G	6G	8G	12G	16G

- 4 Body Material**
- SS : 316 Stainless Steel
  - B : Brass