



JABIRU ENGINE PARTS BOOK



3300 SERIES

HYDRAULIC LIFTER TYPE

**Applicable to Jabiru 3300 Models from S/N 33A961 onwards
(including 33A927, 33A928, 33A947, 33A948, 33A949, 33A950)**

Jabiru Aircraft Pty Ltd ACN 010 910 077

PO Box 5186 Bundaberg
Australia 4670

Australia: Phone 07 4155 1778 Fax 07 4155 2669
International: Phone + 61 7 4155 1778 Fax + 61 7 4155 2669
Email: info@jabiru.net.au
Web: www.jabiru.net.au

Revised November 2011



Please fill in your engine and aircraft details for future reference.

Engine Serial #:

Aircraft Type:

Model:

Serial #:

Registration #:

Note:

1. Not all parts are illustrated
2. All efforts are made to ensure accuracy at the time of publication, if you find any discrepancies, or have any questions about the contents of this publication please contact Jabiru Aircraft Pty Ltd.
3. All quantities are per engine unless stated otherwise.

4. When ordering parts always quote engine serial number and any upgrades carried out on the engine, as well as item number, part number, description, page number and issue number. This complete information will ensure Jabiru Aircraft Pty Ltd supply the correct part.



Engine Parts Catalogue Index

Figure 1 – Drawing 9479083 Crank & Crankcase Assy.....	5
Figure 2 – Drawing 4A635A0D Crank & Crankcase Assy 7/16 Studs	6
Figure 3 – Drawing 4A254A0D Cylinder Head Assy up to S/N 33A2215	7
Figure 4 – Drawing 4A507A0D Cylinder Head Assy Pushrod Oil Feed S/N 33A2216- ...	8
Figure 5 – Drawing 4A255A0D Head Valve Guides & Seats 3.3L up to S/N 33A2215....	9
Figure 6 – Drawing 4A506A0D Head Valve Guides & Seats 3.3L from S/N 33A2216 ..	10
Figure 7– Drawing 4A289A0D Valvetrain Assembly up to S/N 33A2215	11
Figure 8– Drawing 4A508A0D Valvetrain Assembly from S/N 33A2216	12
Figure 9 – Drawing 4A103A0D Barrel Piston & Conrod Assembly	13
Figure 10– Drawing 4A287A0D Timing & Distributor Assembly	14
Figure 11 – Drawing 4A163A0D Oil Relief Valve Filter & Adaptor.....	15
Figure 12 – Drawing 4626073 Flywheel Assembly up to S/N 1521	16
Figure 13 – Drawing 4A427A0D Flywheel Assembly from S/N 1522	17
Figure 14 – Drawing 4A426A0D Flywheel & Crankshaft Assembly from S/N 1522.....	18
Figure 15 – Drawing 4A292A0D Crank Flywheel & Alternator Assy up to S/N 1521	19
Figure 16 – Drawing 4A452A0D Flywheel & Alternator Assembly from S/N 1522.....	20
Figure 17 – Drawing 9491013 Induction System Assy	21
Figure 18 – Drawing 4A541A0D Induction Assy Ser III	22
Figure 19 – Drawing 4A293A0D Exhaust Assembly Tractor	23
Figure 20 – Drawing 9492013 Exhaust Assembly Pusher.....	24
Figure 21 – Drawing 4A159A0D Dipstick Assembly	25
Figure 22 – Drawing 4933023 Starter Motor Assembly	26
Figure 23 – Drawing 4A290A0D Sump Assembly & Rear Plate	27
Figure 24 – Drawing 4A291A0D Rocker Oil Lube Supply up to S/N 33A2215	28
Figure 25 – Drawing 4A170A0D Fuel Pump Assembly & Mounting	29
Figure 26 – Drawing 4886014 Carburetor Assembly	30
Figure 27 – Drawing 4A288A0D Oil Pump Assembly.....	31
Figure 28 – Prop Flange Assembly	32
Figure 29: Miscellaneous Electrical	33
Figure 30.- Drawing C009013 Propeller Installation (4 Laminate Prop).....	34

Note: Refer to Installation Manual for details of parts used in engine installation
Refer to Installation Manual for data & installation details on engine cooling ducts



Figure 1: CRANKSHAFT CRANKCASE AND CAMSHAFT

ITEM	PART #	ISS	DESCRIPTION	QTY	
1	4643084		GEAR CRANKSHAFT	1	
2	4292044		STUD SHORT	4	
3	MS21042-6		NUT CRANKCASE STUD	18	
4	4291044		STUD LONG	10	
5	PB0080N		BEARING SET MAIN	1	
6	4629072	9	CRANKSHAFT	1	
	PH9912N		WELSH PLUG 28 DIA	1	
	PH0646N		WELSH PLUG 7/8 DIA	2	
	PH0636N		GRUB SCREW 1/4 X 1/4 UNF	1	
7	4A146A0D		CRANKCASE R.S. 3300 HYDRAULIC LIFTERS up to S/N 33A2215	1	NSS
	4A145A0D		CRANKCASE L.S. 3300 HYDRAULIC LIFTERS up to S/N 33A2215	1	NSS
	4A510A0D		CRANKCASE RS 3300 HYD LIFTER PUSHROD OIL FEED from S/N 33A2216	1	NSS
	4A509A0D		CRANKCASE LS 3300 HYD LIFTER PUSHROD OIL FEED from S/N 33A2216	1	NSS
	PH9852N		PLUG 1/8 NPT	1	
8	4347054		DOWEL CRANKCASE	14	
9	4293044		STUD FRONT	2	
10	PB9942N		THRUST BEARING	2	
11	PH0676N		CAP SCREW 3/4 X 3/8 UNF	6	
12	PH0279N		WASHER	6	
13	4525064		FLANGE PROP MOUNT STANDARD	1	
	466218N		FLANGE PROP MOUNT 2" EXTENSION	1	
	466228N		FLANGE PROP MOUNT 3" EXTENSION	1	
14	4689084		GUIDE PROP BOLT	6	
15	4625072		CAM SHAFT up to S/N 1683	1	
	4A431A0D		CAM SHAFT from S/N 1684 (with identification groove)	1	
16	4956024		HOUSING FRONT OIL SEAL	1	
17	PH0555N		CAP SCREW 3/4 X 5/16 UNC	4	
18	PG9872N		OIL SEAL	1	
19	PG0035N		'O'RING BS112V	10	
20	4081223		PLATE PROP MOUNT	1	

Crankcase halves are not sold separately.

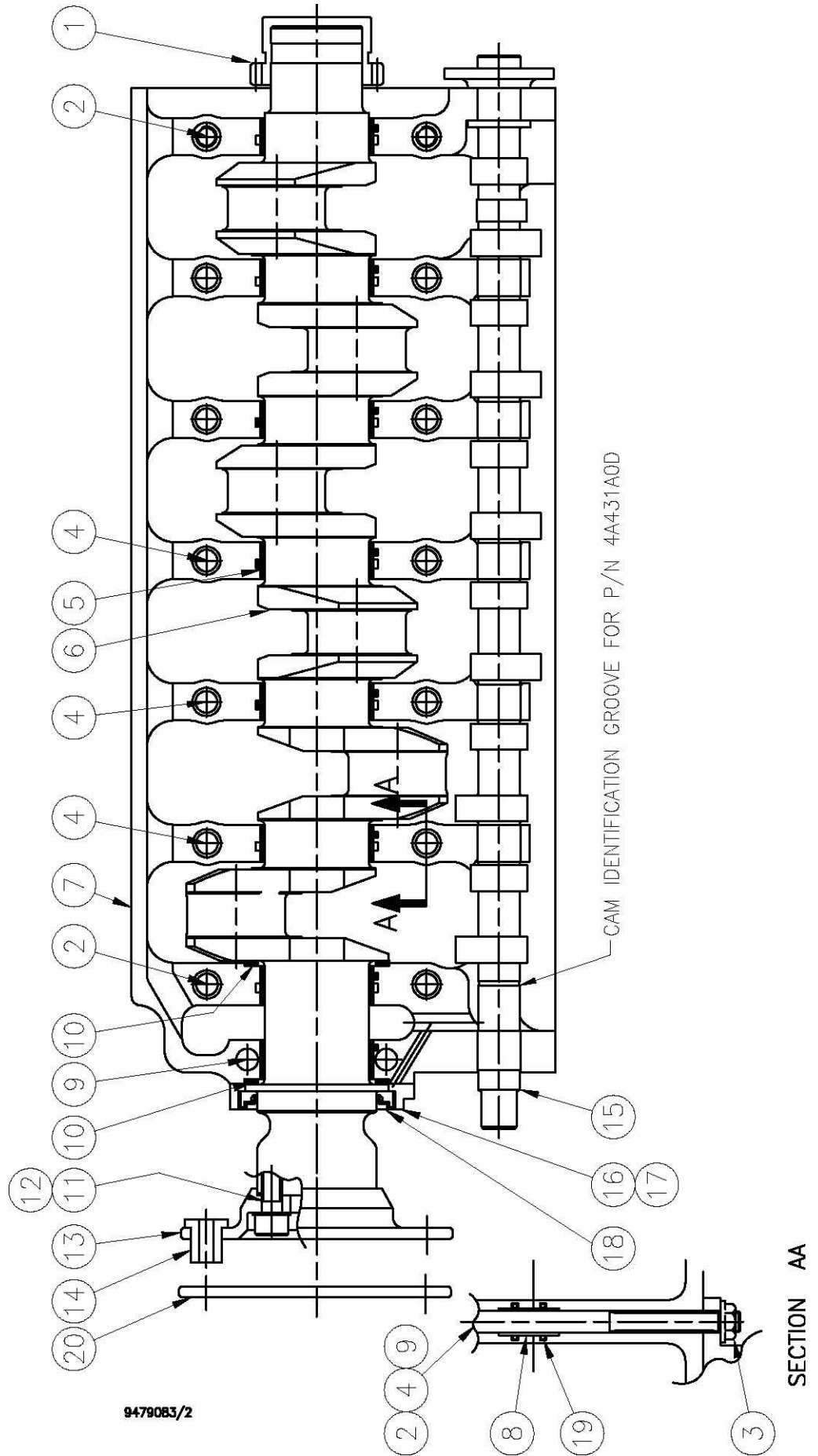

Figure 1 – Drawing 9479083 Crank & Crankcase Assy

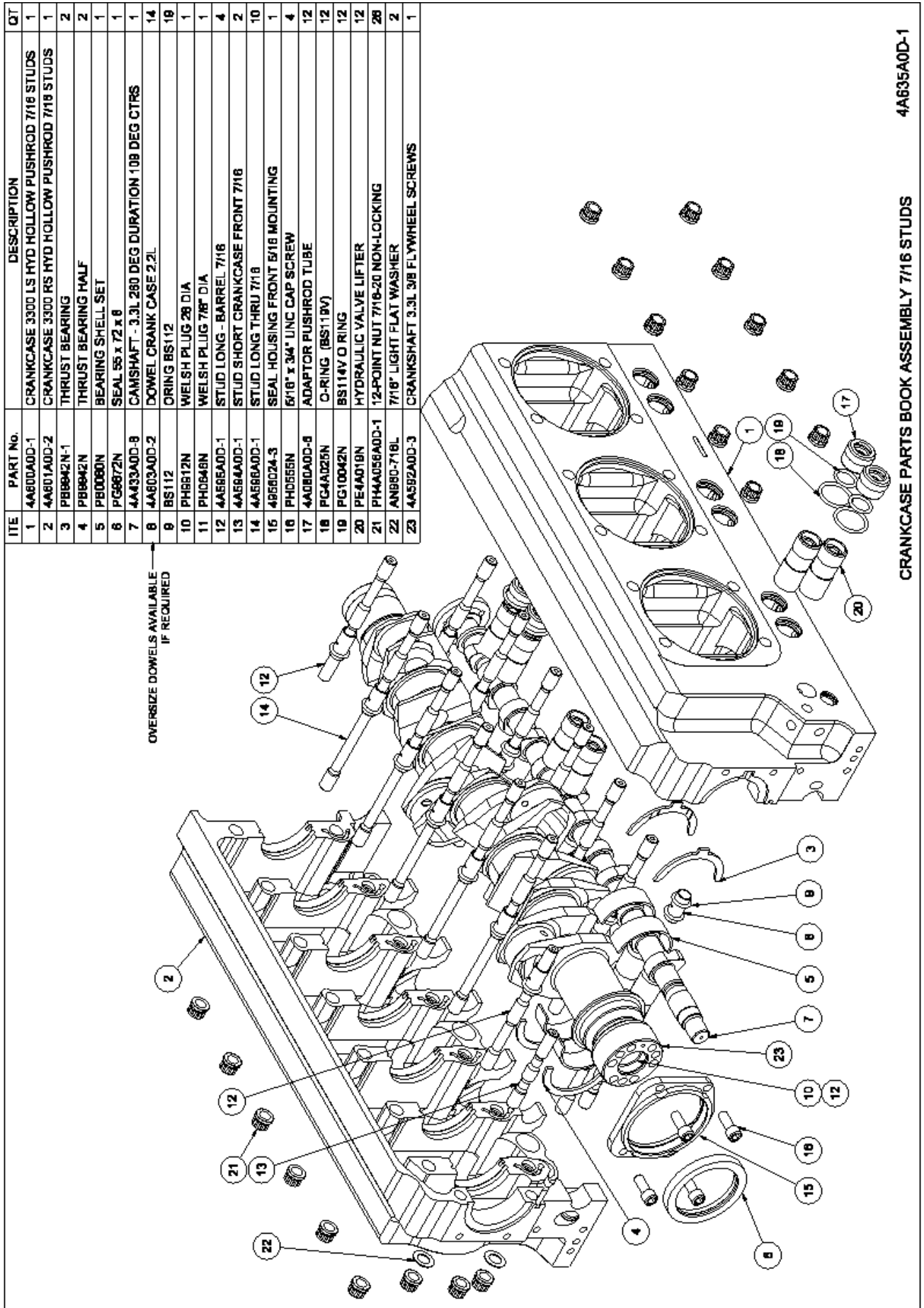
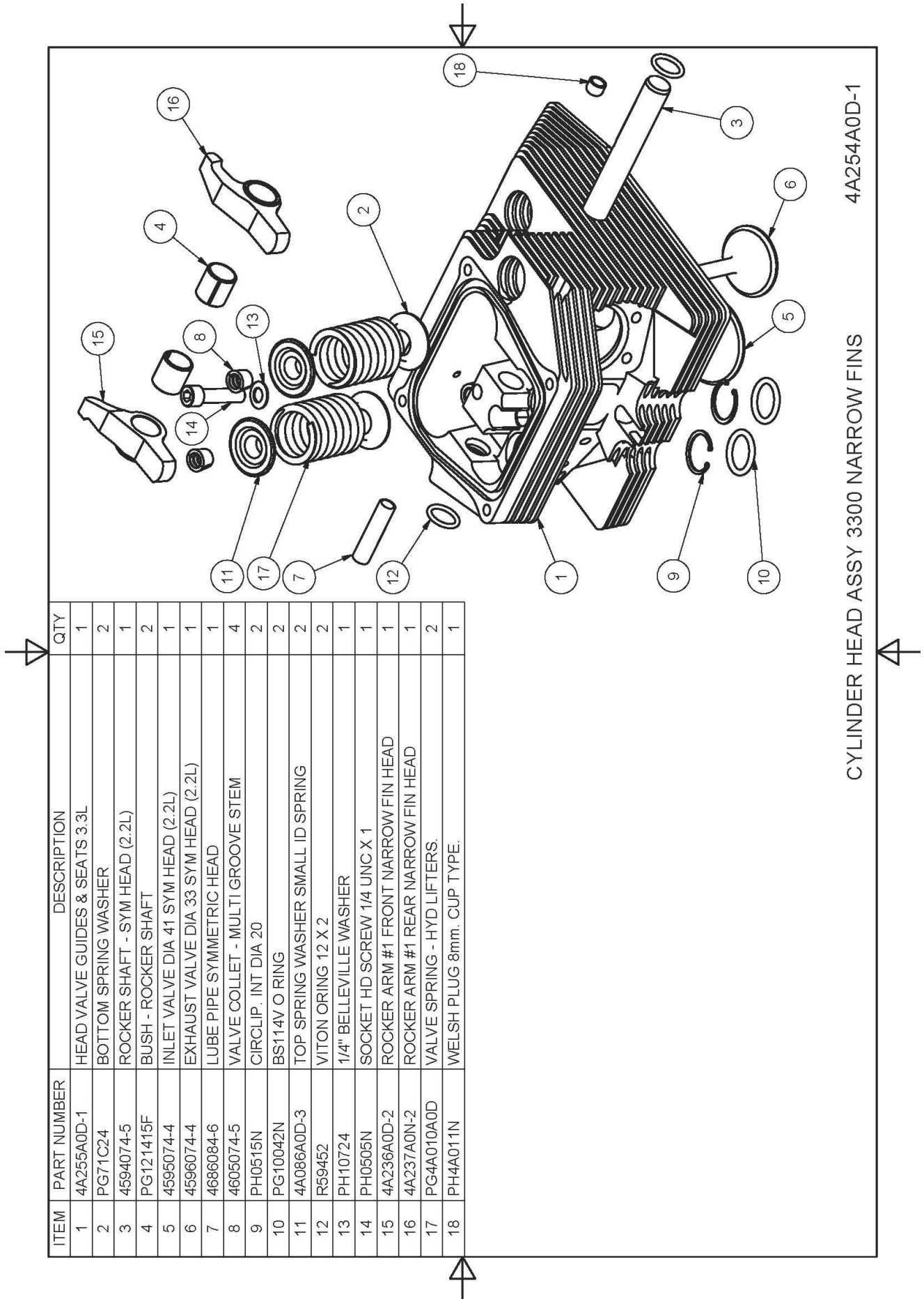

Figure 2 – Drawing 4A635A0D Crank & Crankcase Assy 7/16 Studs



ITEM	PART NUMBER	DESCRIPTION	QTY
1	4A255A0D-1	HEAD VALVE GUIDES & SEATS 3.3L	1
2	PG71C24	BOTTOM SPRING WASHER	2
3	4594074-5	ROCKER SHAFT - SYM HEAD (2.2L)	1
4	PG121415F	BUSH - ROCKER SHAFT	2
5	4595074-4	INLET VALVE DIA 41 SYM HEAD (2.2L)	1
6	4596074-4	EXHAUST VALVE DIA 33 SYM HEAD (2.2L)	1
7	4686084-6	LUBE PIPE SYMMETRIC HEAD	1
8	4605074-5	VALVE COLLET - MULTI GROOVE STEM	4
9	PH0515N	CIRCLIP. INT DIA 20	2
10	PG10042N	BS114V O RING	2
11	4A086A0D-3	TOP SPRING WASHER SMALL ID SPRING	2
12	R59452	VITON ORING 12 X 2	2
13	PH10724	1/4" BELLEVILLE WASHER	1
14	PH0505N	SOCKET HD SCREW 1/4 UNC X 1	1
15	4A236A0D-2	ROCKER ARM #1 FRONT NARROW FIN HEAD	1
16	4A237A0N-2	ROCKER ARM #1 REAR NARROW FIN HEAD	1
17	PG4A010A0D	VALVE SPRING - HYD LIFTERS.	2
18	PH4A011N	WELSH PLUG 8mm. CUP TYPE.	1

CYLINDER HEAD ASSY 3300 NARROW FINS 4A254A0D-1

Figure 3 – Drawing 4A254A0D Cylinder Head Assy up to S/N 33A2215

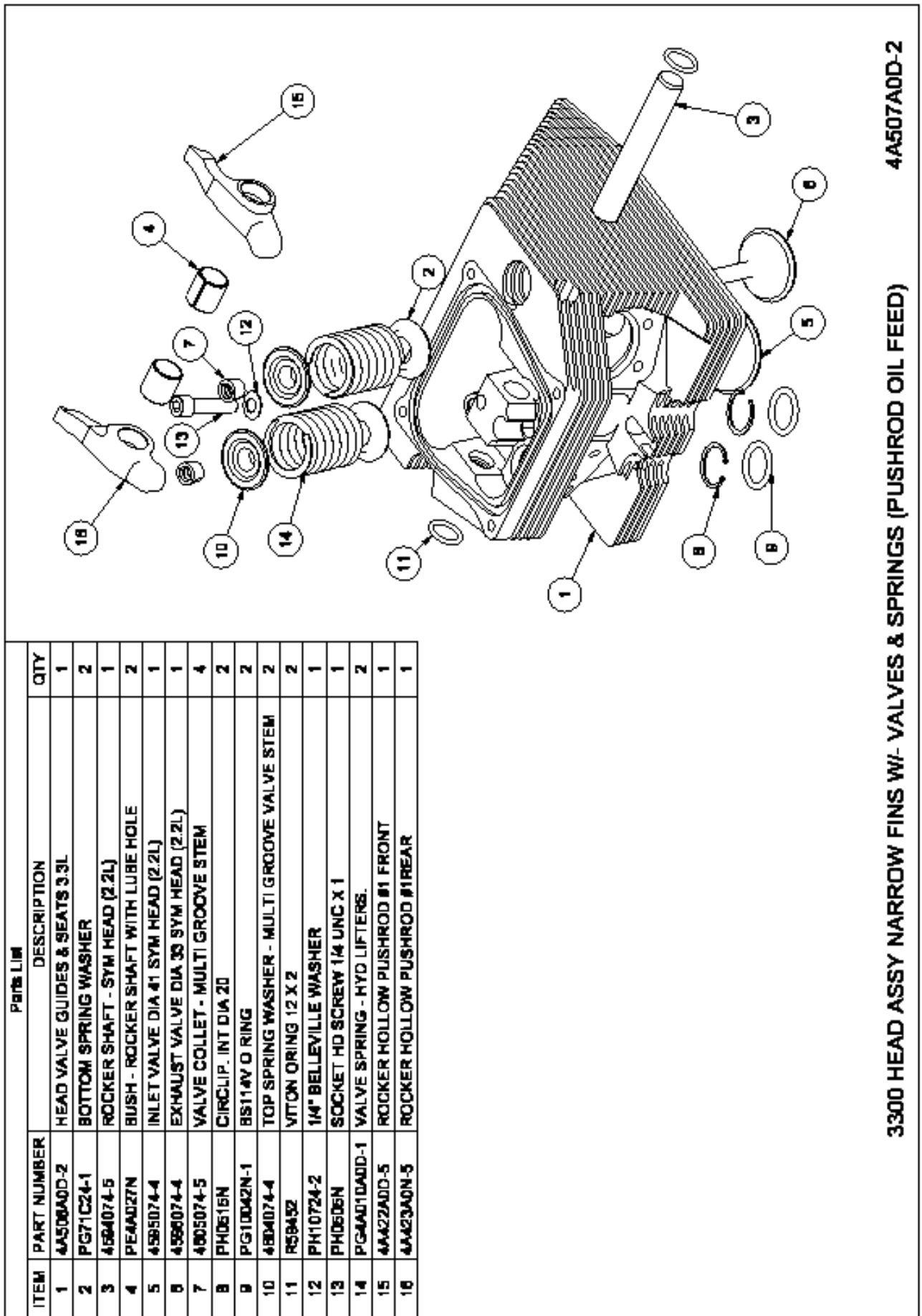

4A507A0D-2

3300 HEAD ASSY NARROW FINS W/ VALVES & SPRINGS (PUSHROD OIL FEED)

Figure 4 – Drawing 4A507A0D Cylinder Head Assy Pushrod Oil Feed S/N 33A2216-

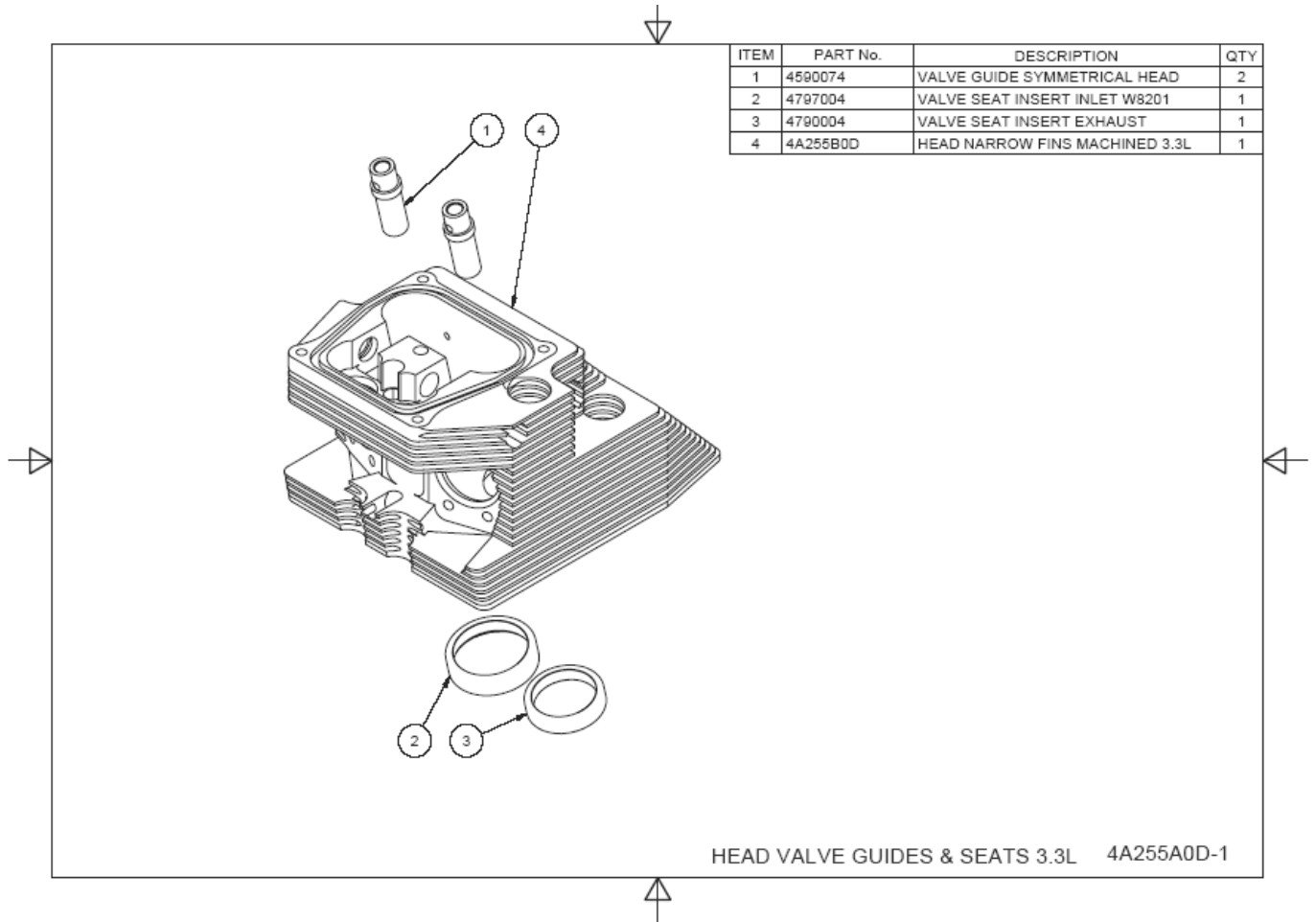

Figure 5 – Drawing 4A255A0D Head Valve Guides & Seats 3.3L up to S/N 33A2215

Note:

Oversize valve guides available, use std P/N & specify 0.05, 0.10, 0.15 Oversize. Identification is by 1, 2 or 3 dimples on exposed diameter when Fitted to assembled head

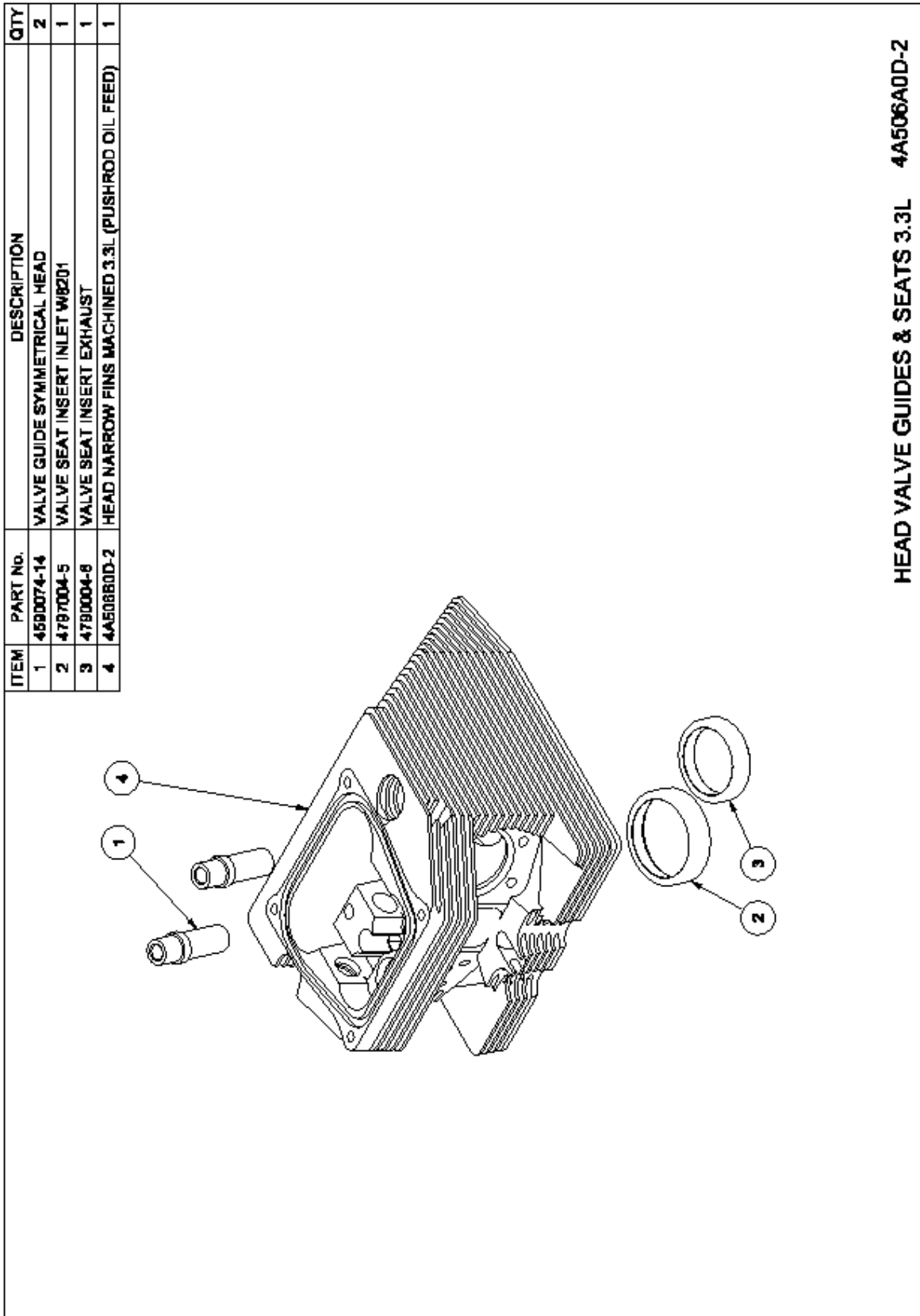

Figure 6 – Drawing 4A506A0D Head Valve Guides & Seats 3.3L from S/N 33A2216

Note: Oversize valve guides available, use std P/N & specify 0.05, 0.10, 0.15 Oversize. Identification is by 1, 2 or 3 dimples on exposed diameter when Fitted to assembled head

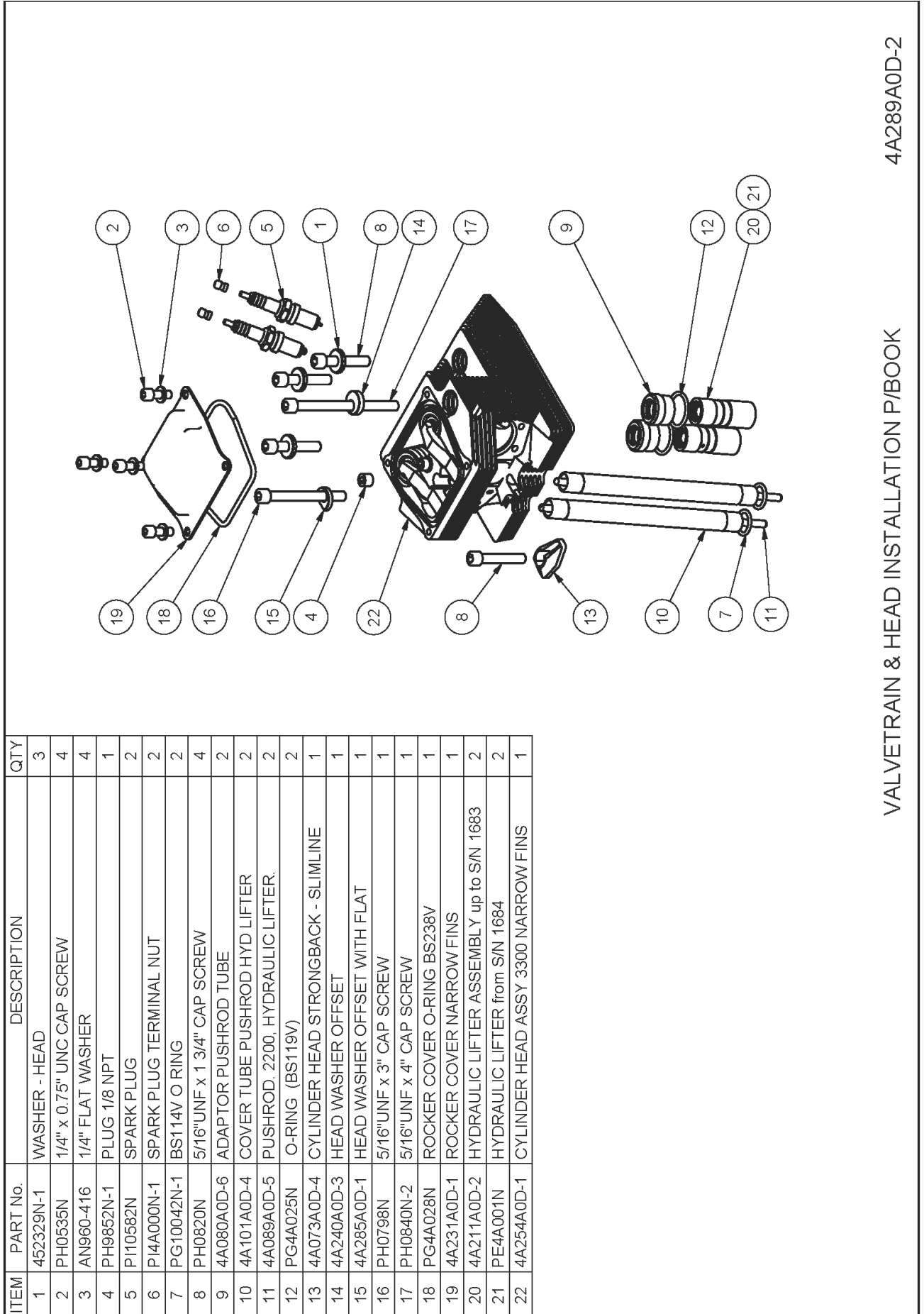

Figure 7- Drawing 4A289A0D Valvetrain Assembly up to S/N 33A2215

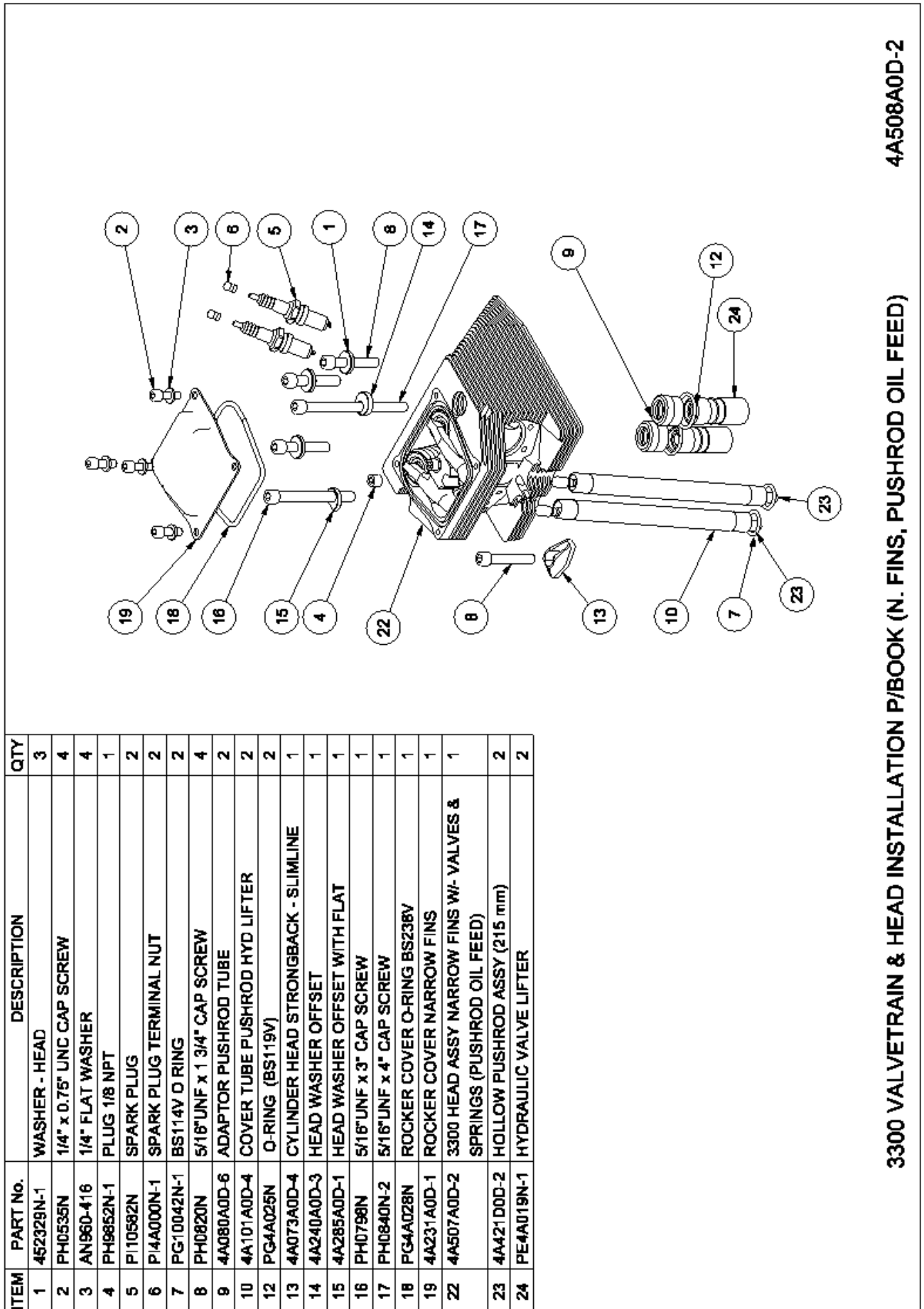

Figure 8– Drawing 4A508A0D Valvetrain Assembly from S/N 33A2216

4A508A0D-2

3300 VALVETRAIN & HEAD INSTALLATION P/BOOK (N. FINS, PUSHROD OIL FEED)

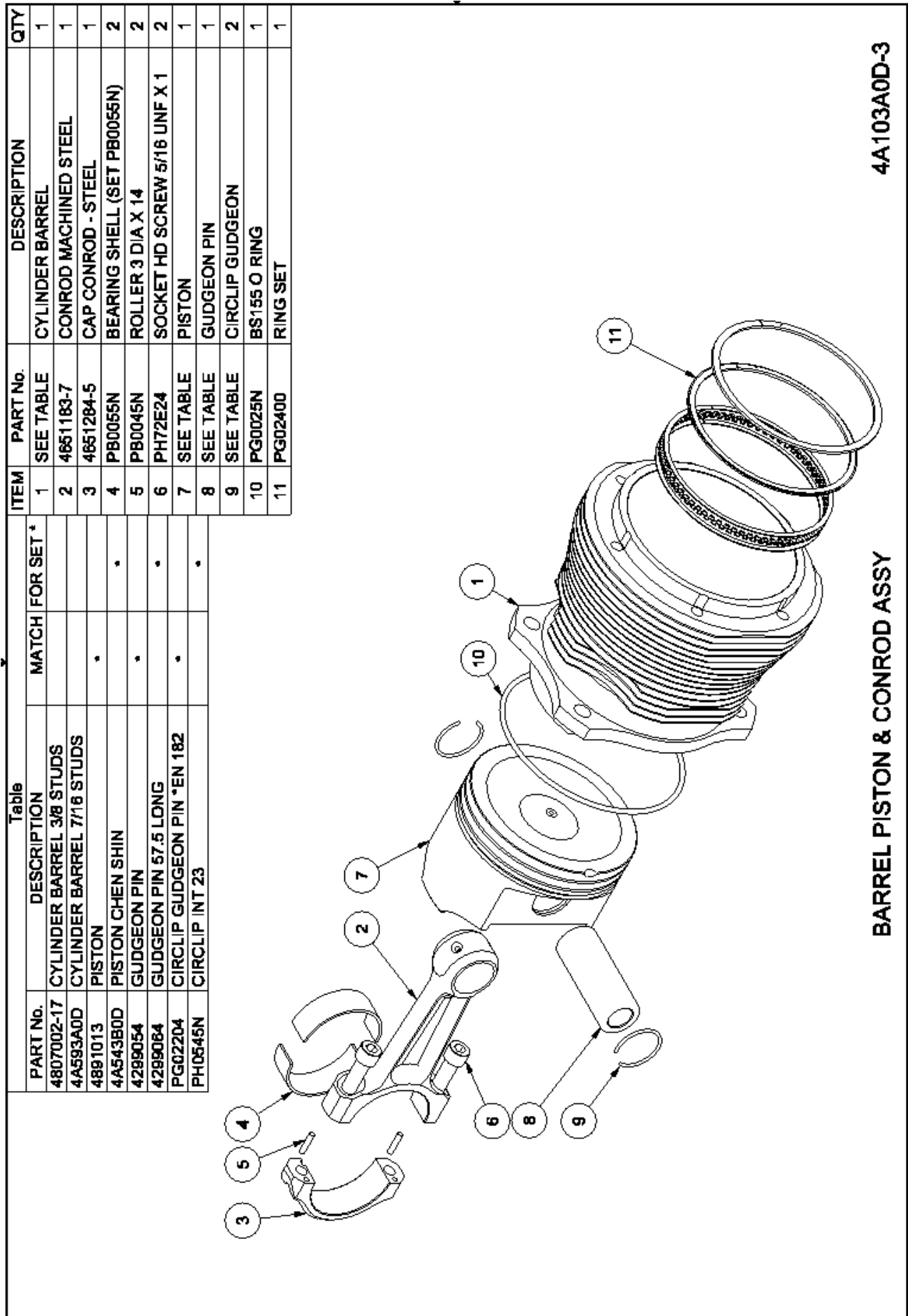

Figure 9 – Drawing 4A103A0D Barrel Piston & Conrod Assembly

ITEM	PART No.	DESCRIPTION	QTY	Part No.	Description	From S/No.	Up To S/No.
1	4631073	GEAR HOUSING REAR	1	PG10612N	SEAL 50 x 65 x 8	2200A-	2200A- 3442
2	SEE TABLE	SEAL 50 OR 62 DIAMETER	1			3300A-	3300A- 2309
3	4066123	GEAR CAMSHAFT INNER	1	PG4A037N	SEAL - CRANKSHAFT REAR 52 I/D x 65 O/D x 8 WIDE VITON	2200A-	2200A-
4	4538064	SPACER CAM TIMING GEARS	1			3300A-	3300A-
5	4333054	DISTRIBUTOR DRIVE GEAR 2.2L	1				
6	AN4H5	BOLT AN4H5	4				
7	4632074	SPACER DISTRIBUTOR MOUNTING 2.2L	2				
8	4332054	DISTRIBUTOR DRIVE SHAFT ASSY 2.2L	2				
9	PH0535N	SOCKET HD SCREW 1/4 UNC X 3/4	3				
10	PH0595N	SOCKET HD SCREW 1/4 UNC X 1 1/2	4				
11	PH72B24	SOCKET HD SCREW 10-32 X 1 1/4	4				
12	PH0605N	SOCKET HD SCREW 1/4 UNC X 1 3/4	10				
13	PH10632N	ROTOR BUTTON	2				
14	PG10622N	SEAL DISTRIBUTOR SHAFT 15 X 24 X 7	2				
15	PH10724	1/4" BELLEVILLE WASHER	17				
16	PH4A003N	3/16" BELLEVILLE WASHER	4				
17	4656084	DISTRIBUTOR CAP MOUNT PLATE 3.3L	2				
18	PG0180N	CAP DISTRIBUTOR GB74 (3300)	2				
19	4881014	CLAMP DISTRIBUTOR CAP (3.3L)	4				

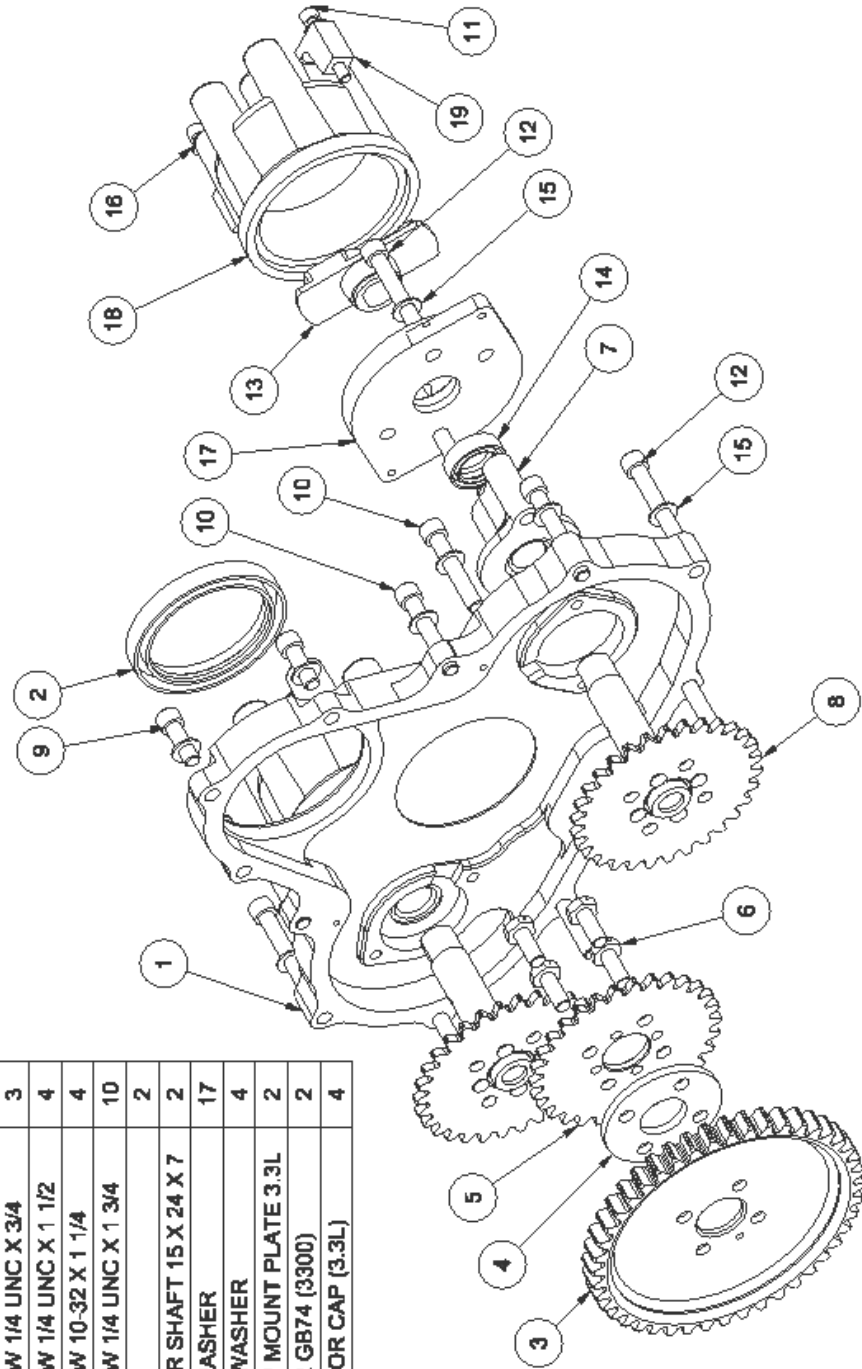
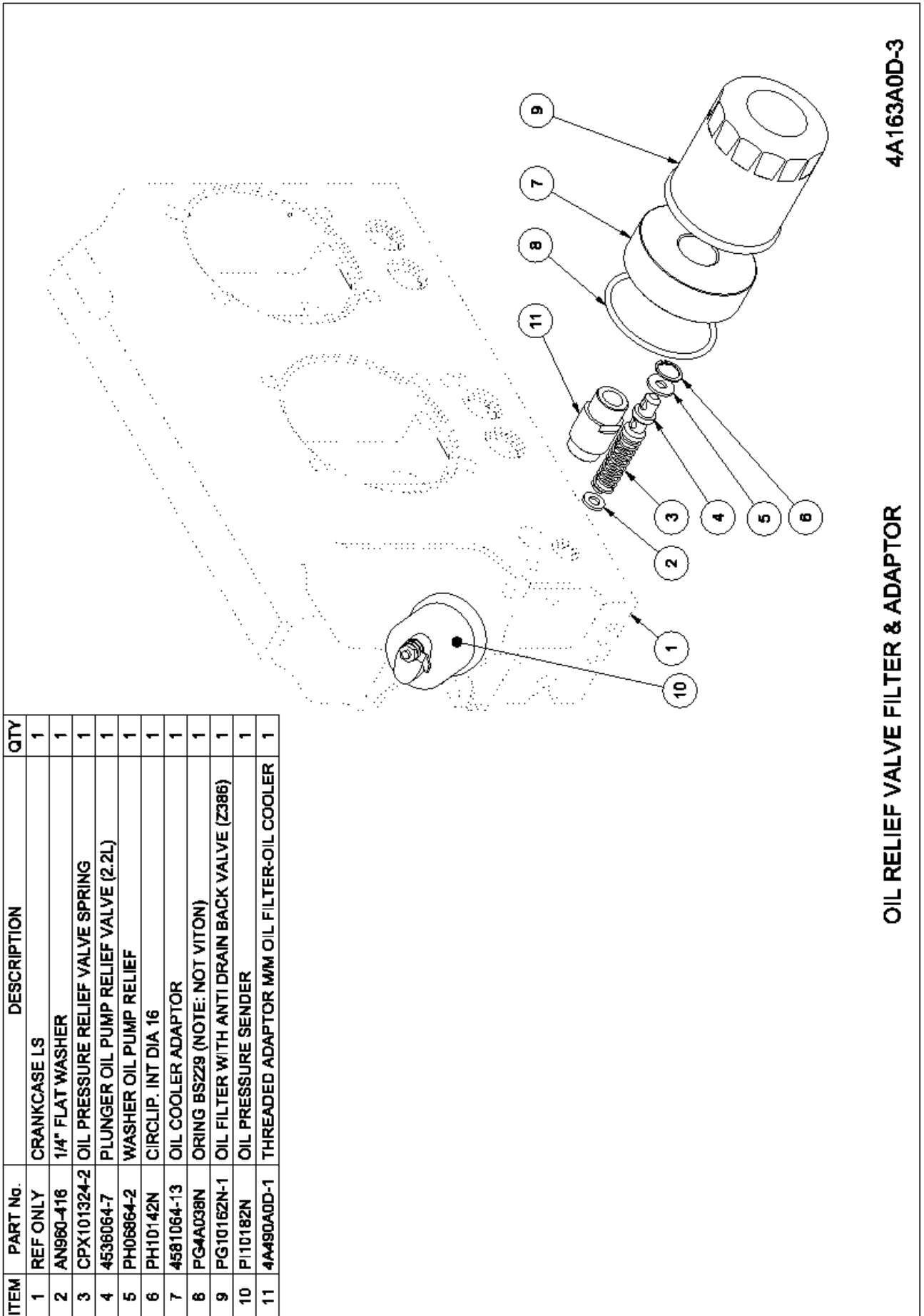

Figure 10– Drawing 4A287A0D Timing & Distributor Assembly

4A287A0D-3

TIMING & DISTRIBUTOR ASSY - 6 CYL P/BOOK



4A163A0D-3

OIL RELIEF VALVE FILTER & ADAPTOR

Figure 11 – Drawing 4A163A0D Oil Relief Valve Filter & Adaptor

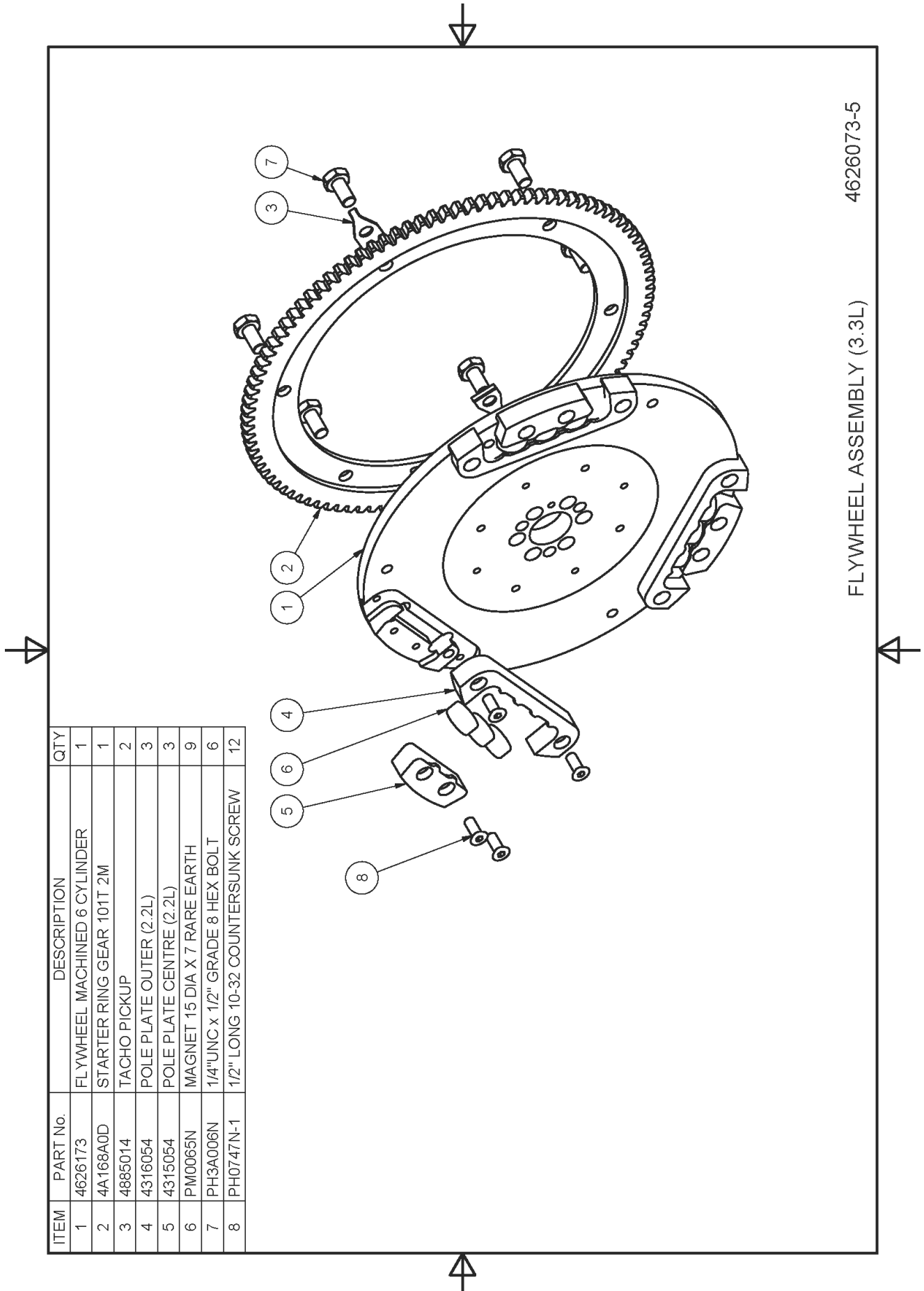

ITEM	PART No.	DESCRIPTION	QTY
1	4626173	FLYWHEEL MACHINED 6 CYLINDER	1
2	4A168A0D	STARTER RING GEAR 101T 2M	1
3	4885014	TACHO PICKUP	2
4	4316054	POLE PLATE OUTER (2.2L)	3
5	4315054	POLE PLATE CENTRE (2.2L)	3
6	PM0065N	MAGNET 15 DIA X 7 RARE EARTH	9
7	PH3A006N	1/4"UNC x 1/2" GRADE 8 HEX BOLT	6
8	PH0747N-1	1/2" LONG 10-32 COUNTERSUNK SCREW	12

FLYWHEEL ASSEMBLY (3.3L) 4626073-5

Figure 12 – Drawing 4626073 Flywheel Assembly up to S/N 1521

ITEM	PART No.	DESCRIPTION	QTY
1	4A427B0D-3	FLYWHEEL MACHINED - STEEL ADAPTOR	1
2	4A168A0D-2	STARTER RING GEAR 101T 2M	1
3	4885014-5	TACHO PICKUP	2
4	4316054-6	POLE PLATE OUTER (2.2L)	3
5	4315054-8	POLE PLATE CENTRE (2.2L)	3
6	PM0065N	MAGNET 15 DIA X 7 RARE EARTH	9
7	PH3A006N	1/4"UNC x 1/2" GRADE 8 HEX BOLT	6
8	PH0747N-1	1/2" LONG 10-32 COUNTERSUNK SCREW	12

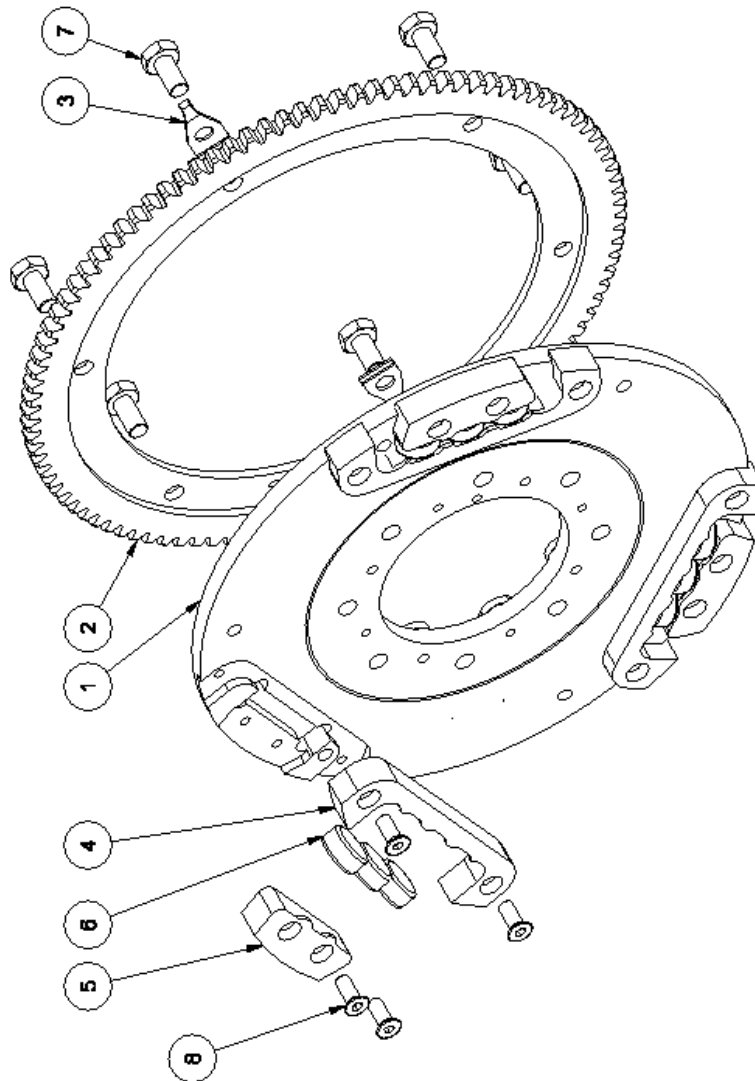
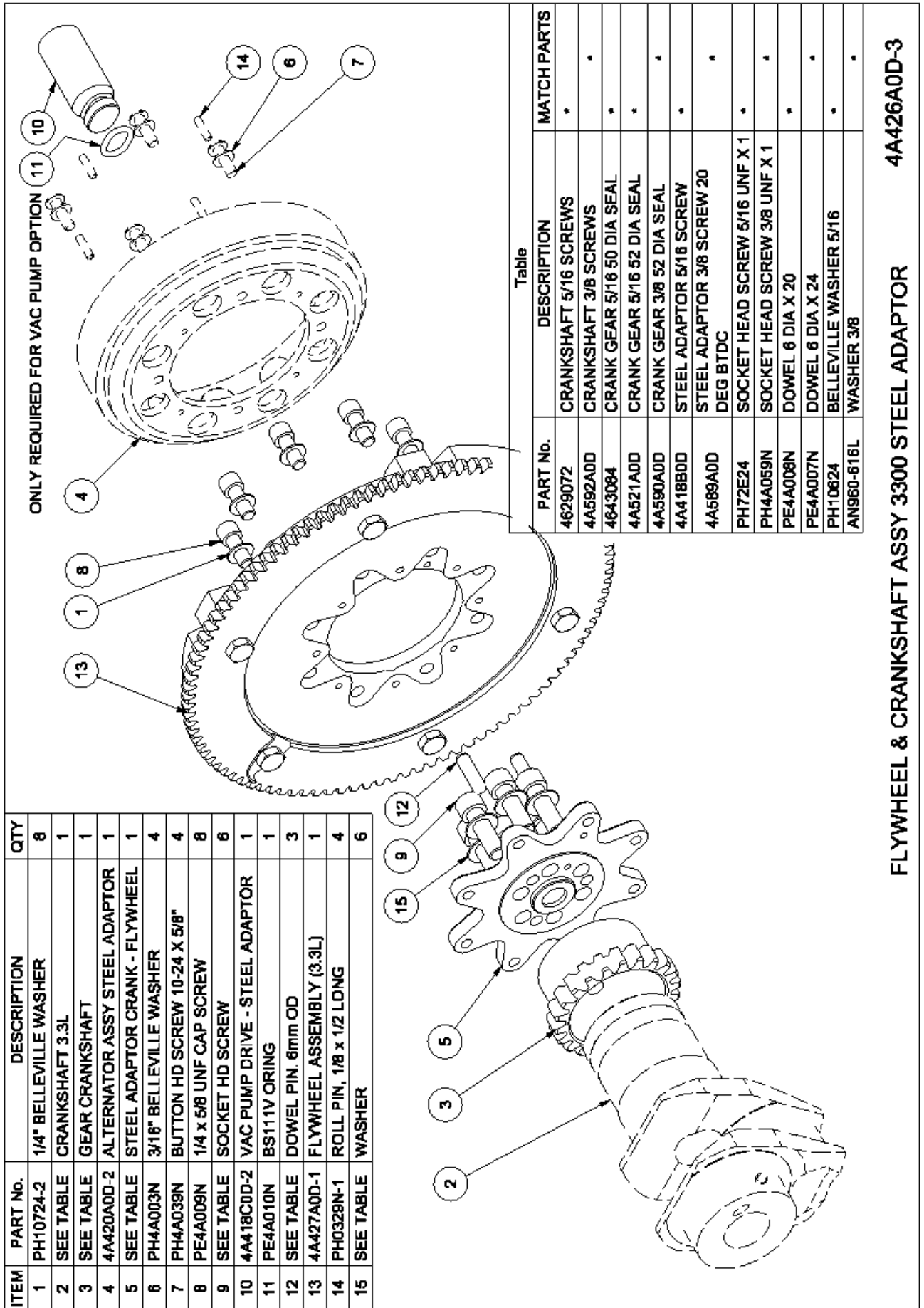

Figure 13 – Drawing 4A427A0D Flywheel Assembly from S/N 1522



FLYWHEEL & CRANKSHAFT ASSY 3300 STEEL ADAPTOR 4A426A0D-3

Figure 14 – Drawing 4A426A0D Flywheel & Crankshaft Assembly from S/N 1522

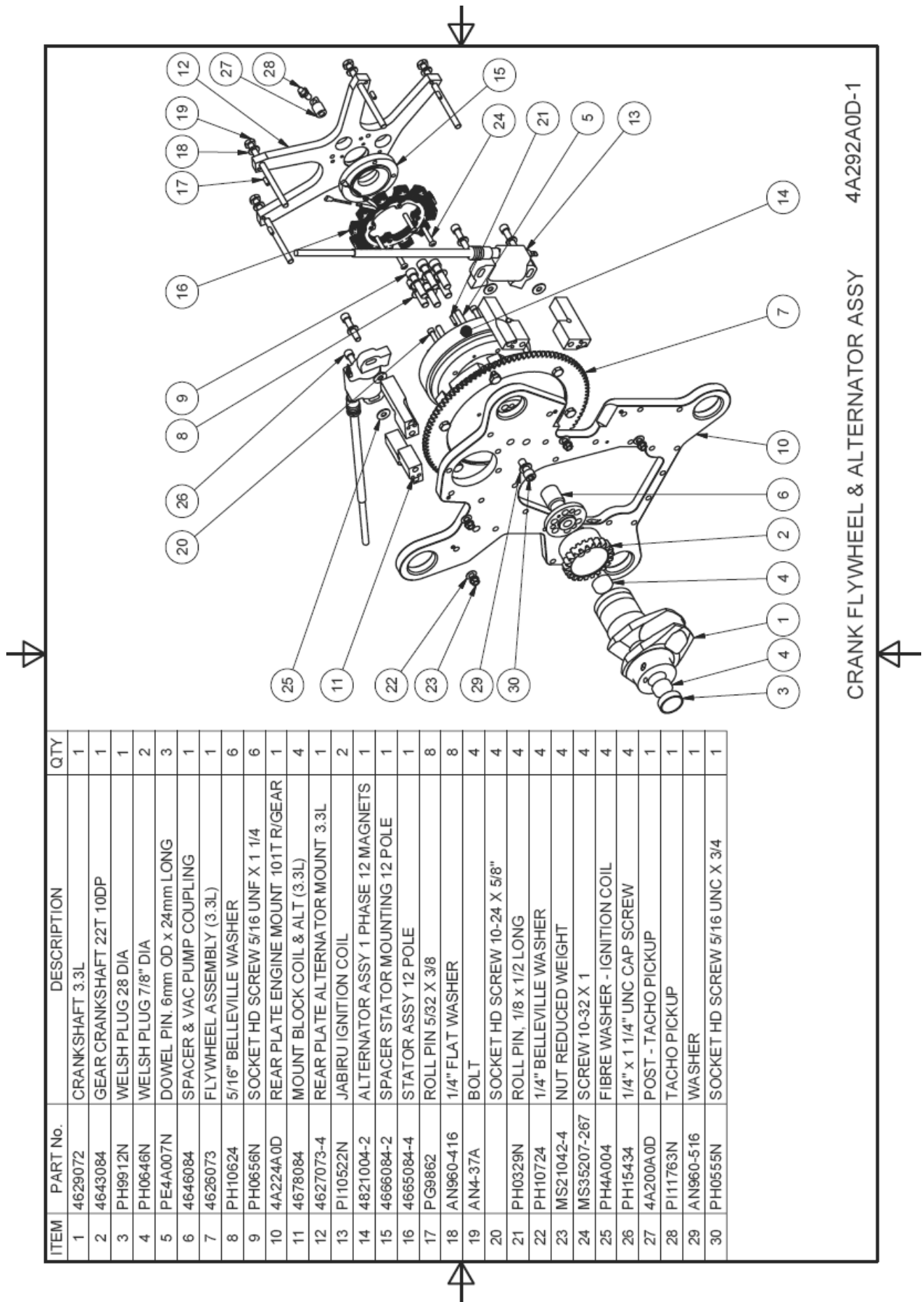
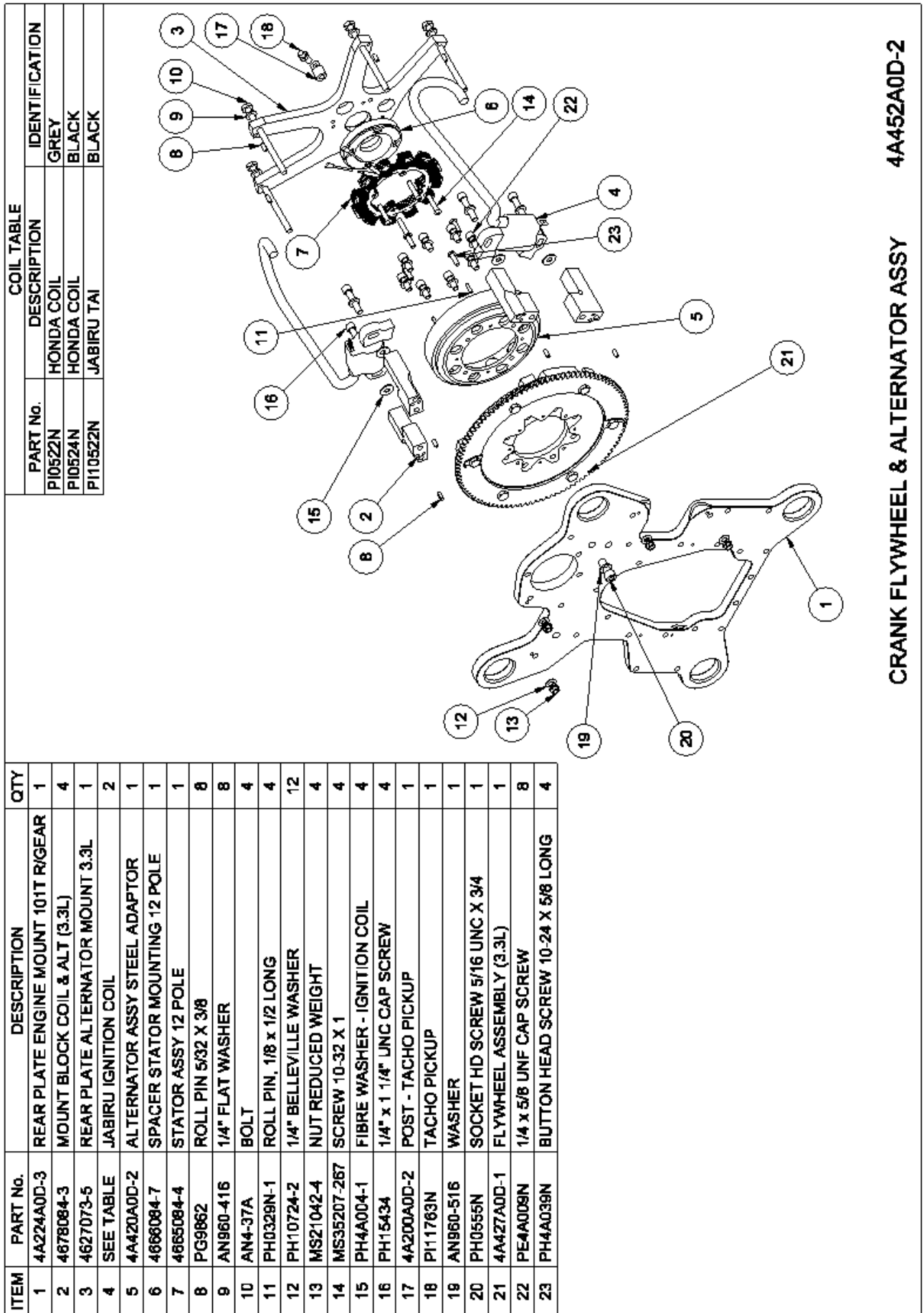

Figure 15 – Drawing 4A292A0D Crank Flywheel & Alternator Assy up to S/N 1521



CRANK FLYWHEEL & ALTERNATOR ASSY 4A452A0D-2

Figure 16 – Drawing 4A452A0D Flywheel & Alternator Assembly from S/N 1522

ITEM	PART #	ISS	DESCRIPTION	QTY
1	4A191A0D	3	GASKET 2 HOLE	6
	PH0535N		CAP SCREW 3/4 X 1/4UNC	12
2	SET 17	1	INDUCTION PIPE SET	1
3	PV102924	1	HOSE INDUCTION	6
4	PG102924		CLAMP	12
5	PG10212N		O'RING BS124V	6
6	PH4A002		CAP SCREW 21/4 X 1/4 UNC	5
7	4690084	3	HEAT SHIELD	1
8	4774094	1	ADAPTOR SUMP - CARBY	1
9	4691084	1	COUPLING RUBBER	1
			HOSE CLAMP 40-64	2
10	PG4A004N	1	CARBY ASSY 40 DIA \$4886014	1
11	4773093	6	INDUCTION BODY HALF	2
12	4773194	2	DIFFUSER	1

Note Induction pipes not sold separately order as P/N SET 17

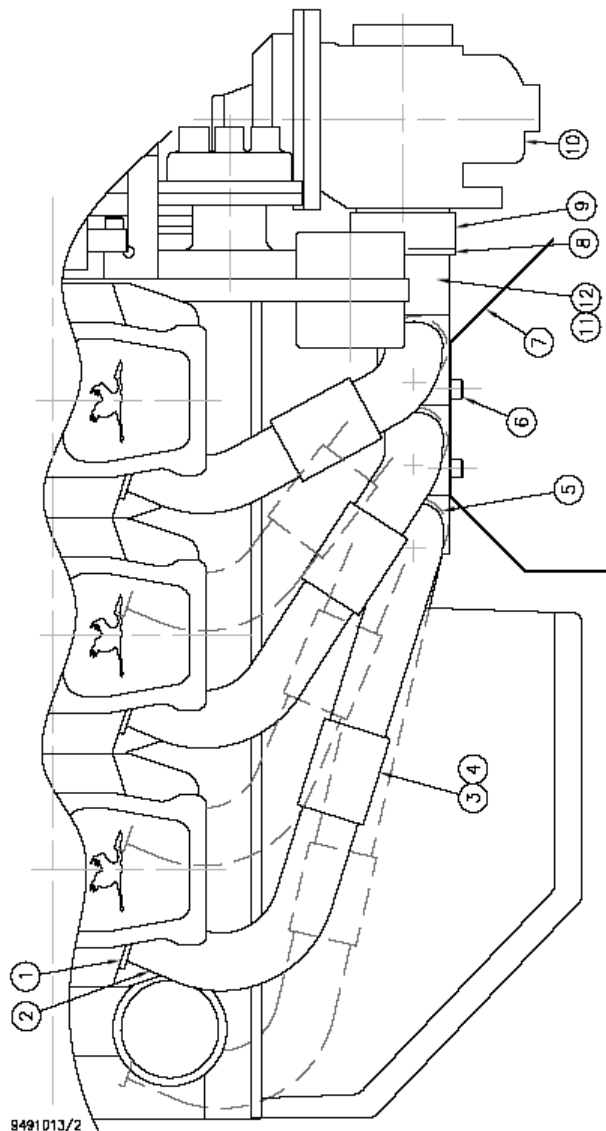
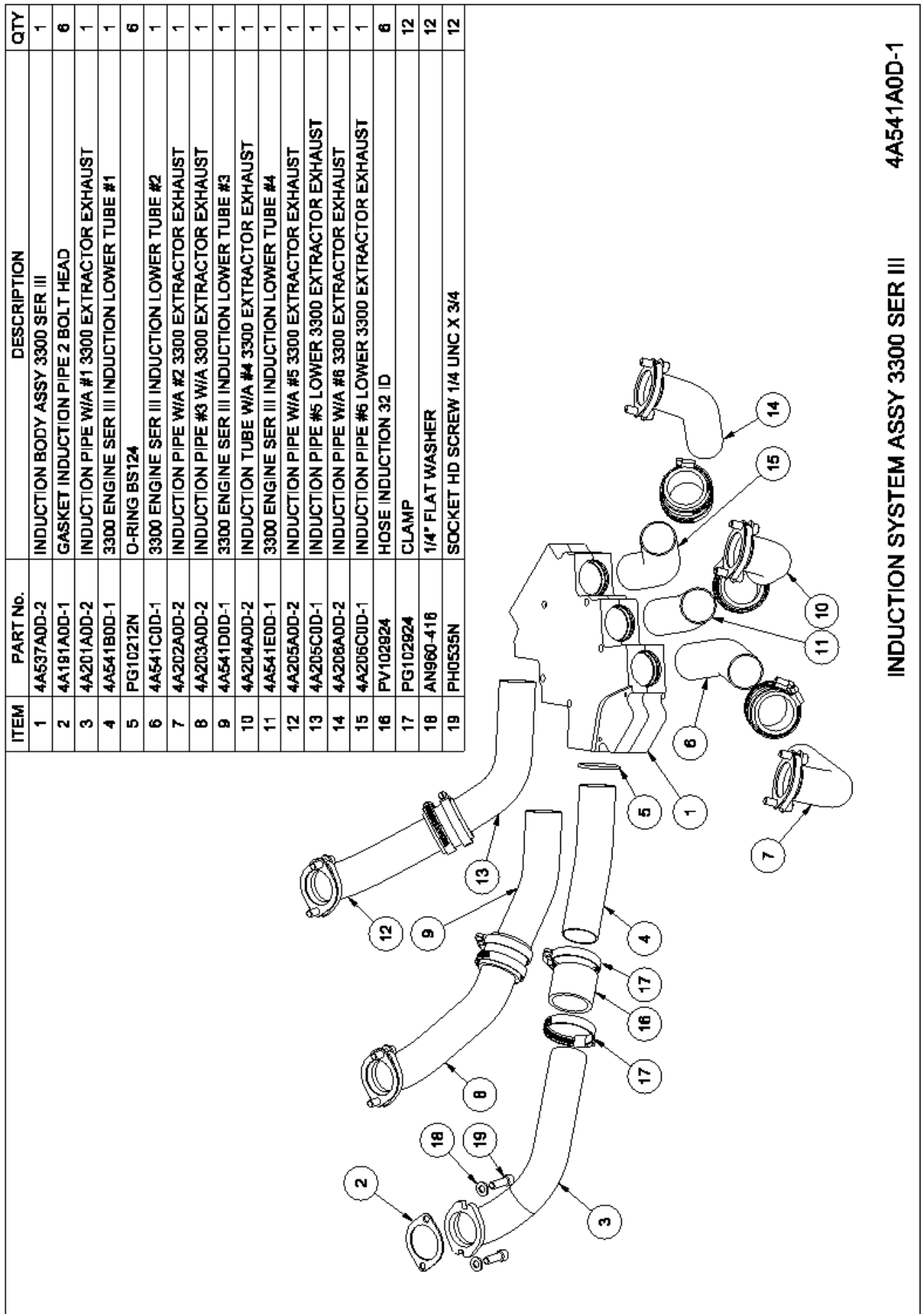

Figure 17 – Drawing 9491013 Induction System Assy



INDUCTION SYSTEM ASSY 3300 SER III 4A541A0D-1

Figure 18 – Drawing 4A541A0D Induction Assy Ser III

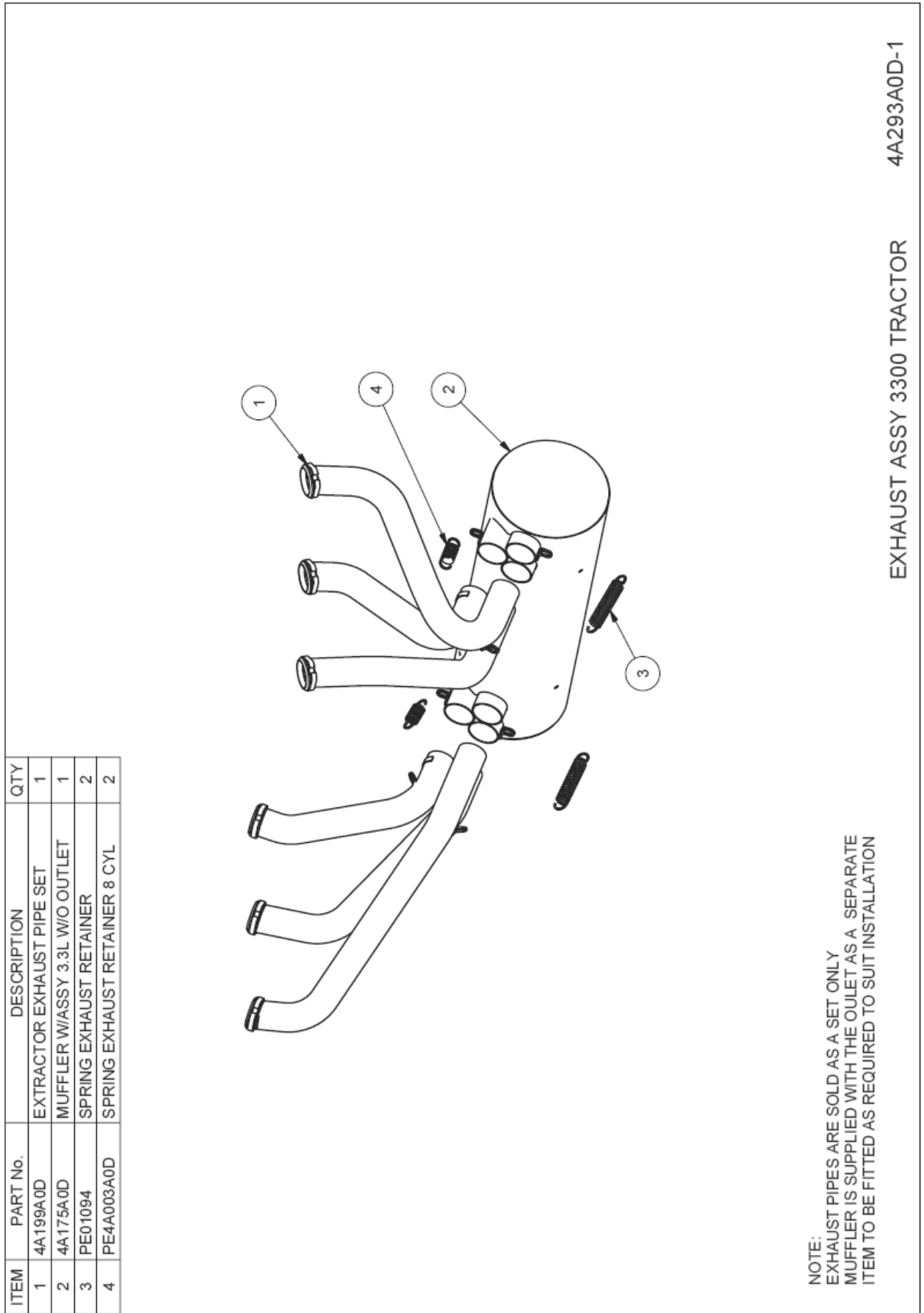

Figure 19 – Drawing 4A293A0D Exhaust Assembly Tractor

ITEM	PART #	ISS	DESCRIPTION	QTY
1 & 2	4A114A0D	1	EXHAUST MANIFOLD SET 2 BOLT FLANGES	1
	PH0535N		CAP SCREW 3/4 X 1/4 UNC	12
3	PE01094	1	SPRING	4
4	4746093	1	MUFFLER ASSY (outlet pipes not welded in)	1

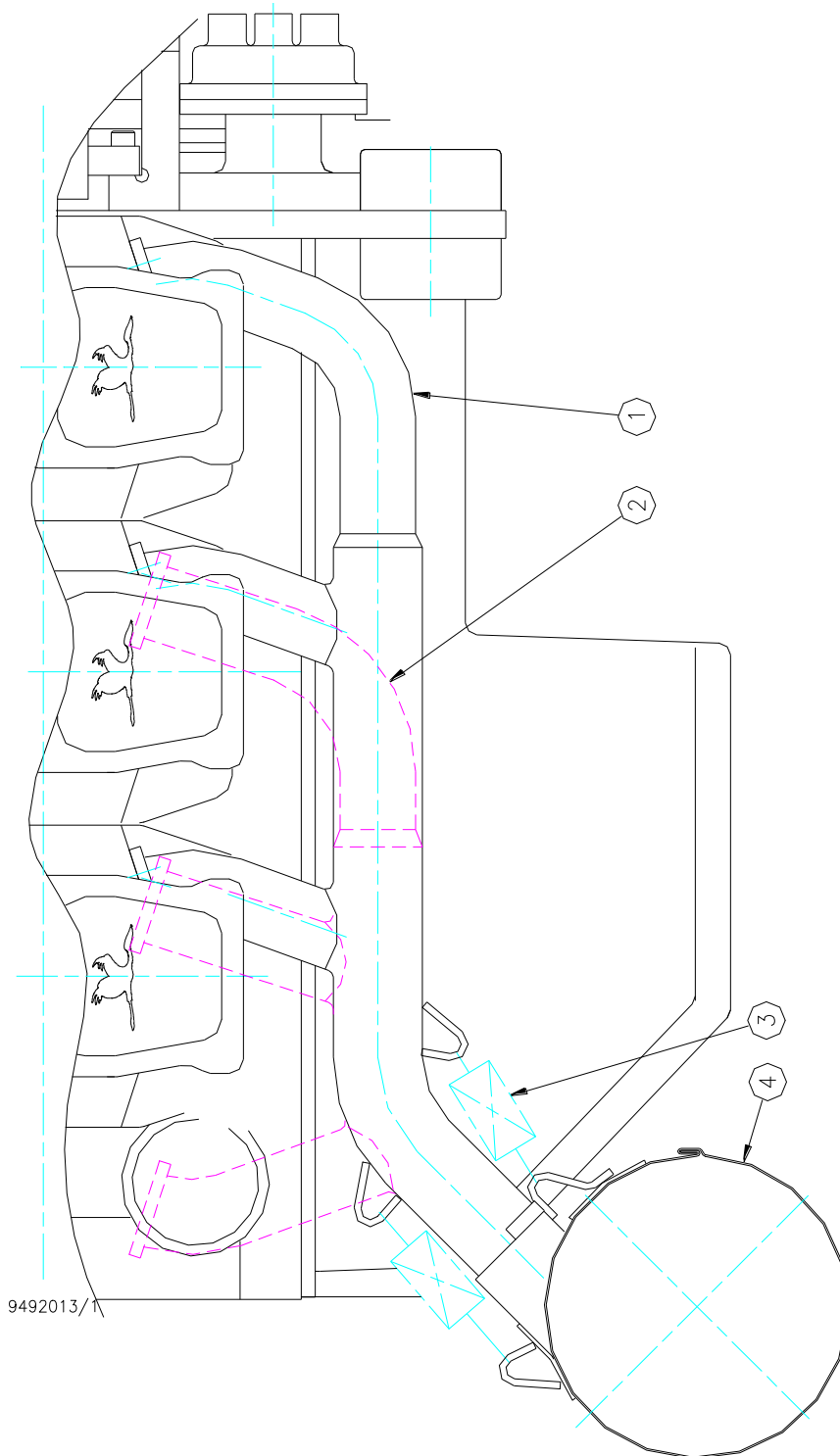

Figure 20 – Drawing 9492013 Exhaust Assembly Pusher

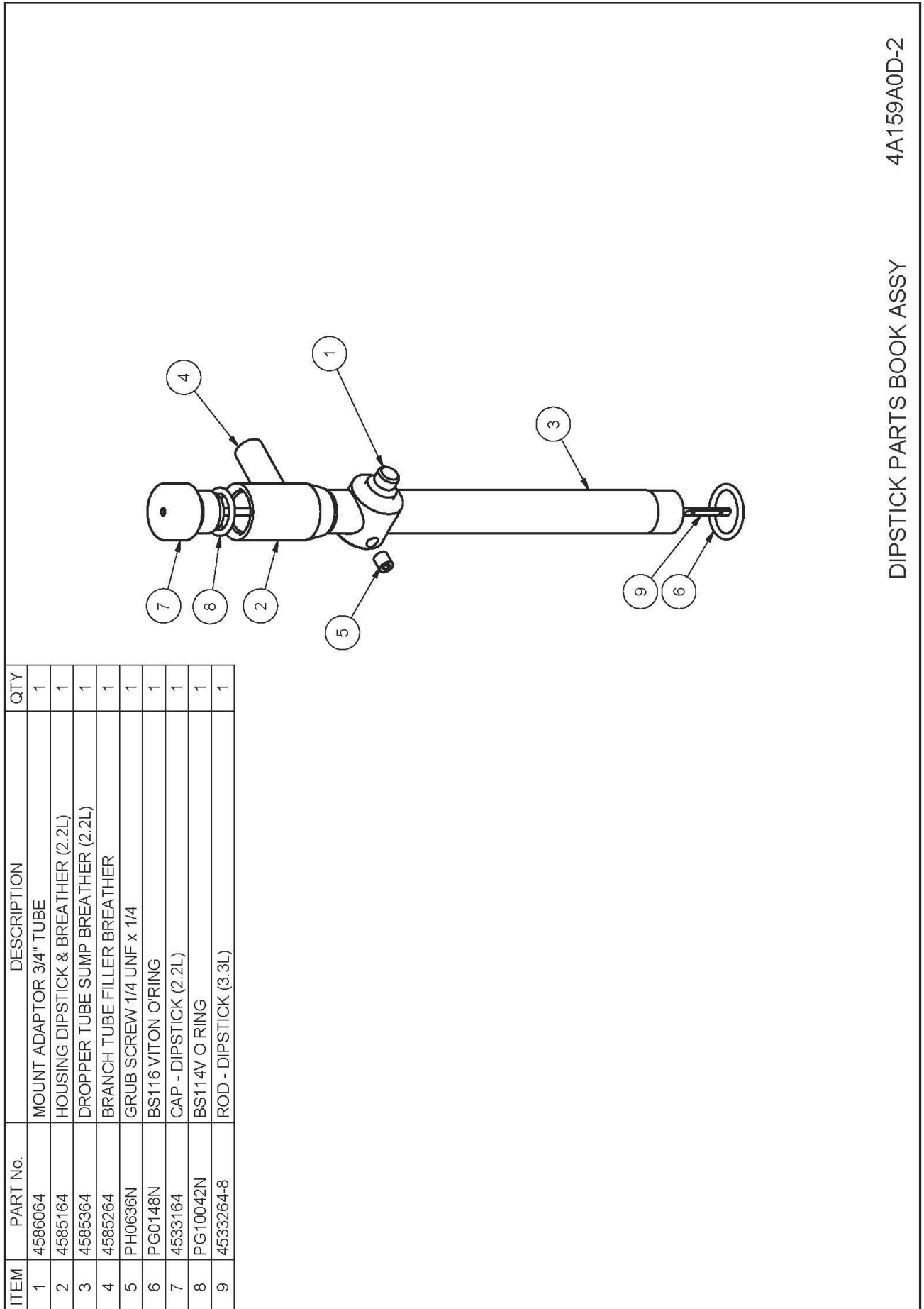
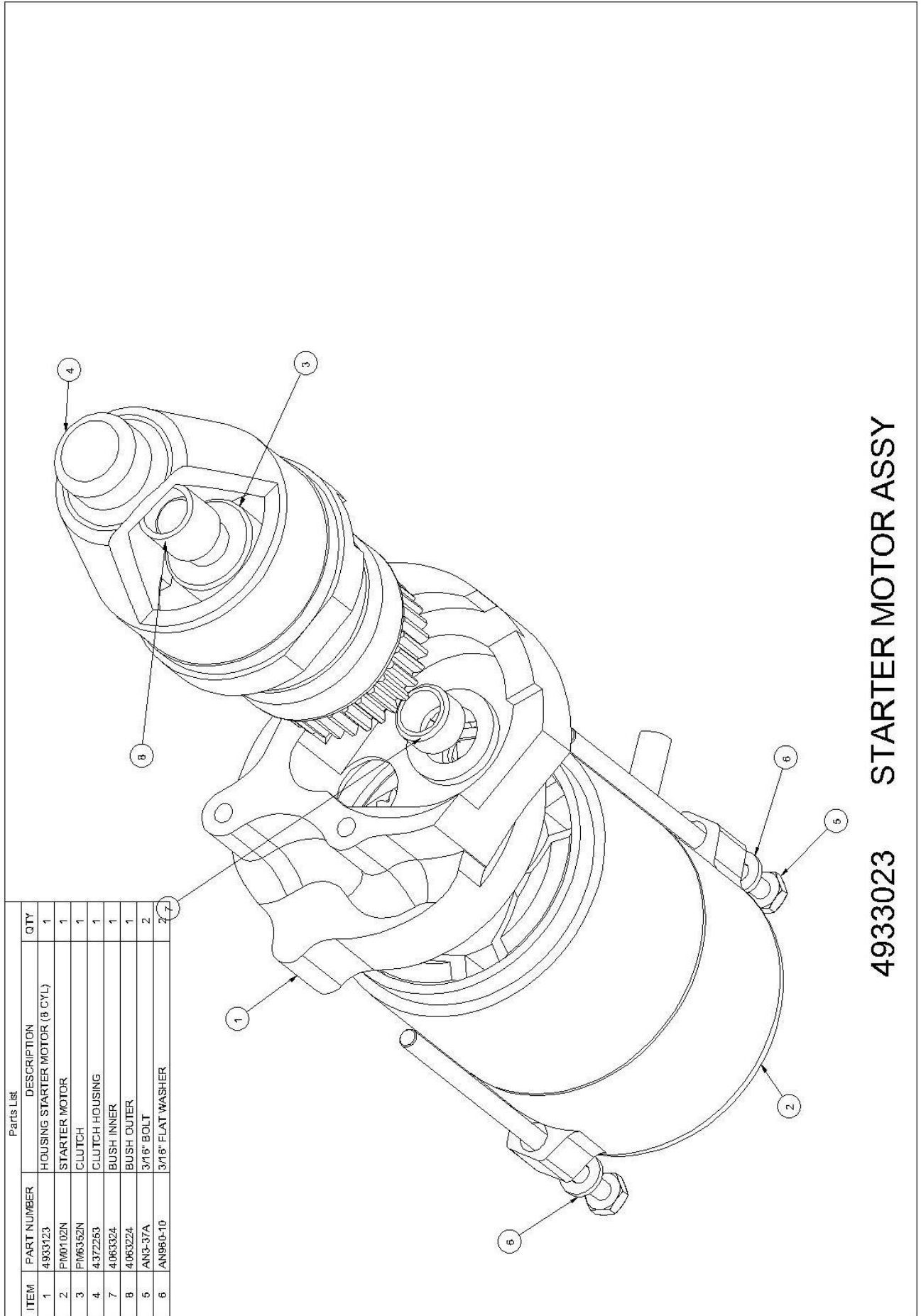

Figure 21 – Drawing 4A159A0D Dipstick Assembly



Parts List

ITEM	PART NUMBER	DESCRIPTION	QTY
1	4933123	HOUSING STARTER MOTOR (8 CYL)	1
2	PM0102N	STARTER MOTOR	1
3	PM6352N	CLUTCH	1
4	4372253	CLUTCH HOUSING	1
7	4063324	BUSH INNER	1
8	4063224	BUSH OUTER	1
5	AN3-37A	3/16" BOLT	2
6	AN960-10	3/16" FLAT WASHER	2

4933023 STARTER MOTOR ASSY

Figure 22 – Drawing 4933023 Starter Motor Assembly

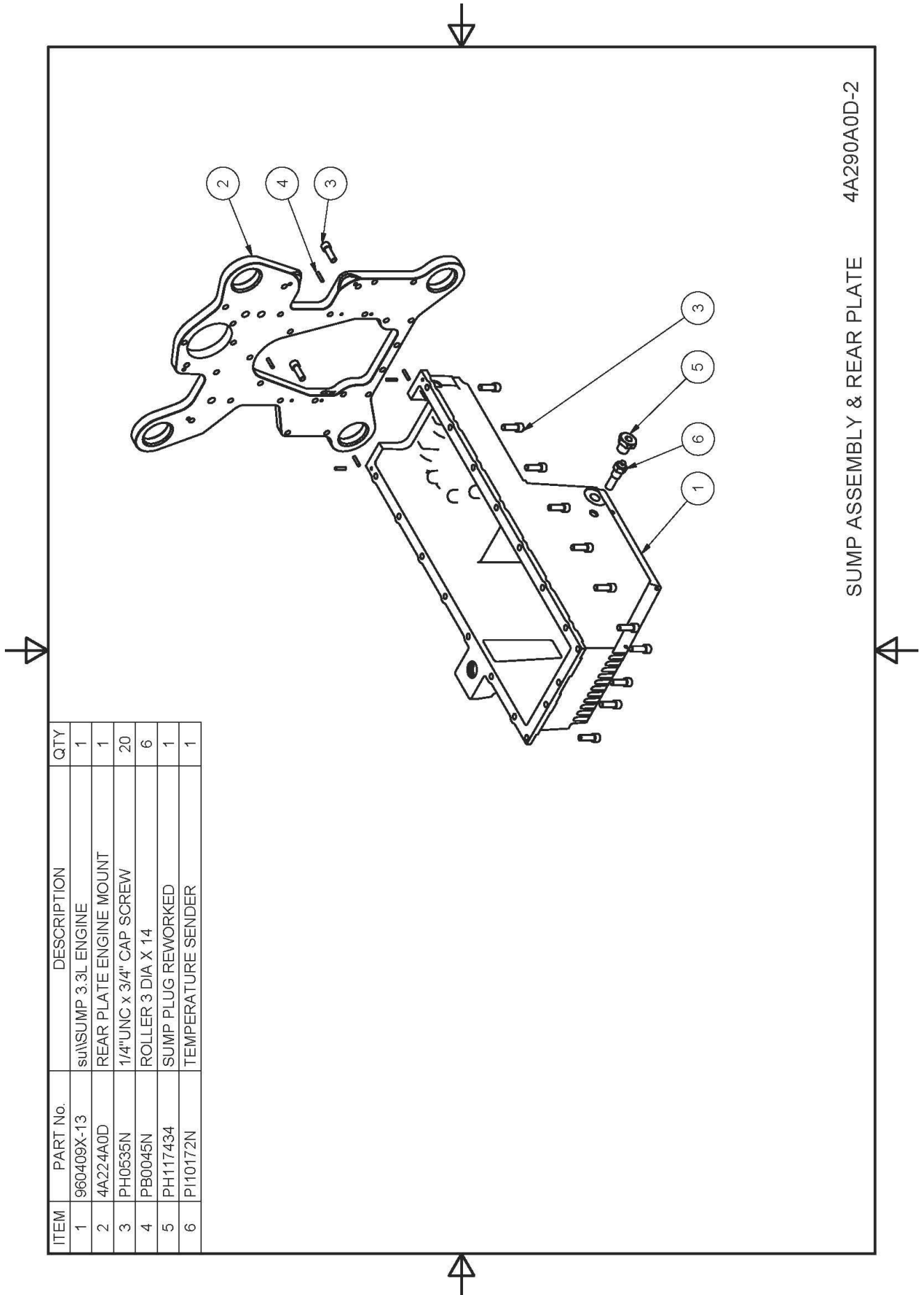

ITEM	PART No.	DESCRIPTION	QTY
1	960409X-13	su\SUMP 3.3L ENGINE	1
2	4A224A0D	REAR PLATE ENGINE MOUNT	1
3	PH0535N	1/4"UNC x 3/4" CAP SCREW	20
4	PB0045N	ROLLER 3 DIA X 14	6
5	PH117434	SUMP PLUG REWORKED	1
6	PI10172N	TEMPERATURE SENDER	1

SUMP ASSEMBLY & REAR PLATE 4A290A0D-2

Figure 23 – Drawing 4A290A0D Sump Assembly & Rear Plate

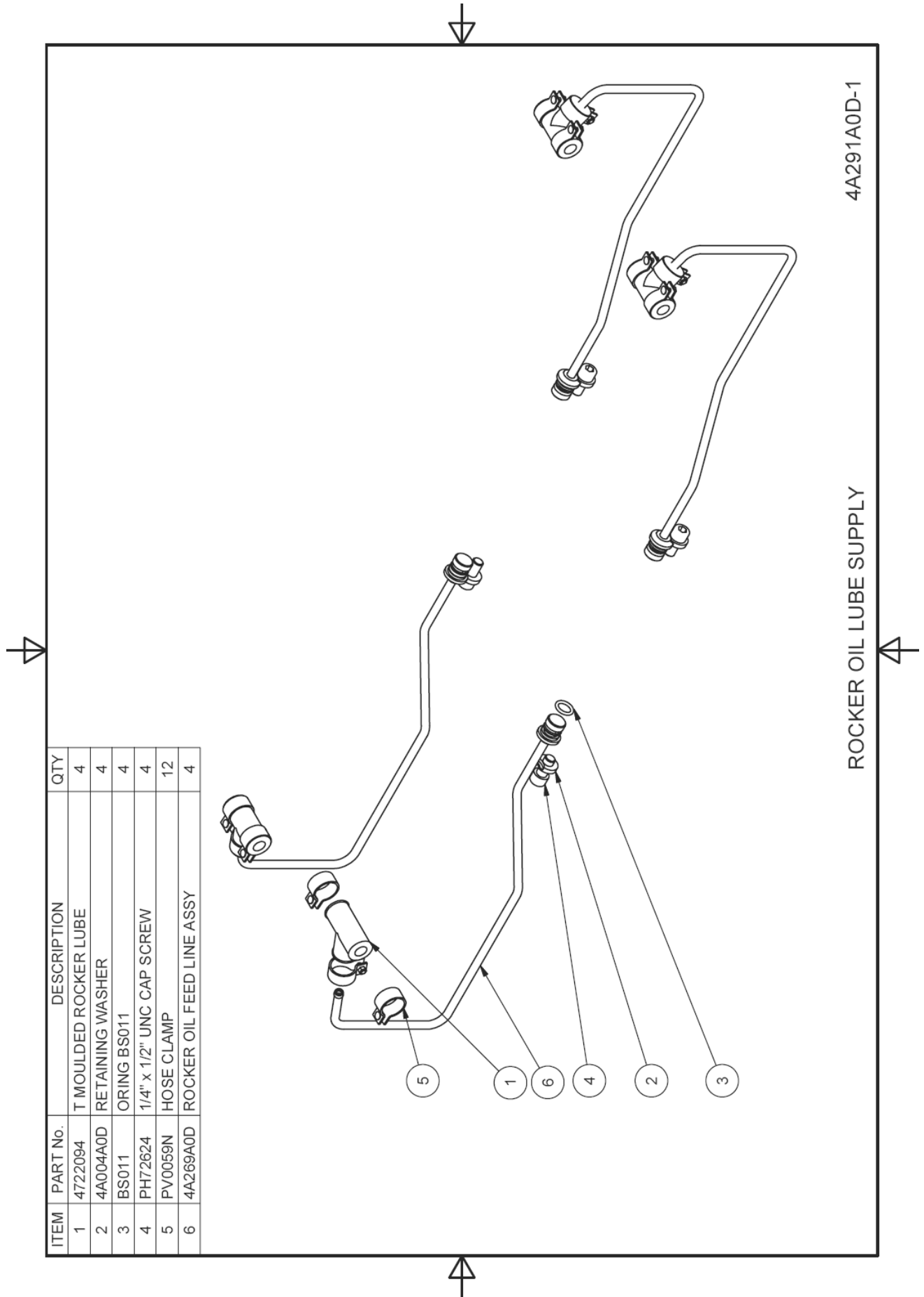
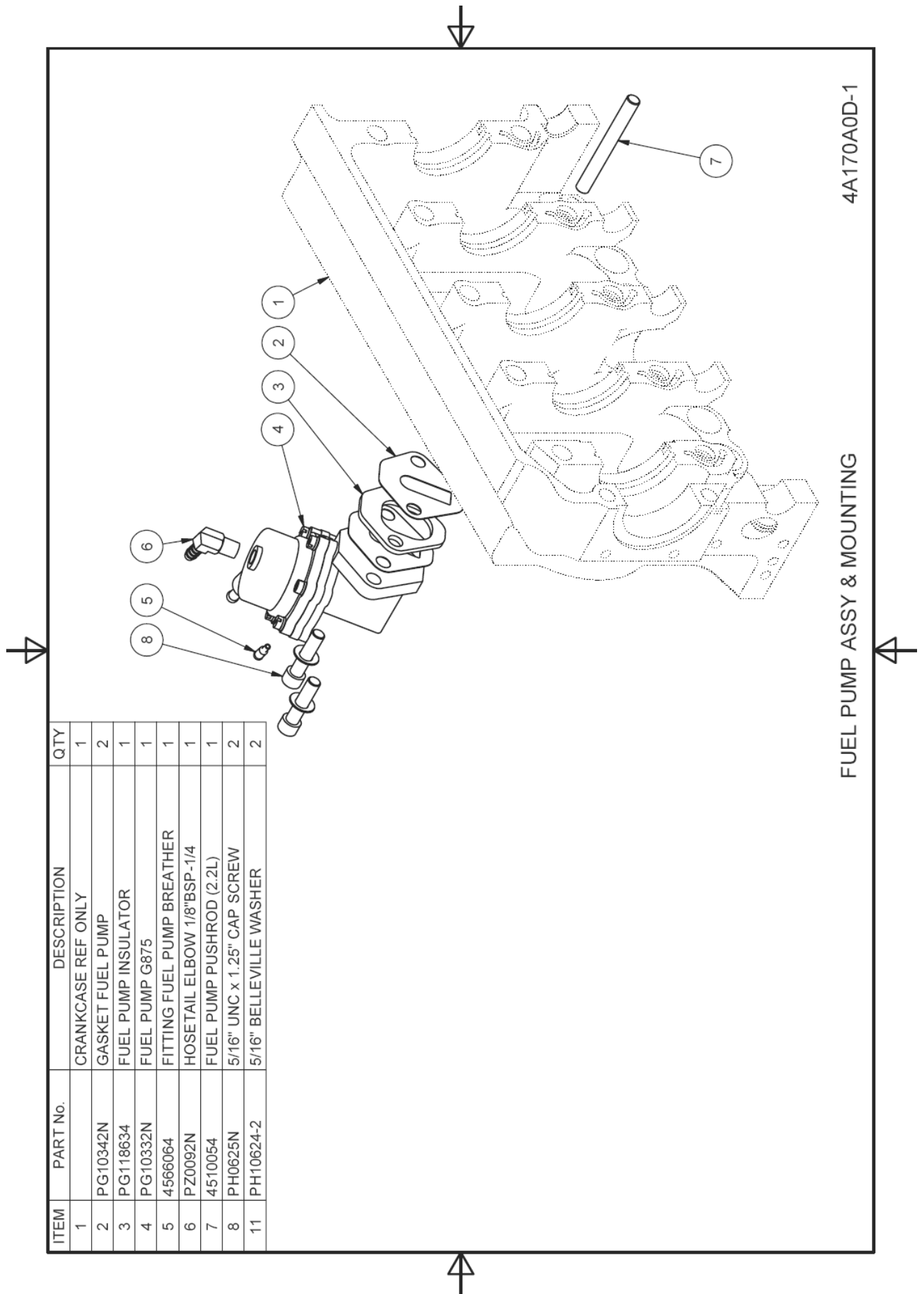

Figure 24 – Drawing 4A291A0D Rocker Oil Lube Supply up to S/N 33A2215



ITEM	PART No.	DESCRIPTION	QTY
1		CRANKCASE REF ONLY	1
2	PG10342N	GASKET FUEL PUMP	2
3	PG118634	FUEL PUMP INSULATOR	1
4	PG10332N	FUEL PUMP G875	1
5	4566064	FITTING FUEL PUMP BREATHER	1
6	PZ0092N	HOSETAIL ELBOW 1/8"BSP-1/4	1
7	4510054	FUEL PUMP PUSHROD (2.2L)	1
8	PH0625N	5/16" UNC x 1.25" CAP SCREW	2
11	PH10624-2	5/16" BELLEVILLE WASHER	2

4A170A0D-1

FUEL PUMP ASSY & MOUNTING

Figure 25 – Drawing 4A170A0D Fuel Pump Assembly & Mounting

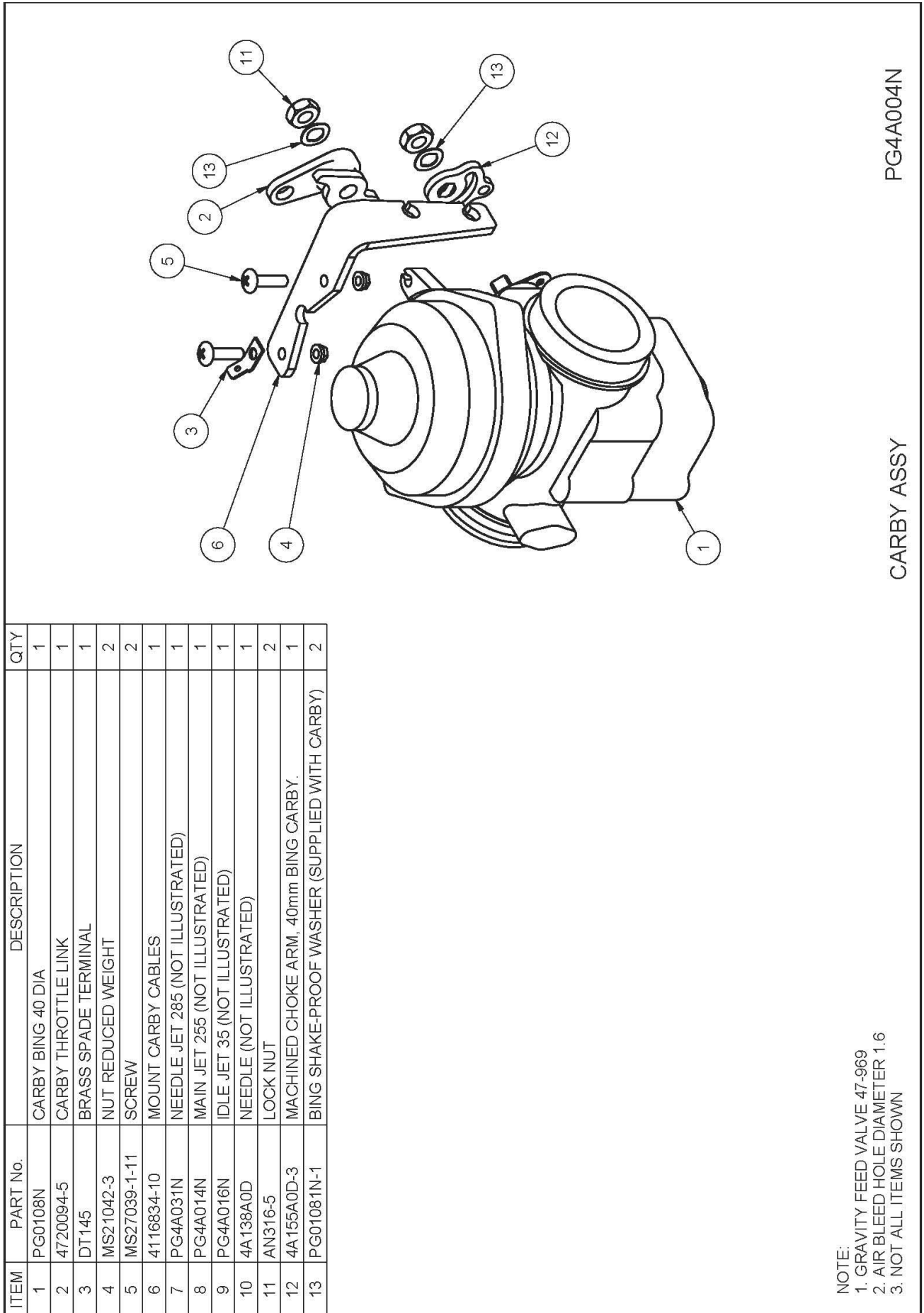

PG4A004N

CARBY ASSY

Figure 26 – Drawing 4886014 Carburetor Assembly

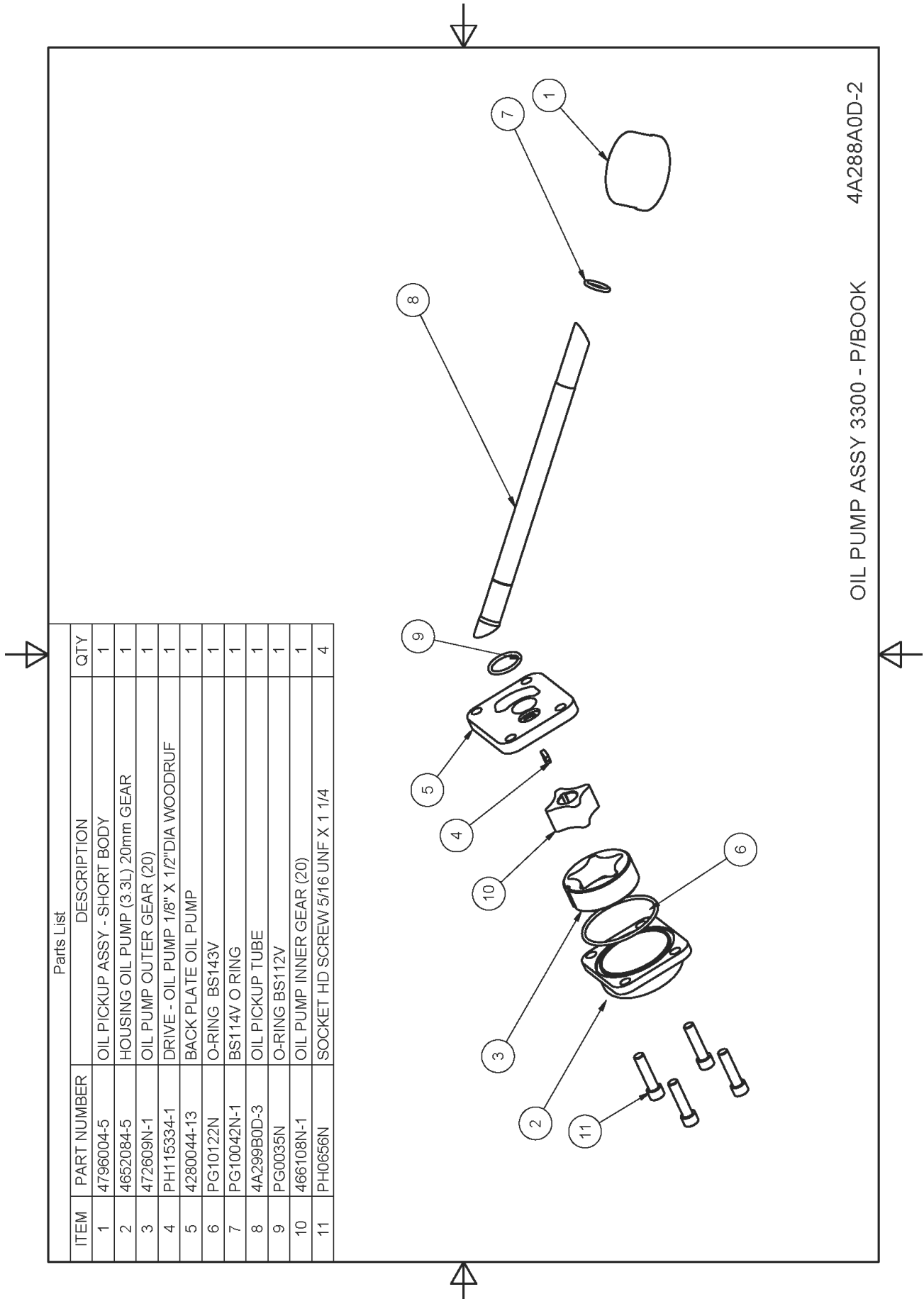

Parts List

ITEM	PART NUMBER	DESCRIPTION	QTY
1	4796004-5	OIL PICKUP ASSY - SHORT BODY	1
2	4652084-5	HOUSING OIL PUMP (3.3L) 20mm GEAR	1
3	472609N-1	OIL PUMP OUTER GEAR (20)	1
4	PH115334-1	DRIVE - OIL PUMP 1/8" X 1/2"DIA WOODRUF	1
5	4280044-13	BACK PLATE OIL PUMP	1
6	PG10122N	O-RING BS143V	1
7	PG10042N-1	BS114V O RING	1
8	4A299B0D-3	OIL PICKUP TUBE	1
9	PG0035N	O-RING BS112V	1
10	466108N-1	OIL PUMP INNER GEAR (20)	1
11	PH0656N	SOCKET HD SCREW 5/16 UNF X 1 1/4	4

Figure 27 – Drawing 4A288A0D Oil Pump Assembly

4A288A0D-2

OIL PUMP ASSY 3300 - P/BOOK

ITEM	PART No.	DESCRIPTION	QTY
1	4662084-8	FLANGE - PROP MOUNT 20mm EXTENDED 3300	1
1	OR 4610074	EXTENDED PROP FLANGE 2" EXT (2200 & 3300)	1
1	OR 4525064	FLANGE PROP MOUNT 20mm EXTENDED 2200	1
2	4688084-3	GUIDE BUSH PROP S/S (2.2L)	6
3	4911024-2	SOCKET HD SCREW DRILLED 3/8 X 3/4	6
4	MS20995C32	LOCKWIRE	A/R
5	PH10224-2	BELLEVILLE WASHER	6
6	PH4A058N-1	DOWEL PIN 8mm x 24 LONG from S/N 22A3499 & 33A2446	3
7	4A542A0D-2	PLATE PROP MOUNT - 2200 / 3300 MULTI-FIT.	1

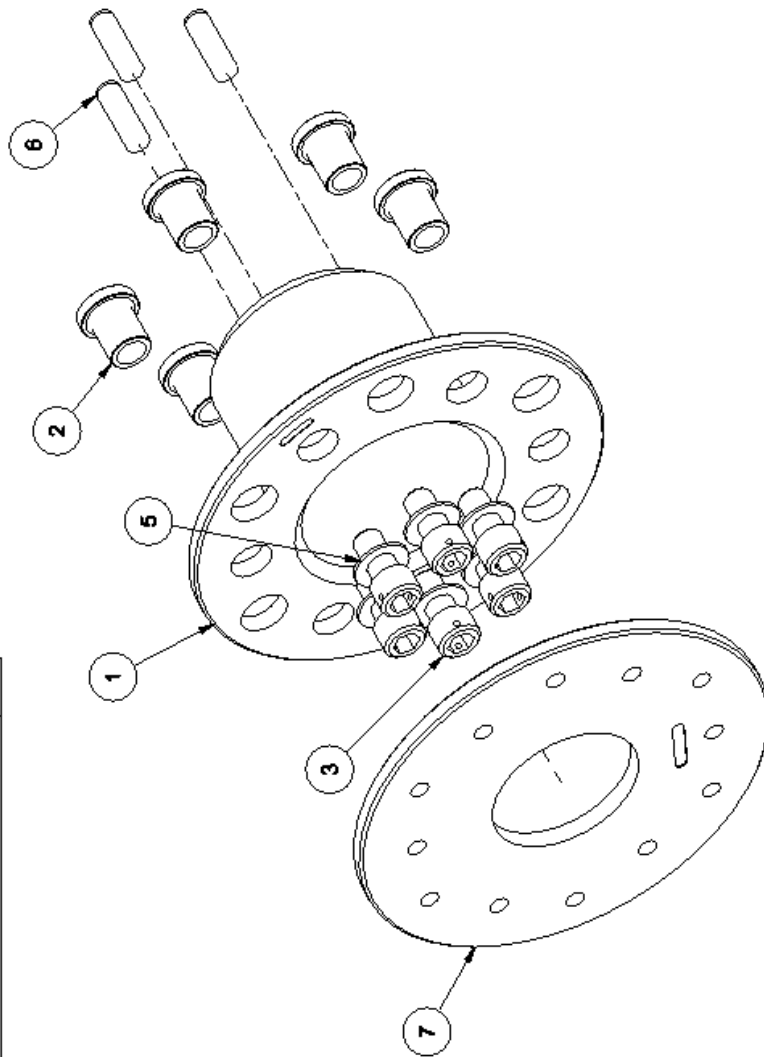

Figure 28 – Prop Flange Assembly



ITEM	PART #	ISS	DESCRIPTION	QTY
	PI10652N		RECTIFIER/REGULATOR SINGLE PHASE	1
	PI10662N		CABLE STARTER	1
	PI10672N		COUPLING CRIMP	1
	PI10682N		CABLE FITTING 5/16	1
	PI10692N		STARTER RELAY	1
	PI12497N		SOLENOID	1

Figure 29: Miscellaneous Electrical

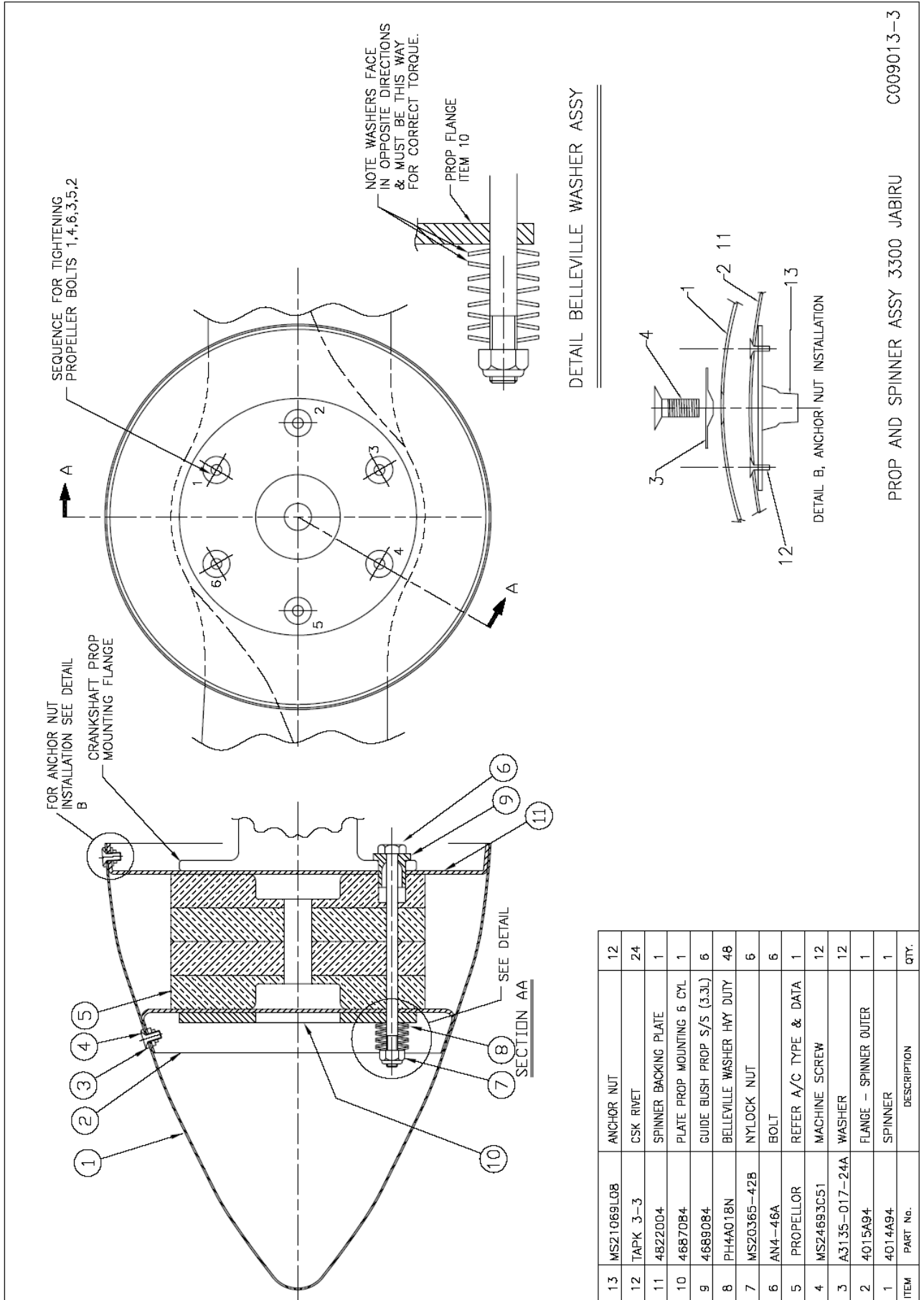

Figure 30.- Drawing C009013 Propeller Installation (4 Laminate Prop)

C009013-3

PROP AND SPINNER ASSY 3300 JABIRU