

# FAU



## ELEVATED APPROACH, THRESHOLD AND RUNWAY END LIGHT

### COMPLIANCES

ICAO: Annex 14 - Volume I Fig. A2-1, A2-2, A2-3, A2-4, A2-8

FAA: L-862S AC150/5345-46

IEC: TS 61827

NATO: STANAG 3316

CAA: CAP 168

IAAE: TP312

### APPLICATIONS

Approach, Threshold and Runway End for ICAO CAT I, II and III and military runways

Used for Stop Bar lighting on FAA taxiways

### BENEFITS

- Only one lamp rated from 65W through 200W: its replacement is quick and easy without use of tools
- 1000 hours lamp rated life at full intensity, but over 3000 hours in field operating conditions
- Designed with simplicity allowing longer maintenance intervals and fewer spare parts
- Heat resistant front glass, white, red or green, external surface with large prisms for easy cleaning
- Customized front glass gasket to avoid the use of sealing
- No optical adjustment after lamp or front glass replacement

### PERFORMANCES

- Lightweight and sturdy due to aluminium die-castings
- Powder coating surface finishing to provide good corrosion resistance
- Body balanced on a graduated support for proper horizontal and vertical aiming
- High jet blast resistance due to the small size of the Threshold and Runway End fixtures, 320 mm high
- Protection degree: IP44 (IP54 on request)
- Temperature range: -55°C to +55°C

### INSTALLATION

- The fixture can be installed on pipe elbow or baseplate
- Specific tools available for easy and precise installation

### PHOTOMETRIC PERFORMANCES

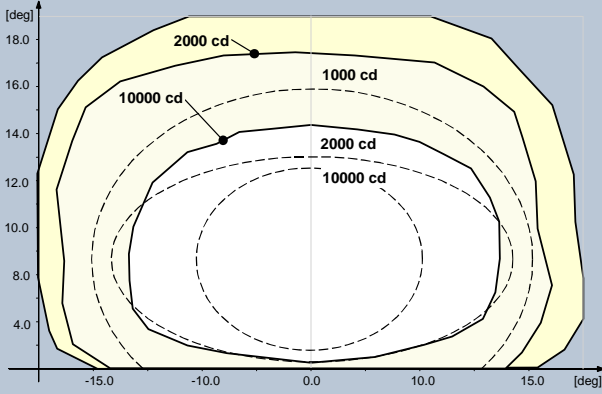

Fig. 1 ICAO Fig. A2-1 – White

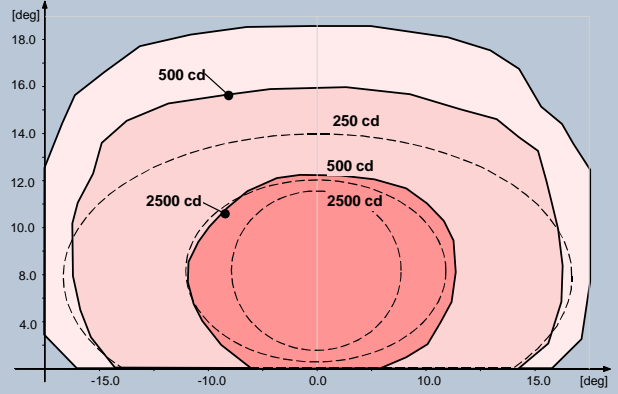

Fig. 2 ICAO Fig. A2-2 – Red

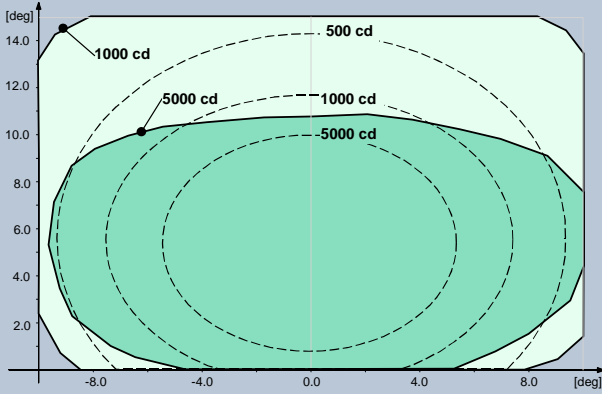

Fig. 3 ICAO Fig. A2-3 – Green

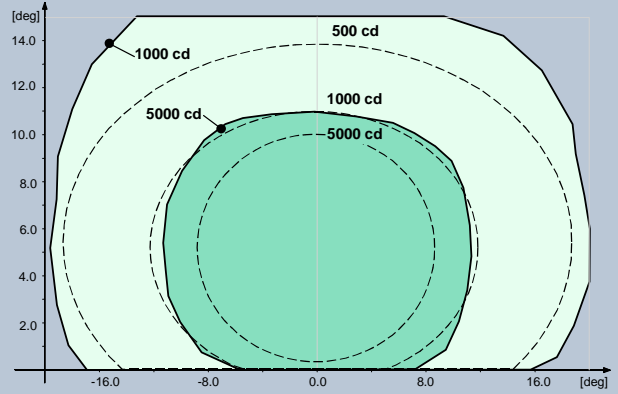

Fig. 4 ICAO Fig. A2-4 – Green

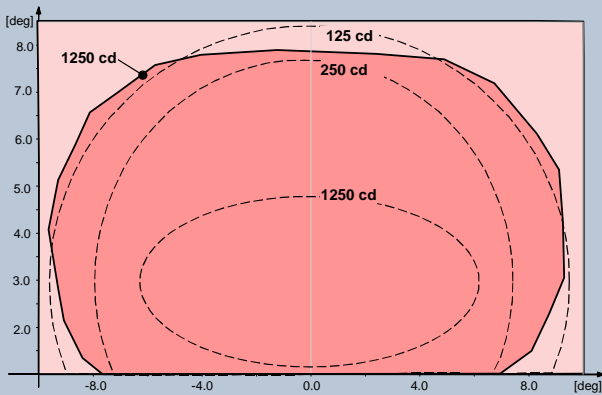

Fig. 4 ICAO Fig. A2-8 – Red

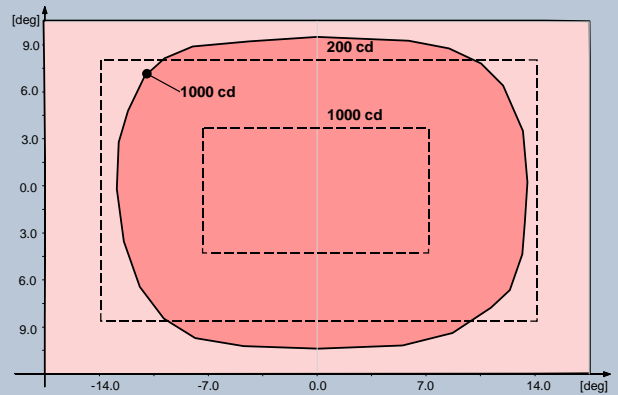
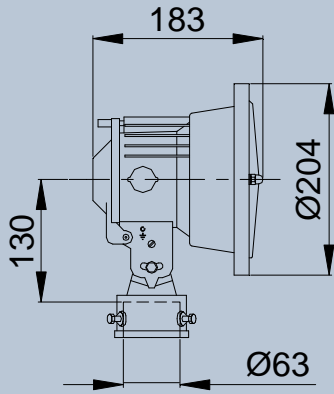
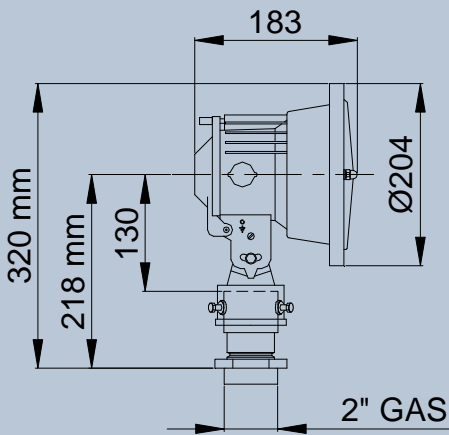

Fig. 5 FAA L-862S – Red



Mounting Assembly "C"



Mounting Assembly "P" (001)

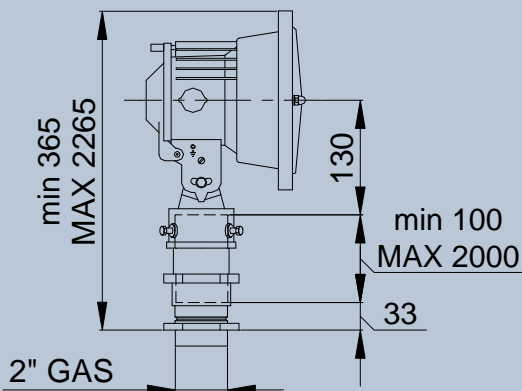

Mounting Assembly "P" (010)

**FAU - TG - 065 - C - 001 - 54**

Basic P/N: \_\_\_\_\_

Use Code: \_\_\_\_\_  
(refer to TABLE A)

Lamps: \_\_\_\_\_

- 065 = 1x65W 6.6A PK30/d
- 100 = 1x100W 6.6A PK30/d
- 150 = 1x150W 6.6A PK30/d
- 200 = 1x200W 6.6A PK30/d

Mounting Assembly: \_\_\_\_\_

P\* = Mounting Pole (if required), Breakable Coupling and Cable Lead INCLUDED

C = Mounting Pole and Breakable Coupling NOT INCLUDED, Cable lead INCLUDED

X = Mounting Pole, Breakable Coupling and Cable Lead NOT INCLUDED

Pole/Cable Lead Key: \_\_\_\_\_

With mounting assembly "P" or "C" refer to TABLE B  
With mounting assembly "X" indicate "000"

Options: \_\_\_\_\_

54 = IP54

\* The standard Threshold, Threshold Wing Bar and Runway End lights are provided without mounting pole

**TABLE A**

USE CODE	APPLICATION	COLOUR	LAMP		
			ICAO	STANAG	FAA
AC	Approach centreline and crossbars	WHITE	150W	150W	/
AR	Approach side row	RED	150W	150W	/
TG	Threshold	GREEN	150W	150W	/
WG	Threshold wing bar	GREEN	200W	150W	/
ER	Runway end	RED	65W	65W	/
SB	FAA Stop bar	RED	/	/	100W

**TABLE B**

Mounting Assembly "P"		Mounting Assembly "C"	
POLE KEY	POLE LENGTH (cm)	CABLE LEAD KEY	CABLE LENGTH (cm)
001	NO POLE	045	45
010	10	050	50
050	50	100	100
100	100	150	150
150	150	200	200
200	200	250	250

### RENEWAL PARTS FOR LIGHT UNIT

- 1 Aluminium ring
- 2 Front glass
- 3 Front glass gasket
- 4 Aluminium reflector
- 5 Lamp
- 6 Body
- 7 Rear door gasket
- 8 Graduated support with screws
- 9 Pole
- 10 Breakable coupling
- 11 Cable gland
- 12 FAA L-823 plug

Refer to the relevant technical manual for the complete list of the available spare parts

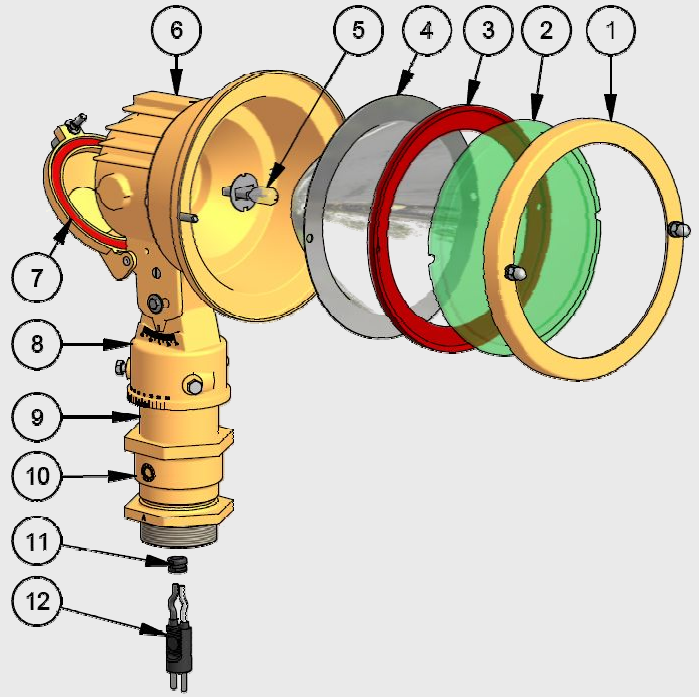

### ACCESSORIES

- 013.0010 Set of two ryton rings for receptacle support inside pipe elbow
- 013.0008 Galvanized steel pipe elbow with upper threaded end only (2" - 11 GAS thread)
- 315.3210 Galvanized steel pipe elbow with both threaded ends (2" - 11 GAS thread)
- 315.1228 Base L-867, Class IA, Size B, 24" Deep
- 315.1062 Baseplate for L-867 base with gasket and cable clamp (2" - 11 GAS thread)
- 332.3270 Levelling and alignment device for light on 2" dia pole
- 332.3240 Levelling and alignment device for light on frangible pole
- 332.3180 Supporting plate for device P/N 332.3240

For any information about isolating transformers and connectors, please see the specific catalogue pages

### Shipping Weights and Volumes

	Light Type "C"	Light Type "P" (001)	Light Type "P" (010)
Weight (kg)	2.3	2.6	3.2
Volume (m <sup>3</sup> )	0.019	0.019	0.019

We reserve the right to change the design or specification data without notice

UC-PU-0054\_EN-Rev.C