

PROJECT SUMMARY

STOW AWAY RV STORAGE

Stats:

LOCATION:

Calgary, AB



CLIENT:

1863885 Alberta Ltd.

PROJECT TIMELINE:

2013 2015 2017 2019 2021



OUR ROLE:

Planning & Civil Engineering
 Consultant

PROJECT TYPE: Commercial – Planning & Engineering

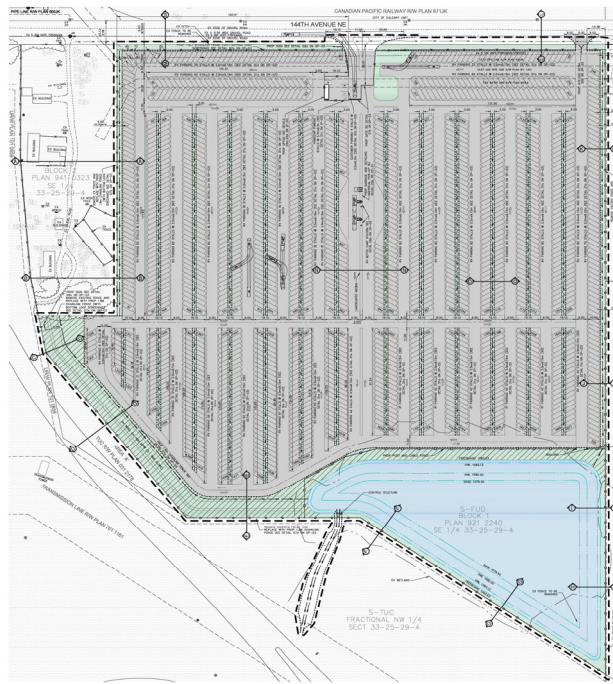

PROJECT DESCRIPTION:

Being located within the Nose Creek basin, adjacent to the Deerfoot and the Stoney Trail TUC presented several challenges to obtain approval of this 17 ha RV Storage facility. During construction of the Stoney Trail interchange, a berm was built within the TUC adjacent to the site which blocked the natural drainage course and caused a large wetland to form on our client's property. For this reason, close coordination with, and approvals were required from the City of Calgary, Alberta Infrastructure, P3 Contractor, Alberta Transportation and Alberta Environment and Parks.

SERVICES WE ARE PROVIDING:

Scheffer Andrew provided planning and civil engineering services including detailed design of the overland drainage system including LID's to reduce runoff volume to match pre-development. The City's Water Balance Spreadsheet was used to estimate pre-development runoff volume from the undeveloped land, offsite lands, and wetland and to then analyze the development and design a pond to limit runoff volume to the 6mm per year pre-development discharge. Analysis included consideration of the volume of runoff that could be used by private irrigation.

We were responsible for preparing the Development Permit and obtaining approval of the **DSSP**, **Stormwater Management Report** and **Erosion and Sediment Control Plan**, and **Ministerial Consent** for remediation work in within the TUC.