



FREE
AIRFARE

See back for details

11 DAY RIVER CRUISE HOLIDAY

Including two nights in
Lisbon, Portugal

Portugal and the Douro River Cruise

Porto to Salamanca, Spain, and return

Departure Date: August 21, 2019

The logo for Mayflower Cruises & Tours features a stylized globe icon above the word "Mayflower" in a large, bold, serif font. Below "Mayflower", the words "CRUISES & TOURS" are written in a smaller, all-caps, sans-serif font.

Mayflower
CRUISES & TOURS



Monument to the Discoveries overlooks the harbor in Lisbon, Portugal



Feel the rhythm of the city in the Plaza Mayor, Salamanca, Spain

Portugal and the Douro River Cruise

11 Days • 23 Meals Spend two nights exploring Lisbon, then set sail through the Portuguese Frontier. Visit Spain's walled city of Salamanca, and the quaint and historic towns of Portugal along the Douro River.



CRUISE AND HOTEL ACCOMMODATIONS

Days Two and Three – Hotel Sana Lisboa, Lisbon, Portugal
 Days Four through Ten – Aboard the *MS Emerald Radiance*

EXCEPTIONAL INCLUSIONS:

- ❖ **23 Meals** (9 breakfasts, 6 lunches and 8 dinners)
- ❖ **Airport transfers** on tour dates when air is provided by Mayflower Cruises & Tours
- ❖ Visit **two countries**
- ❖ Two-night **hotel stay and touring** in Lisbon, Portugal before cruising
- ❖ **Seven-night cruise** on the Douro River
- ❖ **First-class service** by an English-speaking crew
- ❖ **Shore excursions** with English-speaking local guides
- ❖ Personal **listening device** for onboard excursions
- ❖ All meals included onboard with a **variety of international cuisine**
- ❖ Complimentary **regional wines, beer and soft drinks** accompany onboard lunches and dinners
- ❖ Complimentary **bottled water** in your stateroom
- ❖ Complimentary **WiFi onboard**
- ❖ Variety of **onboard evening entertainment**
- ❖ **\$55 in Mayflower Money**

DAY 1 – Depart the USA

Depart the USA on your overnight flight to Lisbon, Portugal.

DAY 2 – Lisbon, Portugal

Upon arrival, you will be met by a Mayflower Tours representative and transferred to your hotel. The remainder of the day is at leisure to explore Lisbon. This evening, join your Mayflower staff and fellow travelers for an included dinner. **Meal: D**



Tile work adorns the Sanctuary of Our Lady of Remedies, Lamego, Portugal

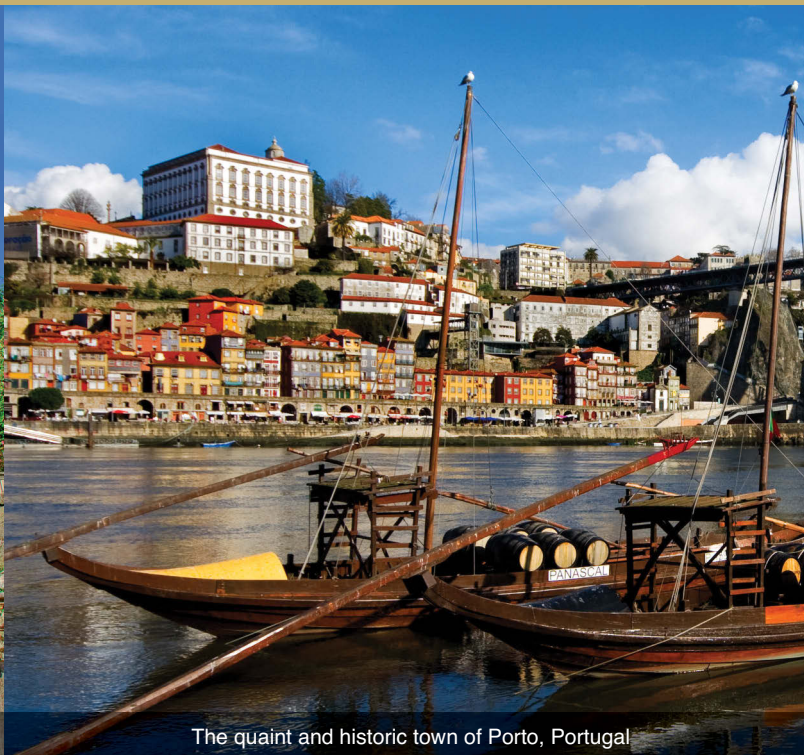

The quaint and historic town of Porto, Portugal

DAY 3 – Discover Lisbon

After breakfast, an included tour highlights the famous sites of the city. See Jerónimos Monastery, ‘Monument to the Discoveries,’ and Belem Tower, a UNESCO World Heritage Site. Enjoy a free afternoon to shop, dine and experience this cosmopolitan city on your own. **Meal: B**

DAY 4 – Fátima / Coimbra

Enroute to the ship in Porto visit Fátima, home to the Sanctuary of Fátima, an important Catholic pilgrimage site. The city’s fame originates from the apparitions of Our Lady of the Rosary that appeared to three shepherd children in the nearby fields. Continue to Coimbra and its famous university before arriving in Porto to embark the *MS Emerald Radiance*, home for the next seven nights. **Meals: B, D**

DAY 5 – Porto / Pinhão

Today is a day of sailing through the twists and turns of the Douro Valley. Designated a UNESCO World Heritage Site, this area is sparsely populated by small quaint villages and typical communities with vineyards and small farms. This afternoon, the ship arrives in the village of Pinhão, perfectly situated on a river bend surrounded by terraced hillsides that produce some of the world’s best Port wine. **Meals: B, L, D**

DAY 6 – Pinhão / Vega de Terron

Begin the day with a visit to a beautiful quinta vineyard with spectacular views of the Douro Valley. Learn about wine production and its importance to the culture and economy. This afternoon, the ship sails for Vega de Terron, gateway to Spain. **Meals: B, L, D**

DAY 7 – Salamanca, Spain

Today’s excursion takes you to the UNESCO World Heritage Site of Salamanca, Spain. During the guided walking tour, see amazingly detailed and intricately carved buildings of the university, the 12-th century Romanesque church of San Martin and the house of Shells. Regal splendor abounds in the Plaza Mayor, the heartbeat of the city. You’ll have free time to explore independently before returning to the ship in Portugal. **Meals: B, L, D**

DAY 8 – Pocinho

Arrive in Pocinho and disembark for a morning excursion to the Coa Valley Museum. Designed to blend in with its surroundings, the concrete structure houses prehistoric stone carvings made by the early inhabitants of the Douro which were uncovered during construction of a nearby dam project. Return to the ship for lunch and relax on deck as the ship sails through idyllic surroundings on the way to Régua.

This evening, enjoy an off-ship dinner at a traditional vineyard estate. **Meals: B, L, D**

DAY 9 – Régua

After arriving in Régua, journey to the marvelous baroque village of Lamego, home to the Sanctuary of Our Lady of Remedies - one of the most important pilgrimage sites in Portugal. See the Sanctuary perched atop the hill, with its iconic 686-step granite staircase, decorated with the traditional Portuguese blue and white ‘azulejos’ tiles. Return to the ship in Régua after the excursion. **Meals: B, L, D**

DAY 10 – Porto

Having traversed the Douro River, the ship returns to Porto – a city with an eclectic mix of modern and ancient architecture. An included tour highlights the sights from historic landmarks to the scenic beauty. And it wouldn’t be complete without a visit to a wine cave for a tour and tasting of Port wine. The remainder of the afternoon is at leisure in Porto. **Meals: B, L, D**

DAY 11 – Porto / USA

This morning, disembark the *MS Emerald Radiance* and bid a fond farewell to Portugal, filled with memories of this remarkable cruise along the ‘river of gold.’ **Meal: B**

Itinerary and vessel are subject to change.

Seven nights accommodations aboard the *MS Emerald Radiance*

Built: 2017 Speed: 15.5 mph Staterooms: 52 Suites: 4 Length: 292 ft. Crew: 37

SUN DECK

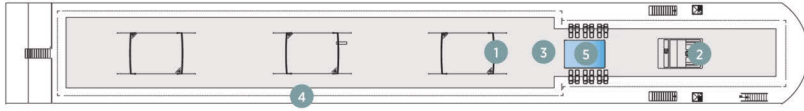

HORIZON DECK

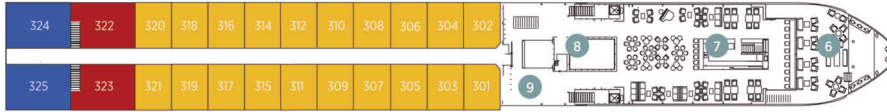

VISTA DECK

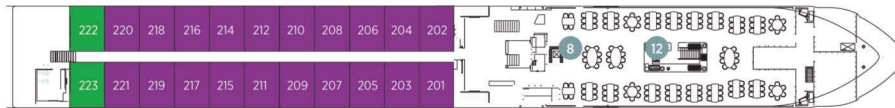

RIVIERA DECK

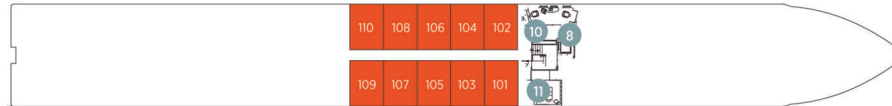

Public Areas and Ship Amenities

- 1 Sun Deck with Deck Chairs
- 2 Navigation Bridge
- 3 Sky Barbecue
- 4 Walking Track
- 5 Serenity Pool
- 6 The Terrace
- 7 Horizon Bar and Lounge
- 8 Elevator
- 9 Reception
- 10 Wellness Area/Hairdresser
- 11 Fitness Area
- 12 Reflections Restaurant

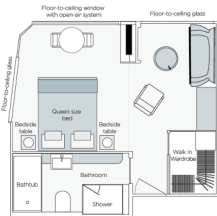

Emerald Riverview Suite

300ft²

RA

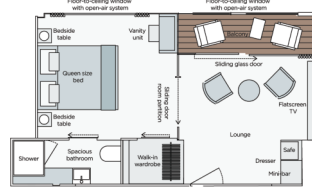

Owner's One-Bedroom Suite

285ft²

SA

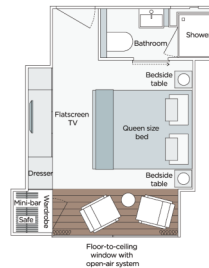

Panorama Balcony Suite

188ft² – 160ft²

P A R B

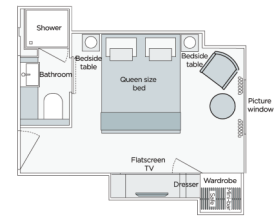

Emerald Stateroom

between 153ft² – 170ft²

E

DEPARTURE DATE: August 21, 2019

CATEGORY	DECK	PER PERSON TWIN	SINGLE ROOM
E Emerald Stateroom	Riviera	\$4,799	add \$3,119
B Panorama Balcony Suite	Vista	\$5,199	add \$3,379
R Panorama Balcony Suite	Vista	\$5,599	add \$3,639
A Panorama Balcony Suite	Horizon	\$5,799	add \$3,769
P Panorama Balcony Suite	Horizon	\$5,899	add \$3,839
SA Owner's One-Bedroom Suite	Horizon	\$6,299	N/A
RA Riverview Suite	Horizon	\$6,499	N/A

FREE AIRFARE when booked by **October 1, 2018**.

Airfare after October 1, 2018 is 2-for-1.
~~\$1,350~~ \$675 per person with offer.

Air itineraries may not be available until documents are received. Air seats are assigned by the airline for the entire group. Seat changes can only be attempted upon receipt of tickets and documents at which time availability may be limited. If specific seat assignments are vital to your reservation, we recommend individual air reservations rather than booking air with the group.

TOUR ACTIVITY LEVEL



Travelers Protection Plan (TPP) for River Cruises - \$429 per person (optional)

This nonrefundable fee will provide a refund to you during the instance that you have to cancel your trip. The cancellation has to be for a covered reason (see Plan for details on coverage) and we have to be notified at least one day prior to departure. If you must leave the tour early due to personal illness or the illness or death of an immediate family member, TPP will provide a refund for any unused services after the departure of the tour. Other benefits include medical expenses for illness and injury, emergency transportation, 24 hour hot line and lost or stolen baggage assistance. Return air transportation is included ONLY if your air tickets are purchased through Mayflower Cruises & Tours. Please review the Plan for details on coverage.

Cancellation Charges Without Traveler's Protection Plan (TPP)

- 91 days or more Deposit Amount
- 90 days to day of departure 100% of the total tour
- No refund on unused portions of the tour

Plan and benefits offered and administered by Trip Mate, Inc.



FOR RESERVATIONS OR INFORMATION CONTACT:

gaharden45@yahoo.com
OR
aryowman@aim.com