

Properties for Lease

1 Aspen Business Center - 2885 N Nevada St, Chandler, AZ 85225



Rental Rate Mo \$0.60 USD/SF/Mo
 Spaces 1
 Property Sub-type Warehouse
 Status Active

Property Notes
 Suite #140 - approximate office area 5,336 sf
 |warehouse12,935 sf | evap cooling in warehouse

Spaces

| # | Total Space Avail. | Rental Rate | Min Divisible | Max Contig. | Lease Type | Date Avail. | Description | Service Type |
|-------------------|--------------------|---------------|---------------|-------------|------------|-------------|-------------|--------------|
| 1st Floor Ste 140 | 12,935 SF | \$0.60 /SF/Mo | 12,935 SF | | NNN | Now | | Triple Net |

Property Description

Aspen Business Center, a 105,751 SF multi-tenant industrial warehouse complex consists of three (3) free standing buildings, 20' ceilings and has adjacent grade and truck well loading. The 2873 building has a private fenced yard.

Close proximity to Elliot & Arizona Ave. 2.6 miles South of the Superstition Freeway (US 60), and 3.5 miles East of the Loop 101.

2 Aspen Business Center - 2877 N Nevada St, Chandler, AZ 85225



Rental Rate Mo \$0.60 USD/SF/Mo
 Spaces 2
 Property Sub-type Warehouse
 Status Active

Property Notes
 Suite #120 - Approximate office area 900 sf | warehouse area 6182 sf | evap cooling in warehouse. Suite #130 - Approximate office area 1836 sf | warehouse area 11,099 sf | evap cooling in warehouse.

Spaces

| # | Total Space Avail. | Rental Rate | Min Divisible | Max Contig. | Lease Type | Date Avail. | Description | Service Type |
|-------------------|--------------------|---------------|---------------|-------------|------------|--------------------|-------------|--------------|
| 1st Floor Ste 120 | 7,082 SF | \$0.60 /SF/Mo | 7,082 SF | | NNN | September 15, 2019 | | Triple Net |
| 1st Floor Ste 130 | 12,935 SF | \$0.60 /SF/Mo | 12,935 SF | | NNN | September 15, 2019 | | Triple Net |

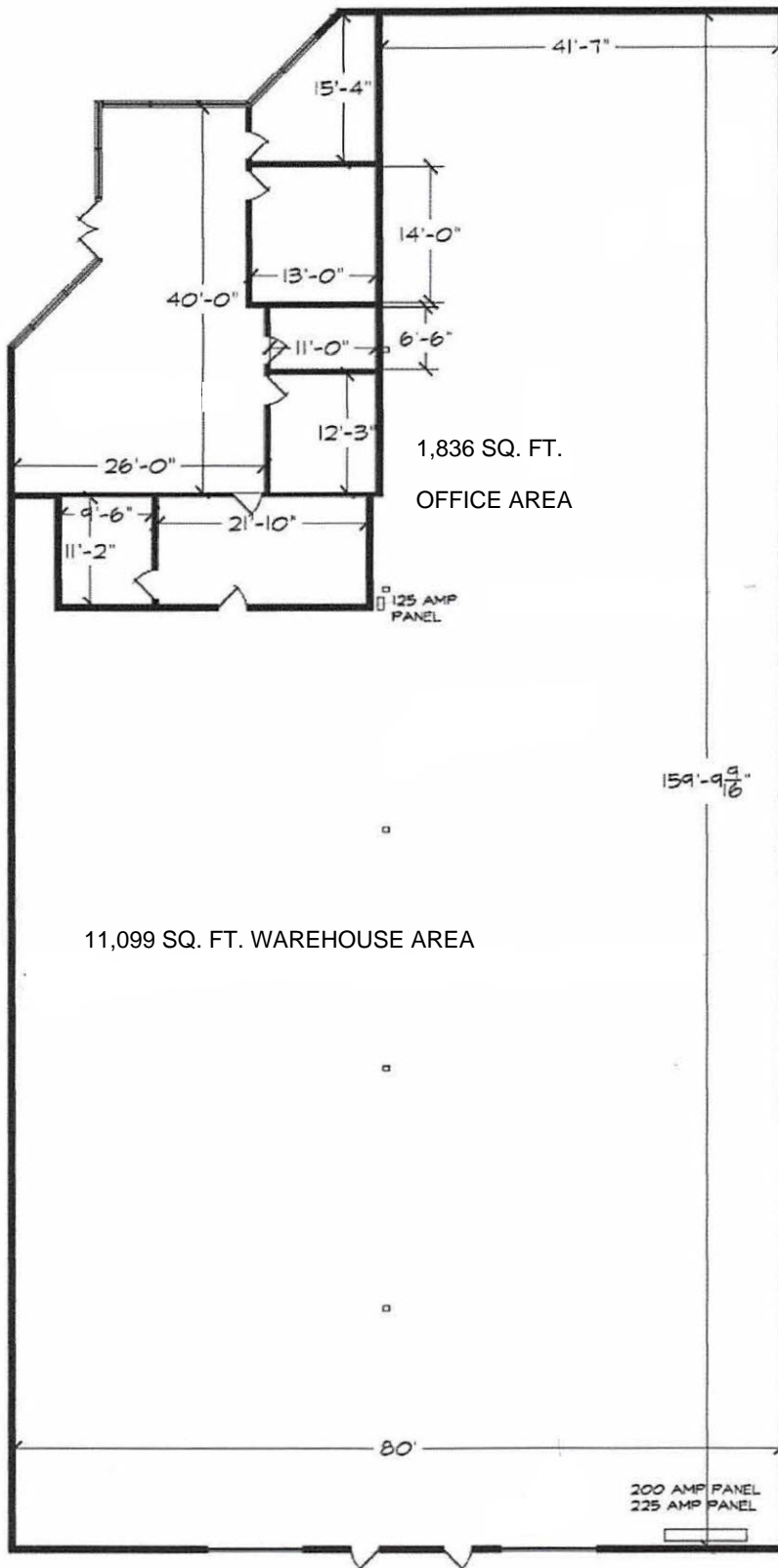

ASPEN

BUSINESS CENTER
CHANDLER, ARIZONA

2877 N. NEVADA ST

REB LIMITED

for more information contact

RANDALL E. BLUM
PRESIDENT

123 N. CENTENNIAL WAY
SUITE 112
MESA AZ, 85201

OFFICE: (480)-827-9591
FAX: (480)-827-2915

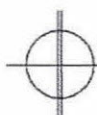

SUITE 130 OFFICE SPACE AND WAREHOUSE

12,935 SQ. FT. TOTAL

REB LIMITED