

EXPLODED VIEW & PART NUMBERS 8" DRILL PRESS

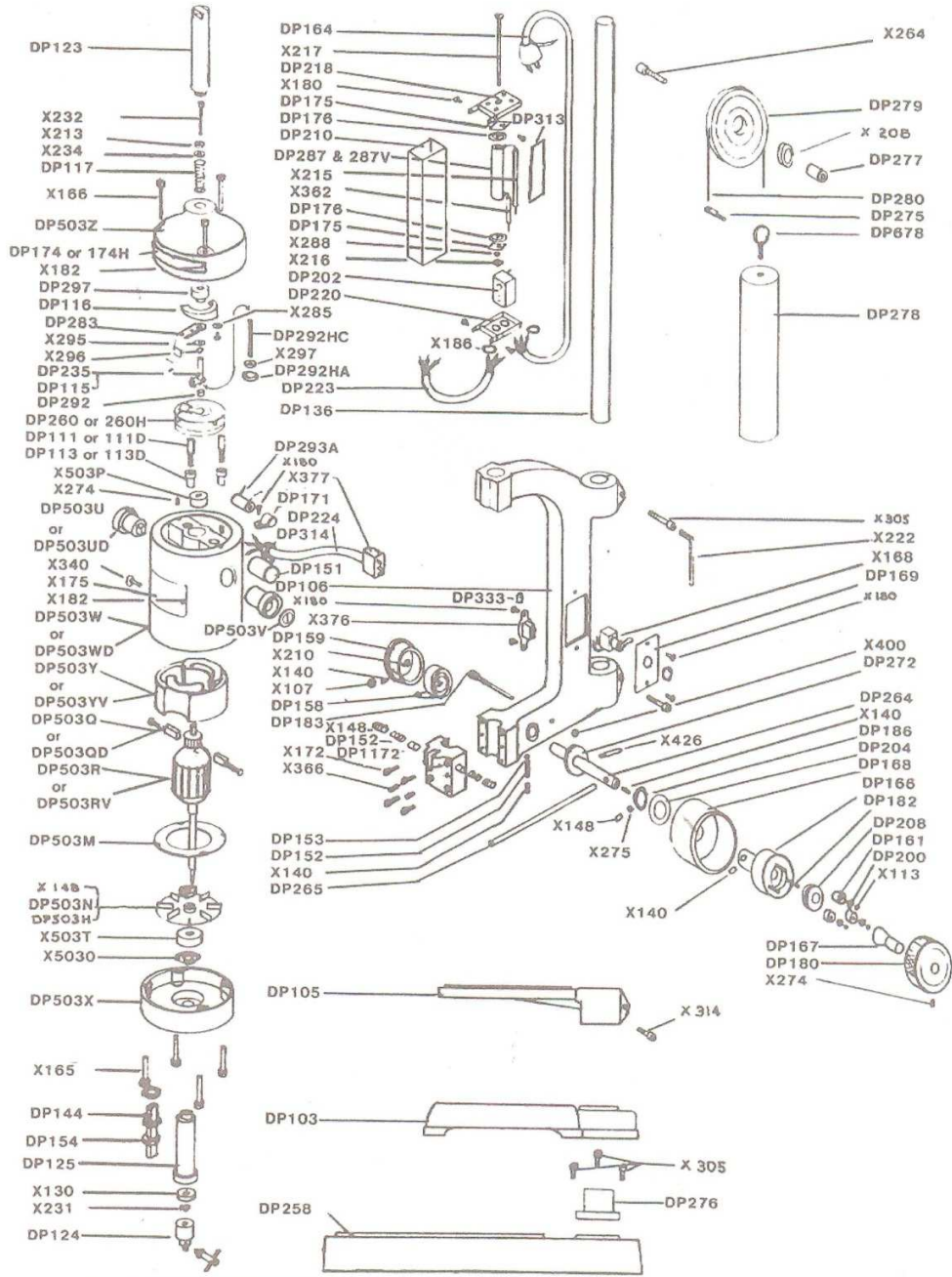

SPECIFY MODEL AND SERIAL NUMBERS OF MACHINE WHEN ORDERING REPLACEMENT PARTS
 MODELS 105, 106, 110, 111 (EXCEPT FOR "Y" SUFFIX) USE "D" PARTS
 2500-15,000 RPM MODELS USE SUFFIX "H" PARTS

Maintenance **Electro-Mechano High Speed Motor**

Extreme care has been exercised in manufacture and inspection to insure the quality of this drilling unit. These instructions have been prepared to help you obtain maximum service from it. Remember, the brushes of this high speed motor must be inspected periodically. Worn and neglected brushes may cause extensive damage to the motor and governor.

TO CHECK MOTOR BRUSHES

Unscrew the BRUSH HOLDER CAPS (located on sides of motor) and remove the brushes. Wipe off any oil or gum found on the brushes or in the brush holders. Check the brush length, if it is less than $\frac{1}{4}$ " , a new brush is required. Make sure that brushes are replaced so that the concave end will conform with the commutator. The brushes must move freely in the brush holders.

TO CHECK GOVERNOR BRUSHES AND GOVERNOR

First disconnect the drilling unit from the power outlet. While holding the motor case firmly, unscrew and remove the TOP QUILL.

Remove the three screws holding the GOVERNOR HOUSING at the top end of the motor. Pull the quill shaft lever down to provide clearance – then remove the governor housing. Remove the governor which is held by two allen screws in its hub.

Remove the governor brushes and wipe off any accumulation. If the brushes are less than $\frac{1}{4}$ " long, replace them with new ones. Inspect the governor for burned contacts and worn brush races.

CAUTION: When installing the governor (part No. DP260) the governor slip rings should be approximately $\frac{1}{32}$ " from the top of the brush holders; the hub screws tightened securely against the two flats on the spindle. DO NOT connect the press to the line until the GOVERNOR HOUSING has been replaced

TO ADJUST SPINDLE SPEED

With the motor case held firmly, unscrew and remove TOP QUILL. Adjust speed by loosening lock-nut "B" and turning screw "A" down to decrease speed and up to increase speed. Tighten lock-nut "B" after adjustment. This adjustment is made with the motor running and SPEED CONTROL LEVER set at minimum speed.



TO REMOVE QUILL DRIVE MECHANISM

While holding the QUILL RETURN SPRING COVER firmly, loosen the ALLEN HEAD LOCK SCREW which secures it in place, then let the spring slowly unwind. Remove the quill return spring cover.

With the motor case held firmly, unscrew and remove TOP QUILL. Unplug motor after loosening small spring lock which holds plug in socket. Unscrew four screws which hold lower quill bearing cap in place and remove motor. Loosen set screw in the end of quill feed shaft and remove handle rod. Loosen set screw in hub of Micro Feed unit on models with dual feed and slide off shaft. Quill feed shaft can then be pulled out.

6" DRILL PRESS WIRING LAY-OUT.

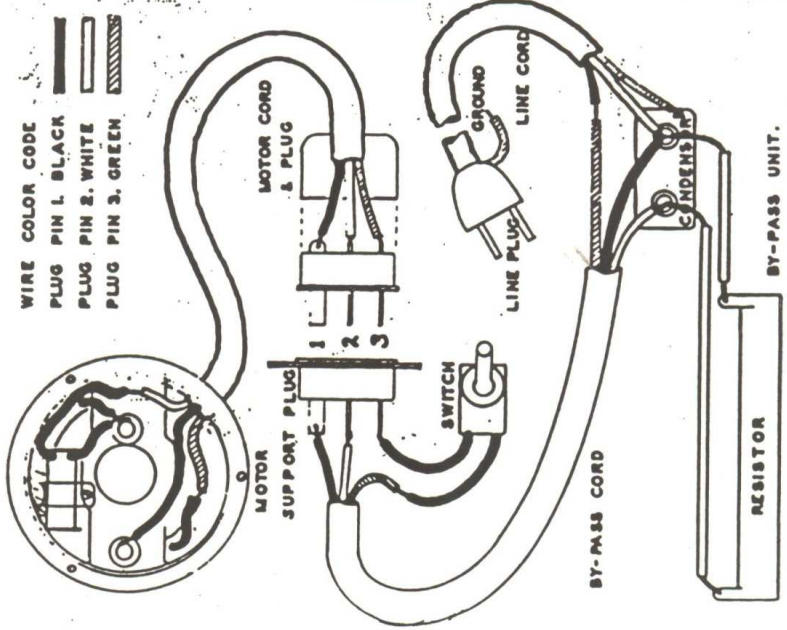

MOTOR WIRING DIAGRAM

