



HUNTMASTER 8X8

Luxuriously equipped, the new ARGO HuntMaster is the ultimate XTV featuring a host of high performance features designed to easily get sportsmen to the best hunting grounds and then safely back to camp.

High-speed power pack

Mounted two gun
Sure Grip gun rack



Front seat pass-through backrest

Robust brushguard



Dual side
entry steps



Low-pressure
tire system



WILDERNESS
SERIES

SPECIFICATIONS FOR ARGO HUNTMASTER 8X8

Engine	Kohler Aegis LH 775	
Engine Warranty	3 year	
Type	4 cycle OHV V-Twin gasoline EFI engine, electronic ignition, full pressure lubrication and oil filter	
Horsepower	30	
Displacement	747 cc	
Cooling	Liquid Cooled	
Starting	Electric	
Brakes	Hydraulic	
Steering	One-piece, ergonomic handlebar. Steering control features hand brake. For safety and ease of handling, the ARGO steering transmission provides continuous torque to all axles.	
Controls	Right-hand twist grip throttle. Light switch and ignition switch.	
Clutch	Belt-driven, Continuously Variable Transmission (CVT) maximizes engine power to the transmission.	
Transmission	ADMIRAL ⁷	
Drive System	Roller chain drive machined sprockets are spline-fit onto 1 3/8" diameter axles and are protected with triple-sealed greaseable bearings.	
Frame	Formed steel channel construction, welded for high strength and durability. Protected with Bondrite® M-PP 930™ epoxy-acrylic autodeposition coating.	
Body	Vacuum formed High Molecular Weight Polyethylene	
Full Skid Plate	Standard	
Load Capacity ¹	On Land	1,000 lb. (454 kg)
	On Water	900 lb. (410 kg)
Towing Capacity ²	1,800 lb. (816 kg)	
Seating Capacity ³	On Land	6 persons
	On Water	4 persons
Fuel Capacity	7.1 US gallons (27 litres) See-through polyethylene fuel tank. 8 hrs. operation ⁴	
Speed ⁵	On Land	25 mph (39.5 km per hour)
	On Water ⁶	3 mph (5 km per hour)
Shipping Weight	1470 lb. (676 kg)	
Dimensions (L X W X H)	124 x 60 x 52" (3,150 x 1,524 x 1,321 mm)	
Axle Bearing Extensions	Front - Standard, Rear - Standard	
Instrumentation	LCD Digital Gauge Cluster: Speedometer, Odometer, Voltmeter, Hour Meter, Tachometer, Low Oil Pressure and Parking Brake Reminder Lights	
Tires	ARGO AT189 25x12.00-9 NHS	
Ground Pressure	1.7 psi (13.5 kPa) using tires 0.67 psi (4.6 kPa) using tracks	
Ground Clearance	Tires	9.5" (240 mm)
	Tracks	11" (279 mm)
Operating Conditions	All weather, all terrain, -40°F to +104°F (-40°C to +40°C)	

The ARGO HuntMaster 8x8 builds on the ARGO 8x8 750 HDI platform to create a high powered go-anywhere package with practical detailing to enhance every hunting experience.

Standard vehicle features:

- Soft ride system with the new ultra-low-pressure tires on dual beadlock aluminum rims
- Robust brushguard provides outstanding protection for the front end of the vehicle, absorbing impacts from off-road hazards such as brush, branches, and more.
- 3,500 lb. (1,588 kg) WARN Winch
- Dual side entry steps to assist in vehicle entry and exit when outfitted with gear, backpack and guns
- Dual USB power outlet, for riders to charge their phones, play digital media and utilize their GPS
- Interior lighting package to illuminate front driving area, vehicle console and rear cargo area
- Bilge Pump

Included HuntMaster upgrades:

- Upgraded triple differential ADMIRAL steering transmission capable of reaching top-end speed of 25 mph (39.5 km/hr)
- Mounted two gun Sure Grip gun rack to ensure the safe transportation of firearms to the best hunting grounds
- Easily removable hood rack capable of carrying cargo, blinds and trophies to and from the hunt
- Upgraded front and rear seat cushions with a front seat backrest pad featuring refined stitching and custom embossing of the ARGO logo
- Heavy duty skid plate for added insurance against lower body damage
- Enhanced lighting package featuring dual high powered floodlights
- Brake lights

DIMENSIONS

Dimensions are approximate and dependent on final build specification.

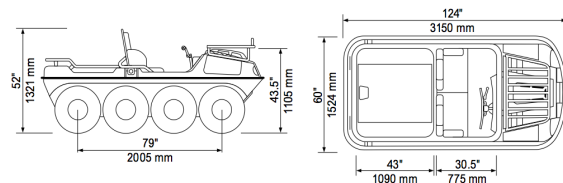

AVAILABLE ARGO COLOR

Colors are reproduced with great care, but may vary slightly on actual vehicles.

MOSSY OAK



INFINITY Camo™



ARGO North
Tel: +1.908-439-3002
363 COUNTY RD 513
CALIFON NJ 07830

- Capacity includes occupants, cargo, outboard motor and fuel, and installed accessories. Max. outboard motor size 7.4 kW (9.9 hp).
- Towing capacity is approximate and depends on type of surface, load on vehicle as well as incline. Max Hitch Tongue Load (when equipped with hitch) 100 lb. (45 kg) for all models
- Subject to rear compartment load capacity limitations.
- Fuel consumption depends on load and operating conditions.
- All speeds are approximate and depend on conditions.
- Always wear approved Personal Floatation Device (PFD) when operating in water or on ice.
- ADMIRAL triple differential steering transmission with dedicated Hi and Low selector; Forward, Neutral, Reverse.

Some vehicle applications shown are for demonstration purposes, originating from third parties and not available from ARGO. In all cases vehicle load limits have been considered. For safety, always wear approved helmets and eye protection. When operating in water, always wear approved Personal Floatation Devices. Always remain seated while in the ARGO. • Printed in Canada 03/2016



Safety!
...always in Season!

tread lightly!
 ON LAND AND WATER



Proud to be located in
**Canada's
 Technology
 Triangle**