



College of the Mainland Plan to Advance Student Success

***2018 COM Bond Advisory Committee
Meeting #3***

Tuesday, May 22

6:00 – 8:00 PM

College of the Mainland LRC 131



1. Facility Tour
2. Overview: COM Long Rang Facility Master Plan Alan Stilts, Architect
3. Overview: Bond Process + Initial Considerations Dr. Warren Nichols,
Alan Stilts
4. Questions & Answers

Overview
***COM Long Range
Facility Master Plan***

PRK

Alan Stilts, Architect



The image shows the cover and the first page of a '2016 FACILITY CONDITION ASSESSMENT' questionnaire for the College of the Mainland. The cover features the college's logo and the title '2016 FACILITY CONDITION ASSESSMENT' in large, bold letters. Below the title, it says 'Prepared By: PBK+'. The first page of the questionnaire is titled 'Student Center Condition Assessment Questionnaire' and includes a header with the college's logo. It contains a form with fields for 'Department', 'Contact Number', 'Department Contact Name', and 'E-mail'. The main section is titled 'I. SITE' and lists 15 questions about the site's condition, each with 'Yes' and 'No' checkboxes and a 'Comments' column. The questions cover topics such as flooding, parking, lighting, accessibility, and safety. At the bottom right of the page, it says 'Page 1 of 5'.

College of the Mainland
2016 FACILITY CONDITION ASSESSMENT

Prepared By: PBK+

Student Center Condition Assessment Questionnaire

Department: _____ Contact Number: _____
Department Contact Name: _____ E-mail: _____

I. SITE

	Yes	No	Comments
1. Does the site flood when it rains?	<input type="checkbox"/>	<input type="checkbox"/>	
2. Do the parking lots flood when it rains?	<input type="checkbox"/>	<input type="checkbox"/>	
3. Is the parking lot adequate in size?	<input type="checkbox"/>	<input type="checkbox"/>	
4. Is the parking lot lighted?	<input type="checkbox"/>	<input type="checkbox"/>	
Adequately?	<input type="checkbox"/>	<input type="checkbox"/>	
5. Is the site lighted?	<input type="checkbox"/>	<input type="checkbox"/>	
Adequately?	<input type="checkbox"/>	<input type="checkbox"/>	
6. Is the exterior around the building lighted?	<input type="checkbox"/>	<input type="checkbox"/>	
7. Is access to site adequate?	<input type="checkbox"/>	<input type="checkbox"/>	
8. Are instructional signs on the site adequate?	<input type="checkbox"/>	<input type="checkbox"/>	
9. Does the site have required disabled parking?	<input type="checkbox"/>	<input type="checkbox"/>	
10. Is there a fire protection (sprinkler) system?	<input type="checkbox"/>	<input type="checkbox"/>	
11. Are any concrete sidewalks cracking?	<input type="checkbox"/>	<input type="checkbox"/>	
12. Is the site landscaped?	<input type="checkbox"/>	<input type="checkbox"/>	
13. Does the irrigation system function adequately?	<input type="checkbox"/>	<input type="checkbox"/>	
14. Is access to site adequate?	<input type="checkbox"/>	<input type="checkbox"/>	
15. Are there any safety issues that need to be addressed?	<input type="checkbox"/>	<input type="checkbox"/>	

Page 1 of 5

Campus Questionnaires

On-Site Investigations

Facility Performance Report

Financial Analysis & Prioritization for:

- ✓ Educational Adequacy
- ✓ Capacity Study (Facility Optimization)
- ✓ Code Violations
- ✓ Life Safety and Security Deficiencies
- ✓ Life-Cycle Renewal Requirements
- ✓ Technology
- ✓ Energy and Sustainability ("Green")
- ✓ Web Based Data Management
- ✓ Preventative Maintenance Program
- ✓ Training and Support



Current Projects

- New Metal Storage Building
- PE Building Renovation
- Student Center Renovation
- Chemistry Lab Renovation
- Fine Arts Roof Replacement
- Campus-Wide Underground Utilities Replacement

Future Bond Projects







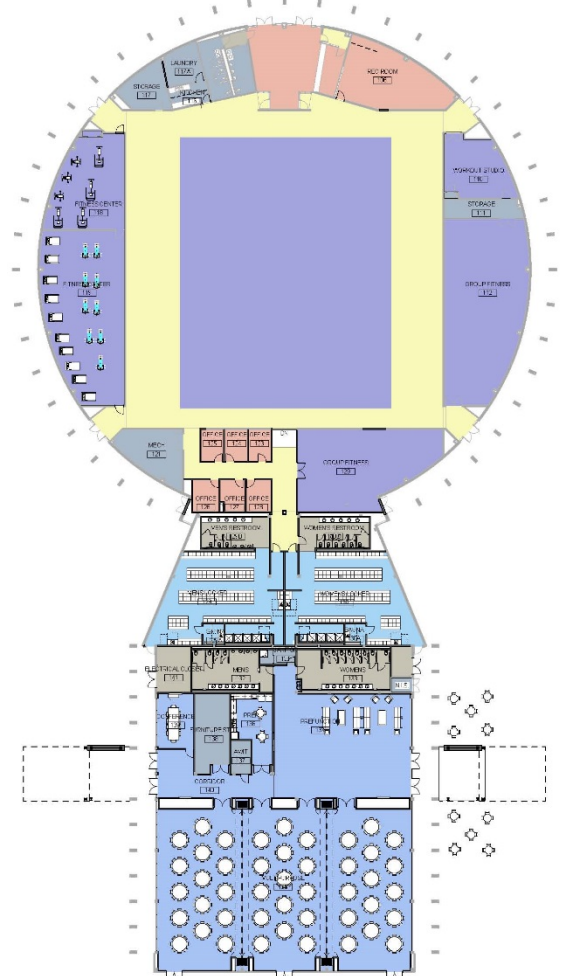
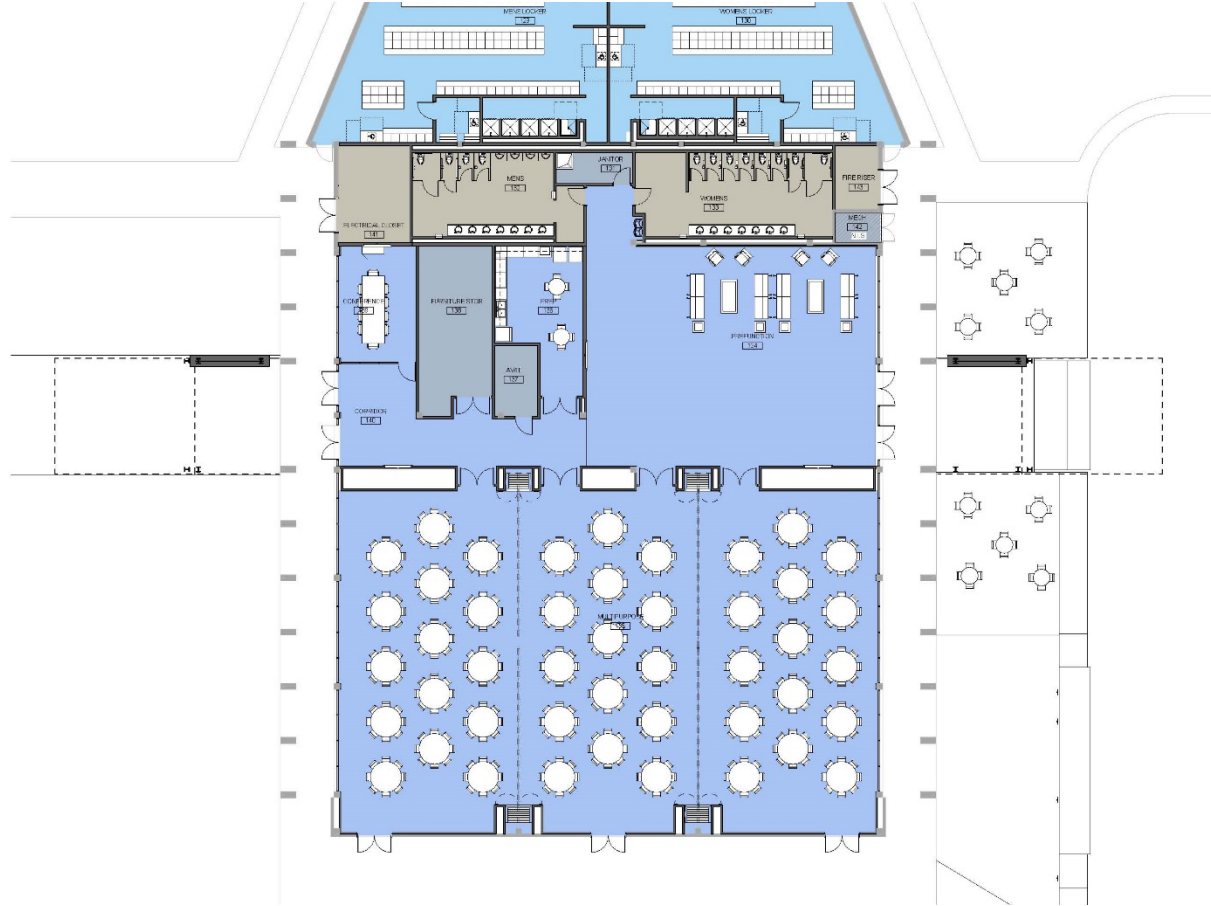
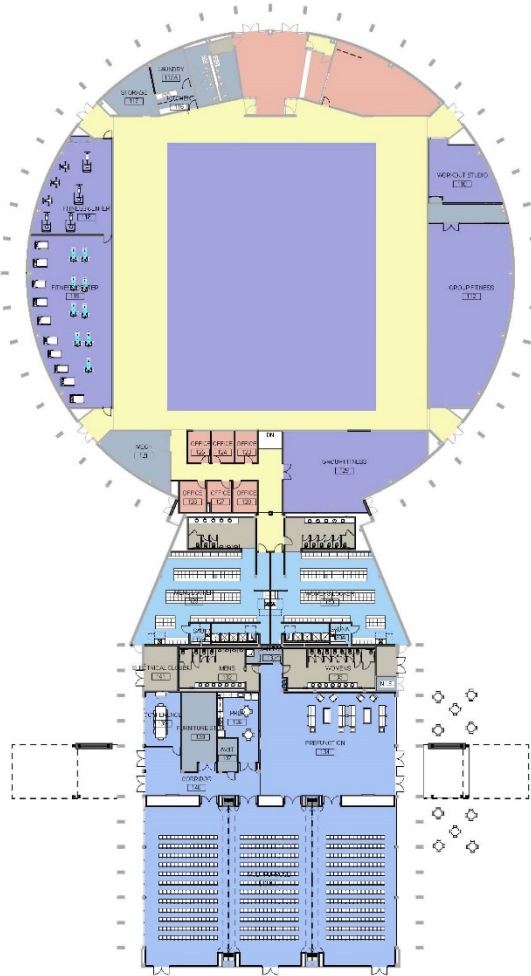



























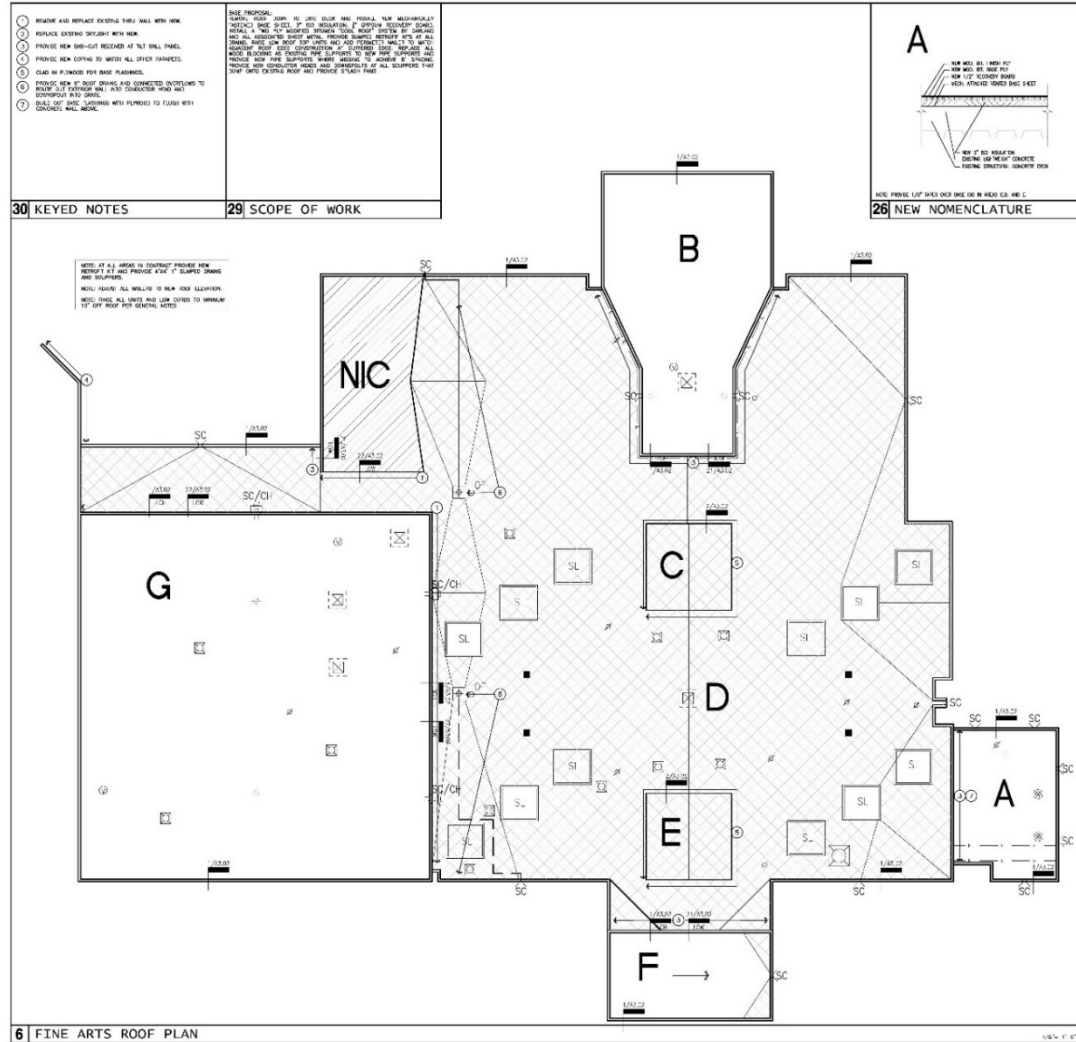

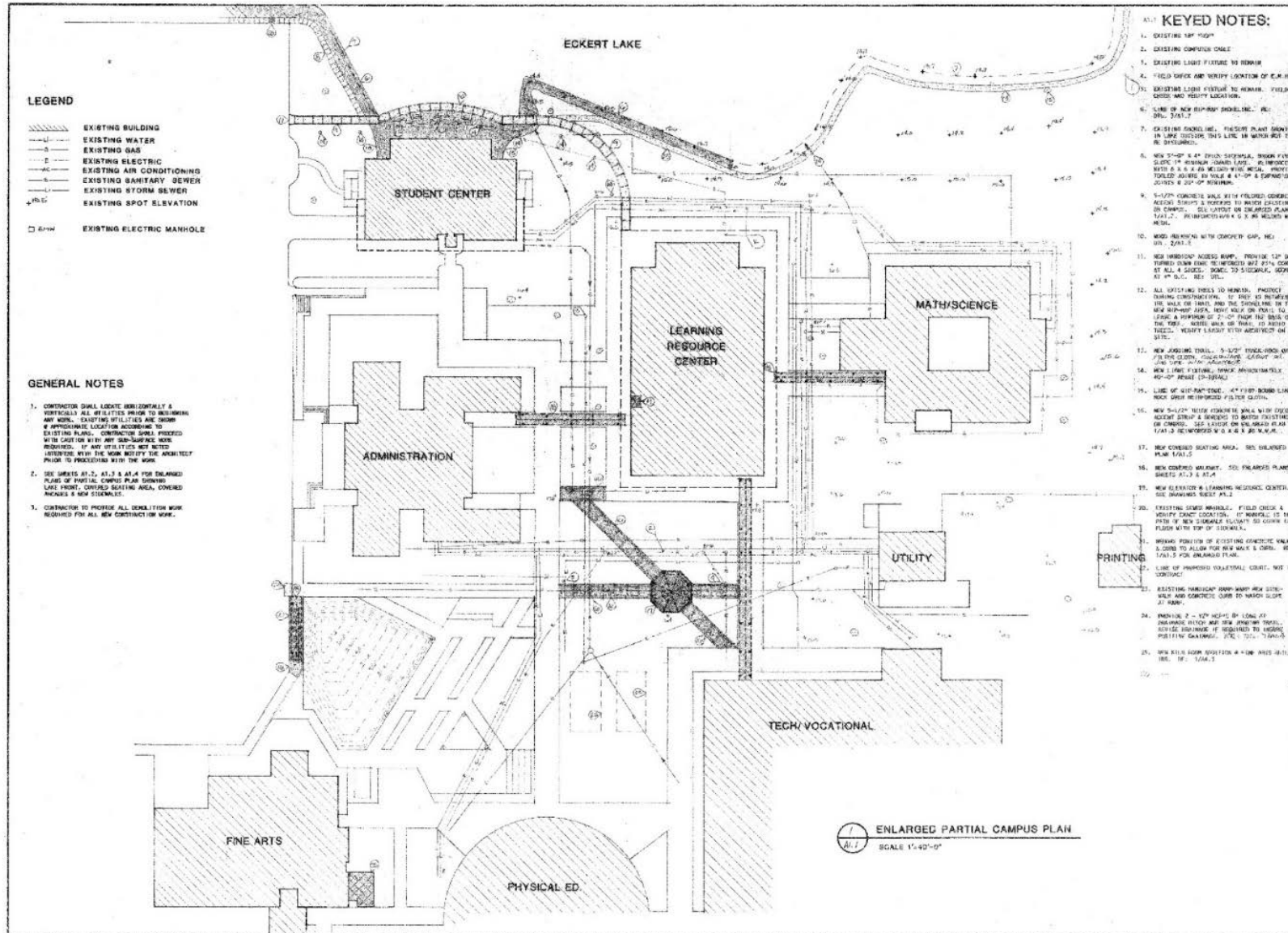





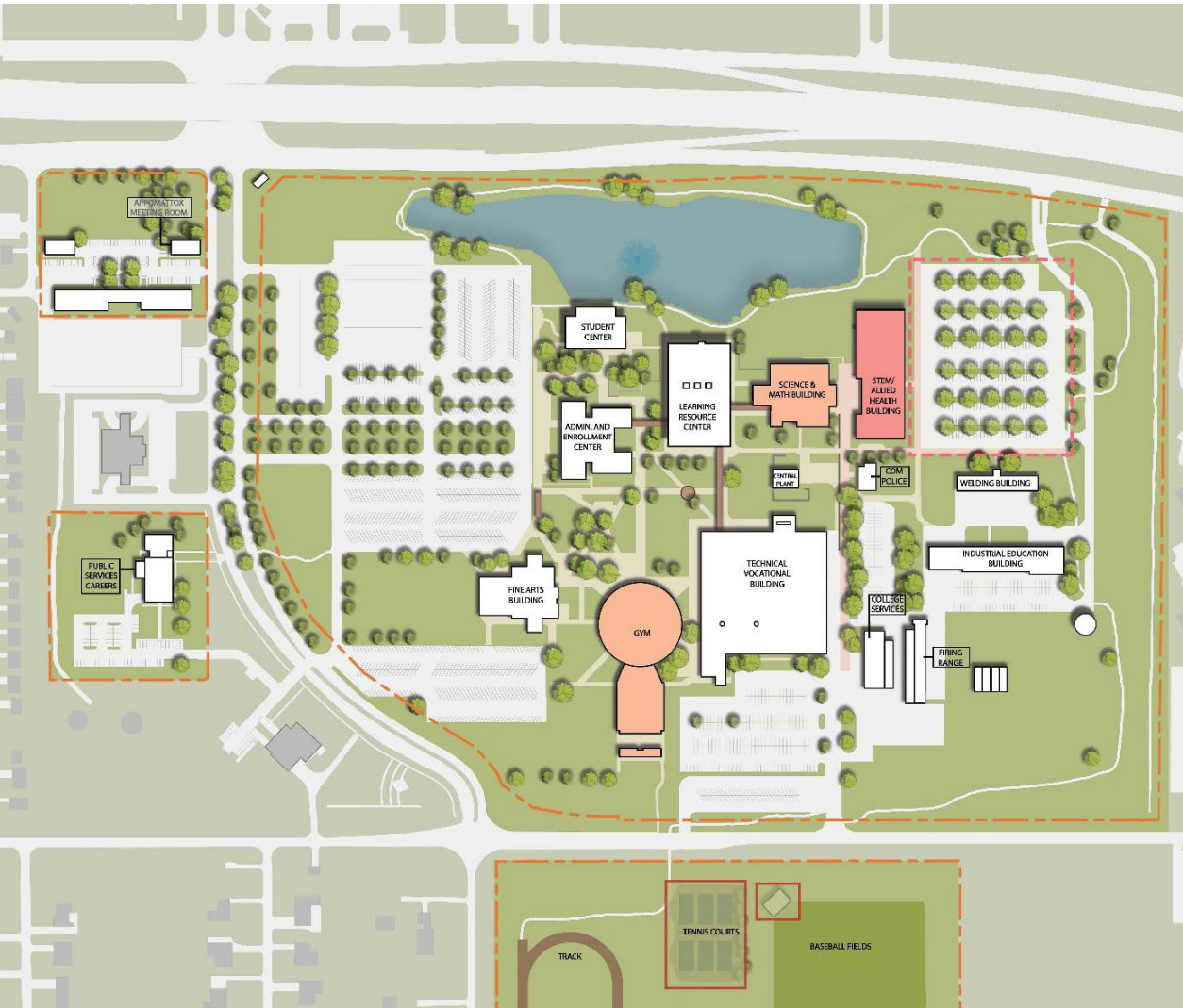

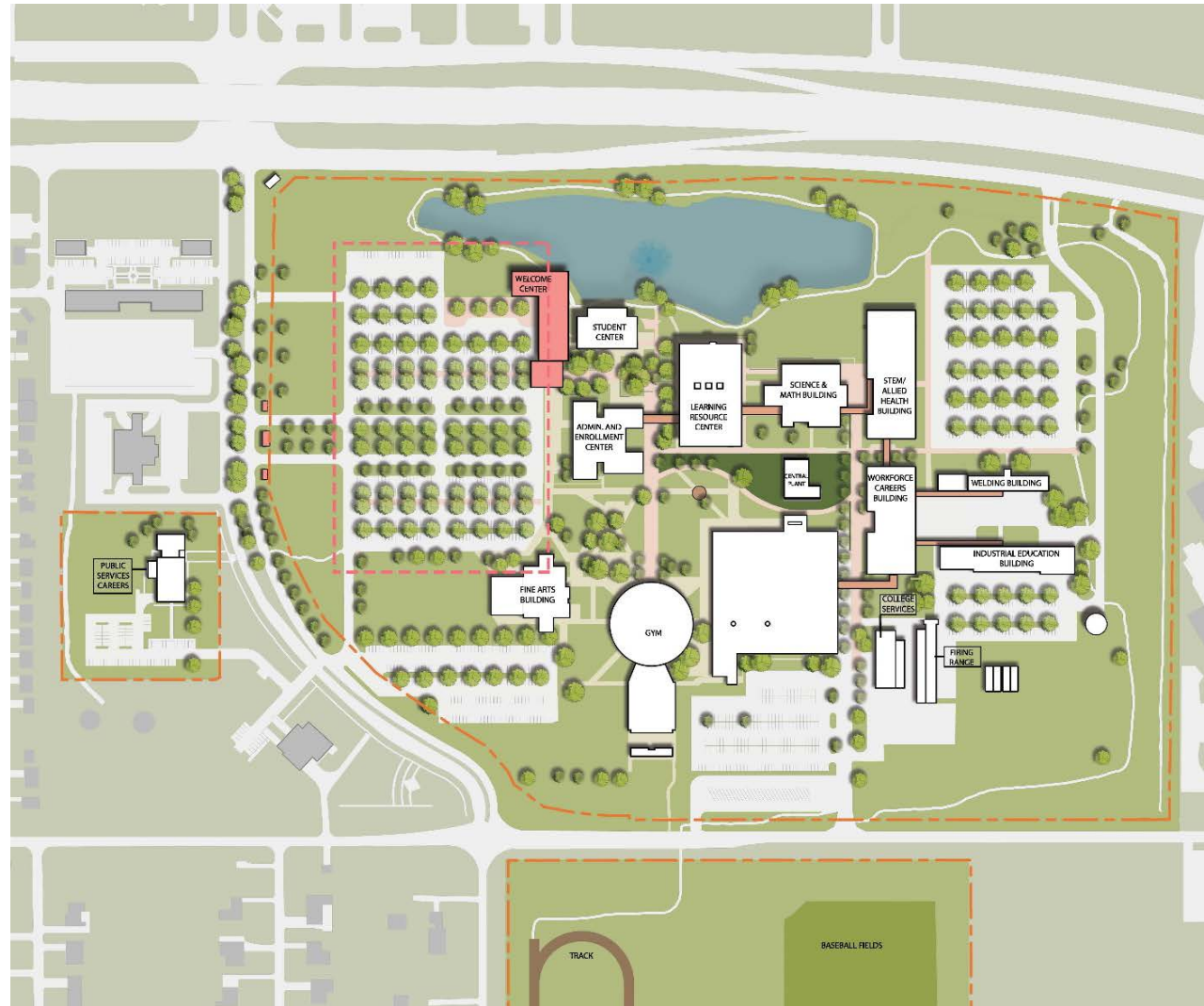
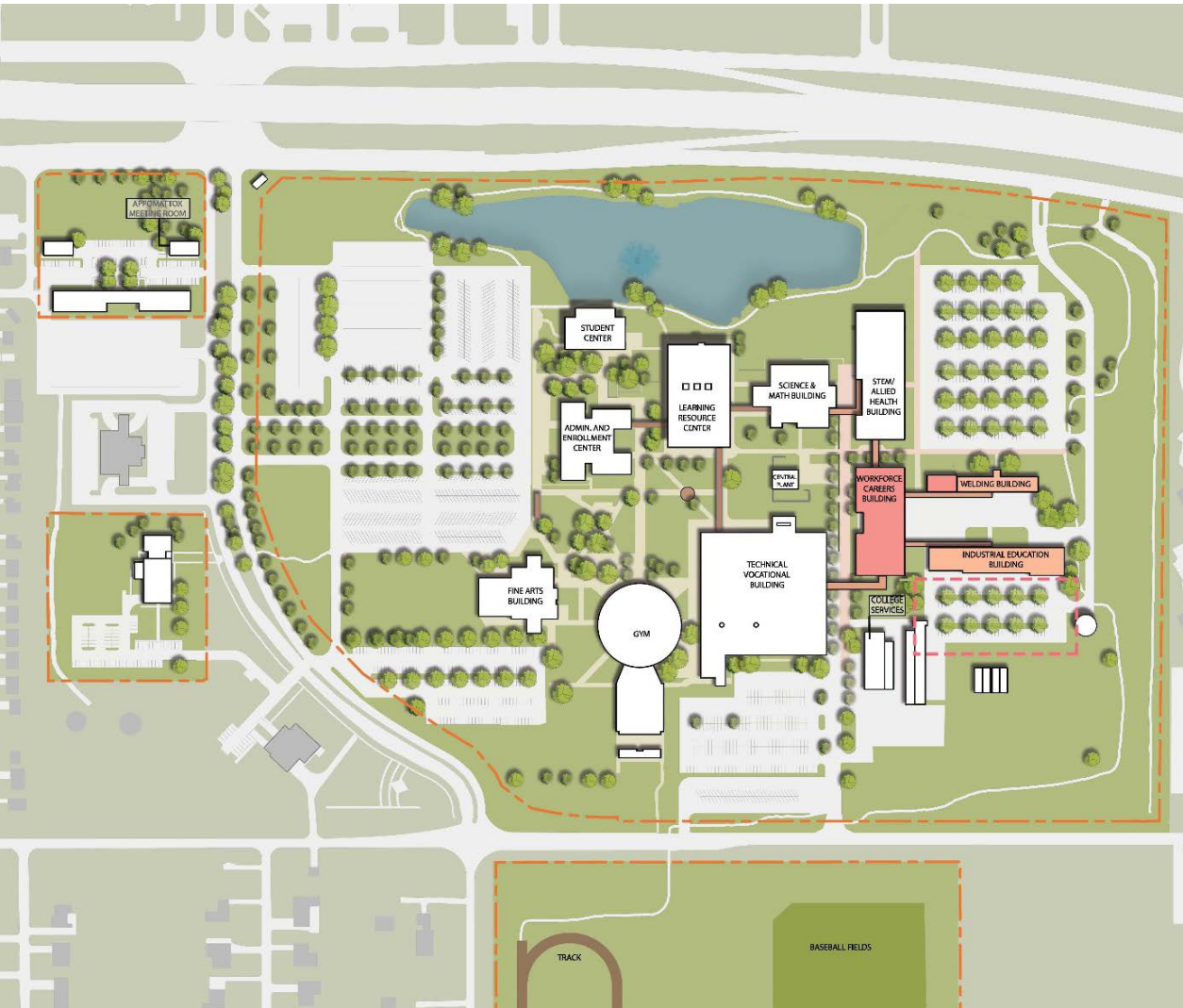

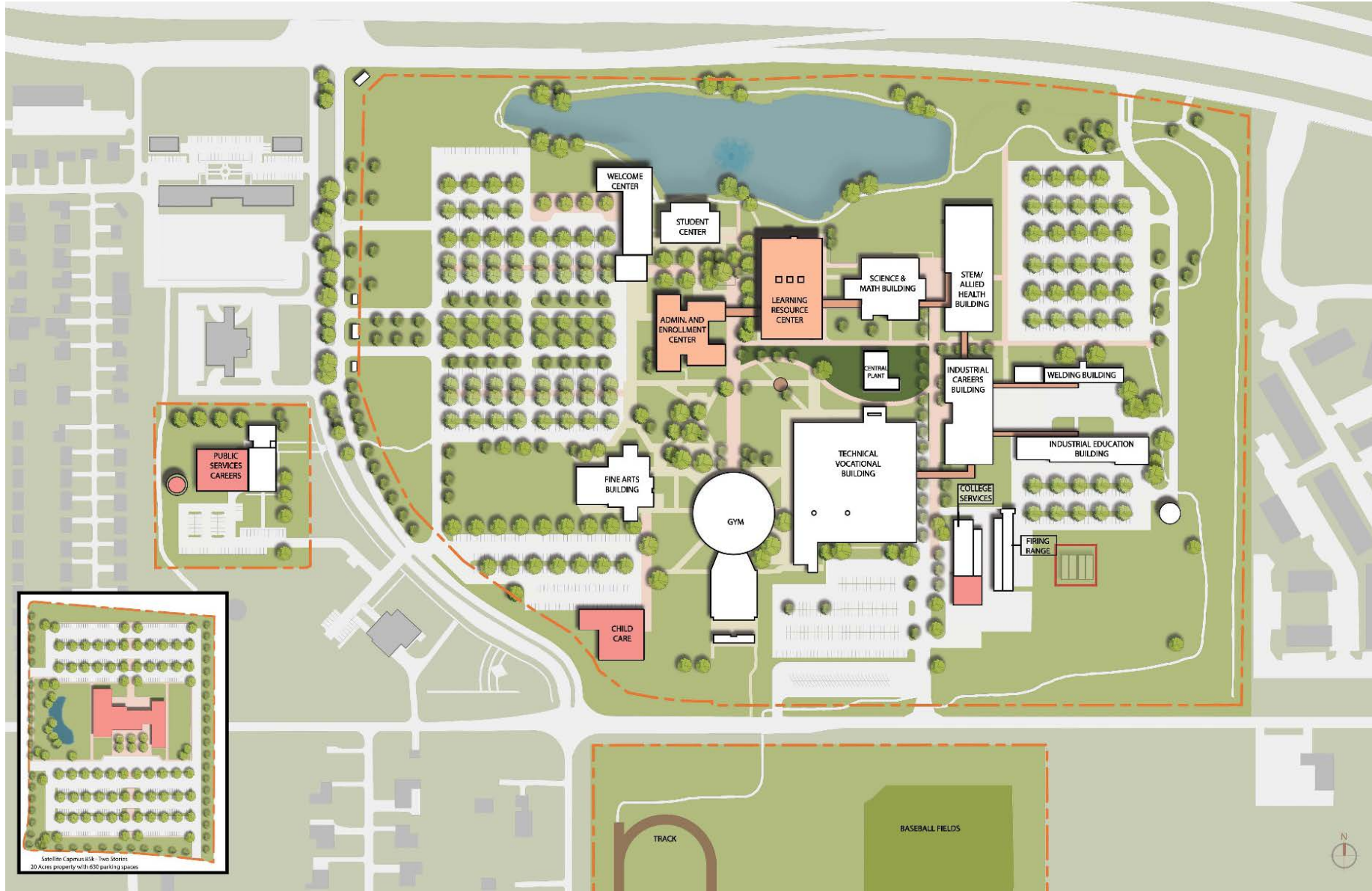

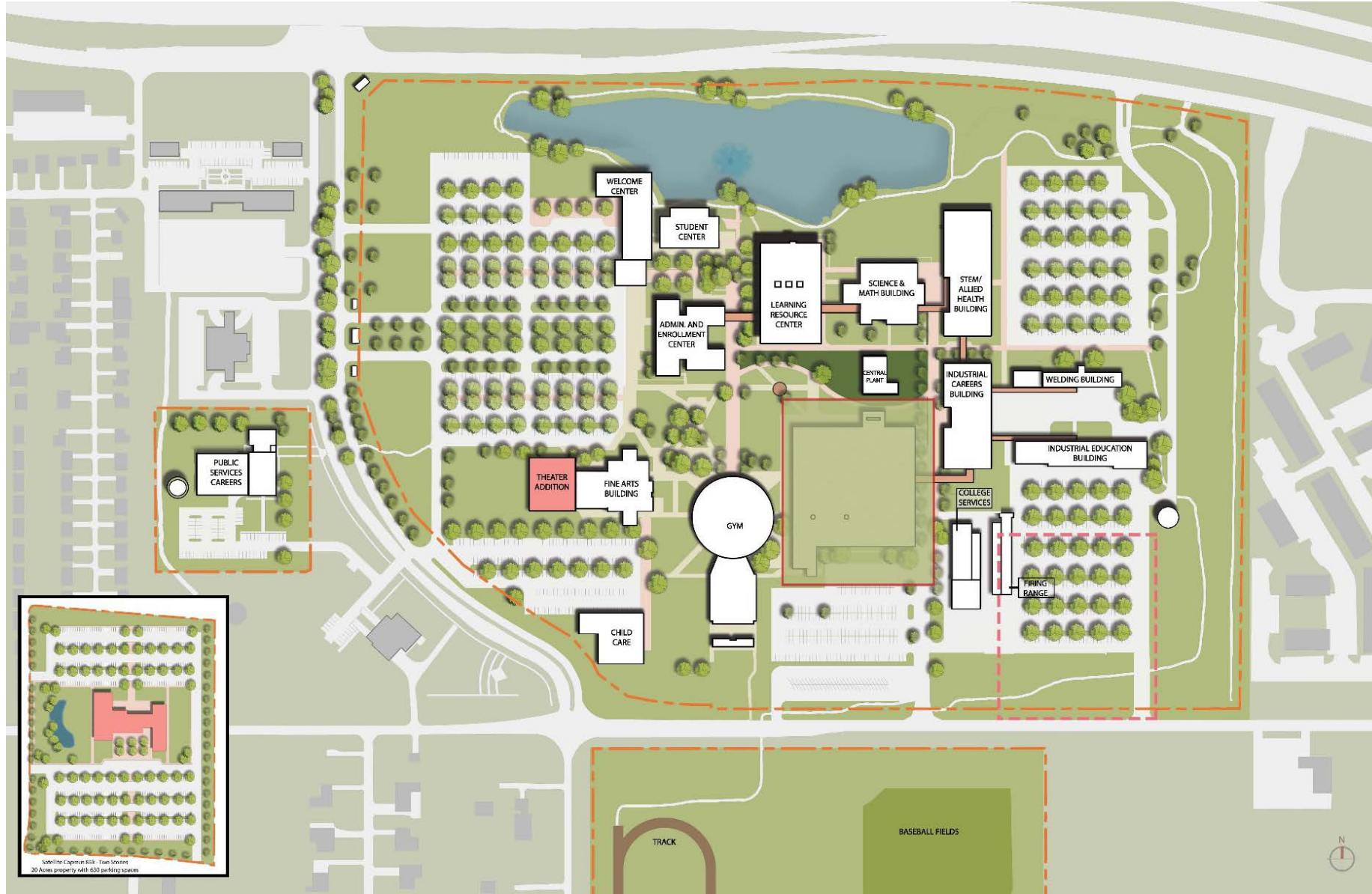

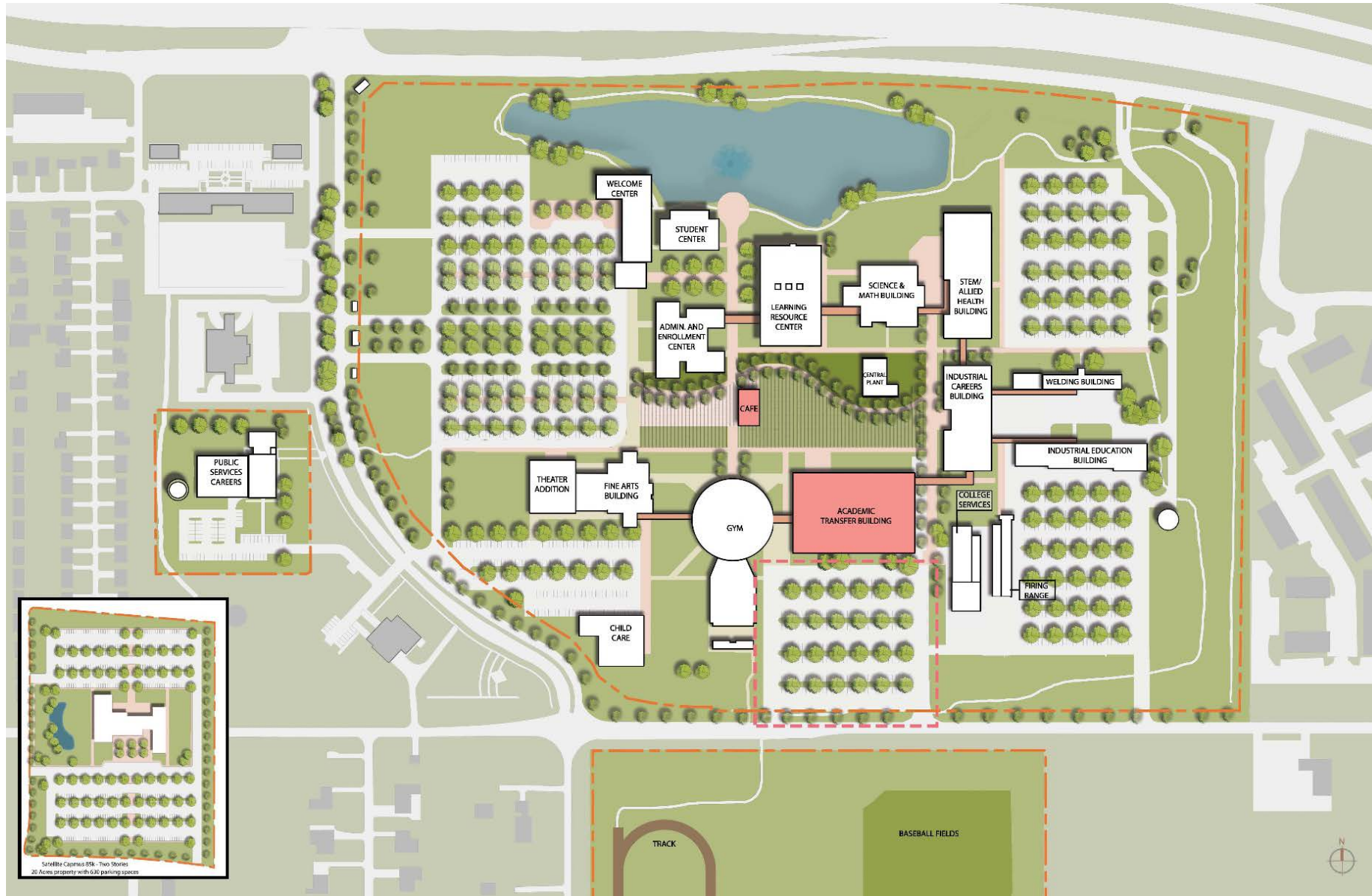



Overview

Bond Process + Initial Considerations

***Dr. Warren Nichols,
Alan Stilts, Architect***



Building the 2018 Bond

Collaborative process between architect, COM administration, stakeholders and end-users.

Initial project considerations determined by reviewing:

- ✓ College Needs
- ✓ 2018 Academic Master Plan
- ✓ Required Priority Maintenance Items

NEW BUILDS	New STEM / Allied Health Building
	New Industrial Careers Building
	New Student Success Building
ADDITION + RENOVATION	Physical Plant Expansion
	Fine Arts Building Theater Addition and Renovation
	Life Cycle and Technology Upgrades
	2016 Maintenance Tax Note and Fund Balance Project Repayment
DEMO	Police Station Demolition
	Tech Voc Building Demolition
	Administration and Enrollment Center Demolition

Potential Bond Amounts

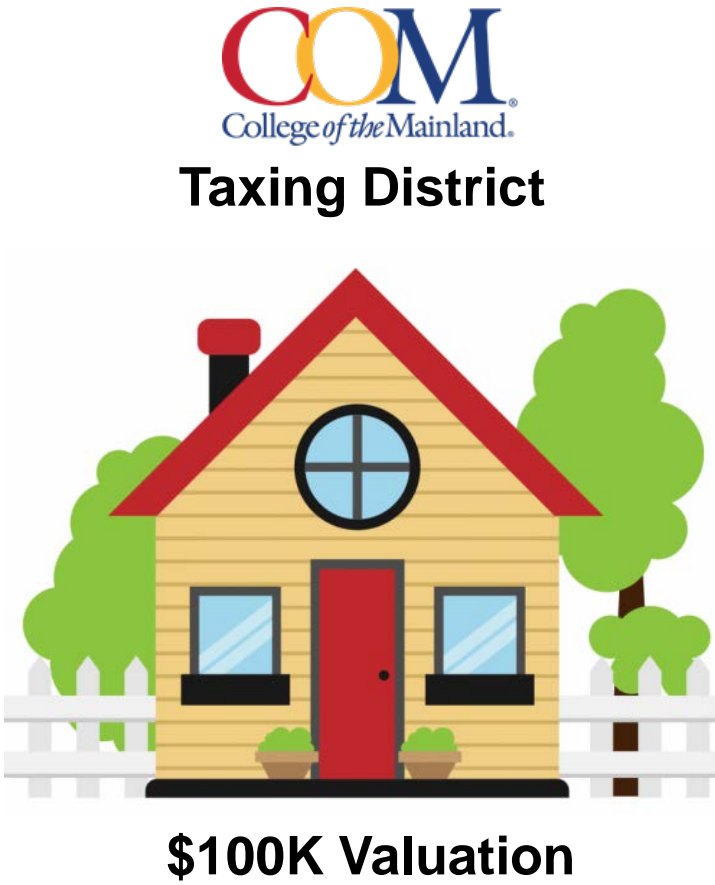

COMPASS

College of the Mainland Plan to Advance Student Success

Thank You!