



- ① LIVING ROOM - 12'-6" x 16'-5"
- ② COATS
- ③ KITCHEN - 11'-0" x 12'-6"
- ④ CLOSET - 2'-0" x 4'-11"
- ⑤ BEDROOM 2 - 13'-5" x 9'-6"
- ⑥ BEDROOM - 10'-0" x 11'-11"
- ⑦ CLOSET - 3'-0" x 6'-1"
- ⑧ HALLWAY
- ⑨ BATH - 6'-0" x 9'-5"

NOTE: DIMENSIONS MAY VARY FROM UNIT TO UNIT

Will Rogers Lofts
 Claremore, Oklahoma
 Units 401/501 Similar
 2-BR Units - 789 sf

- ① ENTRY
- ② STORAGE
- ③ KITCHEN - 9'-1" x 7'-6"
- ④ COATS
- ⑤ LIVING ROOM - 15'-6" x 11'-4"
- ⑥ CLOSET - 2'-0" x 4'-0"
- ⑦ BEDROOM - 11'-10" x 10'-9"
- ⑧ BATH - 13'-2" x 5'-0"
- ⑨ HALLWAY



NOTE: DIMENSIONS MAY VARY FROM UNIT TO UNIT

Will Rogers Lofts
 Claremore, Oklahoma
 Units 402/502 Similar
 1-BR Units - 624 sf

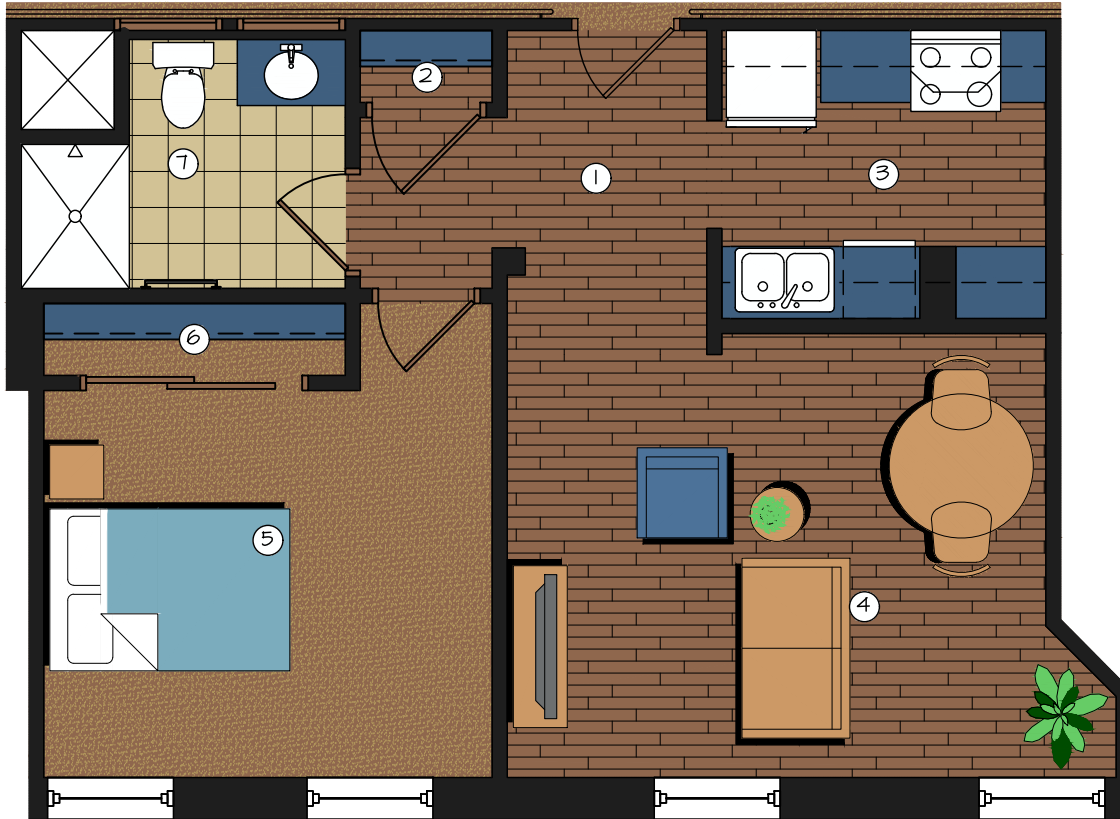

- ① HALLWAY
- ② COATS
- ③ KITCHEN - 9'-0" x 8'-0"
- ④ LIVING ROOM - 12'-4" x 16'-11"
- ⑤ BEDROOM - 12'-5" x 13'-2"
- ⑥ CLOSET - 8'-4" x 2'-0"
- ⑦ BATH - 9'-0" x 6'-11"

NOTE: DIMENSIONS MAY VARY FROM UNIT TO UNIT

Will Rogers Lofts
 Claremore, Oklahoma
 Units 404/504
 1-BR Units - 752 sf



- ① HALLWAY
- ② COATS
- ③ KITCHEN - 12'-11" x 10'-9"
- ④ LIVING ROOM - 14'-4" x 12'-1"
- ⑤ BEDROOM - 11'-0" x 11'-11"
- ⑥ CLOSET - 2'-0" x 7'-1"
- ⑦ BATH - 9'-0" x 5'-10"
- ⑧ STORAGE

NOTE: DIMENSIONS MAY VARY FROM UNIT TO UNIT

Will Rogers Lofts
 Claremore, Oklahoma
 Units 406/506
 1-BR Units - 597 sf



- ① ENTRY
- ② COATS
- ③ KITCHEN - 10'-3" x 7'-6"
- ④ LIVING ROOM - 13'-8" x 17'-6"
- ⑤ BEDROOM - 12'-0" x 10'-3"
- ⑥ CLOSET - 4'-5" x 3'-8"
- ⑦ BATH - 5'-10" x 9'-0"
- ⑧ STORAGE
- ⑨ HALLWAY

NOTE: DIMENSIONS MAY VARY FROM UNIT TO UNIT

Will Rogers Lofts
 Claremore, Oklahoma
 Units 410/510
 1-BR Units - 568 sf

- ① LIVING ROOM - 17'-5" x 12'-6"
- ② COATS
- ③ KITCHEN - 8'-0" x 8'-9"
- ④ BATH - 6'-0" x 8'-4"
- ⑤ STORAGE
- ⑥ CLOSET - 6'-5" x 2'-0"
- ⑦ BEDROOM - 10'-0" x 10'-1"
- ⑧ HALLWAY

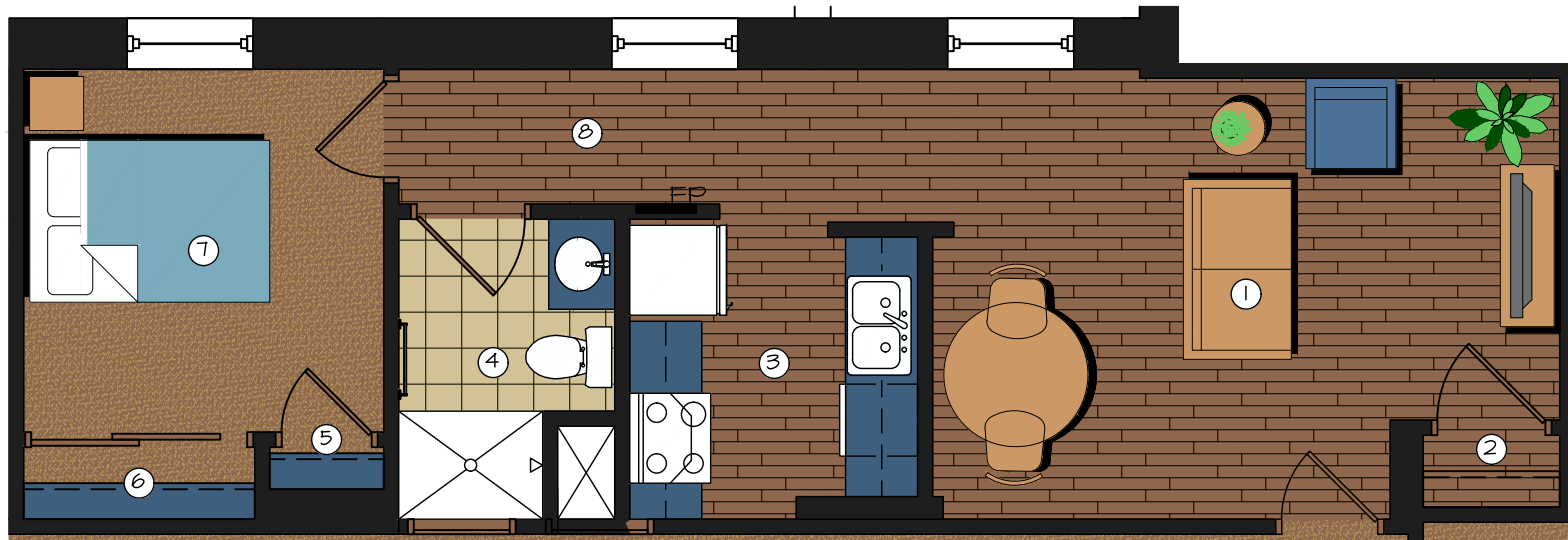

NOTE: DIMENSIONS MAY VARY FROM UNIT TO UNIT

Will Rogers Lofts
 Claremore, Oklahoma
 Units 411/511
 1-BR Units - 605 sf



- ① ENTRY
- ② COATS
- ③ KITCHEN - 8'-0" x 9'-10"
- ④ LIVING ROOM - 14'-3" x 12'-6"
- ⑤ BATH - 9'-0" x 5'-11"
- ⑥ CLOSET - 10'-0" x 2'-0"
- ⑦ BEDROOM - 12'-1" x 10'-0"
- ⑧ HALLWAY

NOTE: DIMENSIONS MAY VARY FROM UNIT TO UNIT

Will Rogers Lofts
 Claremore, Oklahoma
 Units 412/512
 1-BR Units - 656 sf

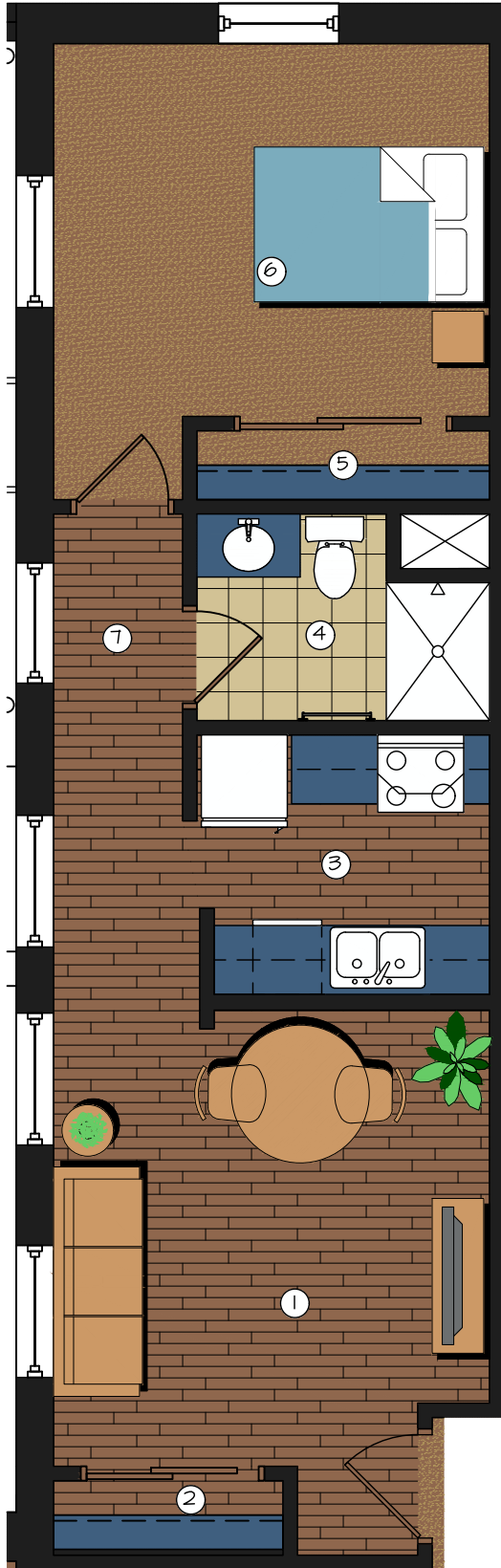

- ① LIVING ROOM - 12'-8" x 15'-10"
- ② COATS
- ③ KITCHEN - 8'-11" x 7'-6"
- ④ BATH - 8'-6" x 6'-0"
- ⑤ CLOSET - 8'-6" x 2'-0"
- ⑥ BEDROOM - 13'-3" x 12'-8"
- ⑦ HALLWAY

NOTE: DIMENSIONS MAY VARY FROM UNIT TO UNIT

Will Rodgers Lofts
 Claremore, Oklahoma
 Unit 413/ Unit 513
 1-BR Units - 627 sf

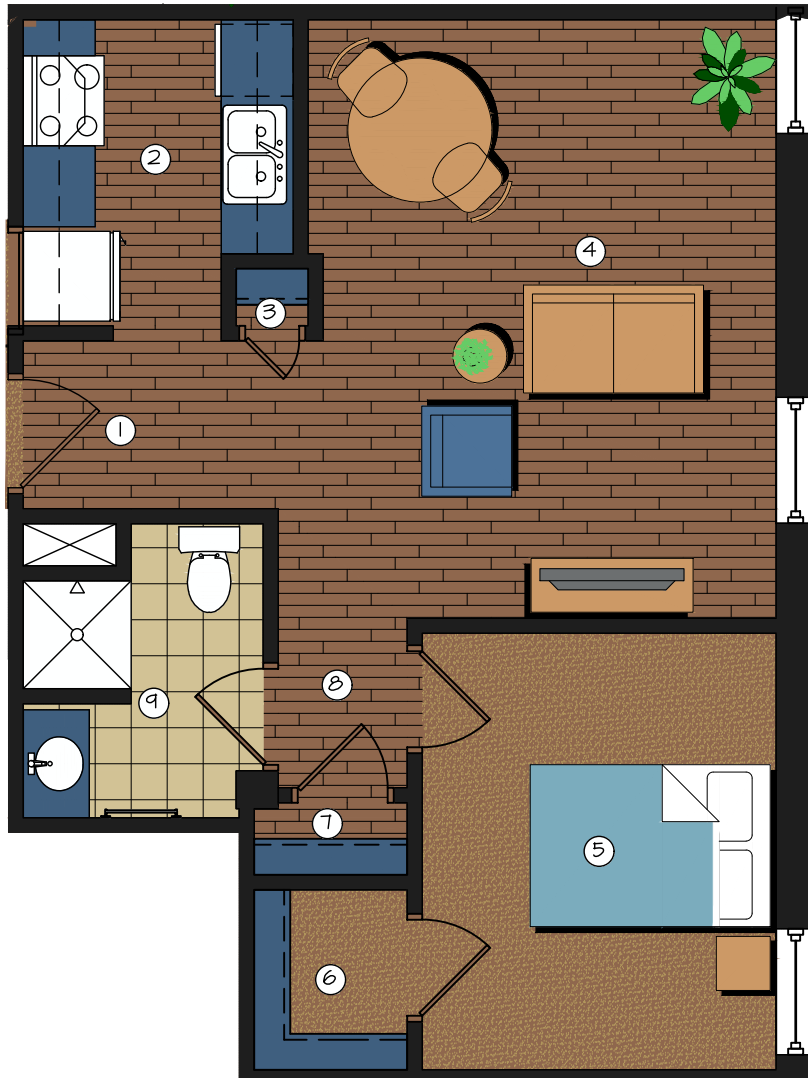

- ① ENTRY
- ② KITCHEN - 7'-6" x 8'-6"
- ③ COATS
- ④ LIVING ROOM - 20'-11" x 16'-7"
- ⑤ BEDROOM - 9'-10" x 12'-2"
- ⑥ CLOSET - 4'-3" x 5'-0"
- ⑦ STORAGE
- ⑧ HALLWAY
- ⑨ BATH - 8'-2" x 6'-8"

NOTE: DIMENSIONS MAY VARY FROM UNIT TO UNIT

Will Rogers Lofts
 Claremore, Oklahoma
 Units 414/514
 1-BR Units - 565 sf



- ① ENTRY
- ② COATS
- ③ KITCHEN - X'-X" x X'-X"
- ④ LIVING ROOM - 18'-0" x 11'-5"
- ⑤ BEDROOM - 9'-11" x 13'-3"
- ⑥ CLOSET - 2'-0" x 5'-5"
- ⑦ STORAGE
- ⑧ BATH - 7'-10" x 8'-9"
- ⑨ HALLWAY

NOTE: DIMENSIONS MAY VARY FROM UNIT TO UNIT

Will Rogers Lofts
 Claremore, Oklahoma
 Units 415/515
 1-BR Units - 640 sf