

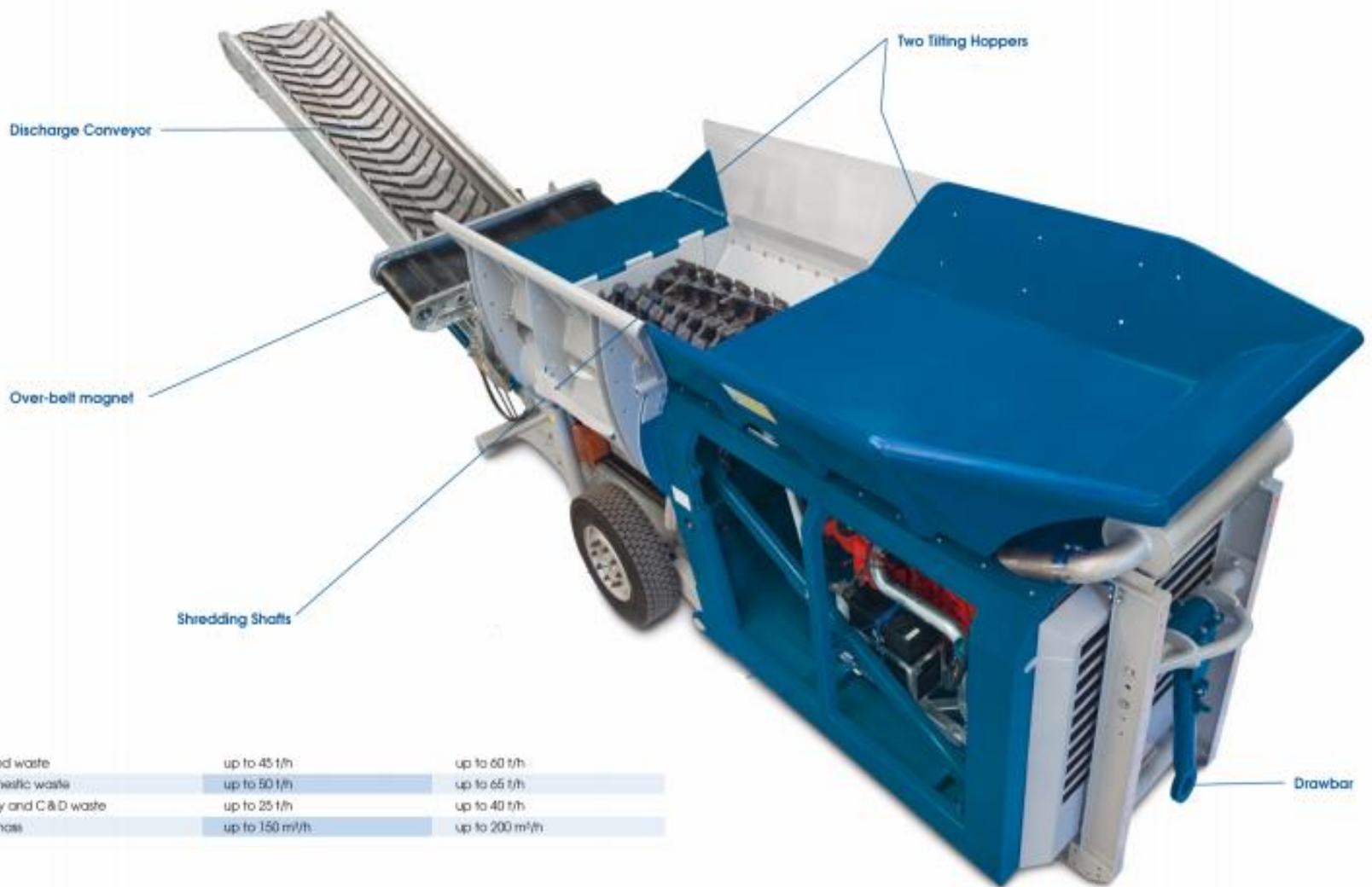

1. **Refractory Unit @1MW**
 - includes Thermal Pipe to Boiler
2. **Boiler @900PSI x 900 Deg/F @Closed Loop System Basis**
 - includes Connection to Steam Generator
3. **Water Filtration System**
4. **Steam Generator @1MW**
 - includes Harmonic Control
5. **Controls Systems**
 - includes Electrical for Inputted, Flows, and Outputted
6. **Systems Wirings**
 - includes for Fuses and Circuit Breakers
7. **SwitchGear Systems**
 - includes for Conversions with/to Local Systems
8. **Transformer**
 - includes for Wiring/Systems for/to Steam Generator
9. **Propane Tank Systems**
 - includes for StandBy Tank and Initial Igniters for Systems
10. **Natural Gas Connection – if Available/Preferred**
11. **Shipment ex-Factory(s) Included**
12. **Insurance for/to Owners Included**
13. **Set-Up/Assembly @Site(s) Included**
14. **Training and Ramping @Sites Included**



BIO-MASS

- » Modular design for your individual requirements.
- » High throughput capacity of up to 60 tons per hour at low energy consumption.





WOOD WASTE A1-A4

Demolition wood pallets,
chipboard, cable drums,
railway sleepers



BIOMASS

Green waste rootstock, log
wood, palms, animal
manure, silo bales, grass
cuttings



WASTE

Domestic waste, organic
waste, plastics, PVC



COMMERCIAL WASTE

Bulky waste, C&D waste,
paper rolls, tar boards,
mixed construction waste



METAL & LIGHT SCRAP

Electric and electronic scrap,
alu scrap and alu housings



TIRES

Passenger car, truck
and tractor tires



ENERGY EFFICIENT AND MAINTENANCE -FRIENDLY







High Productivity and Economical Operations

WASTE TO FUEL

Shredding Technology for the Production of Alternative Fuels

Processing of domestic, commercial and industrial waste, residual and bulk waste, wood, paper, board materials, bundles, rubber, foam materials and other for the production of alternative fuels for cement and industrial power plants, waste management.



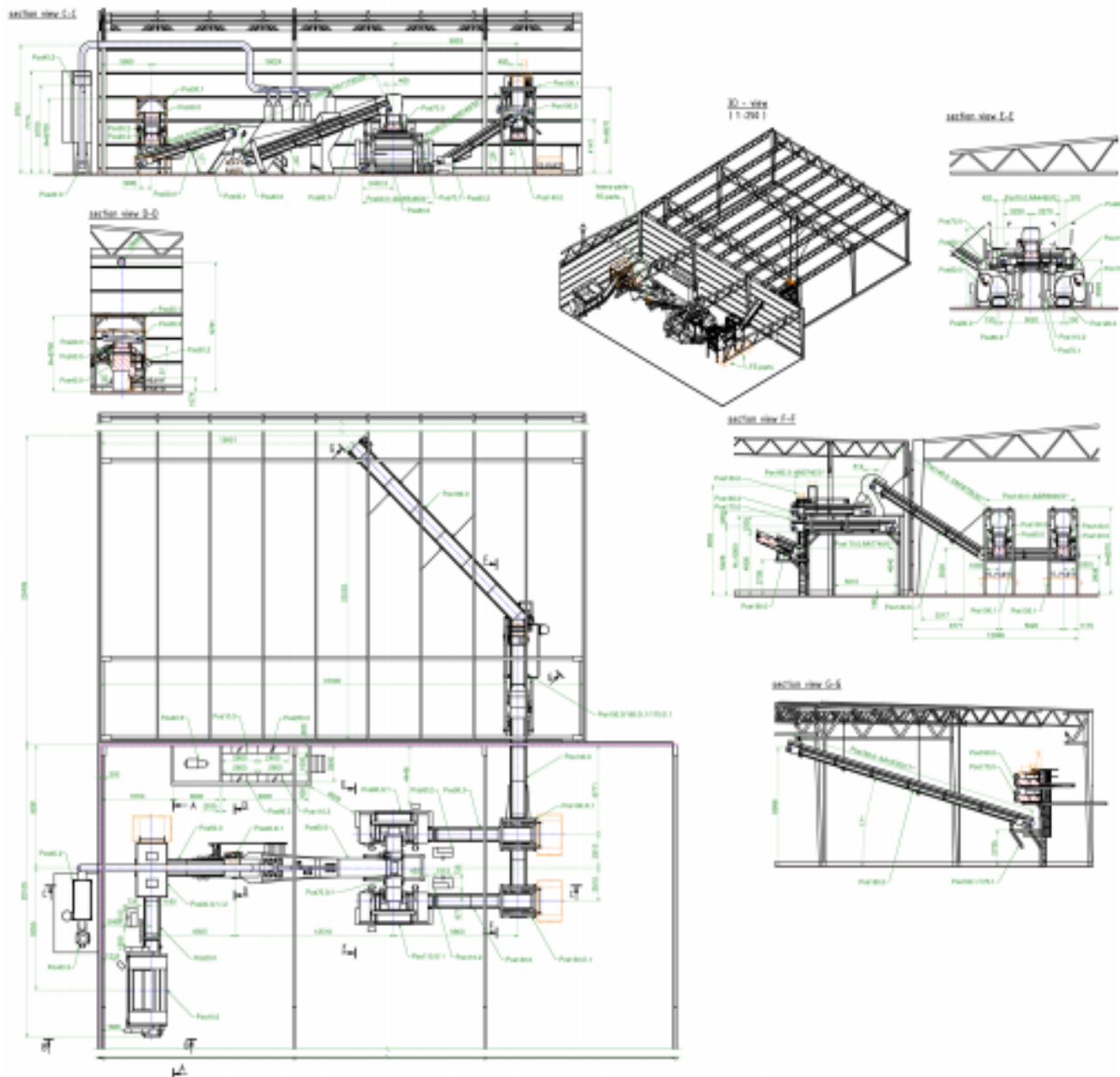

EQUIPMENT

Chipping maximum diameter (soft wood): 400mm
Chipping maximum diameter (hard wood): 300 mm
Drum chipper width: 950 mm
Drum chipper diameter: 660 mm
Number of blades: 4

Collecting screw for recovering lost material between the chain and the comb during chipping

Inferior chain length: 2300 mm

Lower intake chain width: 950 mm

Upper intake roller width: 950 mm

Inlet maximum passage: 950 x 600 mm

Hydraulic independent system

Electronic controller with LCD display for

No Stress and all functions

Transmission with V belts

Hydraulic rotating discharge pipe: 270°

Interchangeable output sieve for the chips size calibration

Production per hour: 60 ÷ 70 cubic metres

Static machine to be mounted on truck, trailer or set on the ground, JOHN DEERE

6068HFU-A18, 6 cylinders, 6,8 litres, 156 kW, 205 hp, 97 Kgm; Stage III A, constant speed, EU 97/68 CE compliant, Tandem axle trailer for low speed (boogie axles)

EU 98/68 CE compliant

CRANE EQUIPMENT

Activation by tractor hydraulics, the assembling includes the logs grapple and the support for the grapple.

IB4800.L68 Icarbazzoli crane, outreach 6,8 m, with 1 seat and hydraulic controls, with no. 2 type "+" cloches and nr. 2 pedal controls, logs grapple opening: 1,2 m with open teeth (without hydraulic stabilizers)

IB-CAB Cabin next to the column (on the left 1 side), not lifting, with low pressure, hydraulic control, comfort guide seat, security devices, Lengthening of chassis, rear mounted crane 1 supporting flange on 3-points linkage, or front mounted on 3-points linkage without intermediate cardan shaft Pantograph hydraulic stabilizers for crane, 1 assembled on the frame of the machine

BLADE SHARPENING EQUIPMENT

I12PA Robotic Sharpening System

Basic Spare Parts plus 4-spare blades