

Weathervane Block

SKILL LEVEL
CONFIDENT BEGINNER

Finished Block Size
12" x 12"

Cutting Instructions
(cut in order listed)

Lime solid
4 squares $2\frac{7}{8}$ " x $2\frac{7}{8}$ "
12 squares $2\frac{1}{2}$ " x $2\frac{1}{2}$ "

Red solid
1 square $4\frac{1}{2}$ " x $4\frac{1}{2}$ "
4 squares $2\frac{7}{8}$ " x $2\frac{7}{8}$ "
4 squares $2\frac{1}{2}$ " x $2\frac{1}{2}$ "

Blue solid
4 squares $4\frac{1}{2}$ " x $4\frac{1}{2}$ "

Piecing the Block

1 Draw diagonal line on wrong side of lime $2\frac{7}{8}$ " square. Place marked square on red $2\frac{7}{8}$ " square, right sides together (**Diagram I**). Sew $\frac{1}{4}$ " seam on each side of marked line; cut apart on marked line. Open and press to make 2 pieced squares. Make 8.

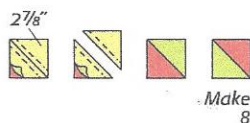

Diagram I

2 Sew together 1 each lime and red $2\frac{1}{2}$ " squares and 2 pieced squares to make corner unit (**Diagram II**). Make 4.

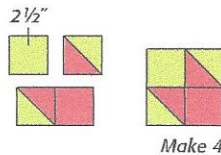

Diagram II

3 Draw diagonal line on wrong side of lime $2\frac{1}{2}$ " square. Place marked square on blue $4\frac{1}{2}$ " square, right sides together, aligning raw edges (**Diagram III**). Sew on marked line; trim away and discard excess fabric. Open and press. In same manner, add lime square to adjacent corner to make edge unit. Make 4.

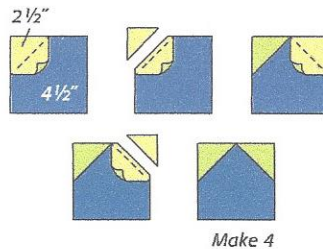

Diagram III

4 Referring to **Diagram IV**, sew 3 rows using 4 corner units, 4 edge units, and red $4\frac{1}{2}$ " square. Sew rows together to make Weathervane Block.

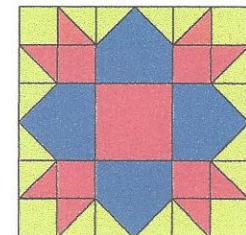
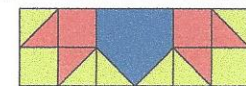

Diagram IV