

SOF₂O Series[®]

Clear Defender

Clear Water
Saves You
Money



Clear Defender-100 Series Birm Filter

Save

With increased water heater efficiency.
On soap for kitchen, bath, and laundry.
On shampoo, conditioners, and lotions.
With less plumbing repairs and supplies.
On household cleaning time.

Benefits:

- Effective, Efficient, and Eco-Friendly.
- Reduces Iron and Manganese in your water.
- Reduces objectionable smells (hydrogen sulfide.)
- Cleaner, better tasting water from every tap, faucet, and water-using appliance.
- Increases the life of your plumbing fixtures, and water using appliances.
- Reduces staining of fixtures, clothing, and hair.

System Features:

- **High Flow System** is ideal for supplying more water with less pressure loss.
- **Permanent System Memory** with no battery needed or required during power outage.
- **Solid State Controller** provides detailed diagnostics like total gallons, average daily use, flow rate, and is easily programmed to match your family's water needs.
- **Fewer Moving Parts** means easy maintenance.
- **Safe Low Voltage Power** uses less than a penny a day in electricity.
- May be used in conjunction with chemical and air injection.



Specialty Water Systems
609 Stafford Lane North, Dundas, MN 55019
Phone (507) 645-6076 • Fax (507) 645-4007
www.SOF2O.com • Info@MidwestWater.com

Clear Defender-100 Series Birm Filter

BACKWASH SYSTEM	100EEBFA125	100EEBFA175	100EEBFA200
BACKWASH ONLY SYSTEM (D)	100EDBF125	100EDBF175	100EDBF200
Birm Media	1.25	1.75	2.0
Backwash Drain Flow	5	6.5	7.5
Service Flow (b)	5	7	10
Water Hardness Range GPG	NA	NA	NA
Maximum Iron (ppm) (a)	5	7	10
Water Pressure Min/Max PSI	25-100	25-100	25-100
Min/Max Water Temp Range F	40°-100°	40°-100°	40°-100°
Electrical Requirement (Volt/Hz)	110-50/60	110-50/60	110-50/60
Plumbing Options	3/4"-1"	3/4"-1"	3/4"-1"

- (a) Iron reduction will vary depending on type of iron, pH, and other local conditions.
- (b) Continuous operation at flow rates greater than the maximum Service Flow rate may affect capacity and efficiency performance.
- (c) All specifications and performance ranges are subject to change without notice.
- (d) Requires retention tank, air and/or chemical injection (see separate literature for details.)

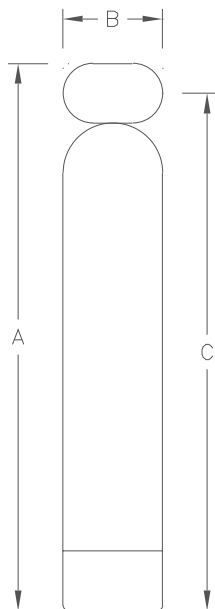

WARRANTY

1 Year on Complete Unit
3 Years on Electrical Parts
5 Years on Valve Body and Internals
10 Years on Resin Tank

See Owners Manual For Specific Conditions

System DIMENSIONS

Model	A	B	C
125	62	10	56
175	60	12	54
200	62	13	56