

# Otocheck

TEOAE  
or  
DPOAE



Ideal newborn and pediatric screener



- Satisfies CPT codes 92558 and 92587
- A simple to use newborn and pediatric screener with an intuitive interface
- Automatic pass/refer, low cost consumables and long battery life make this the ideal OAE screener

Read more at [www.otodynamics.com/otocheck](http://www.otodynamics.com/otocheck)

USA 1 800 659 7776 • International +44 1707 267540 • email [sales@otodynamics.com](mailto:sales@otodynamics.com)

**Otodynamics**  
Audiology Systems

# Otocheck Features

The Otocheck is a simple to use handheld OAE system with an intuitive interface, offered with either TEOAEs for newborn hearing screening or DPOAEs for both newborn and pediatric hearing screening. Automatic pass/refer, low cost consumables and long battery life all make it the ideal way to screen with OAEs.

## Choice of 2 Screening Models

- **TEOAE model** for infant screening, 1-4kHz Quickscreen 5 frequency bands, with 3 screening modes or
- **DPOAE model** for pediatric screening, 2-6kHz 4 frequency points

## Operation

- Easy 'press-and-go' operation. Pass-refer result
- Fast, noise-resistant mode
- Intuitive graphic display shows signal to noise progress
- Unique graphical indication of probe fitting (checkfit)
- Choice of overall or frequency band displays
- Alerts to poor probe fit, high noise level and ringing stimulus
- Long battery life - up to 250 test cycles or one full working week
- Battery level and charging indicators
- Charging cradle and docking station options

## OAE Pass Criteria

- TEOAE model - configurable pass criteria of 6dB SNR in 2, 3 or 4 half-octave bands (1-4kHz) or whole response, wide or narrow bandwidth
- DPOAE model - configurable pass criteria of 6dB SNR at 2, 3 or 4 frequencies (2-6kHz)
- Optimized pediatric mode

## Database

- Provides on-screen test result summary table
- Holds the last 500 tests listed in chronological order  
Stores Patient ID, name, date of birth, gender, notes, location, facility and patient status
- Work-list function for pre-entry
- Integral ID chip reader or barcode scanner options (at time of order)

## Quality Assurance

- Probe test function and ID tracking
- Whole system power-on self test
- User login and password protection if required
- Proven Otodynamics OAE technology

## Printing from Otocheck

- Fast print time, numerical and band pass data
- Automatic print-on-connect mode
- Wired or wireless options (at time of order)

## PC software

- Automated USB data transfer to Otolink PC software
- Uploads firmware updates to Otocheck
- Otolink provides record review, management, printing, archiving
- Archives include detailed ILO format OAE data



# Accessories

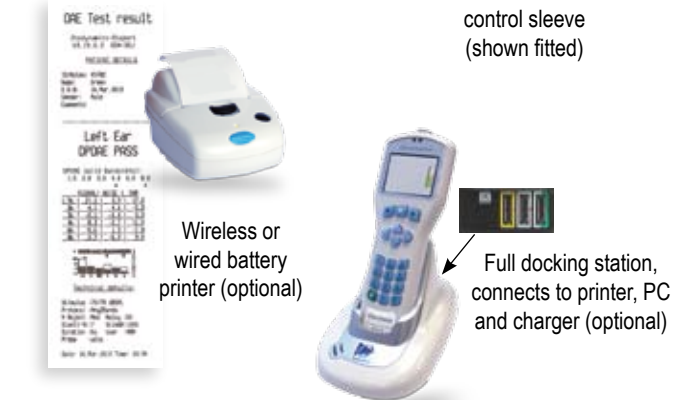

## Technical Specifications

**User interface:** Display: 65K color LCD, QVGA resolution. Input: Alphanumeric keypad with cursor control and menu softkeys.  
**Languages:** English, Spanish, French, Turkish, Portuguese, Italian, German.  
**Test capacity:** More than 250 test cycles or one full working week (typical use). 4GB non-volatile memory. **Hardware options:** Wireless printing/internal barcode reader/RFID scanner. **Data acquisition:** Analogue interface: 2 x 16bit (output) and 1 x 16 bit (input) channels. **Frequency response:** 160Hz to 12KHz (electrical).  
**Electrical interfaces:** Probe connector (Otodynamics 8-pin). Data/charge connector - USB 1.1/2.0 compatible PC connection for data and charging, also accepts Otodynamics PSU. **Power:** Internal rechargeable 3.7v, 1000mAh lithium-polymer battery. **Charge time:** 3 hrs to 90%. Approx 4 hrs to 100% capacity. Intelligent multi-level power control. **Maximum power use:** Testing - 630mW. Charging - 2.5W. **Dimensions:** 7.6" x 2.7" x 1.2" (195mm x 70mm x 30mm). **Weight:** 7.5 oz (214 g). **Operating environment:** For indoor use at 41 to 104°F (5-40°C). Max humidity 80% up to 88°F (31°C) decreasing linearly to 5% RH at 104°F (40°C). **Transport and storage environment:** 32-104°F (0°C to 40°C). **Pressure range:** 23-101KPa. **Humidity:** 10% to 90% non-condensing. **Classifications and standards:** Device Class 2a (Directive 93/42/EEC). ISO 13485. ISO 14971. BS EN 60601. UL 60601. CSA-C22.601.  
 (Features and Specifications subject to change)

## Otodynamics Ltd.

30-38 Beaconsfield Road Hatfield Herts AL10 8BB UK  
 tel 1 800 659 7776 email sales@otodynamics.com  
 www.otodynamics.com/otocheck