



ALUMA-FORM®

# Power Fuse Body and Fittings





ALUMA-FORM®

# Power Fuse Body and Fittings

## Features

- Accommodates third party power fuses
- Accommodates fuse end fittings of other manufacturers
- Fully marine grade available for the harshest environments
- Structural components and fasteners are 316 stainless steel
  - All castings are silicon bronze to eliminate corrodible aluminum
  - Cast load break tool hooks designed to better accept wildlife protectors
- Molded body with highest silicone content available
- Center support fitting fits around continuous rod through the insulator body for maximum strength
- Top and bottom components are keyed onto the stainless steel body to protect against miss-alignment of the fuse holder
- Upper bail is designed to have lowered lift force to ensure fuse drop-out even for low amperage fuses
- Upper and lower fuse fittings and holder ends display Aluma-Form manufacturing logo and part numbers
- Lower fuse fitting has extended skirt to protect against fuse door jumping out of lower holder and swinging back toward pole and grounded equipment
- Conductor fittings can be high-strength eye nuts or parallel groove clamps designed for 50 ft-lb torqueing
- Upper contact has increased surface area for lower resistance

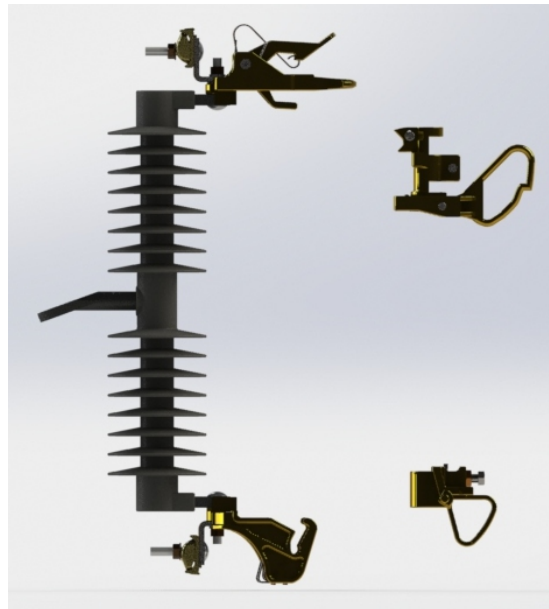



ALUMA-FORM®

# Power Fuse Body and Fittings

## Naming Legend

P	S	M	25	-	150	-	C	N
---	---	---	----	---	-----	---	---	---

P - POWER FUSE

S - SILICONE

M - MARINE GRADE

G - GALVANIZED

15 - 15kV CLASS

25 - 25kV CLASS

125 - 125kV BIL

150 - 150kV BIL

170 - 170kV BIL

C - CLAMSHELL

E - EYE BOLT

R - ROTATABLE CLAMSHELL

N - NO MOUNTING BRACKET

B - NEMA "B" BRACKET

X - EXTENDED NEMA "B" BRACKET

P	EF	-	S
---	----	---	---

P - POWER FUSE

M - MARINE GRADE

S - STANDARD

EF - END FITTINGS ONLY