

DEADBOLT SECURITY STRIKE, "T" STRIKE & DOOR HARDWARE

DEADBOLT SECURITY STRIKES

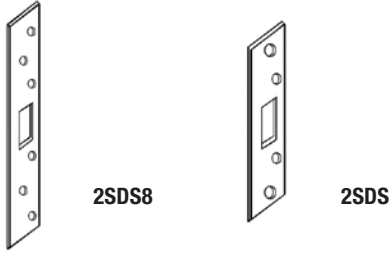

- Supplied with 3" screws to penetrate frame studs for additional strike strength
- Constructed of 13 gauge steel

MFG #	FINISH	SIZE	EZ 3
2SDS SL	Silver Coated	4-7/8" x 1-1/4"	051364
2SDS8 B	Brass Plated	8" x 1-3/8"	100382
2SDS8SL	Silver Plated	8" x 1-3/8"	003230

"T" STRIKE

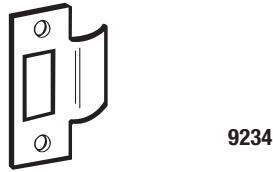

- Constructed of 18 gauge material

MFG #	FINISH	SIZE	EZ #
9234 630	Satin Stainless	2-3/4" x 1-1/8"	100777

DOOR HARDWARE

D

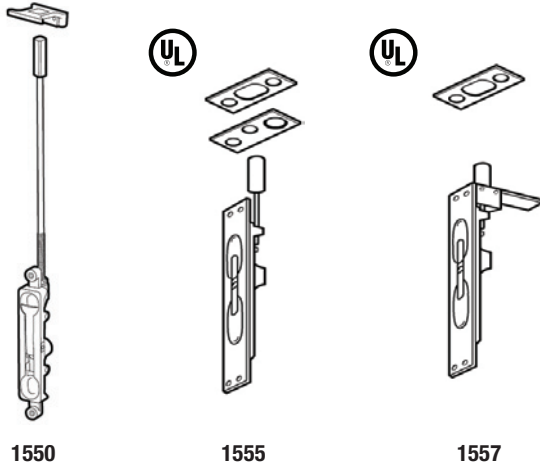

1550: ALUMINUM DOOR FLUSH BOLT

- 1/8" offset
- Radius end

1555: METAL FLUSH BOLT

- Fits ANSI door & frame prep
- 3/4" bolt throw, 3/4" rod backset
- 12" rod length, 1-1/2" adjustable bolt head
- Metal doors faceplate: 1" x 6-3/4", strike: 15/16" x 2-1/4", guide: 1" x 2"

1557: WOOD FLUSH BOLT

- Wood door faceplate: 1" x 6-3/4", strike: 15/16" x 2-1/4"
- 3/4" bolt throw, 3/4" backset
- Door strength maintained by corner reinforcement plate

1603: DOOR FLIP GUARD

- Ball bearing design secures flip guard to lock door from interior for additional security

2080: GRAVITY DOOR COORDINATOR

- Drop arm type gravity door coordinator
- Adjustable
- Field reversible
- Brass

HDCC2512: HEAVY DUTY CRASH CHAIN

- Heavy duty steel chain prevents door from opening wide when caught by high winds

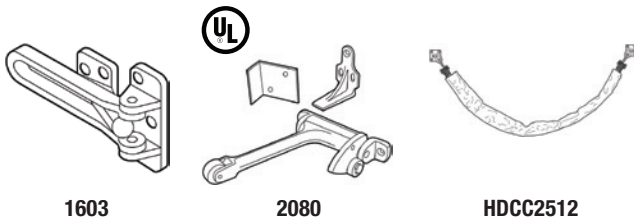

MFG #	FINISH	SIZE	EZ #
1550DU	Duro	15/16" x 4-1/4"	081812
1550SL	Silver Coated	15/16" x 4-1/4"	081811
1555 626	Satin Chrome	1" x 6-3/4"	074790
1557 626	Satin Chrome	1" x 6-3/4"	081700
1603 605	Polished Brass	—	100387
2080 626	Satin Chrome	—	074976
HDCC2512	Gray	25-1/2"	077853

CABINET ELBOW CATCH



- Made of cast brass or bronze
- Ideal for use on the inactive leaf of cabinet doors
- Supplied with screws
- Catch size: 1-3/8" x 5/8"
- Strike size: 1-3/16" x 5/8"

MFG #	FINISH	EZ #
21C26D	Satin Chrome	072703

CYLINDER PULL



- 1-1/4" hole for mortise or rim cylinder
- Cast brass or bronze base material
- 2-3/4"H x 1-7/8"L

MFG #	FINISH	EZ #
980 C28	Aluminum	035239

FLUSH BOLT



- Base material: brass
- Face size: 1" x 6-3/4"
- Keeper size: 1" x 2-1/4"
- Guide: 7/8" x 2-1/4"
- Extension length: 12" (length measured from centre of operating lever to end of bolt when in retracted position)

MFG #	FINISH	EZ #
GSH401C26D	Satin Chrome	039789

CAST WALL STOPS



GSH231



GSH250B

- All fasteners included

GSH231

- For use with most locksets

GSH250B

- For use on locksets with push-in locking button

MFG #	FINISH	DIAMETER	PROJECTION	EZ #
GSH231C26D	Satin Chrome	2-3/8"	1"	035541
GSH250B C26D	Satin Chrome	2-1/2"	1"	039785

CONSTANT LATCHING FLUSH BOLT



TOP BOLT



BOTTOM BOLT

- Constant latching - inactive door remains latched until the active door is opened, releasing the automatic bottom bolt and then the top bolt can be manually released
- Inactive door will relatch automatically when closed
- Low actuation forces
- Fits standard ANSI A115.4 door and frame preparations
- Non-handed
- 3/4" bolt throw with a 7/8" vertical adjustment
- 3/4" backset
- Standard rod length is 12", which is measured from the center of the flush bolt body to the bolt tip
- Body size: 1" W x 6-3/4" L x 2" D
- Meets ANSI A156.3 type 27
- UL listed 3 hr fire doors 8'0" x 10'0"

MFG #	DESCRIPTION	EZ #
FB51P US32D	Metal Door Flush Bolt Set	091025

SURFACE BOLTS



LOCKING
BOTTOM STRIKE



LOCKING
TOP STRIKE

NON-LOCKING
BOTTOM STRIKE



NON-LOCKING
TOP STRIKE

- Standard surface bolt has 1" throw for maximum security
- Ideal for all types of doors
- Fully concealed mounting prevents vandalism
- Available in locking version: unit locks in both the up and down position - locking bolts are furnished with 2 keys in 4 keying variations
- Units packed with wood and machine screws to meet most field conditions
- Units available with either a universal top strike (T) or a flat bottom strike (B)
- 1630 series is constructed of heavy duty steel
- UL listed up to 3 hours when used on the inactive door of pair up to 8' in height
- Meets ANSI/BHMA A156.16, L84161
- Sex bolts available where required

MFG #	DESCRIPTION	EZ #
SB1630B US2G	Bottom Surface Bolt	035837
SB1630BL US2G	Bottom Surface Bolt (Locking)	035838
SB1630T US2G	Top Surface Bolt	035839
SB1630TL US2G	Top Surface Bolt (Locking)	035840

ROLLER LATCH



- Actuation is simple, closing of the door causes the roller to fall in the depression of the strike, thereby holding the door closed
- The projection of the roller is easily adjusted using adjusting screws on the face of the unit
- Maximum projection of the roller is 3/8" allowing for variance in the door clearance
- Nylon roller standard
- Forged brass construction
- Meets ANSI/BHMA A156.16, E19091

MFG #	BODY	STRIKE	EZ #
RL30A626	1" x 3-3/8" x 1-11/16"	1-11/16" x 2-1/4" x 5/32"	035554

MISCELLANEOUS

ASA STRIKES, FLUSH BOLTS, FASTENER SEXBOLT, PUSH & PULL HANDLES

ASA STRIKES



- Meets the ASA strike specification size of A115.2 of 4-7/8"H x 1-1/4"W
- Used for knob & lever sets in commercial applications

MFG #	TYPE	FINISH	EZ #
ASA C15	Standard	Brushed Nickel	035224
ASAC3	Standard	Polished Brass	082308
ASAC15T	Adjustable Lip	Brushed Nickel	083790

FLUSH BOLTS



DC840



DC860

- For keeping the inactive door of a pair of doors stationary
- DC840 supplied in pairs
- DC860 sold individually

MFG #	FOR	HEIGHT	WIDTH	THROW	EZ #
DC840 C15	Steel	6-1/4"	1'	5/8'	086322
DC860C28	Aluminum	5-1/4"	15/16"	5/8"	039421

FASTENER SEXBOLT



- Zinc plated thru-bolt for affixing door closers, exit devices and other hardware on 1-3/4" doors where a blind bolt fastener is required on exterior side
- Allen key nut interior

MFG #	EZ #
SF710ZCB	039649

PUSH & PULL PLATES



1410



H1413

1410

- Push/pull plate combination with a 9" pull mounted on a 4" x 16" push plate
- Aluminum finish

H1413

- Pull handle only

MFG #	DESCRIPTION	EZ #
1410 AL	Push Pull Handle Set	035220
H1413	9" Pull Handle Only	067805

M