

Dethatcher Wheel Kit

Part Number: DTWK-P

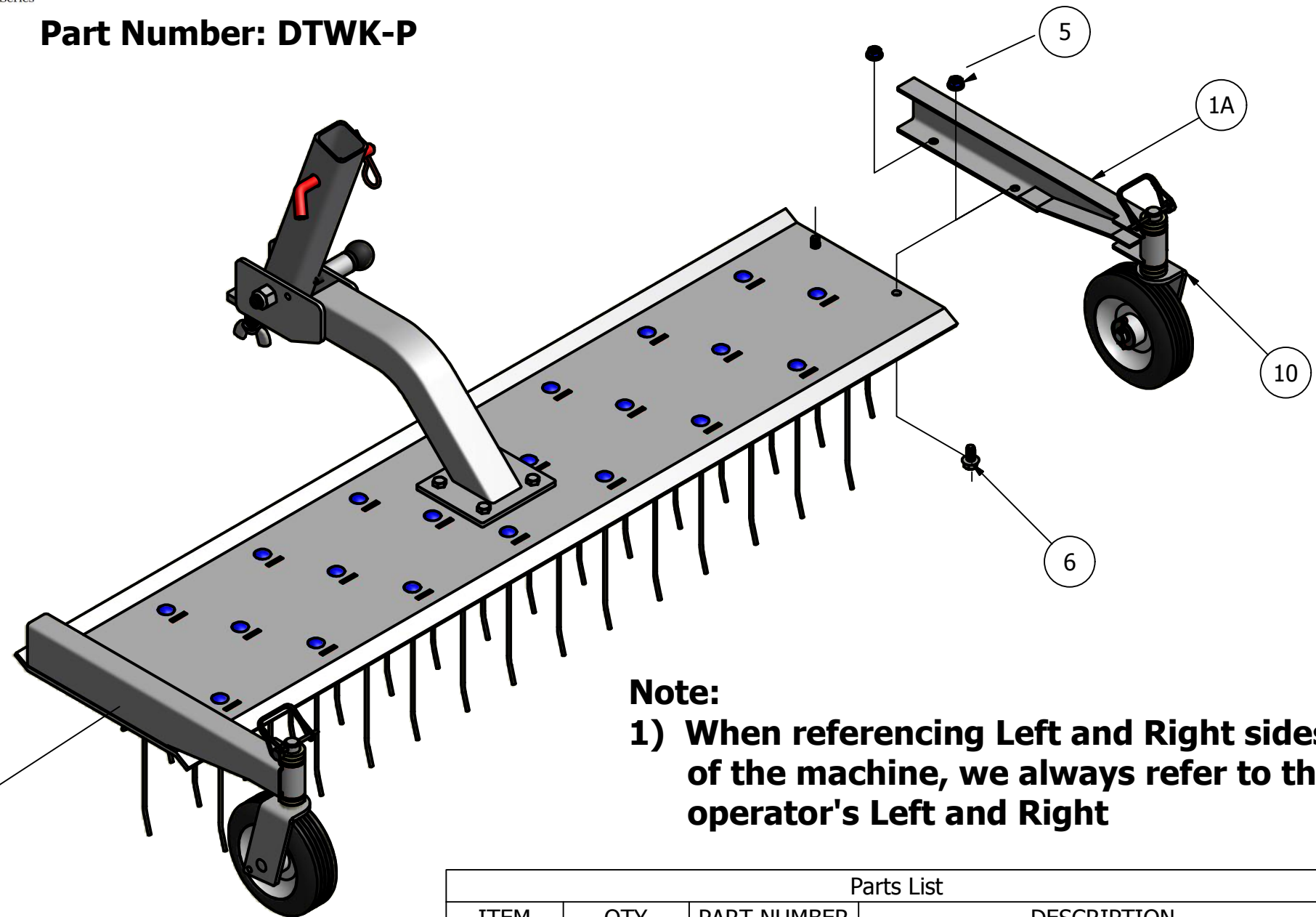
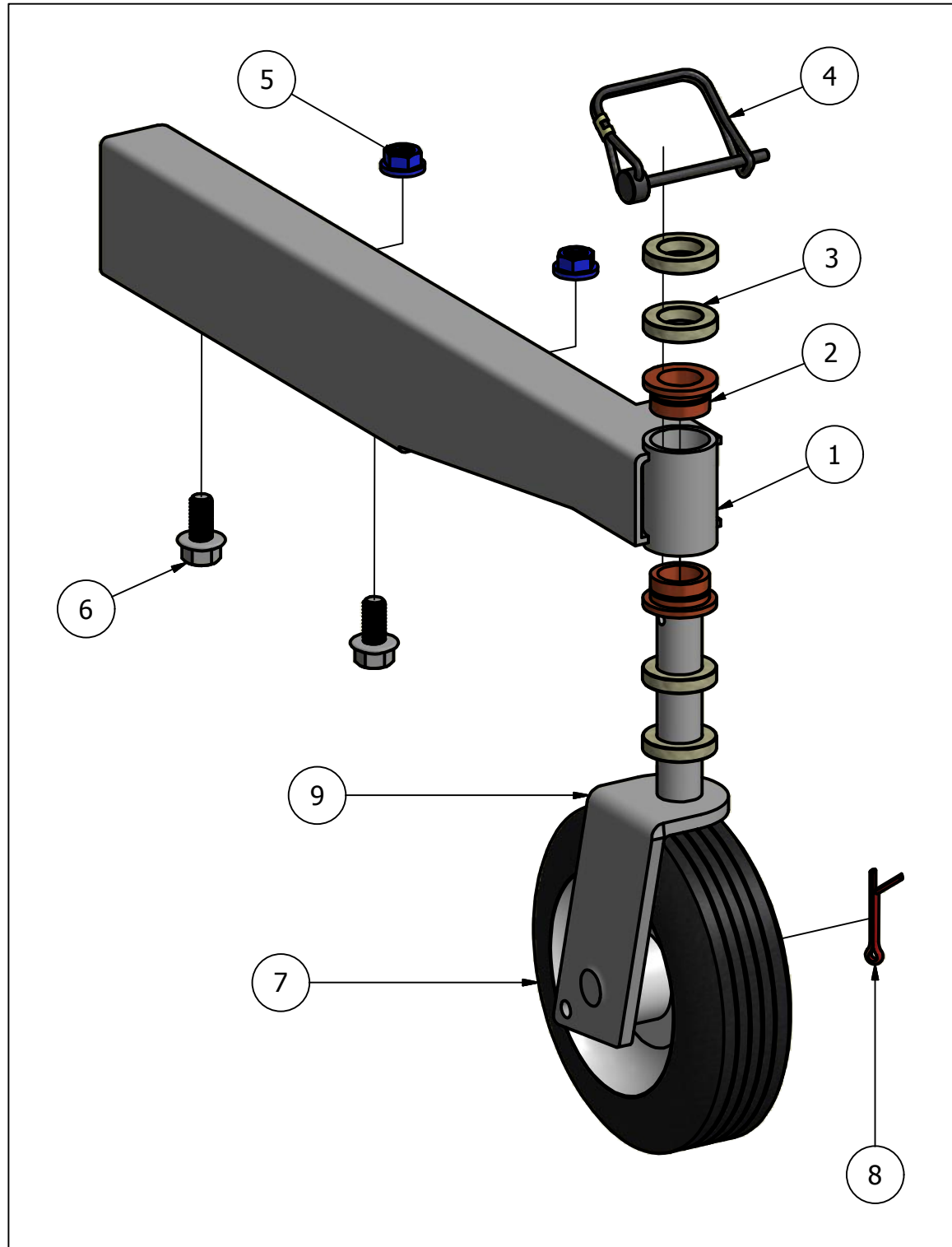

Note:

1) When referencing Left and Right sides of the machine, we always refer to the operator's Left and Right

| Parts List | | | |
|------------|-----|-------------|--|
| ITEM | QTY | PART NUMBER | DESCRIPTION |
| 1 | 1 | 69860100 | Right Caster Arm |
| 1A | 1 | 69860100.1 | Left Caster Arm |
| 2 | 4 | 69860101 | Caster Bushing |
| 3 | 8 | 69860106 | Wheel Spacer |
| 4 | 2 | DTWK66045 | 3/16" Snapper Pin |
| 5 | 4 | 69730014 | 3/8-16 Flanged Nut |
| 6 | 4 | 202100002 | 3/8-16 X 3/4" LG Flanged Hex Head Bolt |
| 7 | 2 | 69860107 | 6 X 2 Semi-Pneumatic Wheel |
| 8 | 2 | 69860108 | Cotter Pin |
| 9 | 1 | 69860109 | Right Caster Yoke |
| 10 | 1 | 69860110 | Left Caster Yoke |

| REVISION HISTORY | |
|------------------|---------|
| REV | DATE |
| C | 1/27/21 |