



OHIO HISTORIC INVENTORY

1. <u>ERI-1586</u>		4. Present Name(s) Geraldine Betzenheimer House		1. No. ERI-1586	
2. County ERIE		5. Other Name(s) Burt Ward / Weller / Fritz Martin House			2. County Erie
3. Location of Negatives O.H.S.					
6. Specific Location West side of Division St., 1400 Ft. north of Chapel St.		16. Thematic Category Industry		28. No. of Stories 2	
7. City or Town If Rural, Township & Vicinity Kelleys Island		17. Date(s) or Period 1887 - Rebuilt c. 1896		29. Basement? Yes <input checked="" type="checkbox"/> No <input type="checkbox"/>	
8. Site Plan with North Arrow N → Pond CHAREZ St Division St German Reform Church		18. Style or Design Folk Victorian		30. Foundation Material l.s. rubble	
9. U.T.M. Reference 17 357500 4606460		19. Architect or Engineer		31. Wall Construction Wood frame	
Zone Easting Northing		20. Contractor or Builder		32. Roof Type & Material Gable/asph shingle	
10. Site Building <input checked="" type="checkbox"/> Structure <input type="checkbox"/> Object <input type="checkbox"/>		21. Original Use, if apparent Residence		33. No. of Bays Front Side	
11. On National Register? Yes <input type="checkbox"/> No <input checked="" type="checkbox"/>		22. Present Use Residence		34. Wall Treatment Insul. brick	
12. Is It Eligible? Yes <input type="checkbox"/> No <input checked="" type="checkbox"/>		23. Ownership Public <input type="checkbox"/> Private <input checked="" type="checkbox"/>		35. Plan Shape Irreg	
13. Part of Estab. Hist. Dist.? Yes <input type="checkbox"/> No <input checked="" type="checkbox"/>		24. Owner's Name & Address, if known Geraldine Betzenheimer Kelleys Island, Ohio		36. Changes (Explain in #42) Addition <input checked="" type="checkbox"/> Altered <input checked="" type="checkbox"/> Moved <input type="checkbox"/>	
14. District Potent'ly? Yes <input checked="" type="checkbox"/> No <input type="checkbox"/>		25. Open to Public? Yes <input type="checkbox"/> No <input checked="" type="checkbox"/>		37. Condition Interior Exterior Fair	
15. Name of Established District N/A		26. Local Contact Person or Organization Kevin Pape: KI Hist Survey		38. Preservation Underway? Yes <input checked="" type="checkbox"/> No <input type="checkbox"/>	
		27. Other Surveys in Which Included N/A		39. Endangered? By What? Yes <input type="checkbox"/> No <input checked="" type="checkbox"/>	
				40. Visible from Public Road? Yes <input checked="" type="checkbox"/> No <input type="checkbox"/>	
				41. Distance from and Frontage on Road 30'	
42. Further Description of Important Features (Continue on reverse if necessary) Like many homes on the island, the main cross gabled section is attached to a rear, single-story, gabled wing. Brick chimneys are located at the intersection of the "T" plan cross gables and on the ridge of the rear gable end. Roof gables have cornice returns on south, east and west sides; north gable is hipped. The southern side of the rear wing contains a hipped dormer. Trim elements, including window enframements are obscured by compound shingles. Windows are a mix of 1/1 and 2/2 types with				5. Other Name(s) Burt Ward / Weller / Fritz Martin House	
43. History and Significance The historic owner and builder is not certain. Information from the Hamilton Collection combined with records from the Erie Co. Grand Tax List seem to indicate that this was the house built by Burt Ward in 1887, and that it burned in 1896 and was rebuilt, presumably by Ward. This would be Burton, son of Edmund and Nancy Ward, and brother of Uri Ward. He was born on K.I.					
44. Description of Environment and Outbuildings Old quarry lands about the property to the west. A series of 4 frame sheds and outbuildings lie to the rear of the house consisting of: A-large, tar papered, gable roofed shed of horizontal tongue and groove siding, a shed-roofed, board & batten privy lies immediately to the north; B-a square shed					
45. Sources of Information Census Records 1896 Atlas; 1909 Platt Map, K.I. 1887 Grand List, Erie Co. M.A. McKillips, Milton Platt, Kurt Roker		46. Prepared by Kevin Pape & Betty Pape			
		47. Organization K.I. Planning Commission			

50. House Type No.

Code No. Name

51. Historic Outbuildings and Dependencies

Barn Type(s)

Code No. Type

Corn Crib or Shed Smoke House Privy
 Silo Spring House Carriage House
 Summer Kitchen or Ice House

Other Sheds of unknown use
 Old fishing net truck behind "B"

52. Archaeological Site on Property?

Yes
 No

Basis for Information

Owner Collection
 Above Ground Earthworks or Mound
 Cultural Materials Noted

QAI No. _____



53. Farmstead Plan

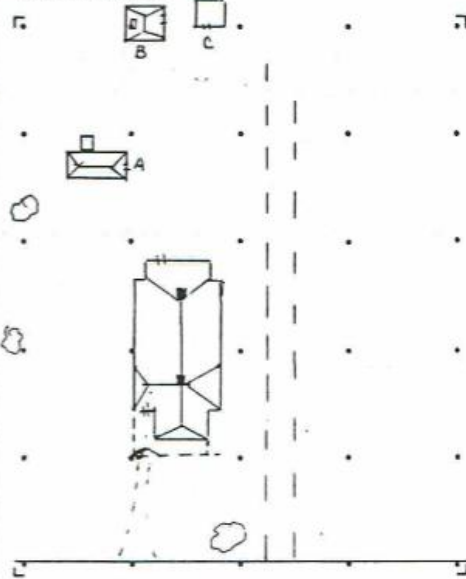

54. Photo

Roll No. 30 Picture No(s) 13 & 14

42. (Cont'd) with large, asymmetrically sashed windows in the first floor eastern and southern gables. The "L" shaped front porch has a hipped roof with gable over the entranceway, all supported by turned columns. The rear porch is enclosed and has a hipped roof.

43. (Cont'd.)

in 1855 and was a sailor on the lakes.

By oral tradition it was known in the 1930's as the Weller house and is said to have been the only house in the neighborhood that seemed to be constantly changing occupancy. There is little information available on the Weller family. It is known that c.1910 the house was owned by the KIL&T Co and was rented to a succession of office and supervisory personnel of the West Quarry. Among these were John Guerin (c1910), Frank and Georgia Kiefer Neuman, George Cleazy, and Robert and Lydia Schnittker Kurtz (c.1930's).

John Guerin was the son of Irish emigrants, Michael and Honora Guerin, was born in Ireland in 1878 and came with his parents to the United States in 1884. Like his father, John worked for the Lime Company but unlike his father who worked in the field as a derrick operator, worked in the office as a timekeeper/bookkeeper and later as a superintendant. He married Lisa (or Lura) Smith, daughter of Louis and Emma Smith (See ERI-1550). George Cleazy was a timekeeper, Frank Neuman a bookkeeper/timekeeper, and Robert Kurtz, a bookkeeper. He was the son of Christopher and Caroline Kurtz, and was born on the island in 1887.

The next owner was Frederick J. Martin (aka Fritz), son of Frederick and Julia Amanda Martin. He probably purchased the property when the KIL&T Co. was divesting itself of much of its property in the 1940's. Fritz operated the Martin Electric Co. (see ERI-1723) until the coming of the electric co-op and later worked as the island electrician. The present owner purchased the property from the Martin Estate and has used it as occasional rental.

#44 (Cont'd.)
 of similar construction to A; C-Board and batten, sheet metal shed roofed building north of B.