



# COMPUTER LAB WORKSTATIONS

The role of computers in classrooms has evolved from basic keyboarding and accounting classes to technology-driven curriculum in areas such as industrial design, animation, and programming. With students employing robust software packages, these technology-rich computer labs require dedicated workstations designed to comfortably accommodate students and their CPUs, monitors, scanners, and printers.

Since these courses are often in high demand, Interior Concepts has designed space-efficient workstations that smoothly integrate technology for the greatest number of students. IT departments also appreciate the Chase™ Wire Management System because of its ability to help simplify equipment connections and hide wires and cables.



## FEATURES

- 1.25" thick worksurface with HPL laminate, balancing-backer sheet, and 3MM edge
- Built-in Chase™ Wire Management
- Limited lifetime warranty
- Made in the USA
- MAS® Certified Green

## OPTIONS

- Station dimensions and worksurfaces are customizable by the inch
- 29" H or counter-height designs
- 8-Wire electrical
- Desktop power
- Storage pedestals, CPU brackets, monitor arms, and keyboard trays
- Decorative acrylic panel inserts to coordinate program areas
- Numerous color options (to view, visit the Resources Section at [interiorconcepts.com](http://interiorconcepts.com))

# ROOM LAYOUT EXAMPLES

Rows Layout

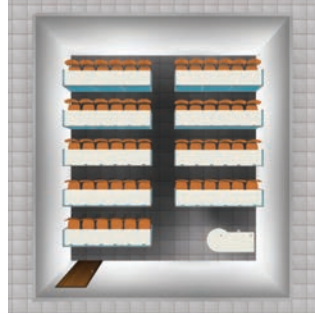
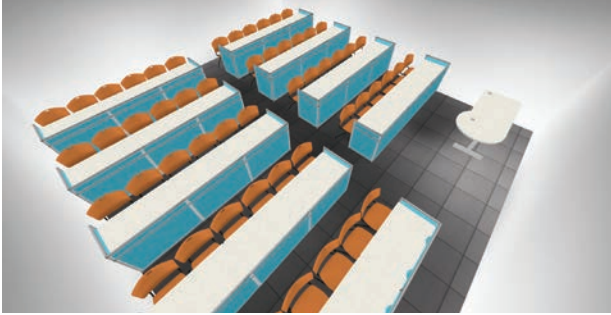

Back-to-Back Layout

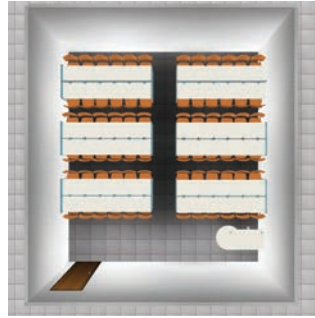
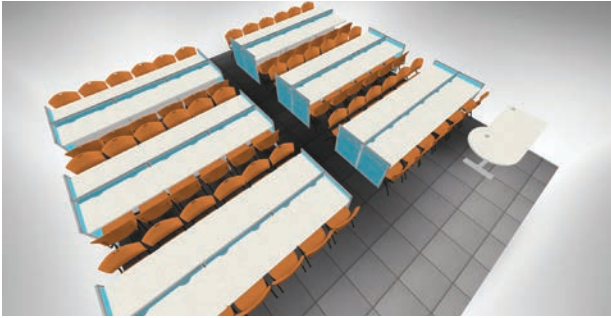

Perimeter Layout

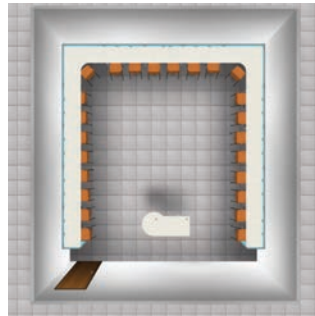
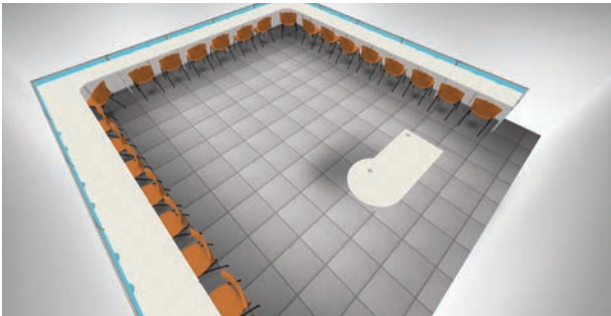

U-Shaped Layout

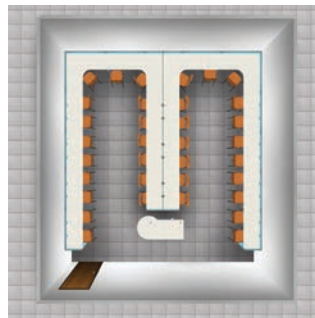
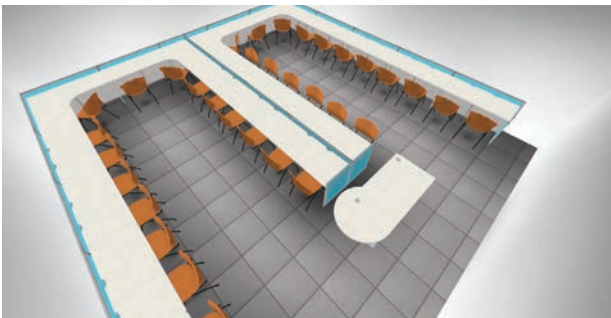

 **Interior Concepts™**  
solutions that fit.

**FIRST**   
**TECHNOLOGIES INC.**  
Putting Education ... **FIRST**

Toll Free: 800-787-9717  
Phone: 262-753-6900  
Fax: 262-753-6901

Email:  
info@firstechd.com  
www.firstechd.com



5/2016