

THE GATEWAYS OF BAAAL II

The purpose of this illustration is to depict the aftermath of how the ISIS Muslim fighters destroyed the ancient Temple of Ba'al in Palmyra, Syria. This temple was the center of Ba'al worship that involved the sacrifice of babies onto the blazing arms of the Moloch idol. In a guise to appease the 'Gods', many families elected to dispense with raising children as being cumbersome and expense to undertake. To sear the conscience, the supposed 'worshippers' would 'sacrifice' their produce of sexual unions to the 'Gods' in a way to dispense with them. Such a practice amounted to infanticide and 'abortion'. A lot of babies were actually conceive in the 'temple' worship rituals of unions with the temple prostitutes that were considered part of the worship rituals and sacraments.

CELEBRATION OF THE SLAUGHTERED

Lucifer's Holy Feasts

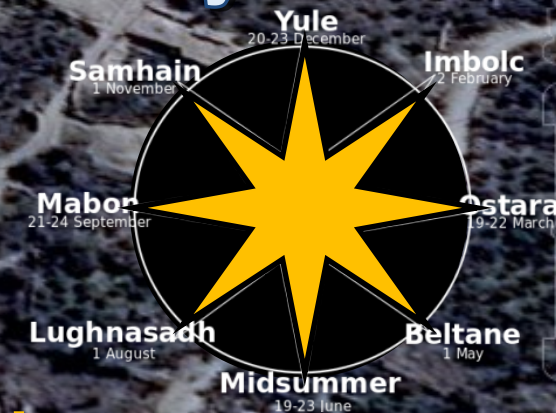

Arch of Triumph
PALMYRA

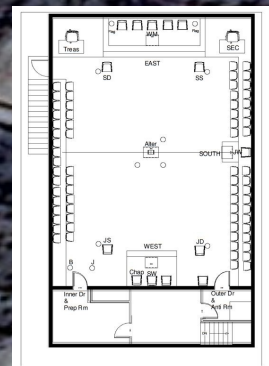

Temple of Baal

Gate

'A Masonic Lodge'



New York London Palmyra

Φ Phi Ratio of distance

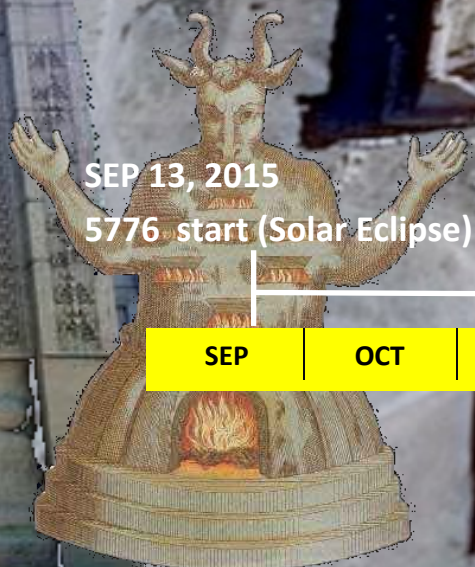

SEP 13, 2015
5776 start (Solar Eclipse)

33 WEEKS

APRIL 19, 2016 ¹³

Fest of Beast

MAY 1
Beltane



APRIL 22
Passover

Image © 2016 CNES / Astrium

Google earth

Imagery Date: 2/19/2014 34°32'50.90" N 38°16'26.79" E elev 1353 ft eye alt 2754 ft

© Composition & Some Graphics by
LUIS B. VEGA
vegapost@hotmail.com
www.PostScripts.org
FOR ILLUSTRATION PURPOSES ONLY

SOME SOURCES
Aljazeera.com
GoogleEarth.com
TimeAndDate.com
UNESCO.org
Wikipedia.com