

THE OPAL

STANDARD FLOORPLAN

3 Bedrooms / 2 Baths

(Floorplan Shown in Frame Version)

Block:

Living Area 1616 sf • Total Area 2204 sf
(Frame elevation not available in all communities.)

One of this home's most impressive and visible features is the large bay window that adds depth and light to what is already an impressive kitchen.

This open Great Room plan allows you the flexibility to design your own sitting and dining areas. This spacious Kitchen offers plenty of room for a table setting near the bay window and a high-countered breakfast bar opens to the Great Room. The Great Room and the adjoining Screened Lanai will provide plenty of space for entertaining.

HIGHLIGHTS

- 3 Bedrooms / 2 Baths
- Elevated Front Entry
- Large Bay Window in Kitchen
- Spacious Great Room Area
- Volume Ceilings in Living Areas & Master Suite
- Lanai Access & Luxurious Master Bath in Master Suite
- Large Kitchen with Breakfast Bar
- Large Screened Lanai & Patio
- 2 Car Garage

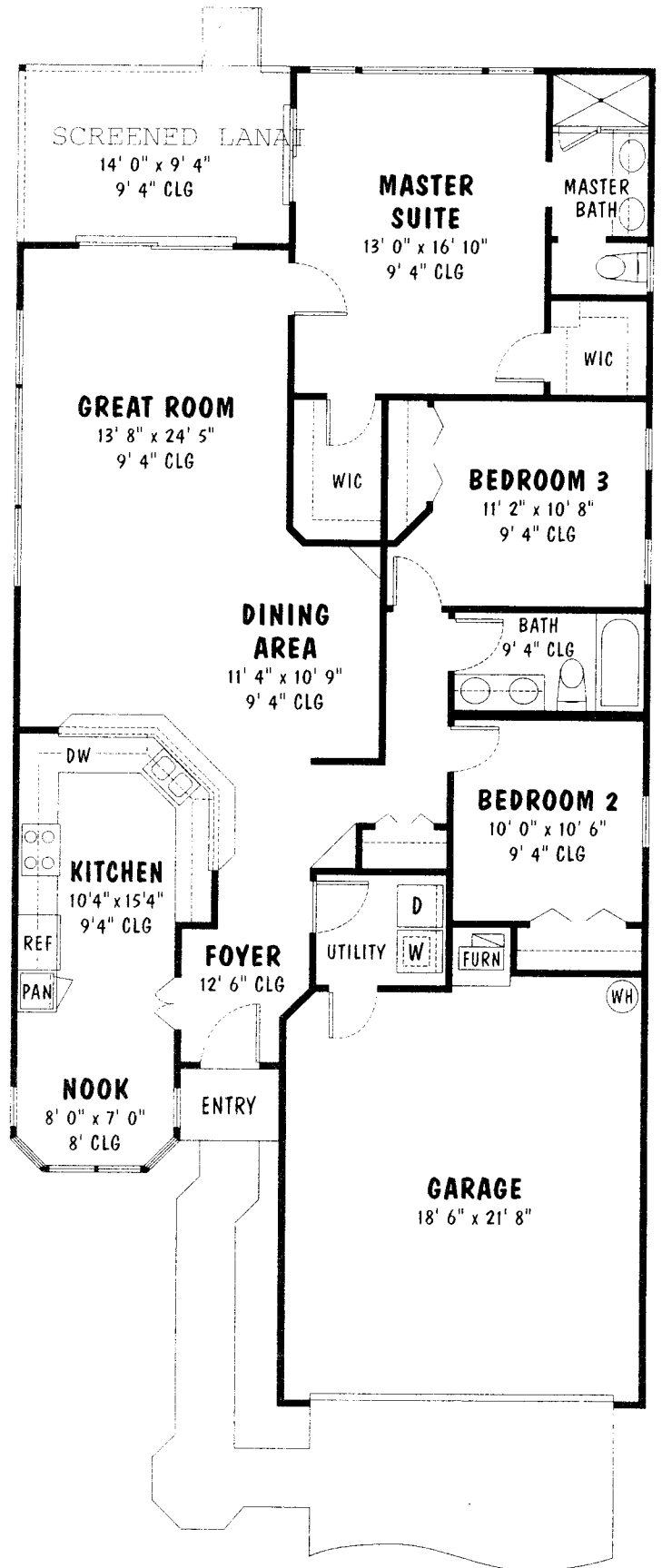

Pringle Development • So. Hwy. 27, 26600 Ace Ave., Leesburg, FL 34748 • 1 (800) 325-4471 • (352) 365-2303 • www.pringle.com

Pringle Construction Company: CG C056993 Builder of custom homes at Riverside, Scottish Highlands, Highland Lakes,

Royal Highlands, Royal Harbor, Legacy of Leesburg and other fine communities.

Because we continually strive to find new ways to improve and change our homes, we reserve the right to change specifications, brands, and architectural details without notice. Dimensions may also vary from those shown in this sales literature and some features depicted may not be included as standard when you buy your home.

