

SPRINKLED BUILDING FACE - 10/14/02
 LIFTING DISTANCE - 150' ±
 ALLOWABLE GLAZED AREA - 58' (3,446 sq ft)
 APPROXIMATE OPENINGS - 3,446 sq ft

WINDOW AND EXTERIOR DOOR SIZES
 TO BE CONFIRMED BY SUPPLIER.

TRUSS DESIGNER TO CONFIRM
 UNITS, 4 BEAM SLING UNITS
 TRUSS LOADS BEAR.

DIMENSIONS ARE FROM OUTSIDE
 OF SLABHING FOR EXTERIOR WALLS
 AND STUDS FOR INTERIOR WALLS.

ENGINEERED LUMBER PRODUCTS
 TO BE SUPPLIED AND INSTALLED
 TO MANUFACTURERS' SPECS.

ALL CONSTRUCTION TO CONFORM
 TO O.B.C. 2012 STANDARDS

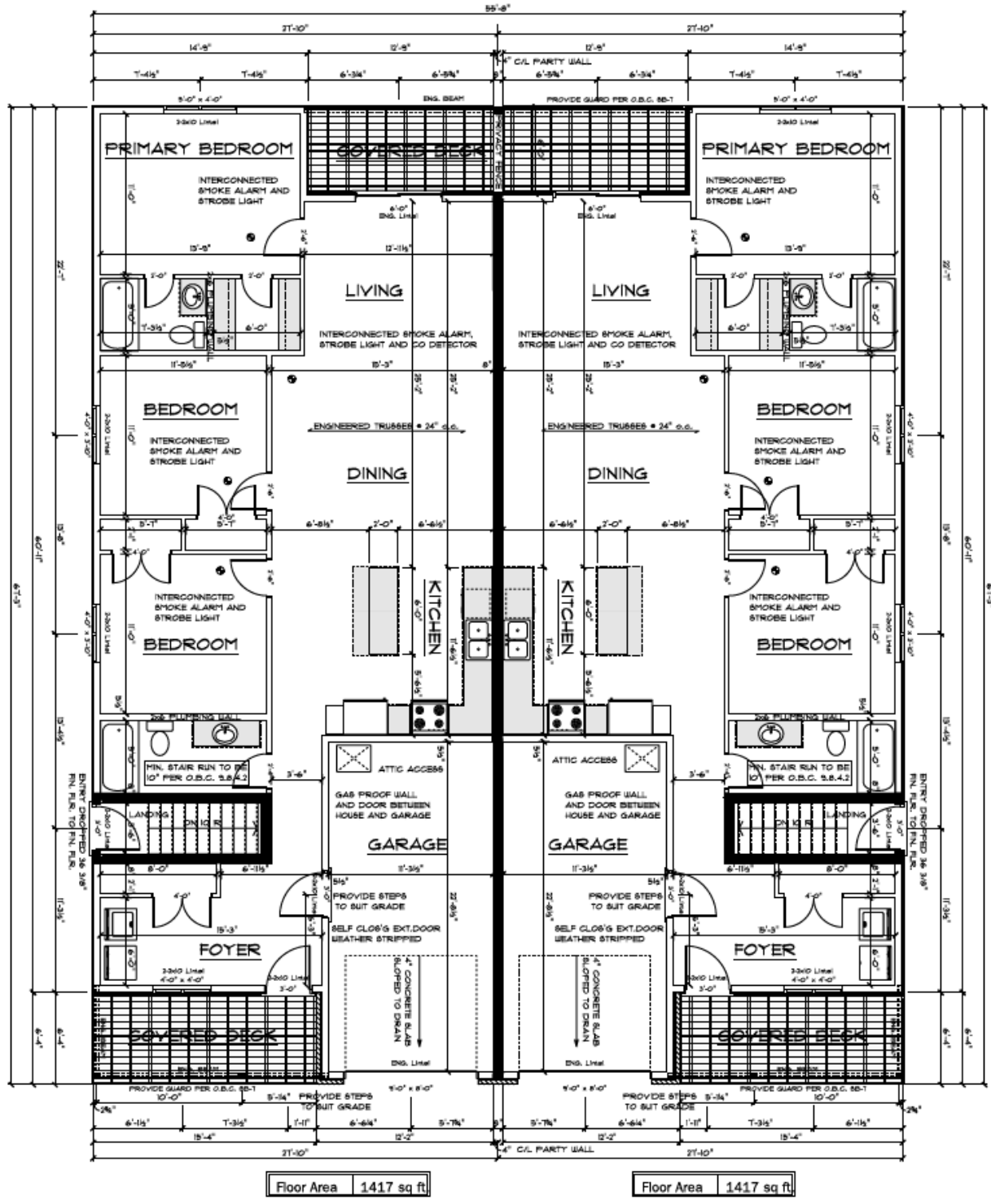

SPRINKLED BUILDING FACE - 10/14/02
 LIFTING DISTANCE - 150' ±
 ALLOWABLE GLAZED AREA - 58' (3,446 sq ft)
 APPROXIMATE OPENINGS - 3,446 sq ft

SPRINKLED BUILDING FACE - 10/14/02
 LIFTING DISTANCE - 150' ±
 ALLOWABLE GLAZED AREA - 58' (3,446 sq ft)
 APPROXIMATE OPENINGS - 3,446 sq ft

WALL ASSEMBLY USE:-
 TWO ROWS 2 x 4 STUDS SPACED AT 16" o.c.
 ON SEPARATE PLATES SET 1" APART
 5 1/2" ABSORBITIVE MATERIAL ON ONE SIDE
 1 LAYER 5/8" TYPE "X" GYPSUM BOARD ON EACH SIDE
 ONE HOUR FIRE RATING, STC 54, TYPICAL BETWEEN UNITS