

47,000 Sq. Ft. For Lease

26575 Northline Rd, Taylor, MI 48180



Listing ID:
Status: Active
Property Type: Industrial For Lease
Industrial Type: Flex Space, Industrial-Business Park
Contiguous Space: 47,000 SF
Total Available: 47,000 SF
Lease Rate: Call
Base Monthly Rent:
Lease Type: Modified Gross
Ceiling: 18 - 20 ft.
Office SF: 4,600
Drive-In Bays: 1 Bay, 2 Truck Wells



Overview/Comments

47,000 sq.ft. of light industrial for lease. Air conditioned warehouse. New Parking lot and landscaping.
Call Rea Construction at 734-946-8730 for a tour. 1 Mile From Detroit Metropolitan Airport.

General Information

| | | | |
|------------------|--|---------------------------|-----------------|
| Tax ID/APN: | 263960770 | Building Name: | 26575 Northline |
| Industrial Type: | Flex Space, Industrial-Business Park, Manufacturing, Mixed Use, Light Industrial, Self Storage, Warehouse/Distribution | Gross Building Area: | 47,000 SF |
| | | Building/Unit Size (RSF): | 47,000 SF |
| | | Usable Size (USF): | 47,000 SF |
| Zoning: | LIGHT INDUSTRIAL | Land Area: | 3.51 Acres |

Available Space

| | | | |
|---------------------|----------------|------------------|-------------|
| Suite/Unit Number: | 26575 | Rent Escalators: | Fixed Lease |
| Space Available: | 47,000 SF | Offices: | 9 |
| Minimum Divisible: | 47,000 SF | Office SF: | 4,600 |
| Maximum Contiguous: | 47,000 SF | Parking Spaces: | 110 |
| Space Type: | Relet | Drive In Bays: | 1 |
| Date Available: | 1/1/2020 | Ceiling Height: | 20 |
| Lease Rate: | Call | Clear Height: | 18 |
| Lease Type: | Modified Gross | | |

Area & Location

Property Located Between: Beech Daly and Lang
Highway Access: I94
Airports: Detroit Metropolitan

Building Related

| | | | |
|----------------------------|-------------------|-----------------------|-----------------|
| Total Number of Buildings: | 1 | Parking Type: | Surface |
| Number of Stories: | 1 | Total Parking Spaces: | 110 |
| Office Space SF: | 4600 SF | Column Spacing: | 50 |
| Property Condition: | Good | Passenger Elevators: | 0 |
| Year Built: | 1989 | Freight Elevators: | 0 |
| Year Renovated: | 2014 | Amps: | 480 Heavy Power |
| Roof Type: | Flat | Volts: | |
| Construction/Siding: | Brick | X-Phase: | 3 |
| Parking Ratio: | 1.6 (per 1000 SF) | Heat Type: | Natural Gas |

Lighting: T-8
Internet Access: Cable

Land Related

Water Service: Municipal
Sewer Type: Municipal

Location

Address: 26575 Northline Rd, Taylor, MI 48180
County: Wayne
MSA: Detroit-Warren-Dearborn
Submarket: Airport District

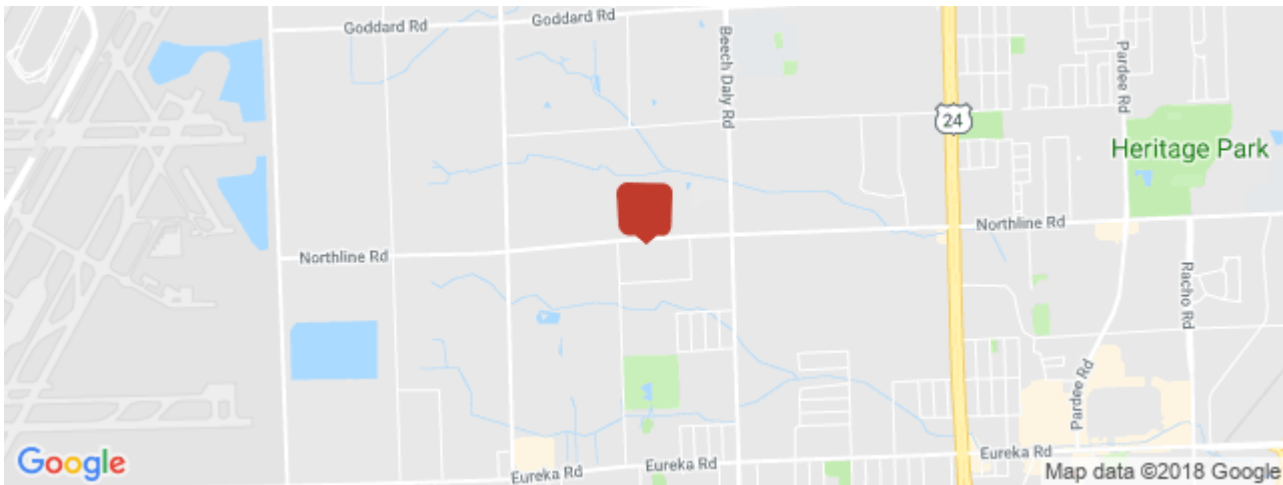

Property Images



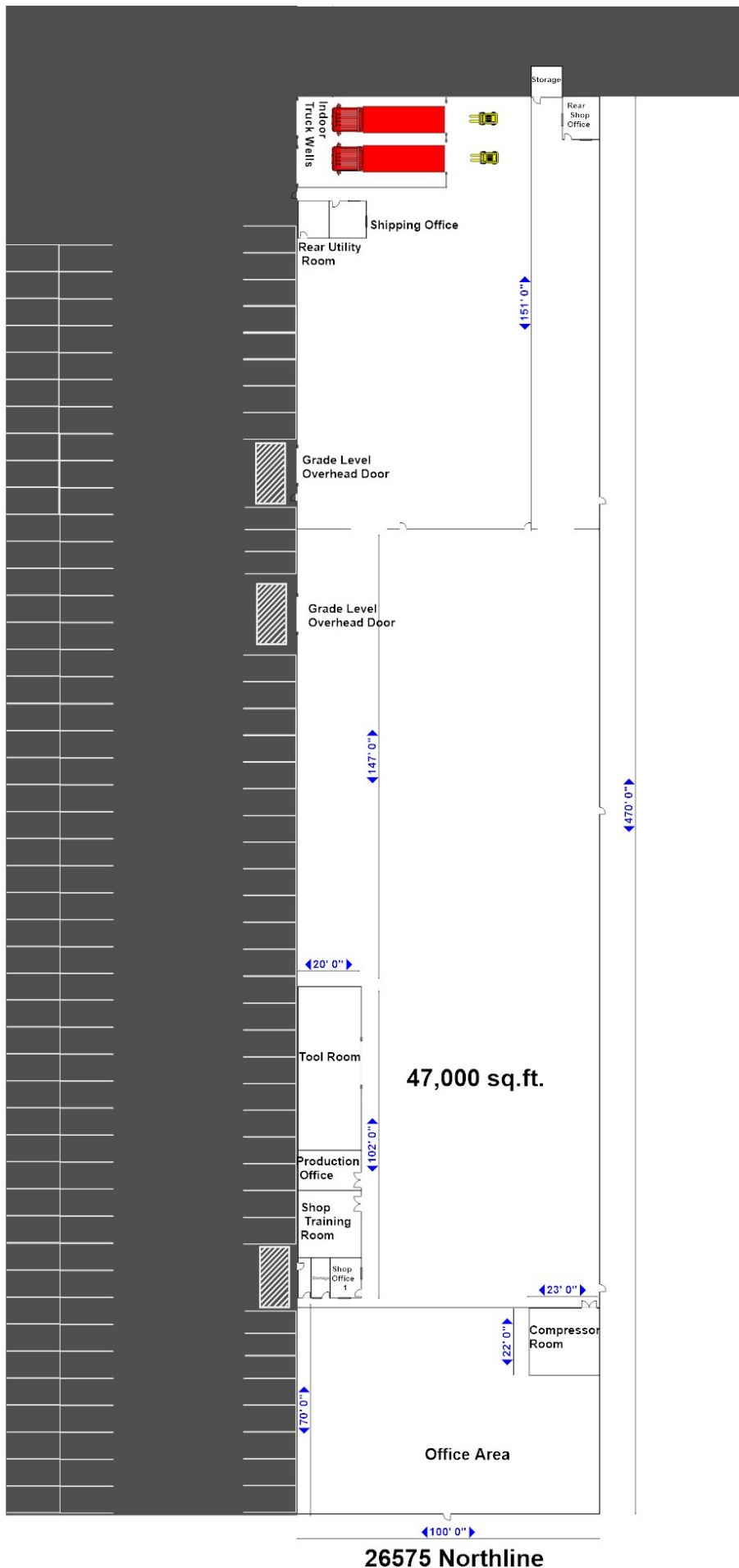

26575 Northline

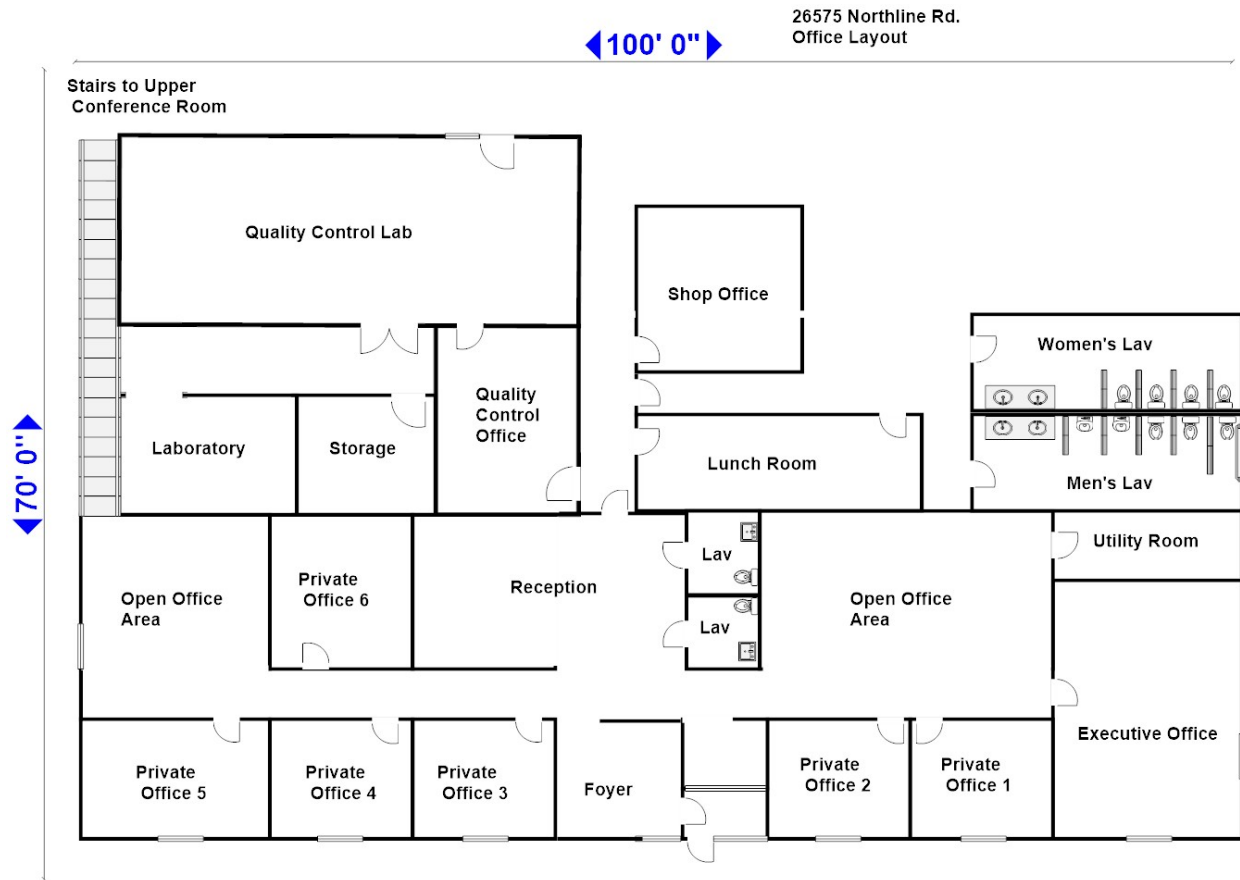

Yvon Rea
734-946-8730