

Model 173 Overhead Separator

Standard Features:

- ✓ All Steel Welded Construction
- ✓ Quality Fabrication Techniques
- ✓ Shell Constructed with Integral Damping
- ✓ Threaded Connections in Small Sizes
- ✓ Plate Flanges to Match ASA 125# Flanges
- ✓ Anti-Cavitation Connection
- ✓ Prime Coated Exterior Surfaces

Optional Features:

- ✓ Materials as Specified
- ✓ Finish as Specified
- ✓ Companion Flanges
- ✓ Inspection Openings or Man Ways
- ✓ Flange Drilling as Specified

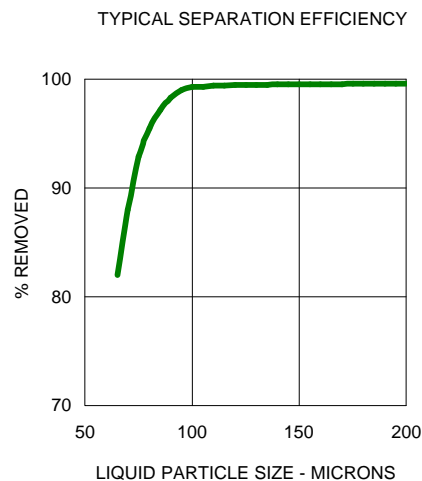
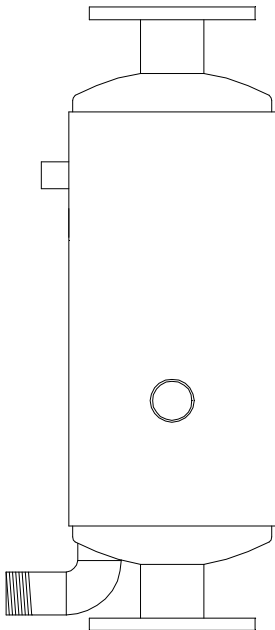
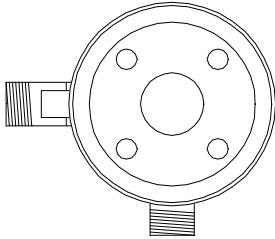

Application:

The **VANEC** Model 173 Overhead Separator is designed for use on liquid sealed vacuum pumps. It separates the seal water from the gas stream while suppressing the vacuum pump exhaust noise.

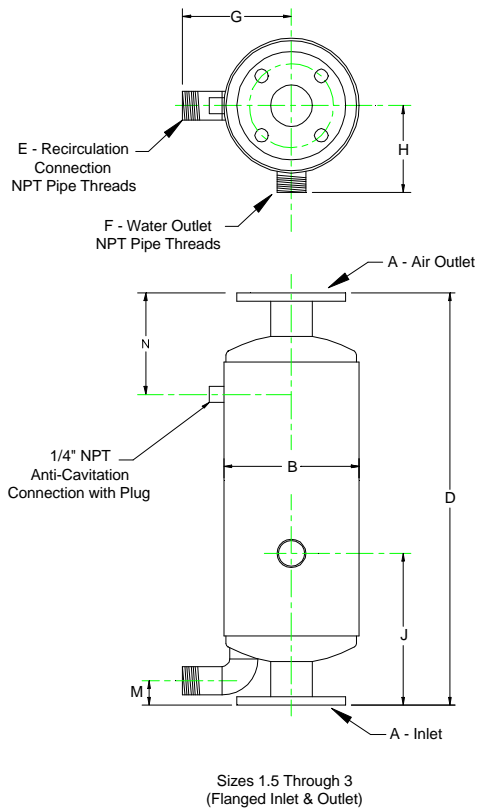
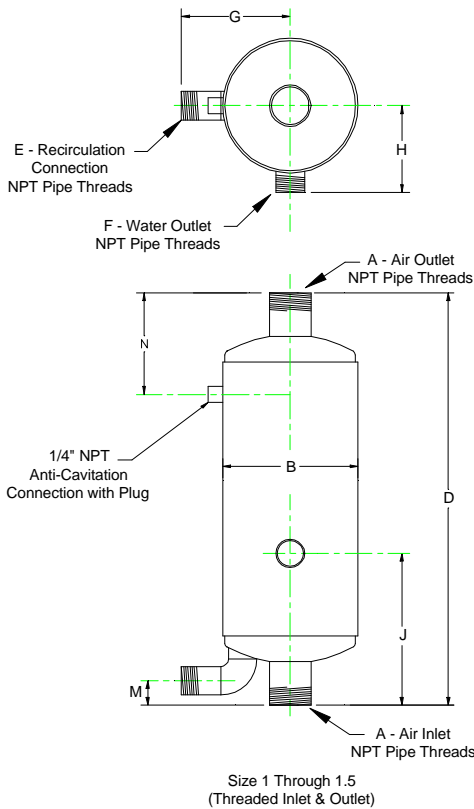

VANEC Model 173 Threaded Inlet & Outlet

Model	Dimensions in Inches										Est.Wt. Lbs.
	A	B	D	E	F	G	H	J	M	N	
173-01	1	4-11/16	16	3/4	1	4-1/4	4	6	1-1/16	5	12
173-01.25	1-1/4	4-11/16	16	3/4	1	4-1/4	4	6	1-1/16	5	12
173-01.5	1-1/2	6	19	1	1	5	4	7	1-1/8	6	14

VANEC Model 173 Flanged Inlet & Outlet

Model	Dimensions in Inches										Est.Wt. Lbs.
	A	B	D	E	F	G	H	J	M	N	
173-01.5	1-1/2	6	19	1	1	5	4	7	1-1/8	6	18
173-02	2	8	24	1-1/2	1-1/2	6	6	8	2-5/16	6	22
173-03	3	10	29	1-1/2	1-1/2	7-1/2	7	8	1-15/16	7	35

VANEC Industrial Silencers
716-827-4959