

# VANEC

## Model 121 Exhaust Silencer

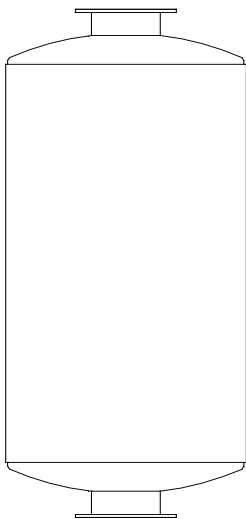
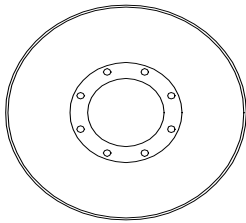

### Standard Features:

- ✓ All Steel Welded Construction
- ✓ Quality Fabrication Techniques
- ✓ Shell Constructed with Integral Damping
- ✓ Prime Coated Exterior Surfaces
- ✓ Condensate Drain
- ✓ Plate Flanges Drilled to Match ASA 125# Flanges

### Optional Features:

- ✓ Low Side Inlet
- ✓ Materials as Specified
- ✓ Finish as Specified
- ✓ Mounting Brackets or Supports for Vertical or Horizontal Installation
- ✓ Inspection Openings or Man Ways
- ✓ Explosion Relief Covers
- ✓ Companion Flanges

### Application:

The **VANEC** Model 121 Exhaust Silencer is designed for use in suppressing the exhaust noise of any internal combustion engine, and a variety of rotary blowers and vacuum pumps.

Typical Performance

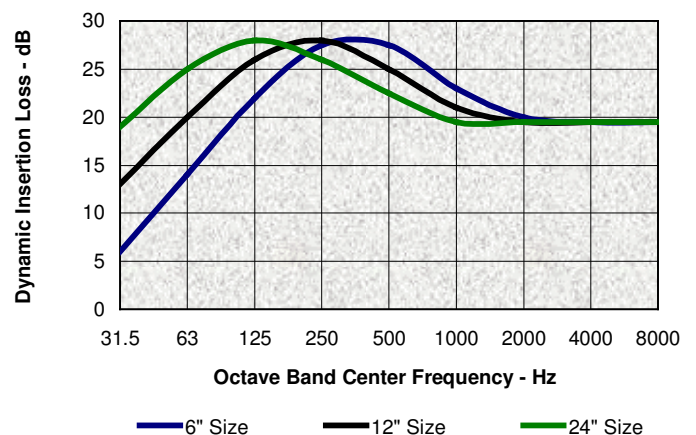

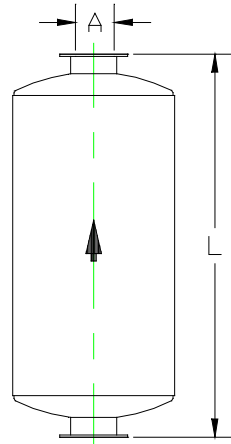
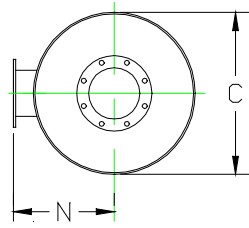
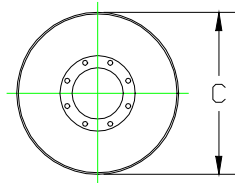

End Inlet -  
End Outlet  
("A" Configuration)

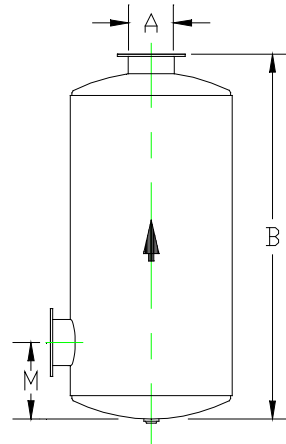

Low Side Inlet -  
End Outlet  
("B" Configuration)

### VANEC Model 121

Model	Dimensions in Inches							Est. Wt. Lbs.
	All Models		"A" Config.	"B" Configuration Low Side Inlet			M	
	A	C		L	B	N		
					Min	Max		
121-08	8	24	86	82	16	14	36	320
121-10	10	26	87	83	17	16	36	465
121-12	12	30	100	96	19	17	40	740
121-14	14	36	124	119	22	21	51	1160
121-16	16	42	124	120	25	22	60	1660
121-18	18	42	154	150	25	22	78	2100
121-20	20	48	155	151	29	23	78	2400
121-22	22	54	171	167	32	23	82	3150
121-24	24	60	173	169	35	26	82	4450

**VANEC Industrial Silencers**  
716-827-4959