

2-3/4" EXTENDED LIP STRIKES

- For use where strike holes are inset into the jamb
- Constructed of 13 gauge material
- Brass plated

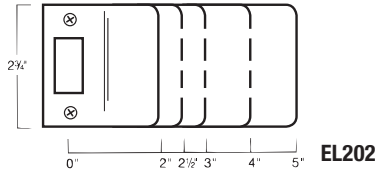

MFG #	SIZE	EZ #
EL202BP	2-3/4" x 2"	003162
EL225BP	2-3/4" x 2-1/2"	003165
EL203BP	2-3/4" x 3"	027712
EL205BP	2-3/4" x 5"	027711

LONG STRIKES

- Designed to work with key-in-knobs or deadbolts
- Constructed of 13 gauge steel

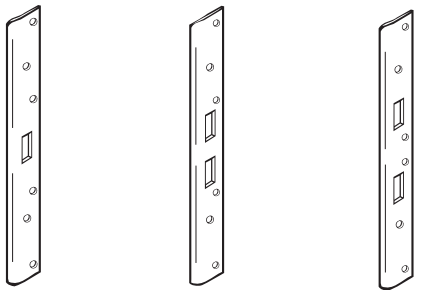

AST21341

AST21342

AST21346

MFG #	SIZE	FINISH	EZ #
SINGLE HOLE; TO WORK WITH KEY-IN-KNOB OR DEADBOLT			
FL208WBP	8" x 1-3/4"	Brass Plated	027850
FL208WSL	8" x 1-3/4"	Silver Plated	027844
FL212WBP	12" x 1-3/4"	Brass Plated	003171
FL212WSL	12" x 1-3/4"	Silver Plated	027847
AST21341BP	18" x 1-3/4"	Brass Plated	026250
DOUBLE HOLE; TO ACCOMMODATE 3-5/8" & 4" CENTRES			
FL212W4BP	12" x 1-3/4"	Brass Plated	027846
FL212W4SL	12" x 1-3/4"	Silver Plated	027845
AST21342BP	18" x 1-3/4"	Brass Plated	026251
DOUBLE HOLE; TO ACCOMMODATE 5-1/2" & 6" CENTRES			
FL212W6BP	12" x 1-3/4"	Brass Plated	027859
AST21346BP	18" x 1-3/4"	Brass Plated	003145
AST21346SL	18" x 1-3/4"	Silver Plated	084880



PUSH/PULL PLATE & KICK PLATES

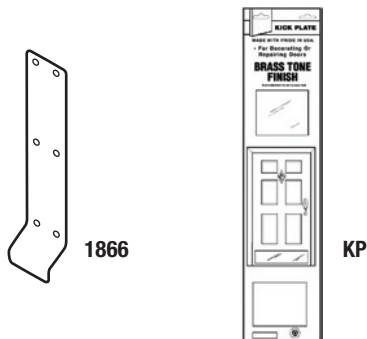

1866

- Constructed of 11 gauge stainless steel
- Projection: 1-1/4"
- ANSI A156.6 J303

KP

- Packaging includes an outer corrugation that protects the kick plate and allows it to be hung for display or stacked

MFG #	SIZE	FINISH	EZ #
1866 630	3-1/2" x 15-3/4"	Stainless Steel	101979
KP634 630	6" x 34"	Satin Stainless	100384

DEADBOLT SECURITY STRIKE, "T" STRIKE & DOOR HARDWARE

DEADBOLT SECURITY STRIKES

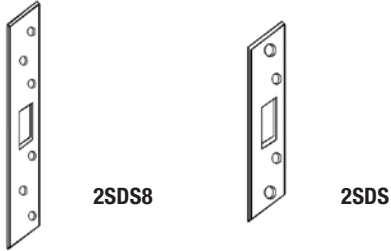

- Supplied with 3" screws to penetrate frame studs for additional strike strength
- Constructed of 13 gauge steel

MFG #	FINISH	SIZE	EZ 3
2SDS SL	Silver Coated	4-7/8" x 1-1/4"	051364
2SDS8 B	Brass Plated	8" x 1-3/8"	100382
2SDS8SL	Silver Plated	8" x 1-3/8"	003230

"T" STRIKE

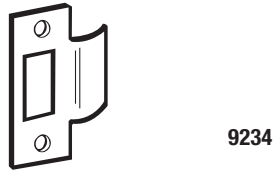

- Constructed of 18 gauge material

MFG #	FINISH	SIZE	EZ #
9234 630	Satin Stainless	2-3/4" x 1-1/8"	100777

DOOR HARDWARE

D

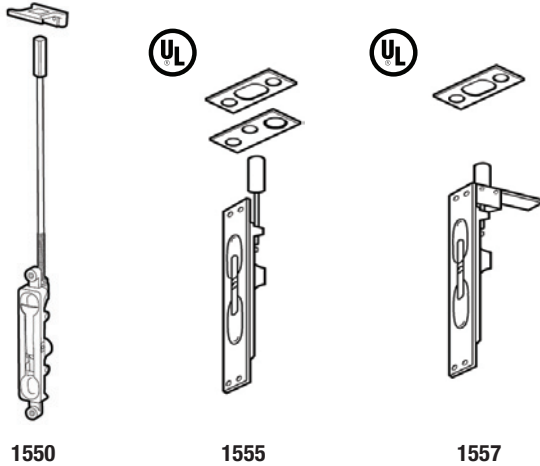

1550: ALUMINUM DOOR FLUSH BOLT

- 1/8" offset
- Radius end

1555: METAL FLUSH BOLT

- Fits ANSI door & frame prep
- 3/4" bolt throw, 3/4" rod backset
- 12" rod length, 1-1/2" adjustable bolt head
- Metal doors faceplate: 1" x 6-3/4", strike: 15/16" x 2-1/4", guide: 1" x 2"

1557: WOOD FLUSH BOLT

- Wood door faceplate: 1" x 6-3/4", strike: 15/16" x 2-1/4"
- 3/4" bolt throw, 3/4" backset
- Door strength maintained by corner reinforcement plate

1603: DOOR FLIP GUARD

- Ball bearing design secures flip guard to lock door from interior for additional security

2080: GRAVITY DOOR COORDINATOR

- Drop arm type gravity door coordinator
- Adjustable
- Field reversible
- Brass

HDCC2512: HEAVY DUTY CRASH CHAIN

- Heavy duty steel chain prevents door from opening wide when caught by high winds

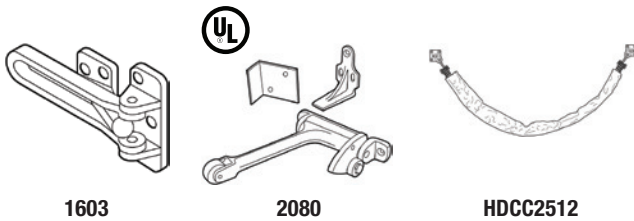

MFG #	FINISH	SIZE	EZ #
1550DU	Duro	15/16" x 4-1/4"	081812
1550SL	Silver Coated	15/16" x 4-1/4"	081811
1555 626	Satin Chrome	1" x 6-3/4"	074790
1557 626	Satin Chrome	1" x 6-3/4"	081700
1603 605	Polished Brass	—	100387
2080 626	Satin Chrome	—	074976
HDCC2512	Gray	25-1/2"	077853