

# BASEMENT DEVELOPMENT WORKSHEET

Permit Name: \_\_\_\_\_

Civic Address: \_\_\_\_\_

**Complete the following:**

Stairs

The stairs leading into the basement must be enclosed with walls and a handrail or protected by guards on all sides not protected by a wall. Guards must be not less than 900 mm (36") measured from the nosing of the stairs.

Bedroom Windows (Window opening must be not less than .35 m<sup>2</sup> (3.9 ft<sup>2</sup>))

- Style of window:
- Inswing awning
  - Casement
  - Slider
  - Outswing awning

Size of window: \_\_\_\_\_" x \_\_\_\_\_"

Size of window opening: \_\_\_\_\_" x \_\_\_\_\_"

Smoke Alarm & Carbon Monoxide Detector

Smoke alarm and carbon monoxide detector required within 5 m (16') of the bedroom doors.

Ventilation System

The washroom must be vented to the exterior.

Connected to the house ventilation system:

Separate fan vented to the exterior:

Fireplace

Natural gas:

Wood burning:

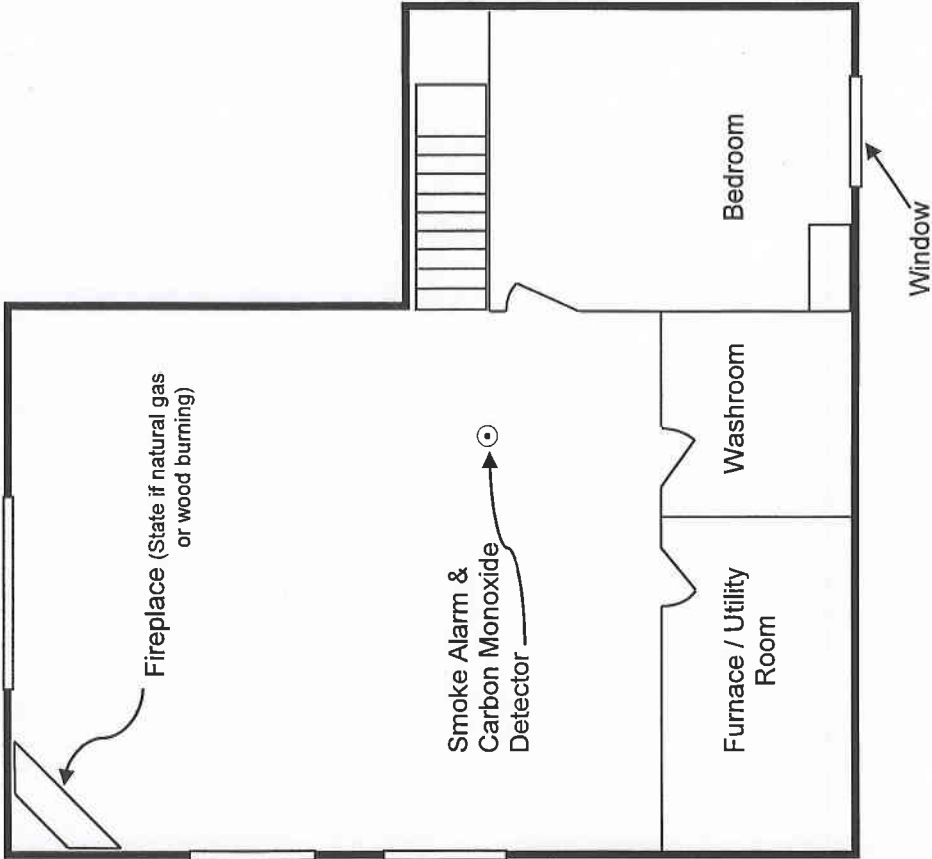

**Complete the following:**

Area of the basement being developed: \_\_\_\_\_ ft<sup>2</sup>



**Meridan  
inspections Ltd**