

ELECTRICAL DATA

Impedance : 50ohm
Frequency range : DC to 4GHz
Contact current : DC 1.5A max.
Voltage rating : 250V rms
Contact resistance : 3.0 M Ω - Center contacts
0.5 M Ω - Outer contacts
Insulation resistance : 1000 M Ω min.
Insertion loss : 0.6dB max.
VSWR : 1.4+0.06f(GHz)
RF leakage : -55dBm min. between 2-3GHz

MECHANICAL DATA

Engagement force : Max. 63N
Life : 500 matings
Contact captivation : Max. 15N

ENVIRONMENTAL DATA

Temperature range : -65°C ~ +125°C
Corrosion resistance : MIL-STD-202, Method 101, Condition B
Moisture resistance : MIL-STD-202, Method 106
Thermal shock : MIL-STD-202, Method 107, Condition B
Vibration : MIL-STD-202, Method 204, Condition D

Part	Material	Plating
Body	Brass	Gold
Center Contact	Brass	Gold
Insulator	PTFE	—

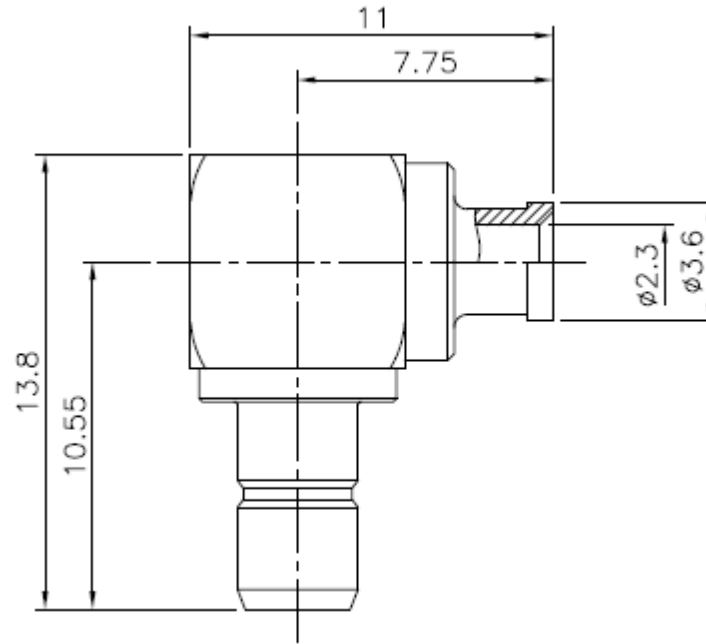

Dimensions are in mm,
for reference only, and are
subject to change
without notice.



Premier RF

17 Roslyn CT
Patchogue, NY 11772
PH: 631-447-3804
sales@premierRF.com
www.premierRF.com

PART NUMBER

PRF-CO8MR1-BG

DESCRIPTION

**SMB RIGHT ANGLE JACK
MALE, FOR .085 CABLE**

8/23/2013

APPROVED

A. Ianacci