

BECOME A MEMBER

- Free admission to the Port St. Lucie Botanical Gardens
- 10% off most Gift Shop purchases
- Garden Center Member Specials
- Reciprocal Admission and/or Discounts to American Horticultural Society Member Gardens
- Members Only Events
- Members Access or Discounts on Selected Classes, Seminars & Events
- Annual Members & Volunteers Holiday Gathering

Memberships in The Friends of the Port St. Lucie Botanical Gardens are for one calendar year, beginning on the date initiated.

- **Individual:** \$35* One adult member
- **Family & Friends:** \$50 2 adults and children under 18 in same household, plus 2 guest passes good for the term of the membership.
- **Business/ Corporate:** \$75 Benefits extended to 2 individuals; a link on our website to the Business/Corporation
- **Student:** \$15 Individual student 18-22 years old; must have valid Student ID

Each membership has the right of one vote in elections and matters requiring passage by the membership.

Rev.02.01.21



WHO WE ARE

The Gardens is managed and operated by Friends of the Port St. Lucie Botanical Gardens, Inc., a non-profit 501(c)(3) organization, that was founded to help support the daily operations of The Gardens. Friends volunteers provide hands-on daily oversight of the facility, including staffing to handle the many visitors year round. The Friends of the Port St. Lucie Botanical Gardens, Inc. receives no funding from any government agency. Your admission donations and Memberships help us maintain and grow The Gardens. Please consider becoming a member of Friends.



2410 SE WESTMORELAND BLVD.
PORT ST. LUCIE, FL 34952
PHONE - 772.337.1959
FAX - 772.237.5952
EMAIL - INFO@PSLBG.ORG
WEBSITE - WWW.PSLBG.ORG

MISSION STATEMENT

Friends' mission is to create and maintain a beautiful, serene sanctuary in the center of Port St. Lucie that is environmentally sound and naturally diverse and to provide educational, cultural and recreational opportunities for all who visit.



Hours: Wed - Sat 10am to 4pm • Sun 12 Noon to 4 pm
Pavilion Closed Mondays, Tuesdays & Major Holidays

THE PORT ST. LUCIE BOTANICAL GARDENS

GARDEN LEGEND

1. Garden Pavilion, Gift Shop, Conference & Rest Rooms
2. Orchid Room
3. Rose Garden
4. Butterfly Garden
5. Cactus and Succulent Garden
6. Bromeliad Island
7. Secret Garden
8. Native Plant Garden
9. Bamboo Room
10. Bonsai Garden
11. Hibiscus Garden
12. Daylily Garden
13. Kelly Pavilion
14. Garden Center Plant Sales and Propagation
15. Palm Walk Garden
- A. Butterfly Mosaic
- B. Scooter
- C. 3 Cubes Sculpture
- D. Armillary Sphere
- F. Faerie Forrest
- M. Maintenance Bldg
- P. Picnic Benches
- R. Rainbow Eucalyptus
- V. Veterans Victory Garden
- * Benches

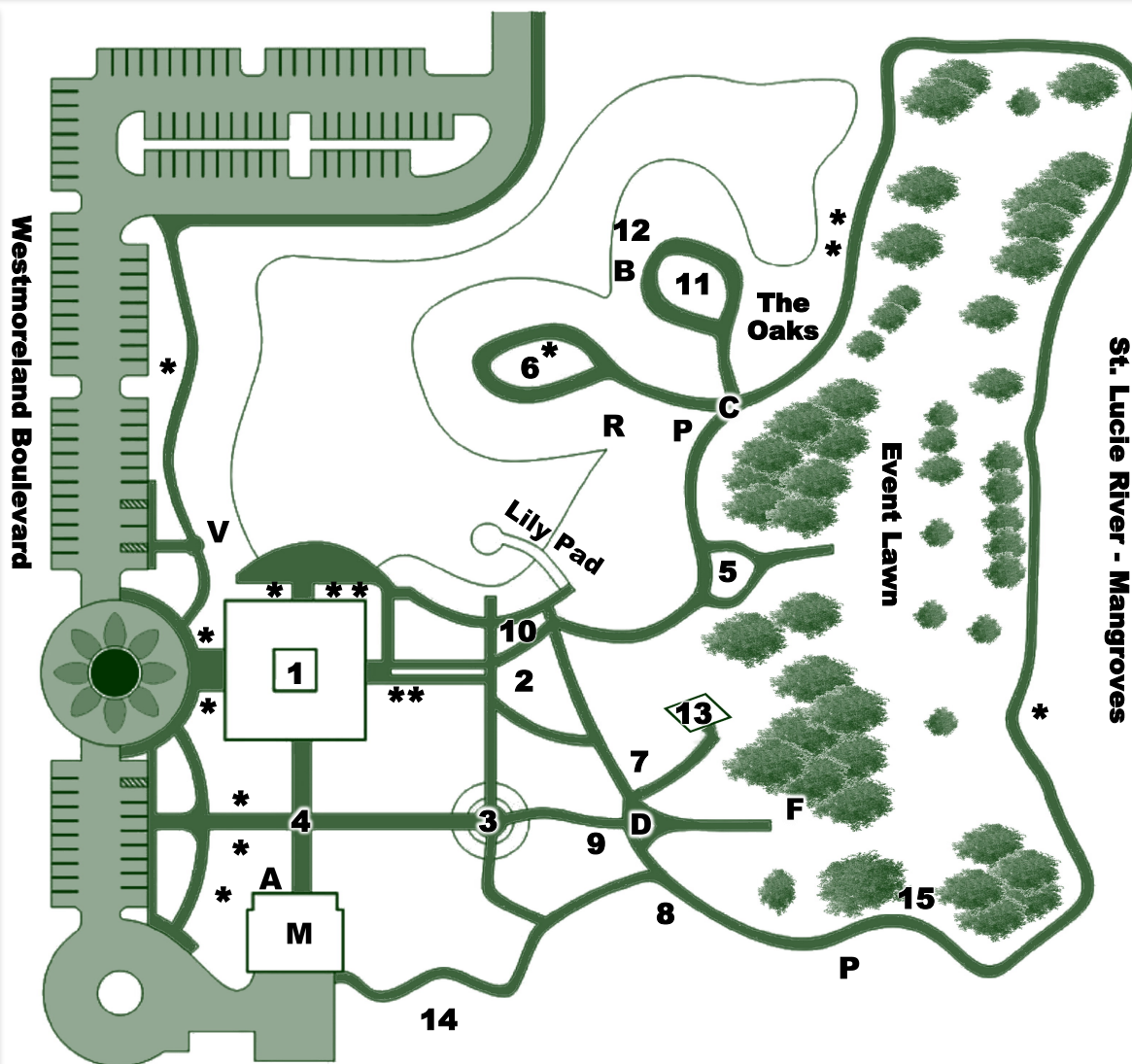

THE GARDENS

The Port St. Lucie Botanical Gardens held its public grand opening on March 6, 2010. The Gardens sit on +/- 20 acres of property on the west side of Westmoreland Boulevard, just south of Port St. Lucie Blvd., conveniently located within the city. The property was acquired through the joint efforts of the City of Port St. Lucie, St. Lucie County, and the Florida Trust for Public Lands.

The site boasts a lake with a fountain and catch and release fishing, convenient paths, beautiful gardens, a pavilion, a gift shop and an array of spaces both inside and out for weddings, meetings, receptions and a host of other events. There is an abundance of convenient on-site parking. The Gardens wetlands and mangroves sit on the banks of the beautiful, pristine North Fork of the St. Lucie River. This site is comprised of Scrub, Scrubby Flatwoods, Bay-Gall and Wet Flatwoods, with a mangrove fringe. The 12.87 acres south of The Gardens access road will be maintained as undisturbed Florida wetlands, subject only to the removal of exotics and maintenance of an eventual walking trail.

GARDEN FACTS.....GARDEN FACTS.....GARDEN FACTS

- Opened March 2010
- Size - 21 acres (minus wetlands & mangroves, just over 7.5 acres)
- Lake - 2+ acres, 12 feet deep
- Size of Pavilion - 4100 sq. ft. & can accommodate up to 375 regular seating, 125 table seating, or 100 table seating with a dance floor.
- Amphitheater - Seats 140-160 with additional standing on Pavilion Plaza
- Sidewalks - 6 feet wide. Length 0.91 miles
- Park Benches - 15 scattered throughout
- Picnic tables - 2 within The Gardens
- Cafe tables and chairs on the veranda
- Parking - 41 paved and 85 stabilized spaces for a total of 126
- The Gardens is ADA compliant.

