

CITY OF HOUSTON

DEPARTMENT OF PUBLIC WORKS AND ENGINEERING ENGINEERING AND CONSTRUCTION DIVISION

STORM DRAINAGE IMPROVEMENTS IN THE RUSTLING OAKS SUBDIVISION

WBS NO. M-000249-0001-4

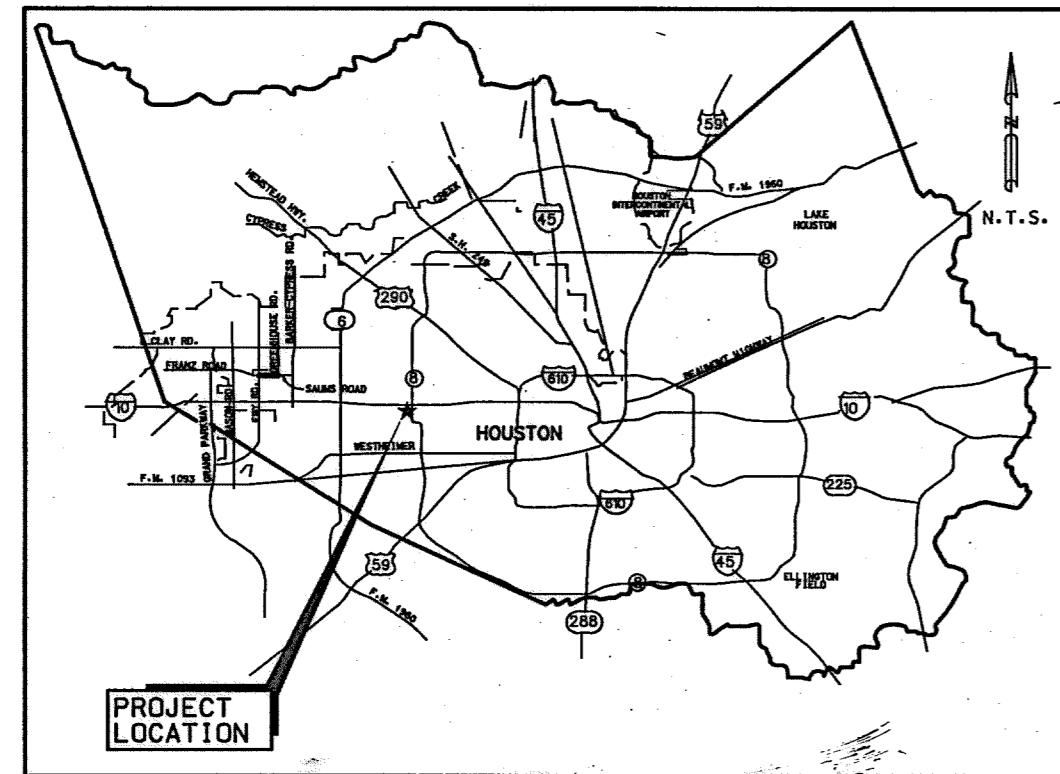

LOCATION MAP
N.T.S.

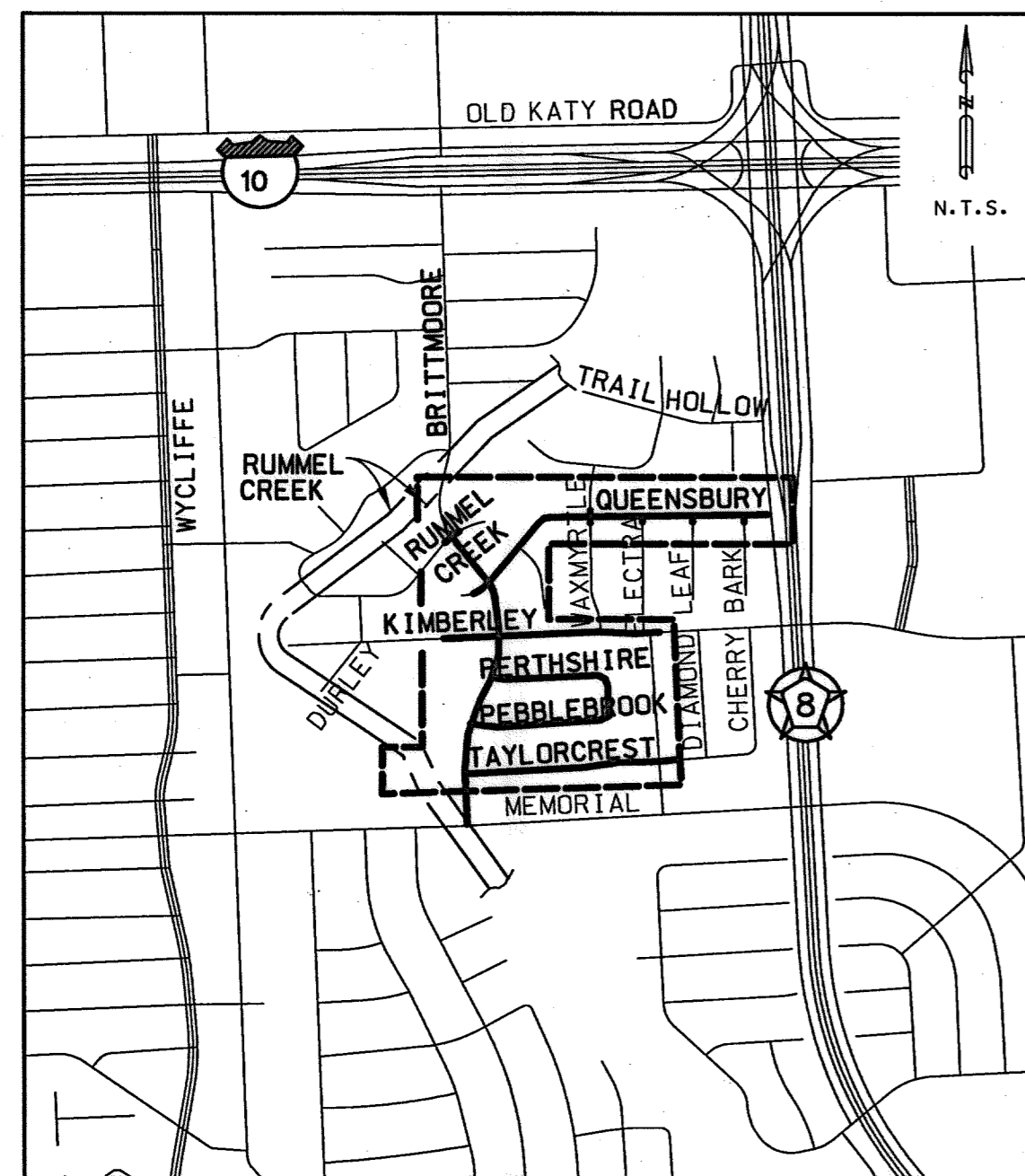

VICINITY MAP
N.T.S.

KEY MAP 489 C & G
GIMS MAP #4957a & #4958c
COUNCIL DISTRICT 'G'

AT&T LOG NO.022808VP01
CENTERPOINT LOG NO.33327

TDLR EABPRJ_A8810636

APPROVED:
HCPID-Permit Group
Flood Plain Management



MAYOR
BILL WHITE

CONTROLLER
ANNISE D. PARKER

DISTRICT
COUNCIL MEMBERS

TONI LAWRENCE
DISTRICT A

WANDA ADAMS
DISTRICT D

PAM HOLM
DISTRICT G

JARVIS JOHNSON
DISTRICT B

MIKE SULLIVAN
DISTRICT E

ADRIAN GARCIA
DISTRICT H

ANNE CLUTTERBUCK
DISTRICT C

M.J. KHAN, P.E.
DISTRICT F

JAMES G. RODRIGUEZ
DISTRICT I

PETER BROWN
POSITION 1

MELISSA NORIEGA
POSITION 3

JOLANDA "JO" JONES
POSITION 5

COUNCIL MEMBERS
AT-LARGE

SUE LOVELL
POSITION 2

RONALD C. GREEN
POSITION 4

VanDeWiele
Engineering
Incorporated
Consulting
Engineers

2925 Briarpark, Suite 275
Houston, Texas 77042-3778
713/782-0042
www.vandewiele-eng.com

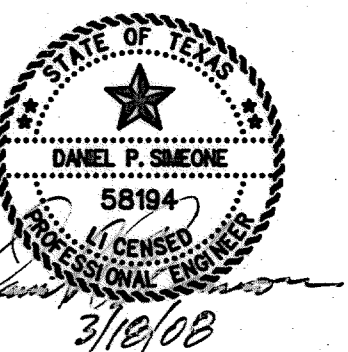

SURVEYED BY: KUO & ASSOCIATES, INC.
FB NO. P-5356

Cherry 4.21.08
WATER

WASTEWATER

STORM WATER

STREET & BRIDGE

CITY ENGINEER DATE

DIRECTOR OF PUBLIC WORKS AND ENGINEERING DATE

SHEET NO 1 OF 108 SHEETS



CONSTRUCTION

Richard Kowich 4-22-08
TRAFFIC AND TRANSPORTATION

SPONSOR DEPARTMENT

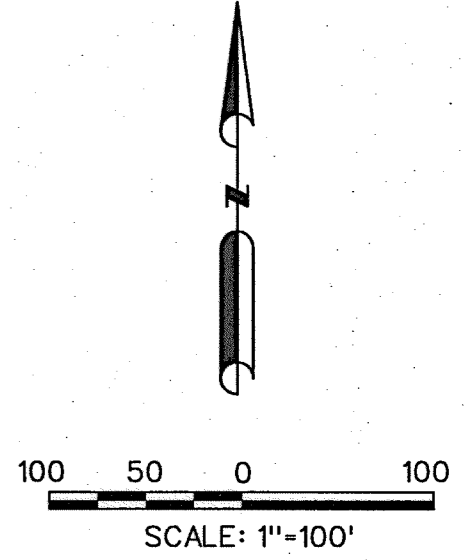
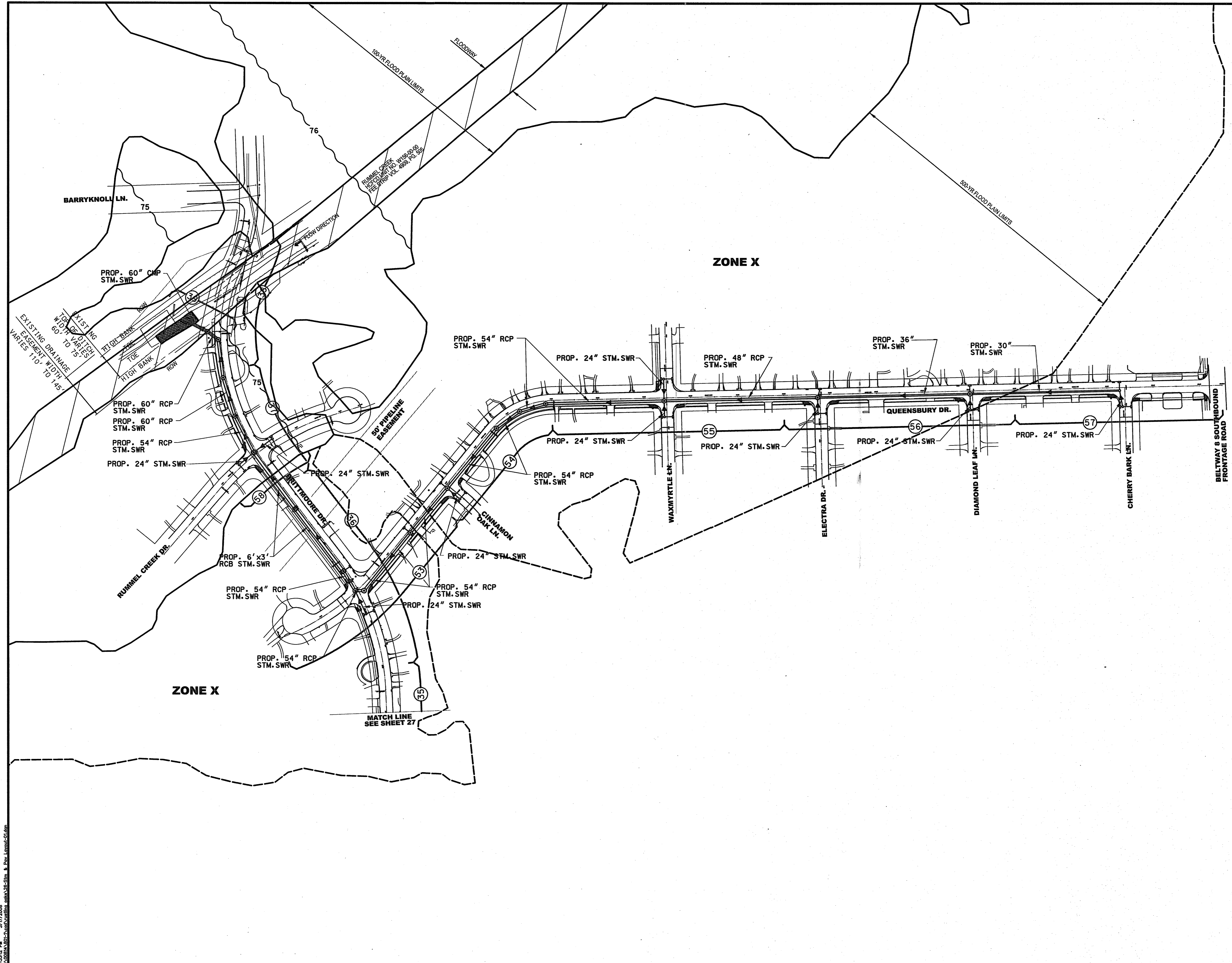
CHIEF ENGINEER



- LEGEND**
-  SHEET NUMBERS
 -  FLOW DIRECTION
 -  PROPOSED PAVEMENT

No.	DATE	REVISIONS	APP.



VanDeWiele
Engineering
Incorporated

2925 Briarpark, Suite 275
Houston, Texas 77042-3778
713/782-0042
www.vandewiele-eng.com

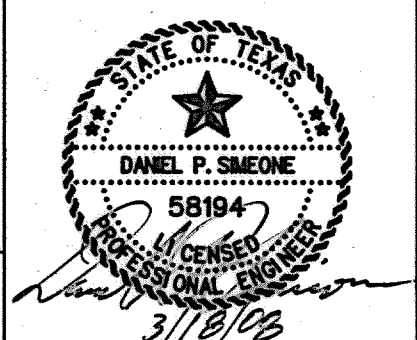

SURVEYED BY:
KIO & ASSOCIATES, INC.
FB No. P-5356



CITY OF HOUSTON
DEPARTMENT OF PUBLIC WORKS AND ENGINEERING
STORM DRAINAGE IMPROVEMENTS IN THE
RUSTLING OAKS SUBDIVISION

PROPOSED STORM AND
PAVEMENT LAYOUT
(SHEET 1 OF 2)

WBS NUMBER	M-000249-0001-4
DRAWING SCALE	1"=100'
CITY OF HOUSTON PM	Mr. Mohammad Sabzevari, PE
SHEET No.	26 OF 108

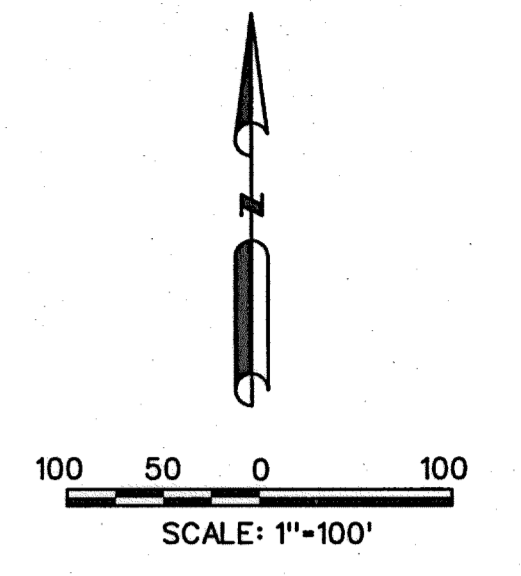
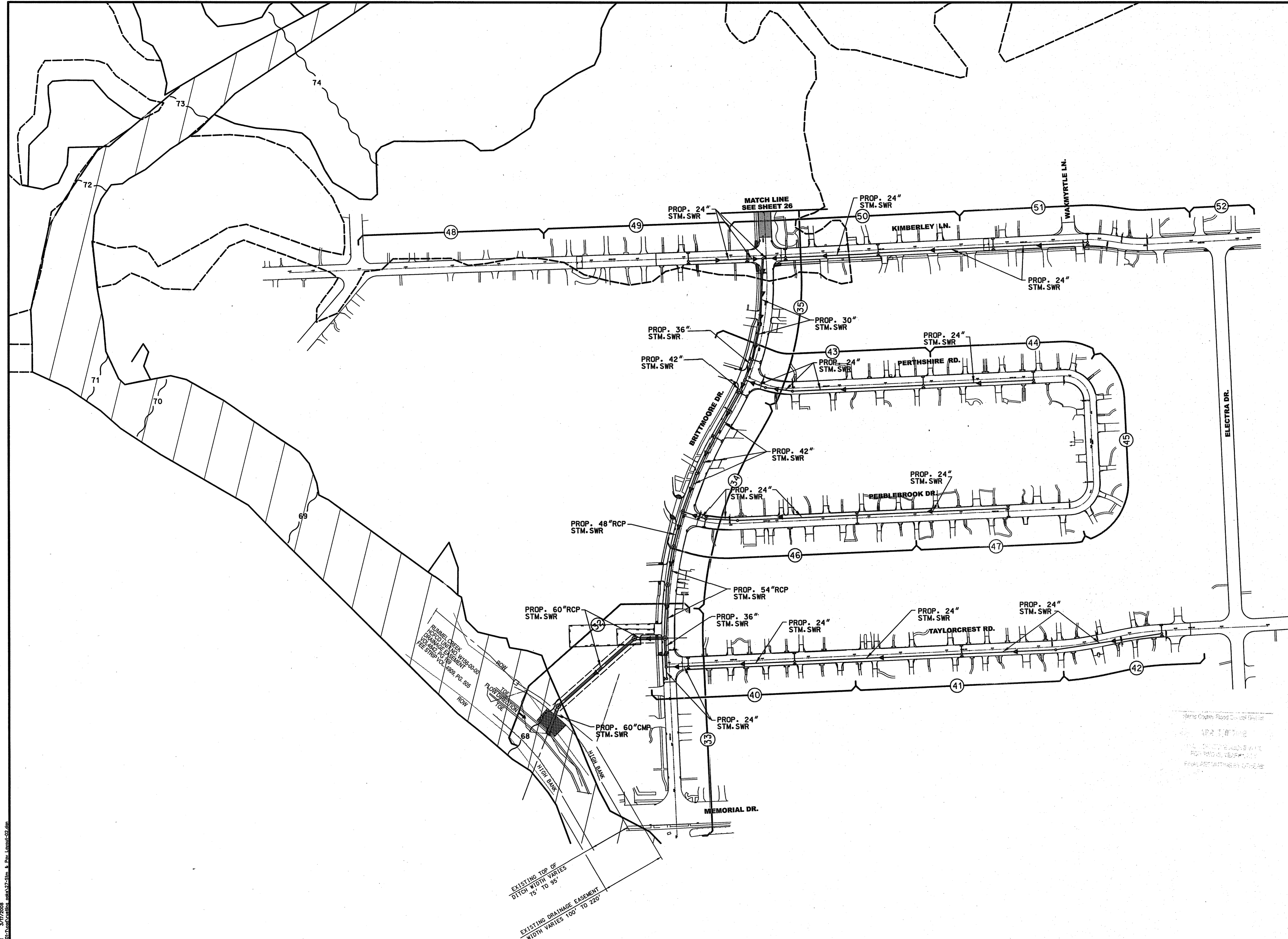
Date: 03/17/2009
 Author: KIO & ASSOCIATES, INC.
 Title: Storm & Pav. Layout-01.dwg

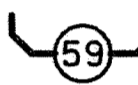

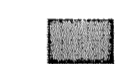
- LEGEND**
-  SHEET NUMBERS
 -  FLOW DIRECTION
 -  PROPOSED PAVEMENT

No.	DATE	REVISIONS	APP.



VanDeWiele Engineering Incorporated

2925 Briarpark, Suite 275
Houston, Texas 77042-3778
713/782-0042
www.vandewiele-eng.com

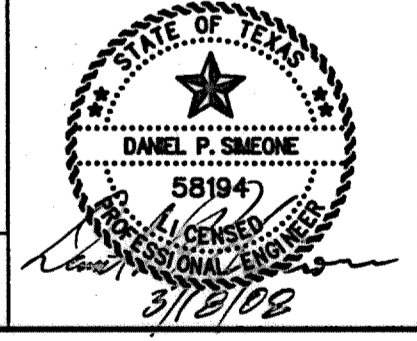

SURVEYED BY:
KUD & ASSOCIATES, INC.
FB No. P-5356

CITY OF HOUSTON
DEPARTMENT OF PUBLIC WORKS AND ENGINEERING

STORM DRAINAGE IMPROVEMENTS IN THE
RUSTLING OAKS SUBDIVISION

**PROPOSED STORM AND
PAVEMENT LAYOUT
(SHEET 2 OF 2)**

WBS NUMBER	M-000249-0001-4
DRAWING SCALE	1"=100'
CITY OF HOUSTON PM	Mr. Mohammad Sabzevari, PE
SHEET No. 27 OF 108	

Drawn by: 2/17/02
 Checked by: 2/17/02
 Approved by: 2/17/02
 Date: 2/17/02
 Project: Rustling Oaks Subdivision
 Sheet: 27 of 108

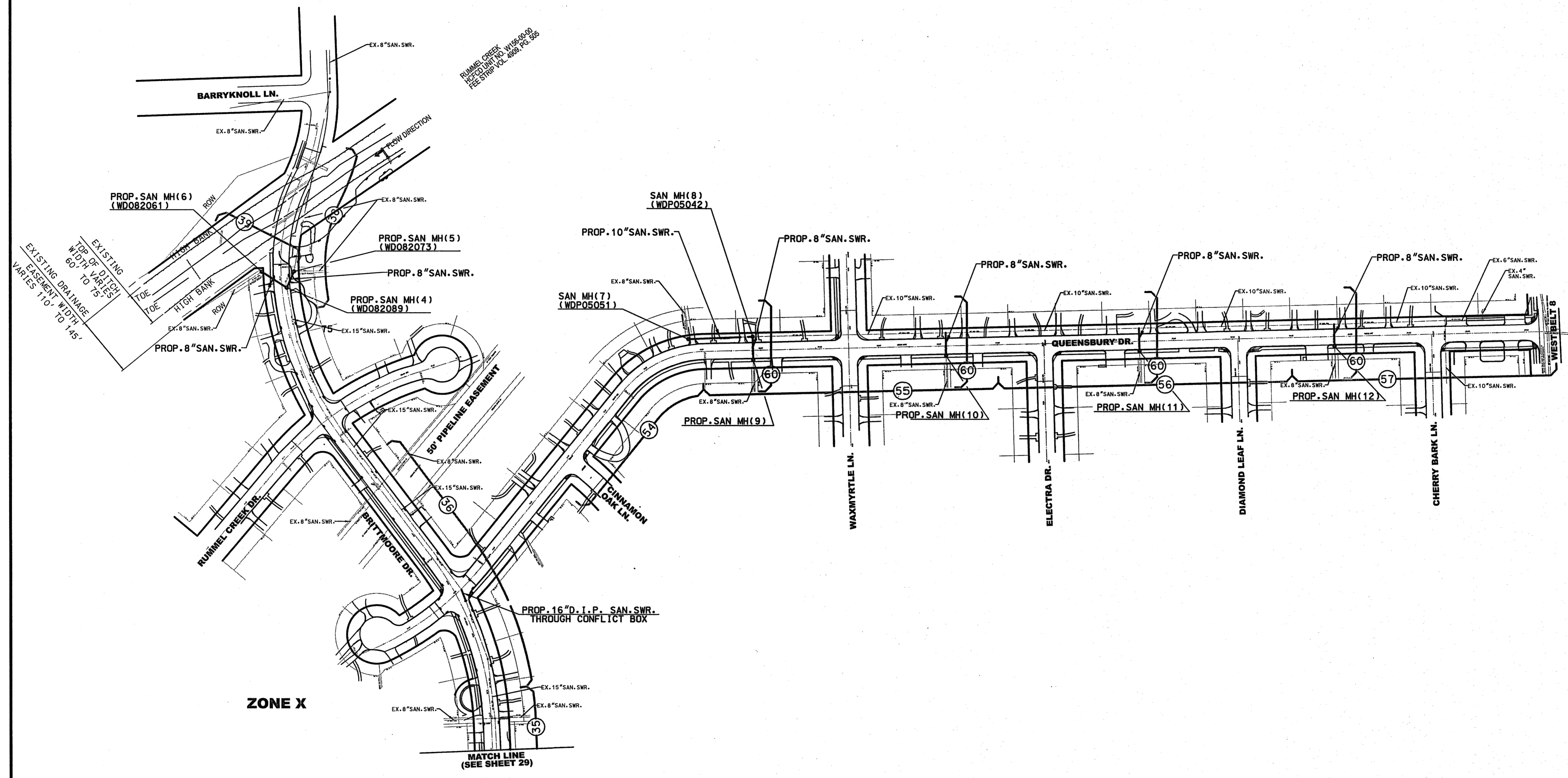
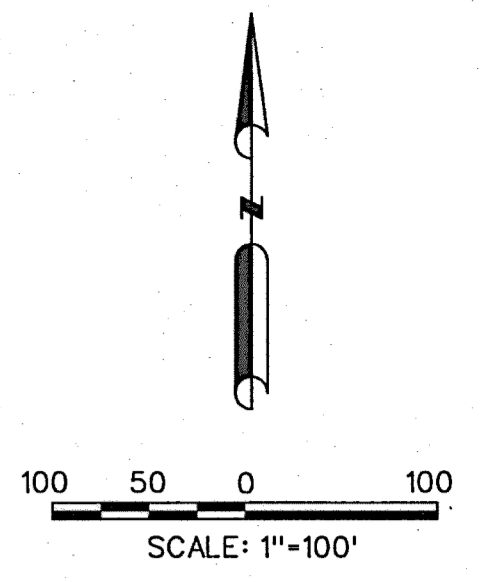

LEGEND
 SHEET NUMBERS

No.	DATE	REVISIONS	APP.



VanDeWiele
 Engineering
 Incorporated

2925 Briarpark, Suite 275
 Houston, Texas 77042-3778
 713/782-0042
 www.vandewiele-eng.com

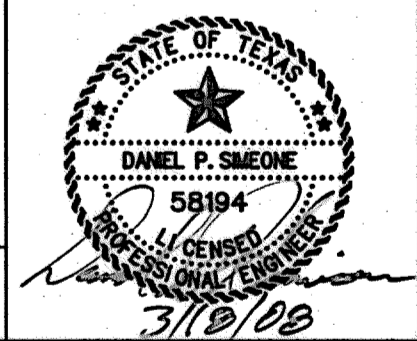

SURVEYED BY:
 RIO & ASSOCIATES, INC.
 FB No. P-5356

CITY OF HOUSTON
 DEPARTMENT OF PUBLIC WORKS AND ENGINEERING
 STORM DRAINAGE IMPROVEMENTS IN THE
 RUSTLING OAKS SUBDIVISION
 PROPOSED SANITARY SEWER
 OVERALL LAYOUT
 (SHEET 1 OF 2)

WBS NUMBER	M-000249-0001-4
DRAWING SCALE	1"=100'
CITY OF HOUSTON PM	M. Mohammad Sabzevari, PE
SHEET No.	28 OF 108

Date: 3/17/08
 Drawn by: M. Mohammad Sabzevari
 Checked by: M. Mohammad Sabzevari
 Title: Sanitary Sewer Overall Layout

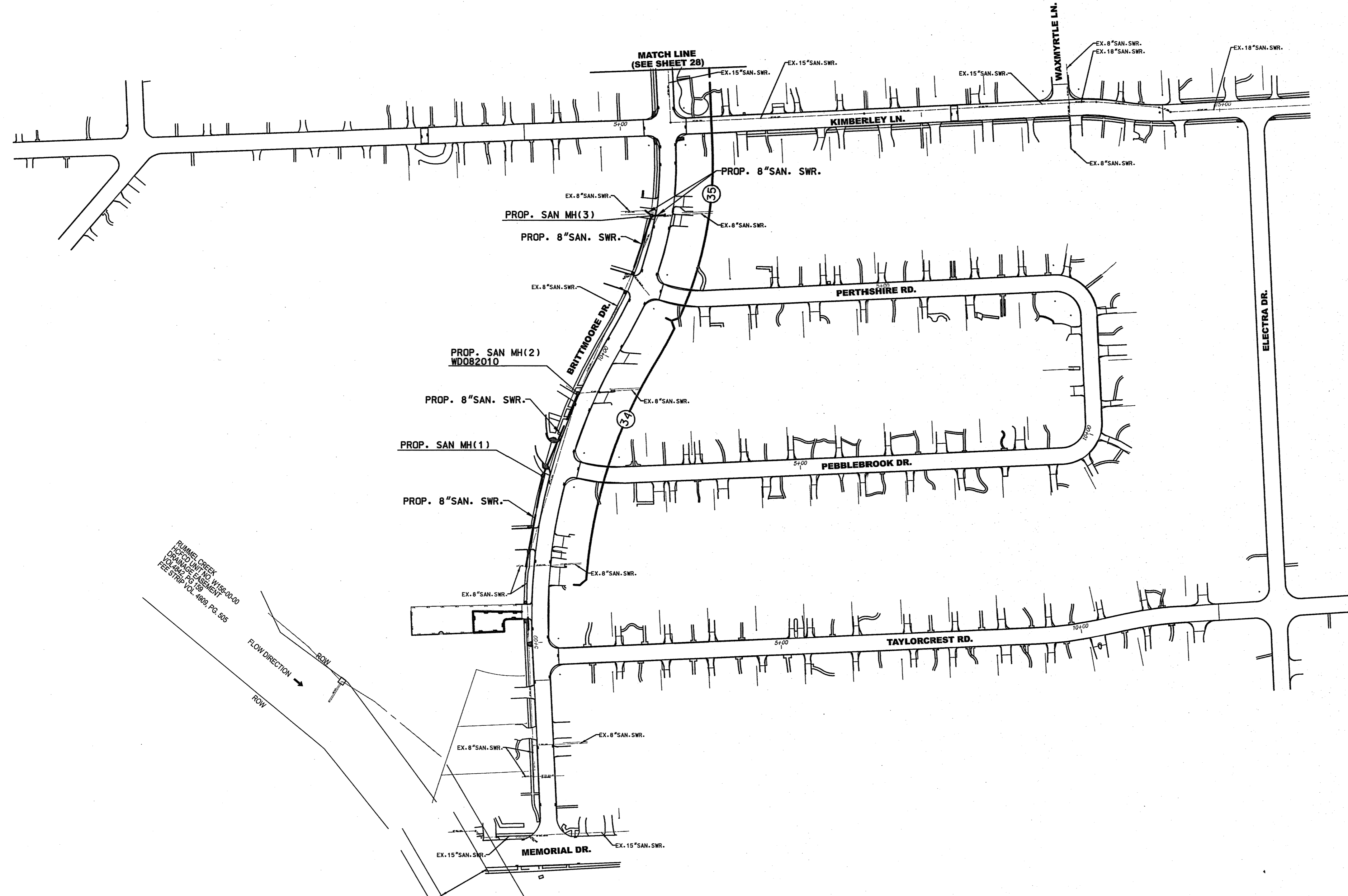
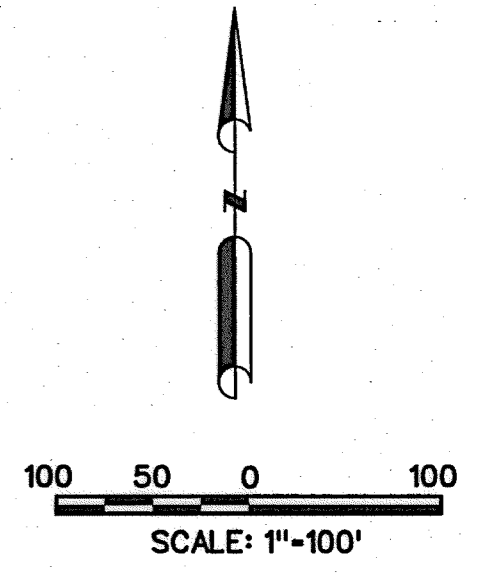

LEGEND



No.	DATE	REVISIONS	APP.

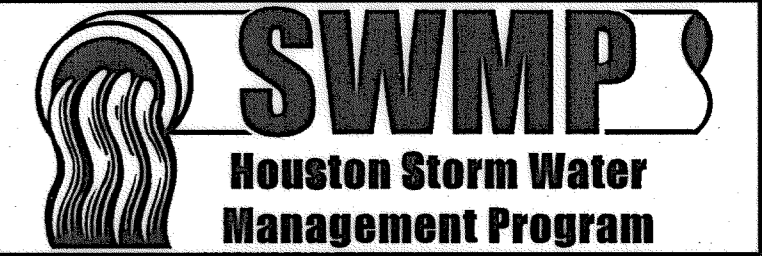

VanDeWiele Engineering Incorporated

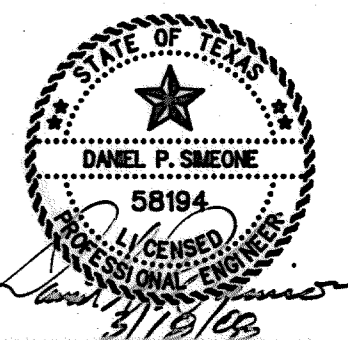

2925 Briarpark, Suite 275
Houston, Texas 77042-3778
713/782-0042
www.vandewiele-eng.com

SURVEYED BY:
KUD & ASSOCIATES, INC.
FB No. P-5356

CITY OF HOUSTON

DEPARTMENT OF PUBLIC WORKS AND ENGINEERING
STORM DRAINAGE IMPROVEMENTS IN THE
RUSTLING OAKS SUBDIVISION

PROPOSED SANITARY SEWER
OVERALL LAYOUT
(SHEET 2 OF 2)

WBS NUMBER	
M-000249-0001-4	
DRAWING SCALE	
1"=100'	
CITY OF HOUSTON PM	
Mr. Mohammad Sabzevari, PE	
SHEET No. 29 OF 108	

Drawn: PM 3/17/2008
 C:\008158\DWG\1008158\1008158-01-29-DW-301.dwg Layout29.dwg

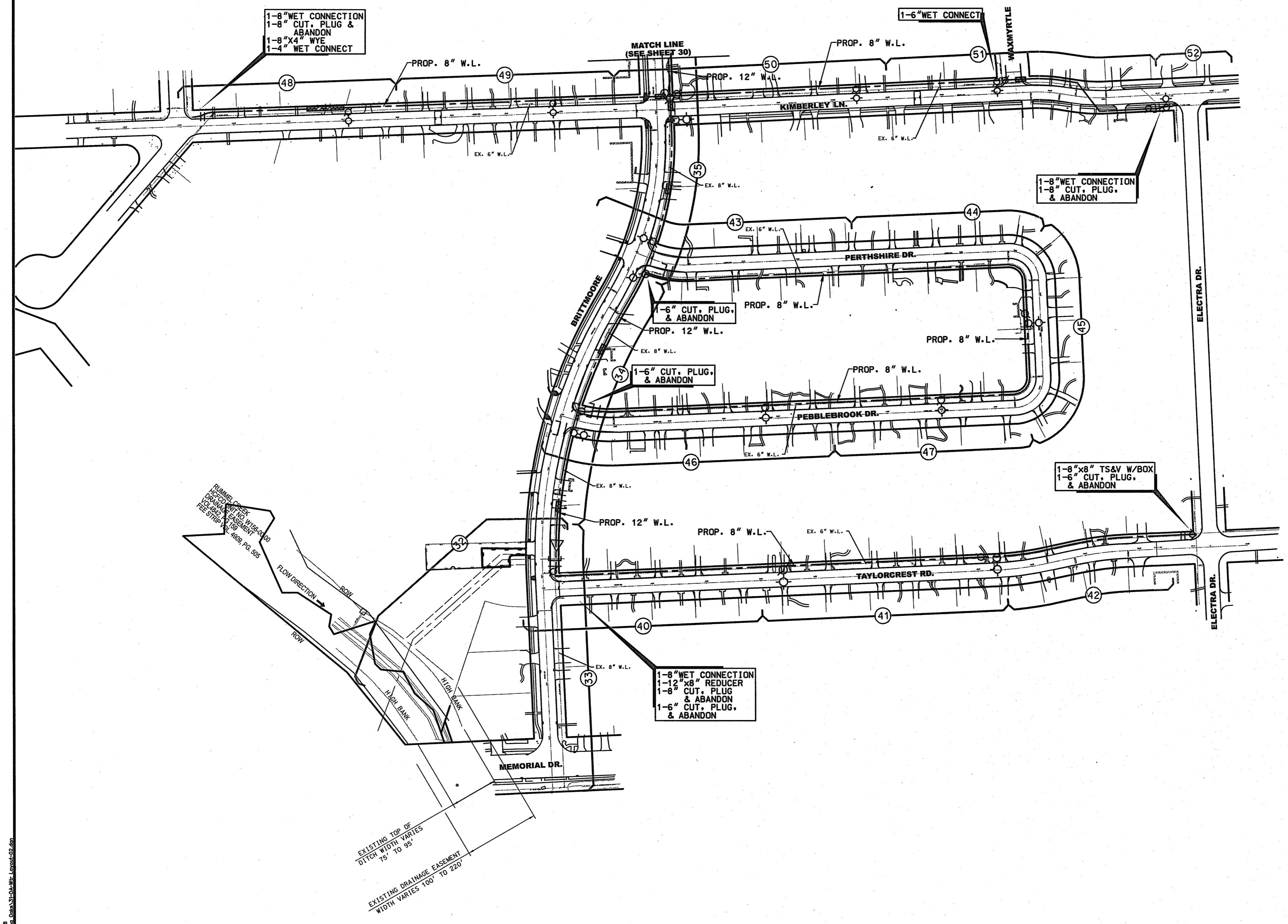
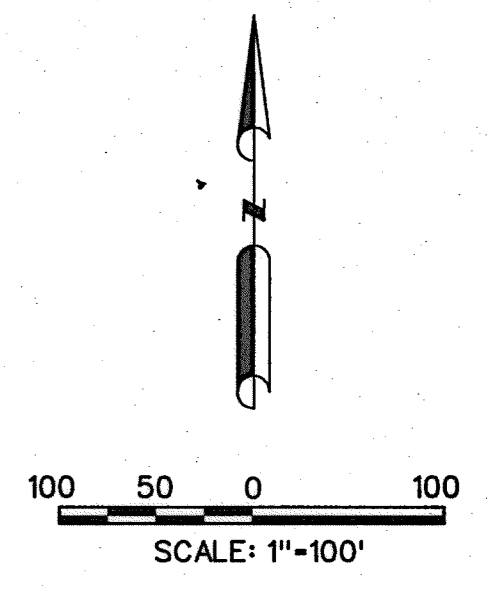

- LEGEND**
- (59) SHEET NUMBERS
 - PROP. FIRE HYDRANT W/GATE VALVE
 - PROP. TAPPING SLEEVE AND VALVE WITH BOX
 - PROP. CUT, PLUG & ABANDON
 - PROP. GATE VALVE
 - PROP. REDUCER
 - PROP. BLOW OFF VALVE
 - ▨ PROP. RESTRAINED JOINT PIPE SECTION
 - EXIST. FIRE HYDRANT W/GATE VALVE
 - EXIST. GATE VALVE

No.	DATE	REVISIONS	APP.

SWMP
Houston Storm Water Management Program

VanDeWiele Engineering Incorporated

2925 Briarpark, Suite 275
Houston, Texas 77042-3778
713/782-0042
www.vandewiele-eng.com

DANIEL P. SWEENEY
58194
Professional Engineer
3/25/06

SURVEYED BY:
KUD & ASSOCIATES, INC.
FB No. P-5356

CITY OF HOUSTON
DEPARTMENT OF PUBLIC WORKS AND ENGINEERING

STORM DRAINAGE IMPROVEMENTS IN THE RUSTLING OAKS SUBDIVISION

PROPOSED WATER LINE OVERALL LAYOUT
(SHEET 2 OF 2)

WBS NUMBER	M-000249-0001-4
DRAWING SCALE	1"=100'
CITY OF HOUSTON PM	Mr. Mohammad Sabzevari, PE
SHEET No.	31 OF 108

3/25/06 AM 3:25:06 PM
 C:\WORK\2006\3152\DWG\3152-0001-4.dwg
 3152-0001-4.dwg

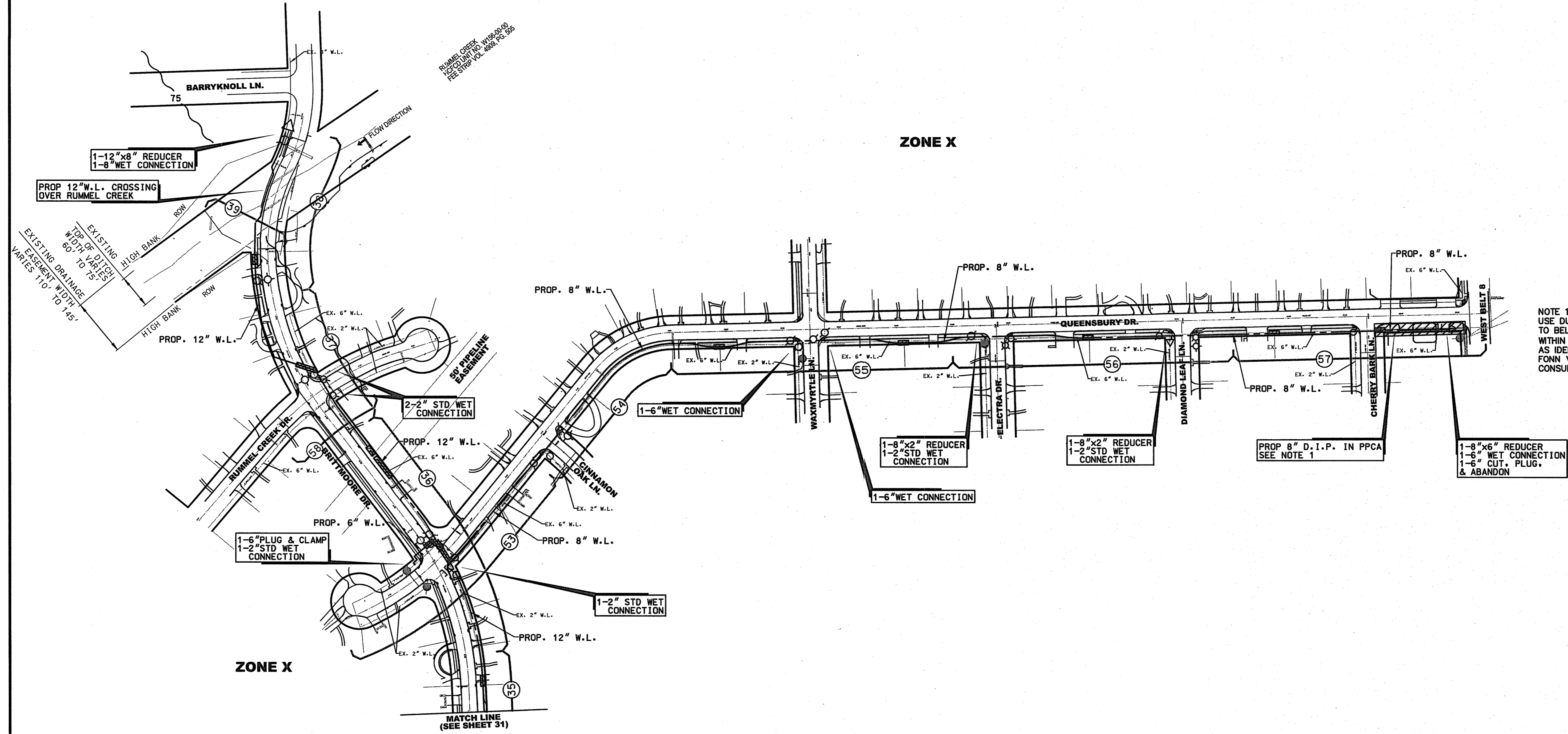
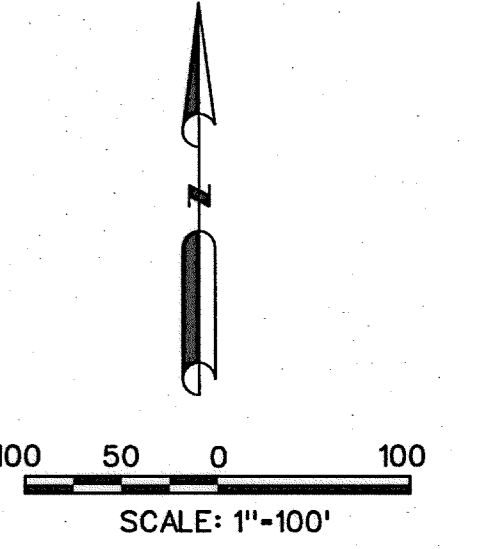

- LEGEND**
- (59) SHEET NUMBERS
 - PROP. FIRE HYDRANT W/GATE VALVE
 - PROP. TAPPING SLEEVE AND VALVE WITH BOX
 - PROP. CUT, PLUG & ABANDON
 - PROP. GATE VALVE
 - △ PROP. REDUCER
 - ⊠ PROP. BLOW OF VALVE
 - ▨ PROP. RESTRAINED JOINT PIPE SECTION
 - EXIST. FIRE HYDRANT W/GATE VALVE
 - EXIST. GATE VALVE

NOTE 1:
 USE DUCTILE IRON PIPE WATER LINE FROM CHERRY BARK LANE TO BELTWAY 8 - THIS PIPE SEGMENT WAS DETERMINED TO BE WITHIN A POTENTIALLY PETROLEUM CONTAMINATED AREA (PPCA) AS IDENTIFIED IN PHASE I ENVIRONMENTAL SITE ASSESSMENT FONN VILLAS AND RUSTLING OAKS HOUSTON, TEXAS, CORRIGAN CONSULTING, INC., AUGUST 2000.

No.	DATE	REVISIONS	APP.

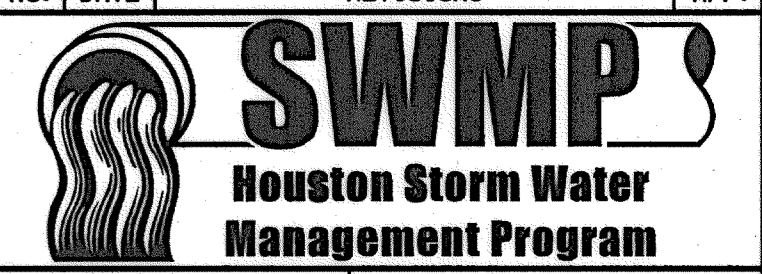

VanDeWiele
 Engineering
 Incorporated
 2925 Briarpark, Suite 275
 Houston, Texas 77042-3778
 713/782-0042
 www.vandewiele-eng.com
 SURVEYED BY:
 KUO & ASSOCIATES, INC.
 FB No. P-5356
 3/12/00

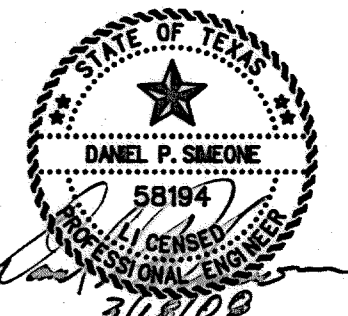

CITY OF HOUSTON
 DEPARTMENT OF PUBLIC WORKS AND ENGINEERING
 STORM DRAINAGE IMPROVEMENTS IN THE
 RUSTLING OAKS SUBDIVISION
 PROPOSED WATER LINE
 OVERALL LAYOUT
 (SHEET 1 OF 2)

WBS NUMBER	M-000249-0001-4
DRAWING SCALE	1"=100'
CITY OF HOUSTON PM	Mr. Mohammad Sabzevari, PE
SHEET No.	30 OF 108

Drawn: 3/17/00
 Checked: 3/17/00
 Approved: 3/17/00
 Date: 3/17/00