

Golden Pacific II Poway

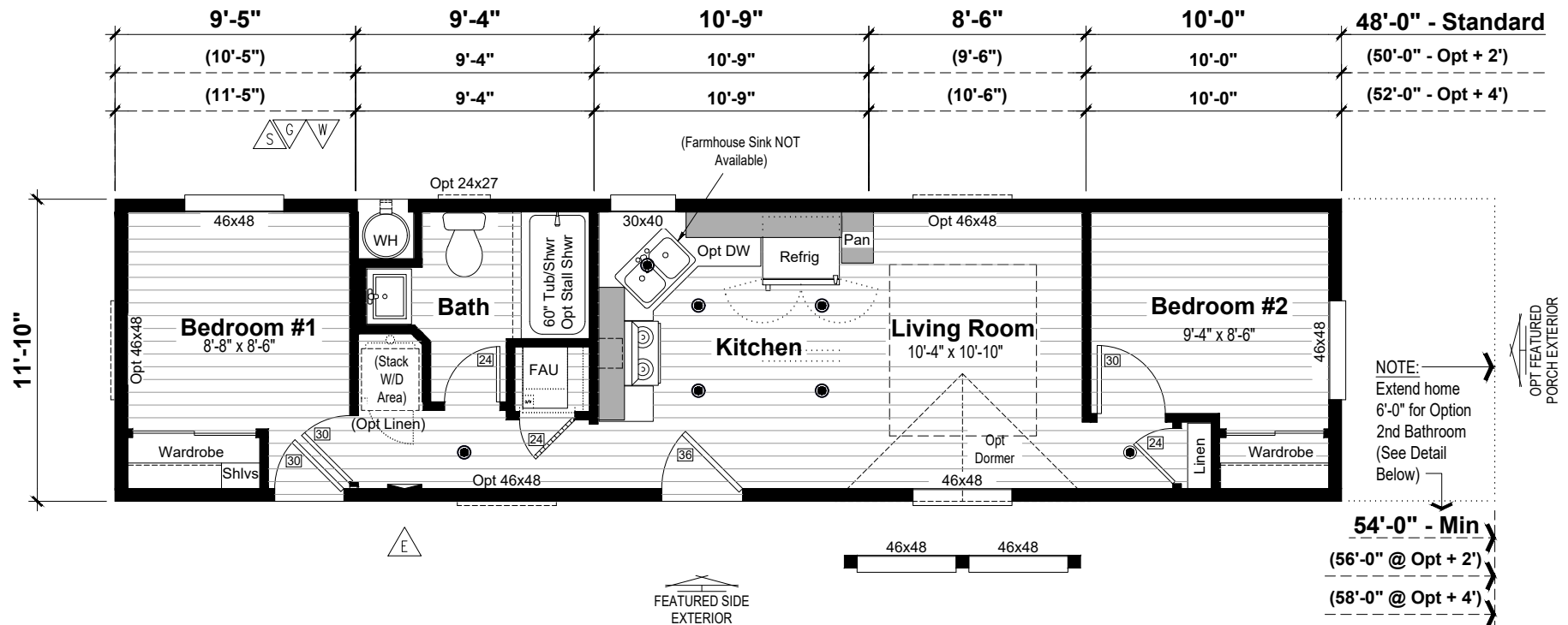

NOTE:
Extend home
6'-0" for Option
2nd Bathroom
(See Detail
Below)

OPT FEATURED
PORCH EXTERIOR

54'-0" - Min

(56'-0" @ Opt + 2')

(58'-0" @ Opt + 4')

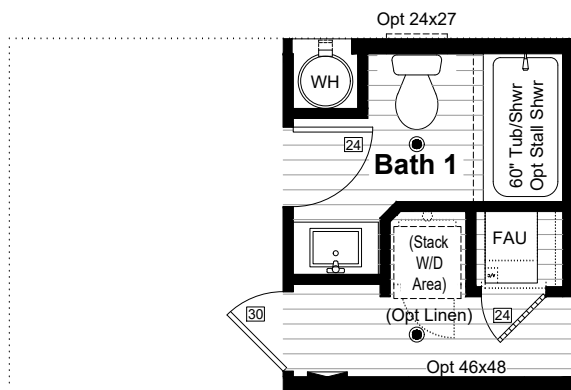

Opt Private Bath

(To Be Used w/ Option Bath 2)

Square Footage:

- 12x48 = 568 Sq. Ft.
- 12x50 = 492 Sq. Ft.
- 12x52 = 615 Sq. Ft.
- 12x54 = 639 Sq. Ft. (Opt Ba2)
- 12x56 = 662 Sq. Ft. (Opt Ba2)
- 12x58 = 686 Sq. Ft. (Opt Ba2)

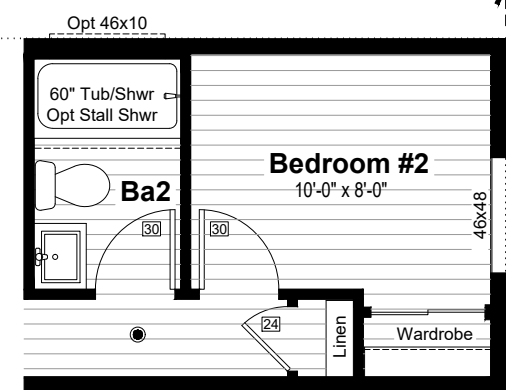

Option Bath 2

(Home Stretched 6'-0")

ADU Floorplan

NEW GPII-1248-2A

(2.2) 04.26.21 dh

