



2025 CATALOG

THE WORLD LEADER IN THE
MANUFACTURE OF FINISHED
COMPOSITE CRYSTAL AND
GLASS COMPONENTS

Onyx Optics, Inc.

6551 Sierra Lane

Dublin, CA 94568

Phone: (925) 833-1969

Email: sales@onyxoptics.com

[Visit Our Website](#)

[REQUEST A QUOTE HERE](#)

TABLE OF CONTENTS

YAG RODS:	PAGE 2
YAG DISKS:	PAGE 30
YAG SLABS:	PAGE 35
YVO4 SLABS:	PAGE 51
YVO4 RODS:	PAGE 63
YLF:	PAGE 65
YALO:	PAGE 69
MISC.:	PAGE 71
CRYSTALLINE FIBER WAVEGUIDES (CFW):	PAGE 76

PART #040128 AFB® 1.1% Nd:YAG Laser Rod | 4mm dia x 20mm L

SPECIFICATIONS Consisting of 1.1% Nd:YAG, 4mm dia. x 10mm L, with undoped YAG of 4mm dia x 5mm L bonded to both ends

Dopant Type, Concentration 1.1% Nd:YAG

Cross-Section 4mm dia.

Length 20mm L

Doped Length 10mm

Undoped Length 5mm L (2x)

End-Face Configuration Flat / Flat

Side Specifications Fine Ground

Quantity 22

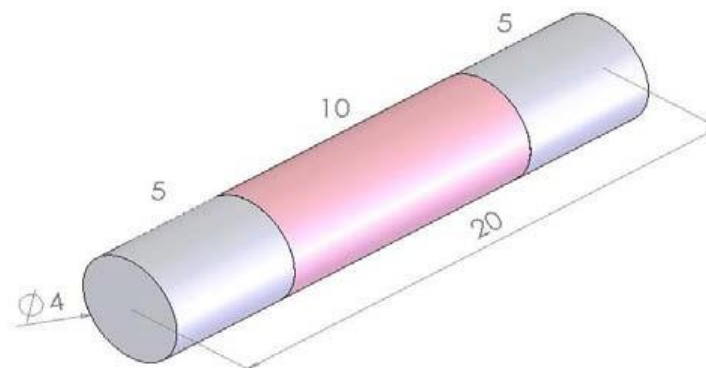

COATING None

PART #040136 AFB® 1% Nd:YAG Laser Rod | 5mm dia x 22mm L

SPECIFICATIONS Consisting of 1% Nd:YAG, 5mm dia. x 12mm L, with undoped YAG of 5mm dia x 5mm L bonded to both ends

Dopant Type, Concentration 1% Nd:YAG

Cross-Section 5mm dia.

Length 22mm L

Doped Length 12mm L

Undoped Length 5mm L (2x)

End-Face Configuration 1 deg wedge / Flat

Side Specifications Fine Ground

Quantity 2

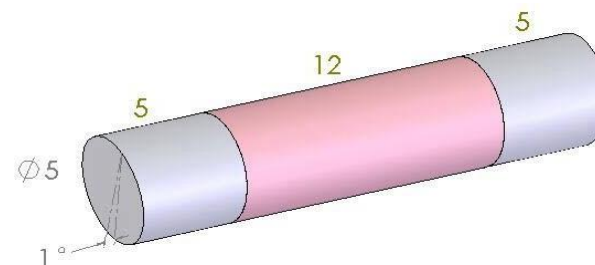

COATING None

PART #040138 AFB® 0.6% Nd:YAG Laser Rod | 6.35mm dia x 156mm L

SPECIFICATIONS Consisting of 0.6% Nd:YAG, 6.35mm dia. x 116mm L, with undoped YAG of 6.35mm dia x 20mm L bonded to both ends

Dopant Type, Concentration 0.6% Nd:YAG

Cross-Section 6.35mm dia.

Length 156mm L

Doped Length 116mm

Undoped Length 20mm L (2x)

End-Face Configuration Flat / Flat

Side Specifications Fine Ground

Quantity 1

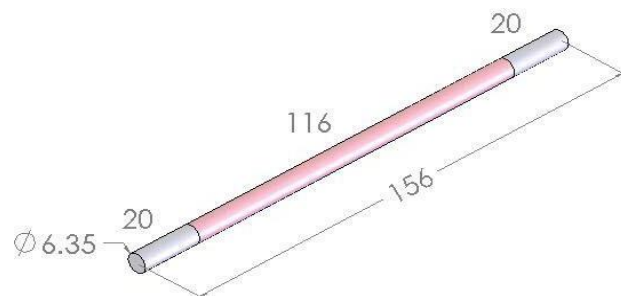

COATING None

PART #040140 AFB® 0.5% Yb:YAG Laser Rod | 1.5mm dia x 65mm L

SPECIFICATIONS Consisting of 0.5% Yb:YAG, 1.5mm dia. x 20mm L, with undoped YAG of 1.5mm dia x 22.5mm L bonded to both ends

Dopant Type, Concentration 0.5% Yb:YAG

Cross-Section 1.5mm dia.

Length 65mm L

Doped Length 20mm L

Undoped Length 22.5mm L (2x)

End-Face Configuration Flat / Flat

Side Specifications Fine Ground

Quantity 1

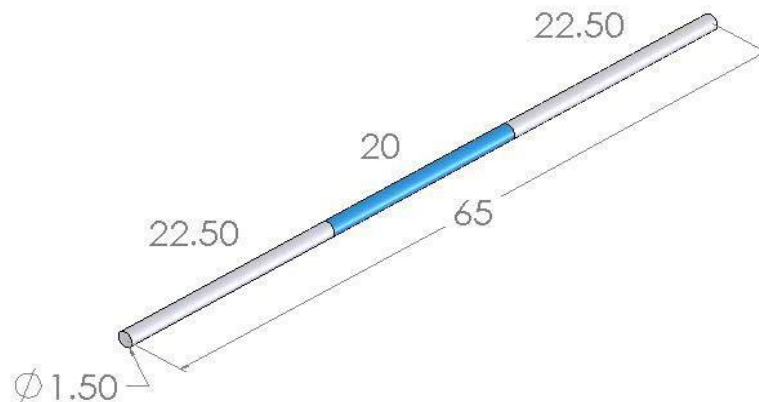

COATING AR/AR @ 1030nm

PART #040141 AFB® 1.1% Nd:YAG Laser Rod | 3mm dia x 8mm L

SPECIFICATIONS Consisting of 1.1% Nd:YAG, 3mm dia. x 6mm L, with undoped YAG of 3mm dia x 2mm L bonded to one end

Dopant Type, Concentration 1.1% Nd:YAG

Cross-Section 3mm dia.

Length 8mm L

Doped Length 6mm L

Undoped Length 2mm L

End-Face Configuration Flat / Flat

Side Specifications Fine Ground

Quantity 3

COATING None

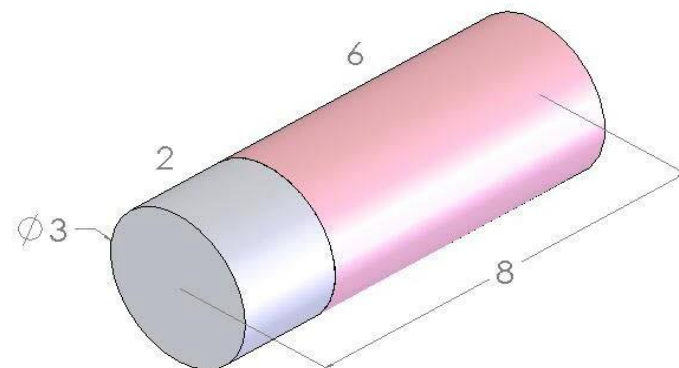

PART #040143 AFB® 1% Nd:YAG Laser Rod | 2mm dia x 8.5mm L

SPECIFICATIONS Consisting of 1% Nd:YAG, 2mm dia. x 3mm L, with undoped YAG of 2mm dia x 2.75mm L bonded to both ends

Dopant Type, Concentration 1% Nd:YAG

Cross-Section 2mm dia.

Length 8.5mm L

Doped Length 3mm L

Undoped Length 2.75mm L (2x)

End-Face Configuration Flat / Flat

Side Specifications Fine Ground

Quantity 5

COATING None

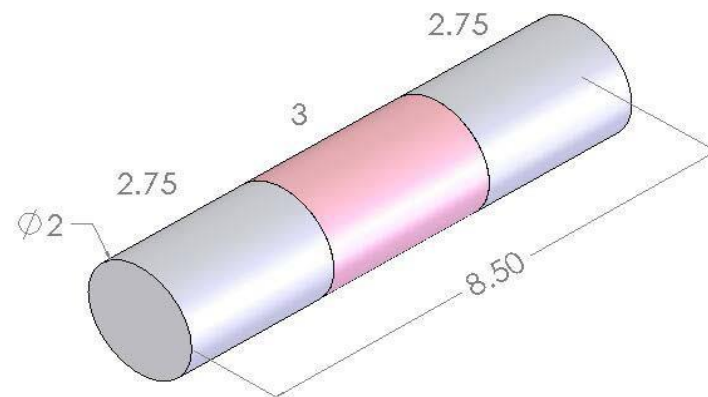

PART #040145 AFB® 1.1% Nd:YAG Laser Rod | 2.5mm dia x 11mm L

SPECIFICATIONS Consisting of 1.1% Nd:YAG, 2.5mm dia. x 8mm L, with undoped YAG of 2.5mm dia x 3mm L bonded to one end

Dopant Type, Concentration 1.1% Nd:YAG

Cross-Section 2.5mm dia.

Length 11mm L

Doped Length 8mm L

Undoped Length 3mm L

End-Face Configuration Flat / Flat

Side Specifications Fine Ground

Quantity 2

COATING None

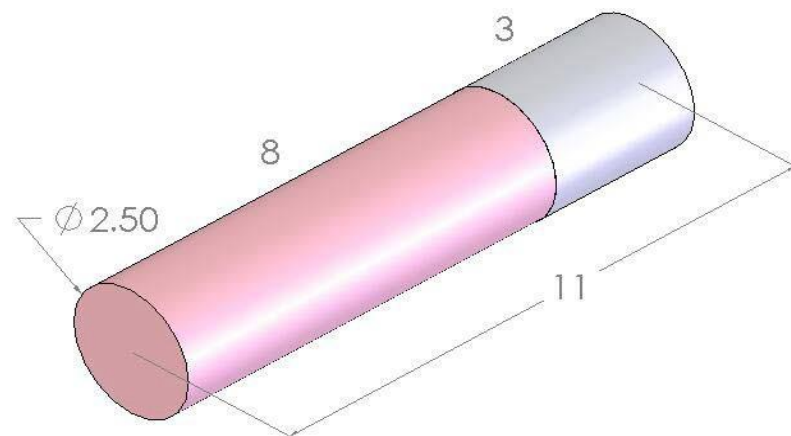

PART #0501674 AFB® Cr:Nd:GSGG / Cr4+:YAG Laser Rod | 2mm dia. x 22.8mm L

SPECIFICATIONS Consisting of Cr:Nd:GSGG, 2mm dia. x 20mm L, with Cr4+:YAG of 2mm dia. x 2.8mm L bonded to one end

Transmission of Cr4+:YAG 70%

Cross-Section 2mm dia.

Length 22.8mm L

Cr3+:Nd:GSGG Length 20mm L

Cr4+:YAG Length 2.8

End-Face Configuration Flat / Flat

Side Specifications Fine Ground

Quantity 1

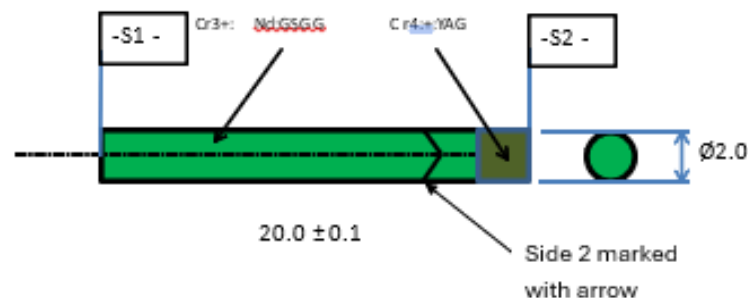

COATING S1 R>99.8% at 1062nm at 0° AOI; S2 R=70% at 1062nm at 0° AOI

PART #040150 AFB® 1.1% Nd:YAG Laser Rod | 2.7mm dia x 55mm L

SPECIFICATIONS Consisting of 1.1% Nd:YAG, 2.7mm dia. x 36mm L, with undoped YAG of 2.7mm dia x 9.5mm L bonded to both ends

Dopant Type, Concentration 1.1% Nd:YAG

Cross-Section 2.7mm dia.

Length 55mm L

Doped Length 36mm L

Undoped Length 9.5mm L (2x)

End-Face Configuration Flat / Flat

Side Specifications Inspection polished

Quantity 1

COATING None

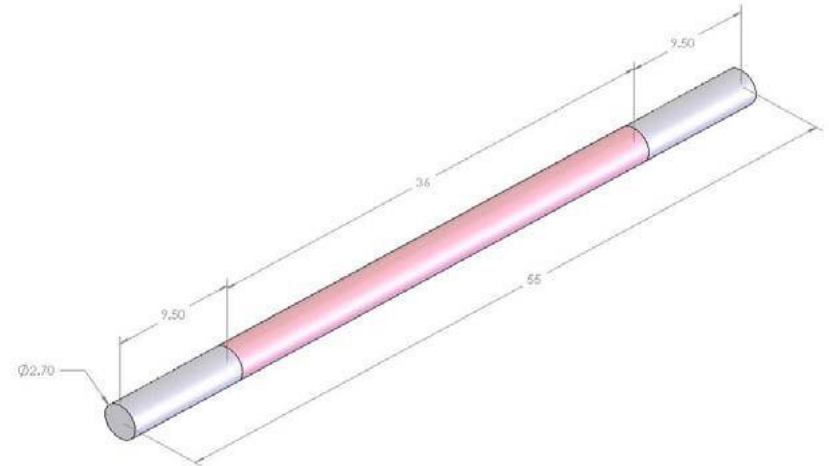

PART #040153 AFB® 0.8% Nd:YAG Laser Rod | 3mm dia x 63mm L

SPECIFICATIONS Consisting of 0.8% Nd:YAG, 3mm dia. x 49 mm L , with undoped YAG of 3mm dia. x 7mm L bonded to both ends

Dopant Type, Concentration 0.8% Nd:YAG

Cross-Section 3mm dia.

Length 63mm L

Doped Length 49mm L

Undoped Length 7mm L (2x)

End-Face Configuration Flat / Flat

Side Specifications Fine Ground

Quantity 1

COATING None

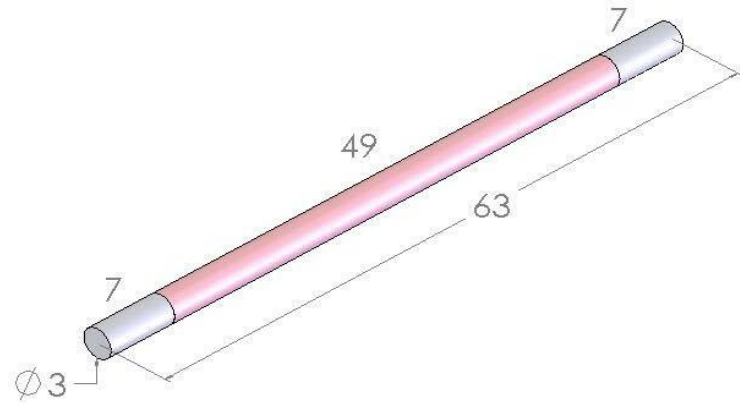

PART #040156 AFB® 0.6% Nd:YAG Laser Rod | 2mm dia x 10mm L

SPECIFICATIONS Consisting of 0.6% Nd:YAG, 2mm dia. x 5mm L, with undoped YAG of 2mm dia x 2.5mm L bonded to both ends

Dopant Type, Concentration 0.6% Nd:YAG

Cross-Section 2mm dia.

Length 10mm L

Doped Length 5mm L

Undoped Length 2.5mm L (2x)

End-Face Configuration Flat / Flat

Side Specifications Inspection polished

Quantity 4

COATING None

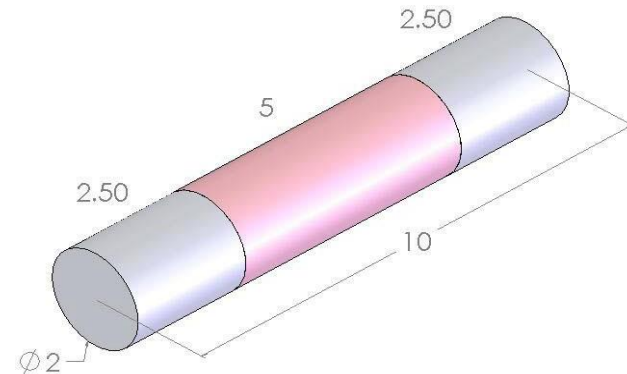

PART #040163 AFB® 1.1% Nd:YAG / Sapphire Laser Rod | 3mm dia x 10mm L

SPECIFICATIONS Consisting of 1.1% Nd:YAG, 3mm dia. x 2mm L, with sapphire of 3mm dia x 8mm L bonded to one end

Dopant Type, Concentration 1.1% Nd:YAG

Cross-Section 3mm dia.

Length 10mm L

Doped Length 2mm L

Undoped Length 8mm L

End-Face Configuration Flat / Flat

Side Specifications Fine Ground

Quantity 1

COATING None

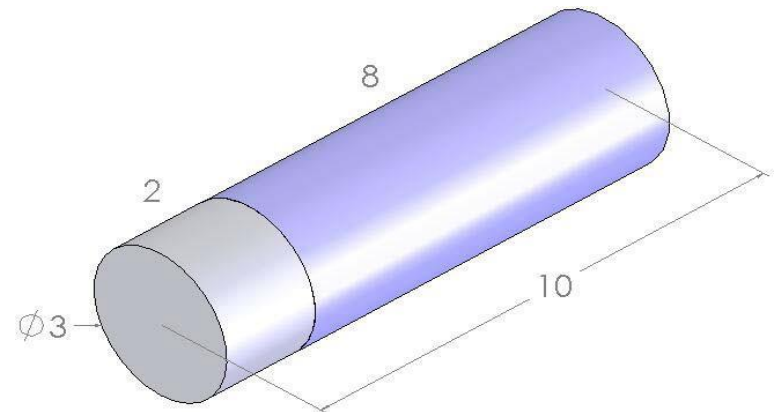

PART #040165 AFB® 0.1% Nd:YAG Laser Rod | 4mm dia x 54mm L

SPECIFICATIONS Consisting of 1% Nd:YAG, 4mm dia. x 40mm L, with undoped YAG of 4mm dia x 7mm L bonded to both ends

Dopant Type, Concentration 1% Nd:YAG

Cross-Section 4mm dia.

Length 54mm L

Doped Length 40mm L

Undoped Length 7mm L (2x)

End-Face Configuration Flat / Flat

Side Specifications Inspection polished

Quantity 2

COATING None

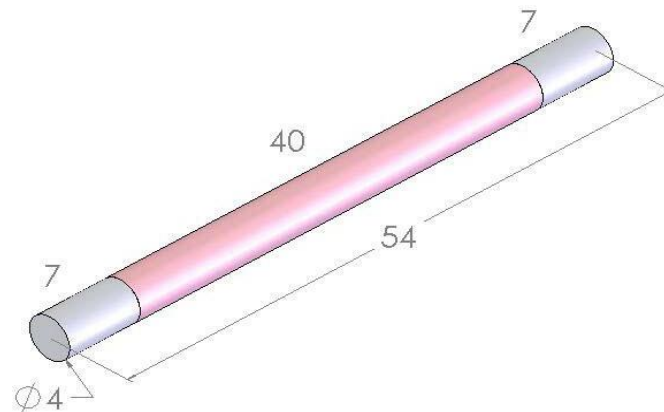

PART #040172 AFB® 1.1% Nd:YAG / Sapphire Laser Rod | 3mm dia x 10mm L

SPECIFICATIONS Consisting of 1.1% Nd:YAG, 3.0 mm dia. x 1 mm L, with undoped YAG of 3.0 mm dia. x 1 mm L bonded to both ends

Dopant Type, Concentration 1.1% Nd:YAG

Cross-Section 3mm dia.

Length 3mm L

Doped Length 1mm L

Undoped Length 1mm L (2x)

End-Face Configuration Flat / Flat

Side Specifications Fine Ground

Quantity 1

COATING None

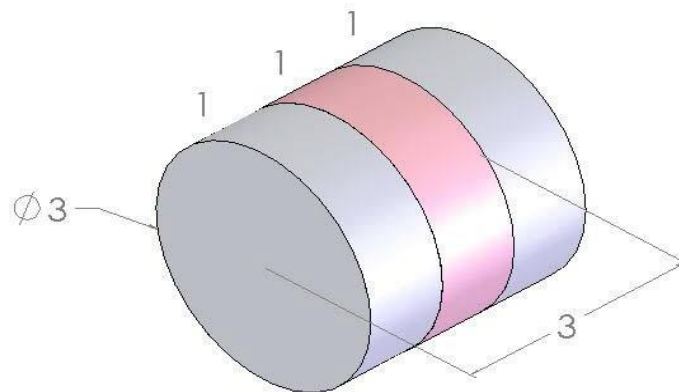

PART #040227 AFB® 25% Yb:YAG Rod | 3mm dia x 6mm L

SPECIFICATIONS Consisting of 25% Yb:YAG, 3mm dia x 1mm L, with undoped YAG of 3mm dia x 2.5mm L bonded to both ends

Dopant Type, Concentration 25% Yb:YAG

Cross-Section 3mm dia

Length 6mm L

Doped Length 1mm L

Undoped Length 2.5mm L (2x)

End-Face Configuration Flat / Flat

Side Specifications Precision Polished

Quantity 20

COATING None

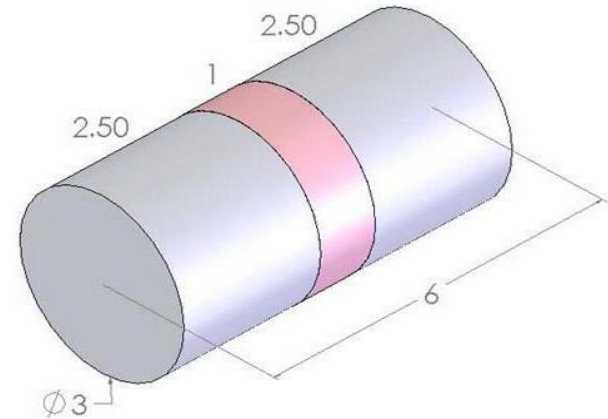

PART #040185 AFB® 1% Nd:YAG Laser Rod | 2mm dia x 8.5mm L

SPECIFICATIONS Consisting of 1% Nd:YAG, 2 mm dia. x 3mm L, with undoped YAG of 2mm dia. x 3mm L bonded to both ends

Dopant Type, Concentration 1% Nd:YAG

Cross-Section 2mm dia.

Length 8.5mm L

Doped Length 3mm L

Undoped Length 2.75mm L (2x)

End-Face Configuration Flat / Flat

Side Specifications Fine Ground

Quantity 2

COATING None

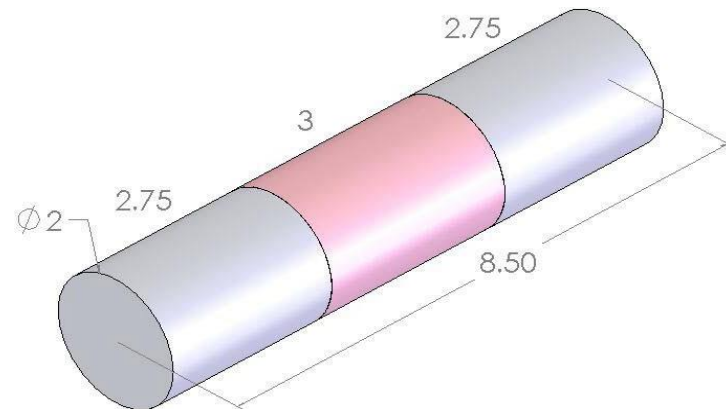

PART #040190 AFB® 0.4% Nd:YAG Laser Rod | 2mm dia x 32mm L

SPECIFICATIONS Consisting of 0.4% Nd:YAG, 2mm dia x 22mm L, with undoped YAG of 2mm dia x 5mm L bonded to both ends

Dopant Type, Concentration 0.4% Nd:YAG

Cross-Section 2mm dia

Length 32mm L

Doped Length 22mm L

Undoped Length 5mm L (2x)

End-Face Configuration Flat / Flat

Side Specifications Fine Ground

Quantity 1

COATING None

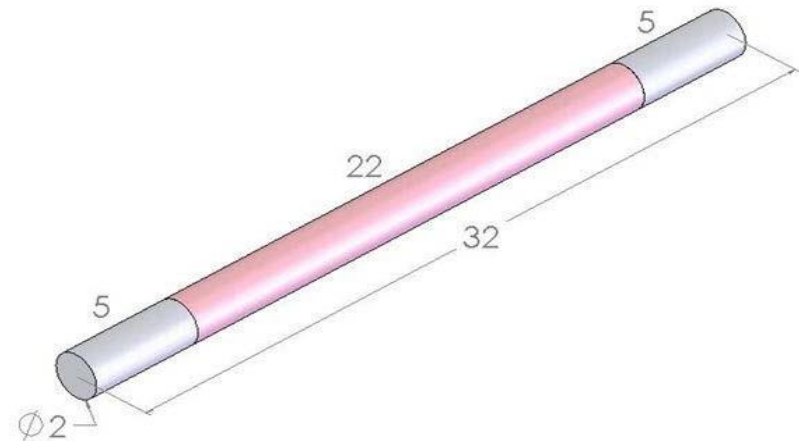

PART #040191 AFB® 0.9% Nd:YAG Laser Rod | 9mm dia x 12mm L

SPECIFICATIONS Consisting of 0.9% Nd:YAG, 9mm dia. x 9mm L, with undoped YAG of 9mm dia. x 3mm L bonded to one end

Dopant Type, Concentration 0.9% Nd:YAG

Cross-Section 9mm dia.

Length 12mm L

Doped Length 9mm L

Undoped Length 3mm L

End-Face Configuration Flat / Flat

Side Specifications Fine Ground

Quantity 1

COATING None

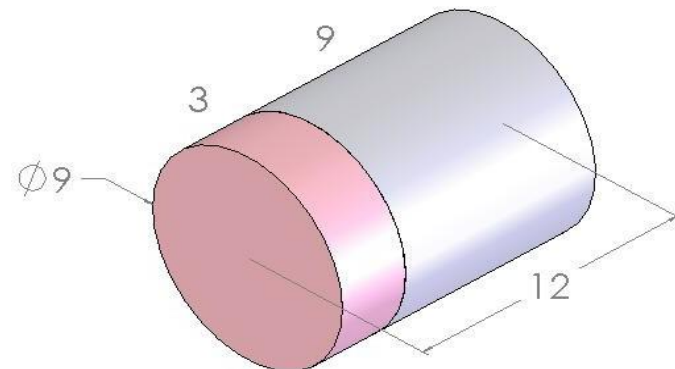

PART #040195 AFB® Undoped YAG / Sapphire Laser Rod | 12.7mm dia x 12.7mm L

SPECIFICATIONS Consisting of undoped YAG, 12.7mm dia x 6.35mm L, with sapphire of 12.7mm dia x 6.35mm L bonded to one end

Dopant Type, Concentration N/A
Cross-Section 12.7mm dia
Sapphire Length 6.35mm L
Undoped Length 6.35mm L
End-Face Configuration Flat / Flat
Side Specifications Fine Ground
Quantity 1

COATING None

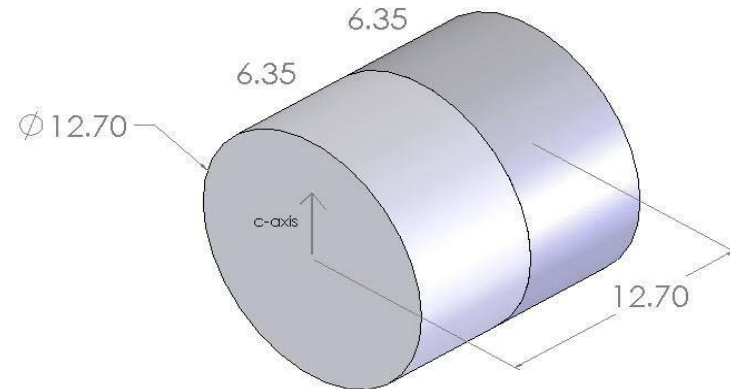

PART #040196 AFB® 25% Yb:YAG Laser Rod | 3mm dia x 5mm L

SPECIFICATIONS Consisting of 25% Yb:YAG, 3mm dia. x 3mm L, with undoped YAG of 3mm dia. x 2mm L bonded to one end

Dopant Type, Concentration 25% Yb:YAG
Cross-Section 3mm dia.
Length 5mm L
Doped Length 3mm L
Undoped Length 2mm L
End-Face Configuration Flat / Flat (Undoped YAG end has 1 degree wedge)
Side Specifications Fine Ground
Quantity 1

COATING AR/AR @ 960-1100nm

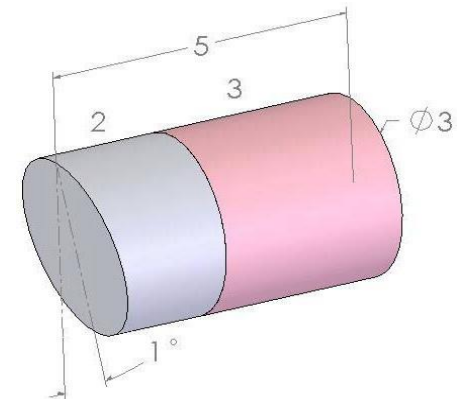

PART #040199 AFB® 0.1% Nd:YAG Laser Rod | 3mm dia x 54mm L

SPECIFICATIONS Consisting of 0.1% Nd:YAG, 3mm dia. x 40mm L, with undoped YAG of 3mm dia x 7mm L bonded to both ends

Dopant Type, Concentration 0.1% Nd:YAG

Cross-Section 3mm dia.

Length 54mm L

Doped Length 40mm L

Undoped Length 7mm L (2x)

End-Face Configuration Flat / Flat

Side Specifications Inspection polished

Quantity 3

COATING None

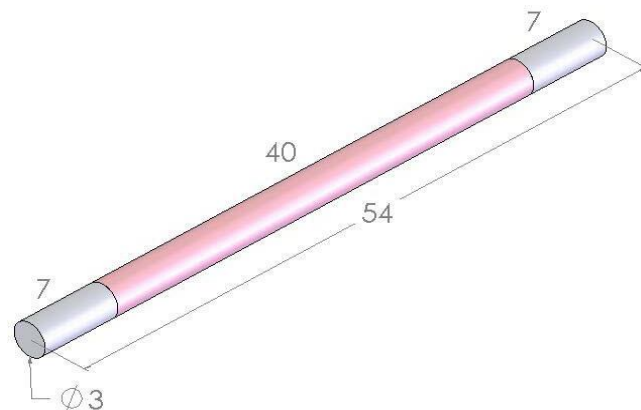

PART #040202 AFB® 3% Tm:YAG Laser Rod | 3mm dia x 85mm L

SPECIFICATIONS Consisting of 3% Tm:YAG, 3.0 mm dia. x 65mm L, with undoped YAG of 3mm dia. x 10mm L bonded to both ends

Dopant Type, Concentration 3% Tm:YAG

Cross-Section 3mm dia.

Length 85mm L

Doped Length 65mm L

Undoped Length 10mm L (2x)

End-Face Configuration Flat / Flat

Side Specifications Fine Ground

Quantity 1

COATING None

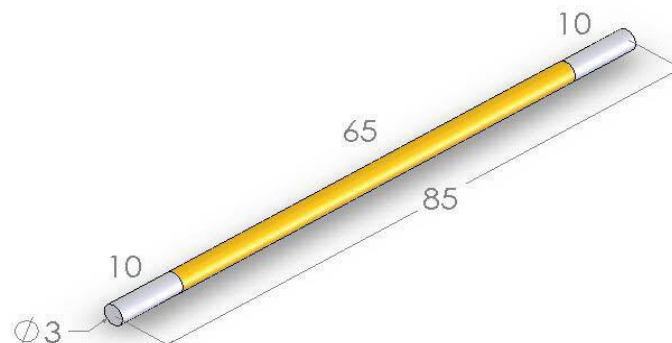

PART #040223 AFB® 1.4% Nd:YAG / Cr4+:YAG Laser Rod | 4mm dia x 8.8mm L

SPECIFICATIONS Consisting of 1.4% Nd:YAG, 4 mm dia. x 5mm L, with Cr4+:YAG (alpha ~3.5cm-1, Tzero = 25%) of 4 mm dia. X 3.8 mm L bonded to one end

Dopant Type, Concentration 1.4% Nd:YAG, Cr4:YAG (alpha ~3.5cm-1, Tzero = 25%)

Cross-Section 4mm dia.

Length 54mm L

Nd:YAG Length 4mm L

Cr4:YAG Length 3.8mm L

End-Face Configuration Flat / Flat

Side Specifications Fine Ground

Quantity 1

Note Two flats to indicate [001] axes perpendicular to the [110] axis

COATING None

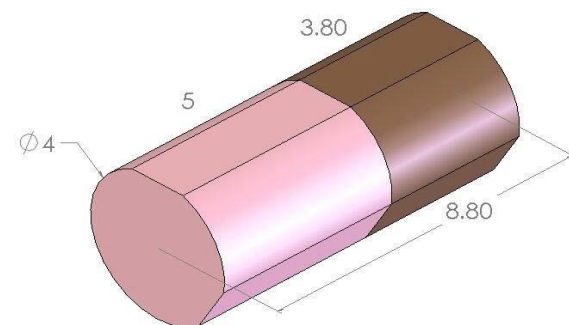

PART #040234 AFB® 0.67% Yb:YAG Laser Rod | 3mm dia. x 65 mm L

SPECIFICATIONS Consisting of 0.67% Yb:YAG, 3 mm dia. x 35 mm L, with undoped YAG of 3 mm dia x 15 mm L bonded to both ends

Dopant Type, Concentration 0.67% Yb:YAG

Cross-Section 3mm dia.

Length 65mm L

Doped Length 35mm L

Undoped Length 15mm L (2x)

End-Face Configuration Flat / Flat

Side Specifications Fine Ground

Quantity 3

COATING None

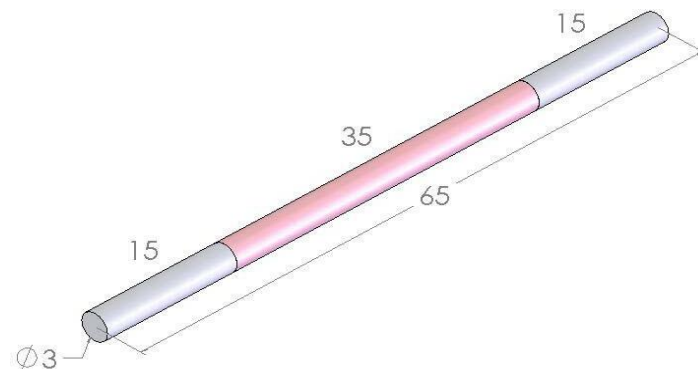

PART #040228 AFB® 1.1-1.2% Nd:YAG Laser Rod | 3mm dia x 15mm L

SPECIFICATIONS Consisting of 1.1-1.2% Nd:YAG, 3mm dia. x 5mm L, with undoped YAG of 3mm dia x 5mm L bonded to both ends.

Dopant Type, Concentration 1.1-1.2% Nd:YAG

Cross-Section 3mm dia

Length 15mm L

Doped Length 5mm L

Undoped Length 5mm L (2x)

End-Face Configuration Flat / Flat

Side Specifications Fine Ground

Quantity 5

COATING None

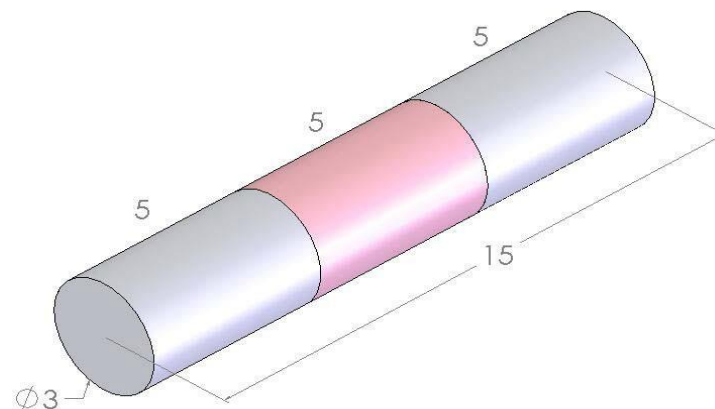

PART #040238 AFB® 1.1% Nd:YAG Laser Rod | 5mm dia x 35mm L

SPECIFICATIONS Consisting of 1.1% Nd:YAG, 5mm dia. x 30mm L, with undoped YAG of 5mm dia. x 5mm L bonded to one end

Dopant Type, Concentration 1.1% Nd:YAG

Cross-Section 5mm dia.

Length 35mm L

Doped Length 30mm L

Undoped Length 5mm L

End-Face Configuration Flat / Flat

Side Specifications Fine Ground

Quantity 2

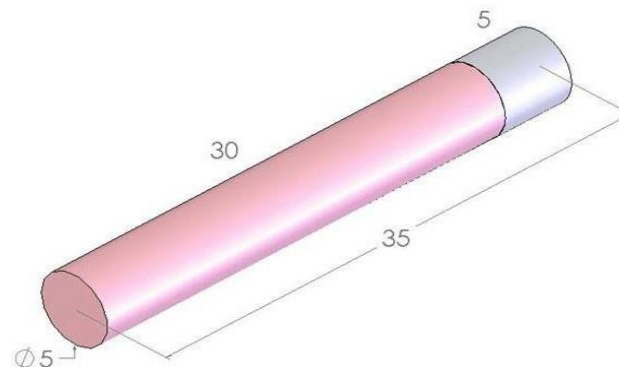

COATING Undoped YAG: R>99.9% @ 1064nm, Tav>97% @ 790-820nm, AOI = 0-50° Nd:YAG: R<0.15% @ 1064nm, Tav<3.0% @ 790-820nm, AOI = 0-15°

PART #040239 AFB® 1.1% Nd:YAG Laser Rod | 5mm dia x 40mm L

SPECIFICATIONS Consisting of 1.1% Nd:YAG, 5mm dia x 30mm L, with undoped YAG of 5mm dia x 5mm L bonded to both ends

Dopant Type, Concentration 1.1% Nd:YAG

Cross-Section 5mm dia

Length 40mm L

Doped Length 30mm L

Undoped Length 5mm L (2x)

End-Face Configuration Flat / Flat

Side Specifications Fine Ground

Quantity 2

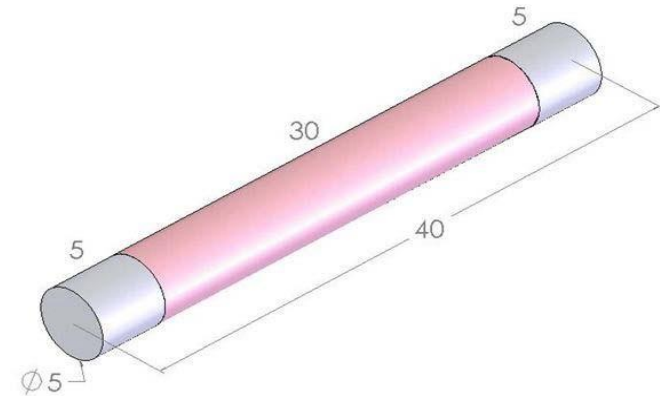

COATING Undoped YAG: R>99.9% @ 1064nm, Tav>97% @ 790-820nm, AOI = 0-50° Nd:YAG: R<0.15% @ 1064nm, Tav<3.0% @ 790-820nm, AOI = 0-15°

PART #040247 AFB® 3% Tm:YAG Laser Rod | 4mm dia x 72mm L

SPECIFICATIONS Consisting of 3% Tm:YAG, 4mm dia. x 36mm L, with undoped YAG of 4mm dia. X 18mm L bonded to both ends; barrel has screw-thread design.

Dopant Type, Concentration 3% Tm:YAG

Cross-Section 4mm dia.

Length 72mm L

Doped Length 36mm L

Undoped Length 18mm L (2x)

End-Face Configuration Flat / Flat

Side Specifications Fine Ground (screw-thread design)

Quantity 2

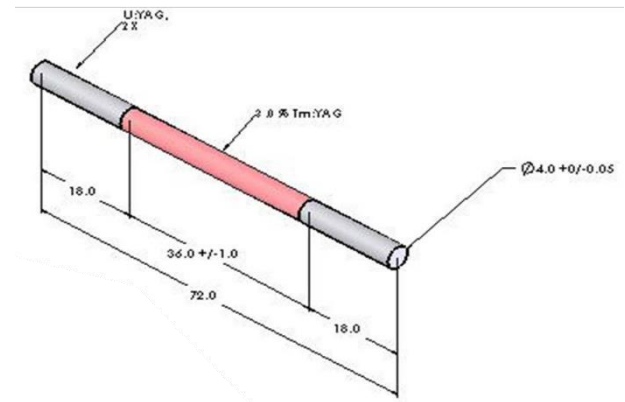

COATING Both ends HT>99.8% @ 2.04um

PART #040250 AFB® 6% Tm, 0.5% Ho:YAG YAG Laser Rod | 3mm dia. x 10mm L

SPECIFICATIONS Consisting of 6% Tm, 0.5% Ho:YAG, 3mm dia. x 7mm L, with undoped YAG of 3mm dia. x 1.5mm L bonded to both ends.

Dopant Type, Concentration 6% Tm, 0.5% Ho:YAG

Cross-Section 3mm dia

Length 10mm L

Doped Length 7mm L

Undoped Length 1.5mm L (2x)

End-Face Configuration Flat / Flat

Side Specifications Inspection Polished

Quantity 1

COATING None

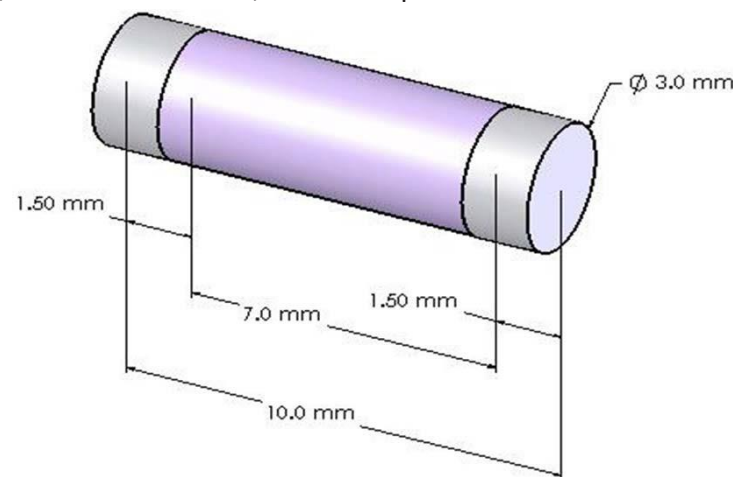

SOLD PART #040263 AFB® Undoped YAG / Cr4+:YAG / 1.1% Nd:YAG / Undoped YAG Rod | 3.0 mm dia. x 12.5 mm L

SPECIFICATIONS Consisting of 1.1% Nd:YAG, 3.0 mm dia. x 8.0 mm L, with Cr4+:YAG of 3.0mm dia. x 0.773mm L bonded to one 3.0mm dia. end; undoped YAG of 3.0mm dia. x 1.85mm L bonded to both 3.0mm dia. ends.

Dopant Type, Concentration 1.1% Nd:YAG; Cr4+:YAG

Cross-Section 3mm dia.

Length 12.5mm L

Doped Length Nd: 8mm L; Cr4+: 0.773mm L

Undoped Length 1.85mm L (2x)

End-Face Configuration Flat / Flat

Side Specifications Fine Ground

Quantity 2

COATING None

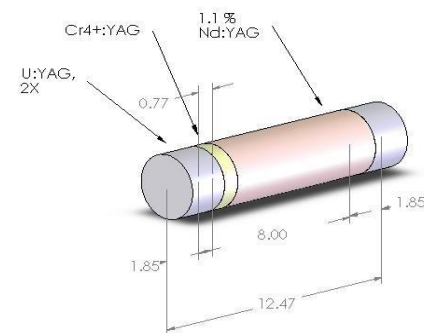

PART #040251 AFB® 1.1% Nd:YAG / Cr4+:YAG Laser Rod | 3mm dia x 32mm L

SPECIFICATIONS Consisting of 1.1% Nd:YAG, 3mm dia. x 29.5mm L, with Cr4+:YAG of 3mm dia. x 2.5mm L bonded to one end

Dopant Type, Concentration 1.1% Nd:YAG; Cr4+:YAG (T=20% @ 1064nm)

Cross-Section 3mm dia

Length 32mm L

Nd Length 29.5mm L

Cr Length 2.5mm L

End-Face Configuration Nd end: flat; Cr end: 1800mm concave ROC

Side Specifications Fine Ground

Quantity 1

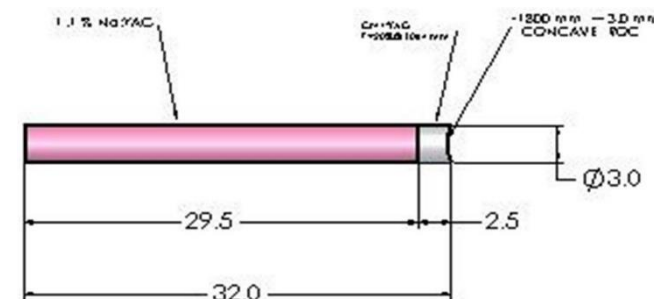

COATING None

PART #040262 AFB® 0.6% Nd:YAG Laser Rod | 2mm dia x 63mm L

SPECIFICATIONS Consisting of 0.6% Nd:YAG, 2mm dia. x 52mm L, with undoped YAG of 2mm dia. x 5.5mm L bonded to both ends

Dopant Type, Concentration 0.6% Nd:YAG

Cross-Section 2mm dia.

Length 63mm L

Doped Length 52mm L

Undoped Length 5.5mm L (2x)

End-Face Configuration Polished, 1000mm concave radius

Side Specifications Fine Ground

Quantity 2

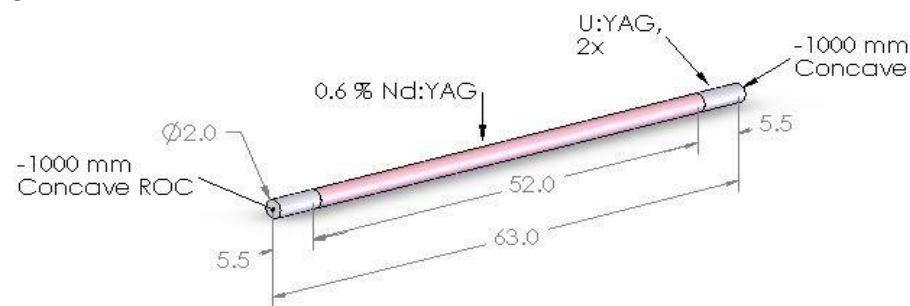

COATING Both ends R<0.1% @ 1064nm

PART #040269 AFB® 3% Tm:YAG Rod | 4mm dia x 70mm L

SPECIFICATIONS Consisting of 3% Tm:YAG, 4mm dia. x 22mm L, with undoped YAG of 4mm dia. x 24mm L bonded to both ends

Dopant Type, Concentration 3% Tm:YAG

Cross-Section 4mm dia.

Length 70mm L

Doped Length 22mm L

Undoped Length 24mm L (2x)

End-Face Configuration Flat / Flat

Side Specifications Fine Ground

Quantity 1

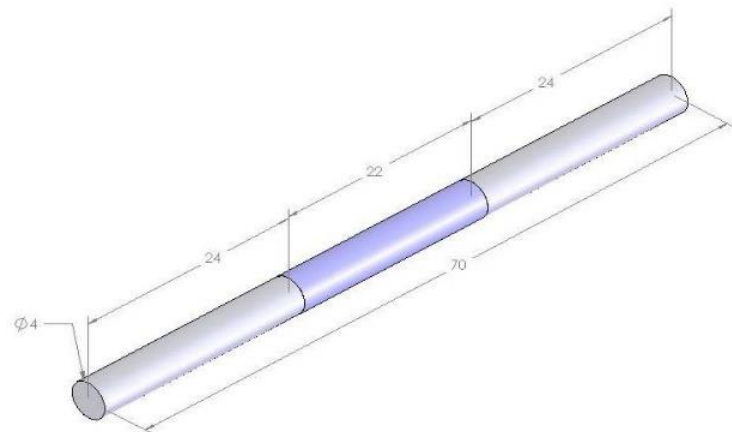

COATING Both 4mm dia ends AR @ 2100nm

PART #040270 AFB® 6% Tm:YAG Laser Rod | 3mm dia x 75mm L

SPECIFICATIONS Consisting of 6% Tm:YAG, 3mm dia. x 22mm L, with undoped YAG of 4mm dia. x 24mm L bonded to both ends

Dopant Type, Concentration 6% Tm:YAG

Cross-Section 3mm dia.

Length 70mm L

Doped Length 36mm L

Undoped Length 24mm L (2x)

End-Face Configuration Flat / Flat

Side Specifications Fine Ground

Quantity 2

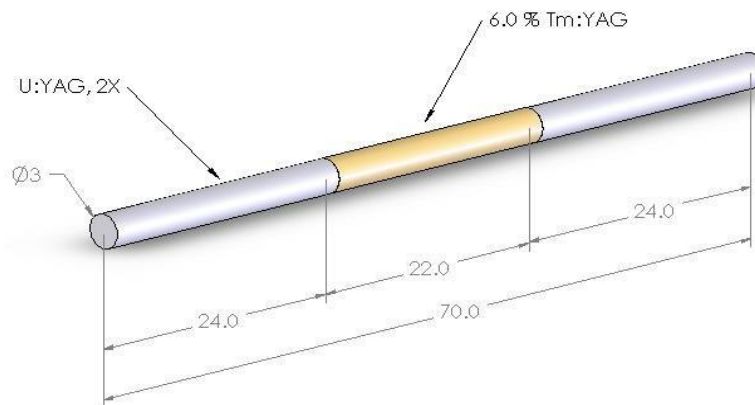

COATING Both 4mm dia ends AR @ 2100nm

PART #040271 AFB® 3% Tm:YAG Rod | 3mm dia x 75mm L

SPECIFICATIONS Consisting of 3% Tm:YAG, 3mm dia. x 22mm L, with undoped YAG of 3mm dia. x 26.5mm L bonded to both ends

Dopant Type, Concentration 3% Tm:YAG

Cross-Section 3mm dia.

Length 75mm L

Doped Length 22mm L

Undoped Length 26.5mm L (2x)

End-Face Configuration 61.2 deg parallel wedges

Side Specifications Fine Ground

Quantity 1

COATING None

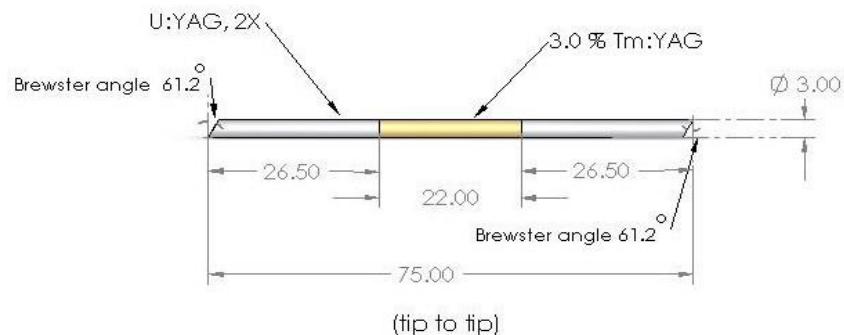

PART #040272 AFB® 3% Tm:YAG Laser Rod | 3mm dia x 70mm L

SPECIFICATIONS Consisting of 3% Tm:YAG, 3mm dia. x 22mm L, with undoped YAG of 3mm dia. x 24mm L bonded to both ends.

Dopant Type, Concentration 3% Tm:YAG

Cross-Section 3mm dia.

Length 70mm L

Doped Length 22mm L

Undoped Length 24mm L (2x)

End-Face Configuration Flat / Flat

Side Specifications Fine Ground

Quantity 1

COATING Both 4mm dia ends AR @ 2100nm

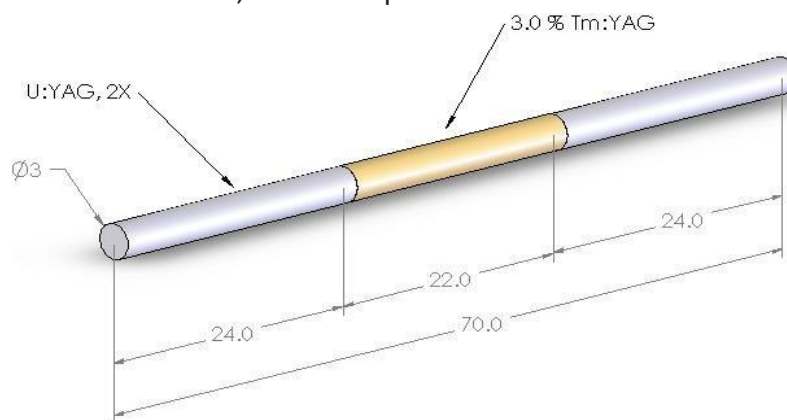

SOLD PART #040274 AFB® Undoped YAG / Cr4+:YAG / 1.1% Nd:YAG / Undoped YAG Rod | 3mm dia. x 12.2 mm L

SPECIFICATIONS Consisting of 1.1% Nd:YAG, 3mm dia. x 7mm L, with Cr4+:YAG of 3mm dia. x 2.1mm L bonded to one end; undoped YAG of 2.05mm and 1.05mm L bonded to both ends

Dopant Type, Concentration 1.1% Nd:YAG; Cr4+:YAG

Cross-Section 3mm dia

Length 12.2mm L

Nd Length 7mm L

Cr Length 2.1mm L

End-Face Configuration Flat/Flat

Side Specifications Fine Ground

Quantity 2

COATING Undoped / Cr4+:YAG end: R = 21% ± 2% @ 1064nm, AOI = 0°

Undoped / Nd:YAG end: R = >99% @ 1064nm, 0° AOI, T >95% @ 808nm, 0° AOI

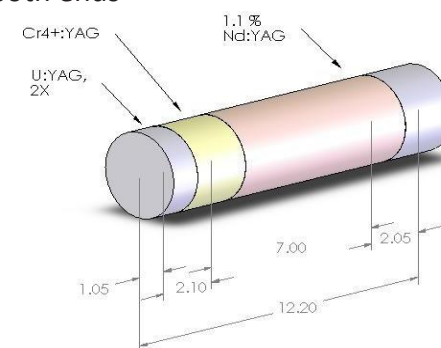

PART #040275 AFB® CTH:YAG Laser Rod | 4.3mm dia x 130mm L

SPECIFICATIONS Consisting of 0.85% Cr, 5.9% Tm, 0.36% Ho:YAG, 4.3mm dia. x 110mm L, with undoped YAG of 4.3mm dia. x 10mm L bonded to both ends

Dopant Type, Concentration 0.85% Cr, 5.9% Tm, 0.36% Ho:YAG

Cross-Section 4.3mm dia.

Length 130mm L

Doped Length 110mm L

Undoped Length 10mm L (2x)

End-Face Configuration Flat / Flat

Side Specifications Fine Ground

Quantity 1

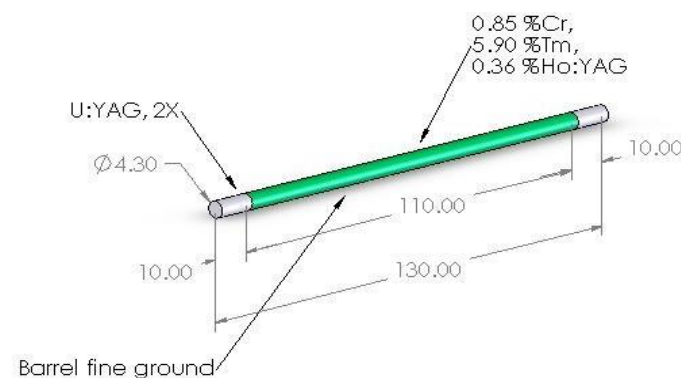

COATING None

(Same item available as 10.2mm / 109.6mm / 10.2mm (040276))

PART #040278 AFB® 0.4% Nd:YAG Rod | 2mm dia x 32mm L

SPECIFICATIONS Consisting of 0.4% Nd:YAG, 2mm dia. x 22mm L, with undoped YAG of 2mm dia. x 5mm L bonded to both ends

Dopant Type, Concentration 0.4% Nd:YAG

Cross-Section 2mm dia.

Length 32mm L

Doped Length 22mm L

Undoped Length 5mm L (2x)

End-Face Configuration Flat / Flat

Side Specifications Fine Ground

Quantity 2

COATING None

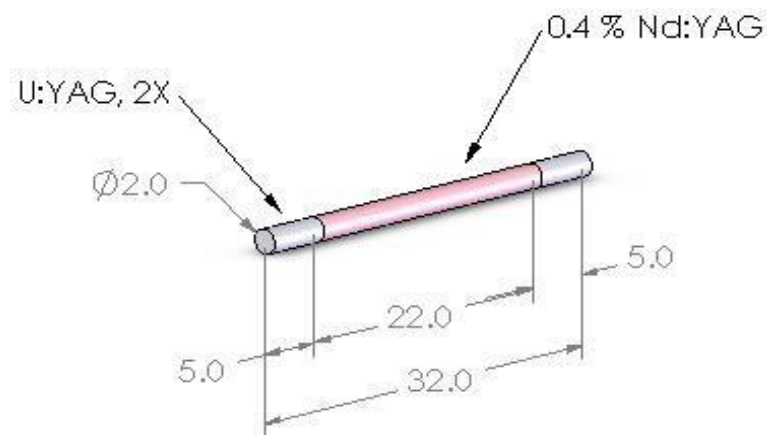

PART #040285 AFB® 1% Nd:YAG Laser Rod | 3mm dia x <28mm L

SPECIFICATIONS Consisting of 1.0% Nd:YAG, 3.0 mm dia. x 20.0 mm L, with undoped YAG of 3.0 mm dia. x <4.0 mm L bonded to both ends

Dopant Type, Concentration 1% Nd:YAG

Cross-Section 3mm dia.

Length <28mm L

Doped Length 20mm L

Undoped Length <4mm L (2x)

End-Face Configuration Flat / Flat

Side Specifications Fine Ground

Quantity 1

COATING None

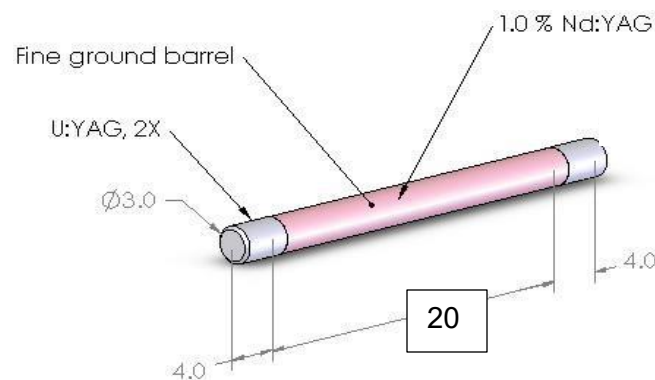

PART #040292 AFB® Cr4+:YAG / Undoped YAG Rod | 5mm dia. x 3.94mm L

SPECIFICATIONS Consisting of Cr4+:YAG, 5mm dia. x 2.94mm L, with undoped YAG of 5mm dia. x 1mm L bonded to one end.

Dopant Type, Concentration Cr4+:YAG 30% transmission

Cross-Section 5mm dia.

Length 3.94mm L

Doped Length 2.94mm L

Undoped Length 1mm L

End-Face Configuration Flat / Flat

Side Specifications Fine Ground

Quantity 1

COATING None

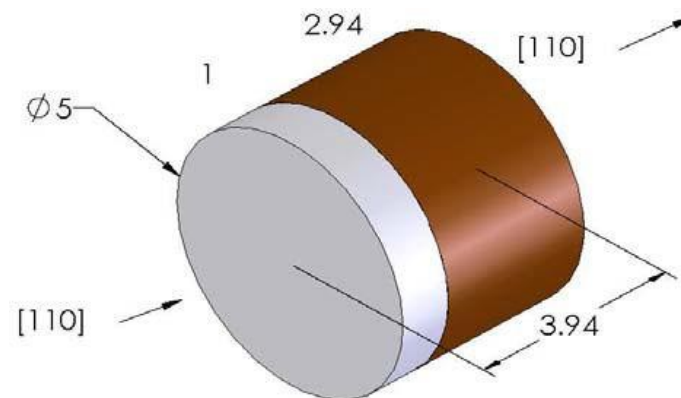

PART #040294 AFB® Cr4+:YAG / Nd:YAG Rod | 2mm dia. x 31.8mm L

SPECIFICATIONS Consisting of 1.1% Nd:YAG, 2mm dia. x 29.3mm L, with Cr4+:YAG of 2mm dia. x 2.5mm L bonded to one end.

Dopant Type, Concentration 1.1% Nd:YAG

Cross-Section 2mm dia.

Length 31.8mm L

Doped Length 29.3mm L

Doped Length 2.5mm L

End-Face Configuration Flat / Flat

Side Specifications Fine Ground

Quantity 1

COATING Both 4mm dia ends AR @ 2100nm

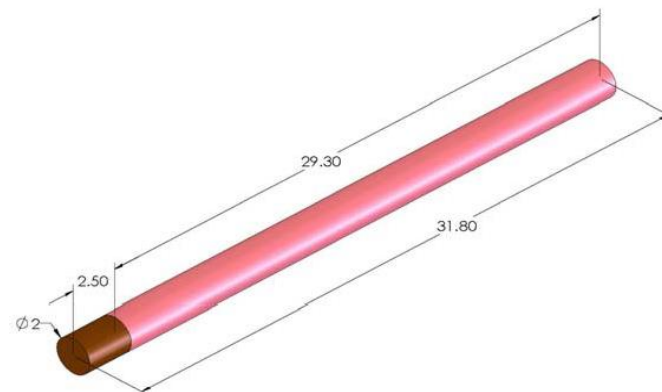

PART #040295 AFB® Undoped YAG / Tm:YAG / Undoped YAG Rod | 4mm dia. x 70mm L

SPECIFICATIONS Consisting of 3% Tm:YAG, 4mm dia. x 22mm L, with undoped YAG of 4mm dia. x 24mm L bonded to both ends

Dopant Type, Concentration 3% Tm:YAG

Cross-Section 4mm dia.

Length 70mm L

Doped Length 22mm L

Undoped Length 24mm L (2x)

End-Face Configuration Flat / Flat

Side Specifications Fine Ground

Quantity 1

COATING None

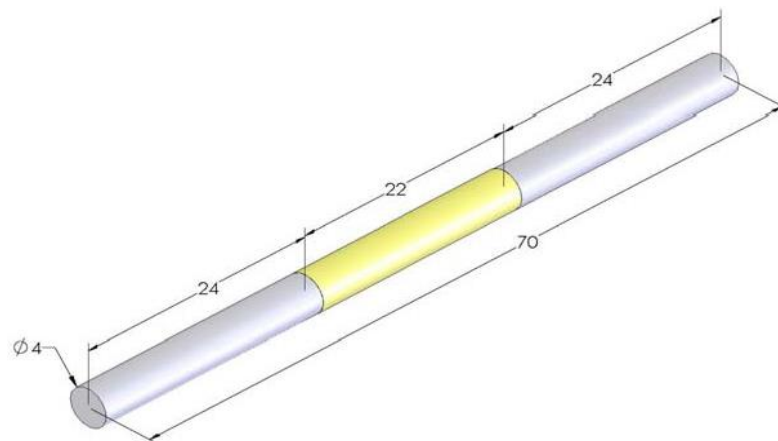

PART #040297 AFB® Undoped YAG / Nd:YAG / Undoped YAG Rod | 3mm dia. x 124mm L

SPECIFICATIONS Consisting of 0.8% Nd:YAG, 3mm dia. x 7.5mm L, with undoped YAG of 3mm dia. x 24.5mm L bonded to both ends

Dopant Type, Concentration 0.8% Nd:YAG

Cross-Section 3mm dia.

Length 124mm L

Doped Length 7.5mm L

Undoped Length 24.5mm L (2x)

End-Face Configuration Flat / Flat

Side Specifications Fine Ground

Quantity 1

COATING None

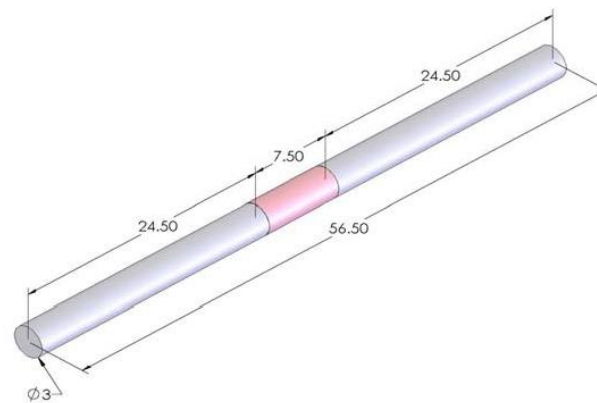

PART #040298 AFB® Undoped YAG / Cr4+:YAG / 1.1% Nd:YAG / Undoped YAG Rod | 2.4mm dia. x 13.9mm L

SPECIFICATIONS Consisting of 1.1% Nd:YAG, 2.4mm dia. x 5mm L, with Cr4+:YAG of 2.4mm dia. x 1.9mm L bonded to one 2.4mm dia. end; undoped YAG of 2.4mm dia. x 1mm L bonded to the Nd:YAG end and undoped YAG of 2.4mm dia. x 6mm L bonded to the Cr4+:YAG end

Dopant Type, Concentration 1.1% Nd:YAG; Cr4+:YAG ($\alpha = 3\text{cm}^{-1}$)

Cross-Section 2.4mm dia.

Length 13.9mm L

Doped Length Nd: 5.0 mm L; Cr4+: 1.9 mm L

Undoped Length 1mm L; 6mm L

End-Face Configuration Flat / Flat

Side Specifications Fine Ground

Quantity 5

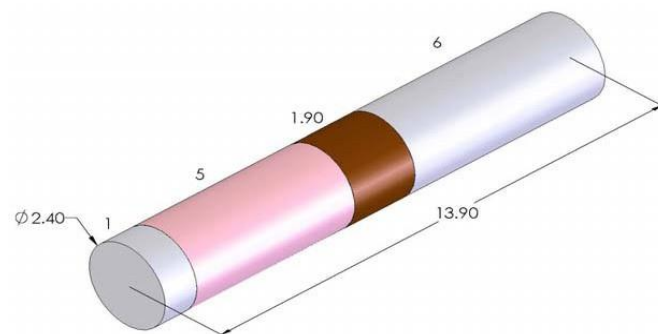

COATING None

PART #040308 AFB® 0.6% Nd:YAG Laser Rod | 4.5mm dia x 30mm L

SPECIFICATIONS Consisting of 0.6% Nd:YAG, 4.5mm dia. x 27mm L, with undoped YAG of 4.5mm dia. x 3mm L bonded to one end

Dopant Type, Concentration 0.6% Nd:YAG

Cross-Section 4.5mm dia.

Length 30mm L

Doped Length 27mm L

Undoped Length 3mm L

End-Face Configuration Flat / Flat

Side Specifications Fine Ground

Quantity 1

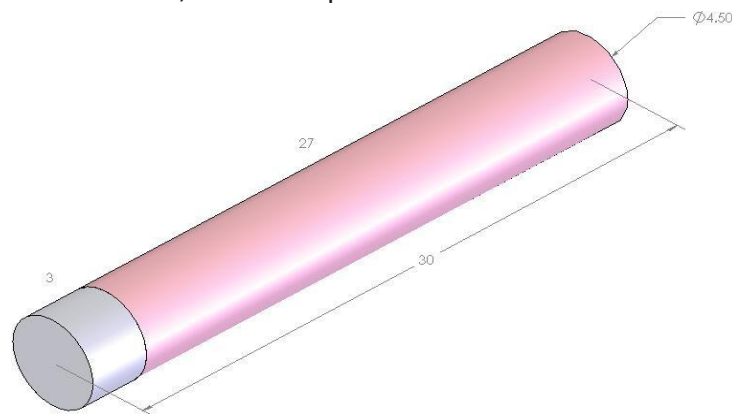

COATING Both 4.5 mm dia. ends $R \leq 0.5\%$ @ 808nm, $R \leq 0.1\%$ @ 1064nm

PART #040311 AFB® 1.1% Nd:YAG/Cr4+:YAG Laser Rod | 3mm dia. x 12.8mm L

SPECIFICATIONS Consisting of 1.1% Nd:YAG, 3mm x 8mm L, with Cr4+:YAG of 3mm dia. x 0.787 mm L bonded to one end; undoped YAG of 3mm dia. x 2mm L bonded to both ends

Dopant Type, Concentration 1.1% Nd:YAG

Cross-Section 3mm dia.

Length 12.8mm L

Doped Length 8mm L / 0.787mm

Undoped Length 2mm L (2x)

End-Face Configuration Flat / Flat

Side Specifications Fine Ground

Quantity 5

COATING None

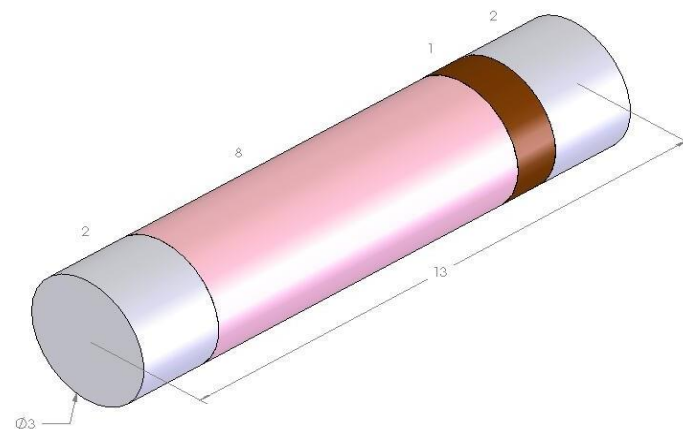

PART #050157 AFB® 2% Ho:YAG Laser Rod | 6mm dia x 25mm L

SPECIFICATIONS Consisting of 2% Ho:YAG, 6mm dia. x 20mm L, with undoped YAG of 6mm dia. x 5mm L bonded to one end

Dopant Type, Concentration 2% Ho:YAG

Cross-Section 6mm dia.

Length 25mm L

Doped Length 20mm L

Undoped Length 5mm L

End-Face Configuration Flat / Flat

Side Specifications Fine Ground

Quantity 1

COATING AR/AR between 1905nm-2096nm with R<0.5% at 1905
And 0.25% at 2090nm

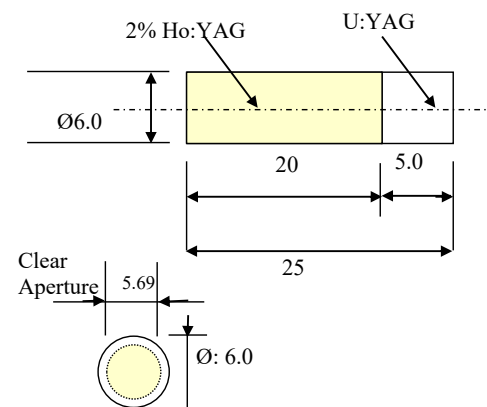

PART #050167 AFB® 1% Yb:YAG Rod | 10mm dia. x 31.3mm L

SPECIFICATIONS Consisting of 1% Yb:YAG, 10mm dia. x 25.1mm L, with undoped YAG of 10mm dia. x 3.1mm L bonded to both ends

Dopant Type, Concentration 1% Yb:YAG

Cross-Section 10mm dia.

Length 31.3mm L

Doped Length 25.1mm L

Undoped Length 3.1mm L (2x)

End-Face Configuration Flat / Flat

Side Specifications Fine Ground

Quantity 1

COATING None

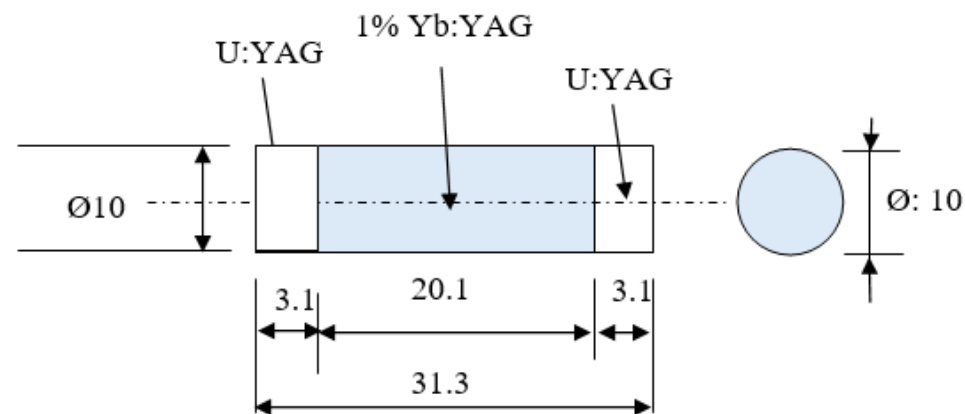

PART #050171 AFB® 1% Nd,0.5% Cr:YAG / Cr:YAG Laser Rod | 3mm dia x 40.4mm L

SPECIFICATIONS Consisting of 1% Nd, 0.5% Cr:YAG, 3mm dia. x 38.2mm length, with Cr:YAG of 3mm dia. x 2.2mm D L bonded to one end

Dopant Type, Concentration Nd³⁺, Cr³⁺(Co-doped):YAG <111>

Nd doping: 1.0% ±1%

Cr doping: 0.5% ±0.05%

Cross-Section 3mm dia.

Length 40.4mm L

Cr:YAG Length 38.2mm L

Nd,Cr:YAG Length 38.2mm L

End-Face Configuration Flat / Flat

Side Specifications Fine Ground

Quantity 1

COATING None

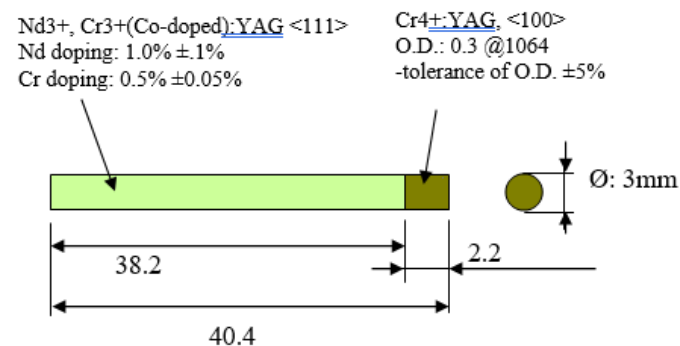

PART #050200 AFB® 0.7% Ho:YAG Rod | 5mm dia. x 40mm L

SPECIFICATIONS Consisting of 0.7% Ho:YAG, 5mm dia. x 30mm L, with undoped YAG of 5mm dia. x 5mm L bonded to both ends

Dopant Type, Concentration 0.7% Ho:YAG
Cross-Section 5mm dia.
Length 40mm L
Doped Length 30mm L
Undoped Length 5mm L (2x)
End-Face Configuration Flat / Flat
Side Specifications Fine Ground
Quantity 1

COATING None

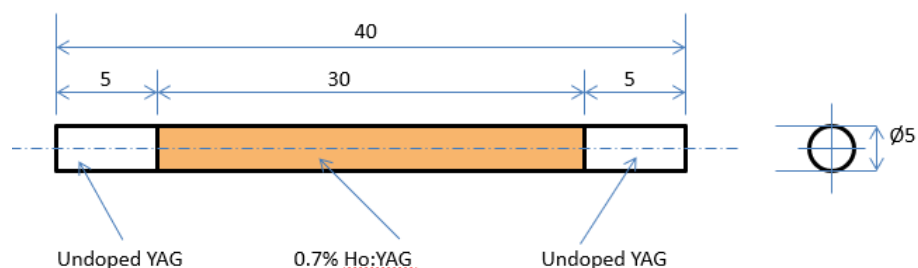

PART #050202 AFB® 1% Yb:YAG Laser Rod | 7.5mm dia x 31mm L

SPECIFICATIONS Consisting of 1% Yb:YAG, 7.5mm dia. x 25mm length, with undoped YAG of 7.5mm dia. x 3mm L bonded to both ends

Dopant Type, Concentration 1% Yb:YAG
Length 7.5mm dia
Doped Length 25mm L
Undoped Length 3mm L (2x)
End-Face Configuration Flat / Flat
Side Specifications Fine Ground
Quantity 1

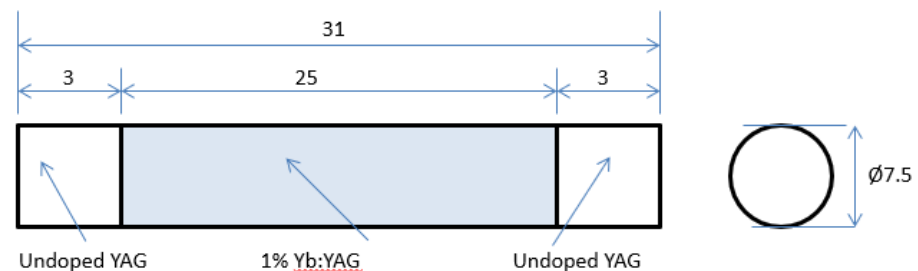

COATING Both ends AR coated at 1030nm and 940nm:
 $r < 0.15\%$ at 1030nm and $r < 0.25\%$ at 940nm

THIS PAGE INTENTIONALLY LEFT BLANK

PART #040232 AFB® 1.3% NdCe:YAG / Cr4+:YAG Laser Disks | 12.7mm dia x 6.9mm L

SPECIFICATIONS Consisting of 1.3% NdCe:YAG, 12.7mm dia. x 4.7mm L, with Cr4+:YAG of 12.7mm dia x 2.2mm L bonded to 12.7mm surface. Final dimensions may be determined by customer.

Dopant Type, Concentration 1.3% NdCe:YAG / Cr4+:YAG
Quantity 3

COATING None

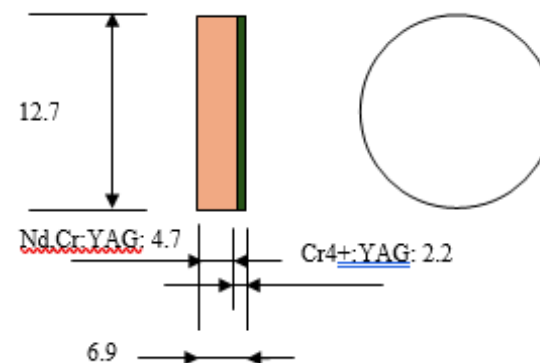

PART #040235 AFB® 1% Nd:YAG Disk | 8mm dia x 2.5mm L

SPECIFICATIONS Consisting of 1.0% Nd:YAG, 8mm dia. x 1.5mm L, with undoped YAG of 8mm dia. x 1mm L bonded to one 8mm surface

Dopant Type, Concentration 1% Nd:YAG
Cross-Section 8mm dia.
Length 2.5mm L
Doped Length 1.5mm L
Undoped Length 1mm L
End-Face Configuration Flat / Flat
Side Specifications Fine Ground
Quantity 2

COATING None

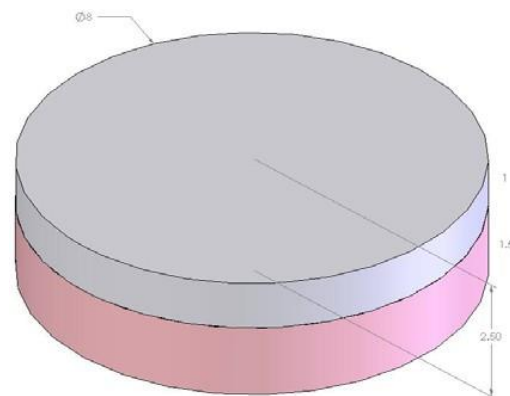

PART #040279 AFB® 10% Yb:YAG Disk | 20mm dia x 2mm L

SPECIFICATIONS Consisting of 10% Yb:YAG, 20mm dia. x 1mm L, with undoped YAG of 20mm dia. x 1mm L bonded to one 20mm surface

Dopant Type, Concentration 10% Yb:YAG

Cross-Section 20mm dia.

Length 2mm L

Doped Length 1mm L

Undoped Length 1mm L

End-Face Configuration Flat / Flat

Side Specifications Fine Ground

Quantity 1

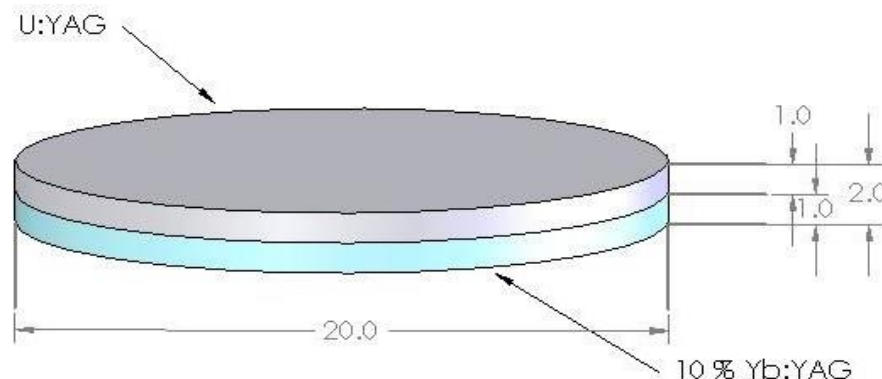

COATING None

PART #050163 AFB® 5% Yb:YAG Disk | 15.4/17mm dia x 0.8mm L

SPECIFICATIONS Consisting of 5% Yb:YAG, 15.4mm dia x 0.400mm, with Undoped YAG of 17mm dia x 0.400mm thick bonded to one 15.4mm dia surface

Dopant Type, Concentration 5% Yb:YAG

Cross-Section 15.4/17mm dia.

Length 0.8mm L

Doped Length 0.4mm L

Undoped Length 0.4mm L

End-Face Configuration Undoped YAG side has a 0.1° wedge

Side Specifications Fine Ground

Quantity 4

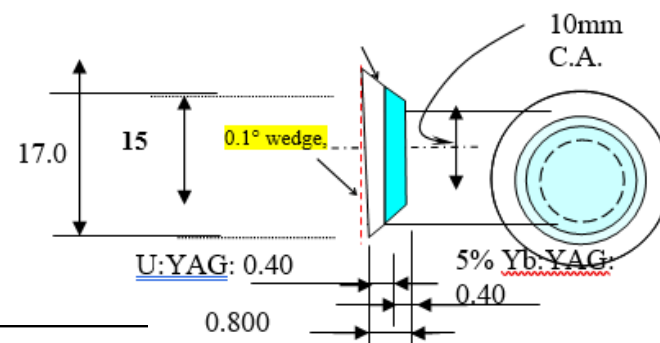

COATING

Coating Specs.							
# Surf	Side/Face Dimension (mm)	λ1 (nm)	Coating	AOI (Degree)	λ2 (nm)	Coating	AOI (Degree)
Yb:YAG side	15.4mm dia	1010-1050	R>99.9%	2.7	934-946	R>99.9%	16.2
U:YAG side	17.0mm dia	1010-1050	R<0.20% small as possible	5	934-946	R<0.20% small as possible	30.6

PART #050181 AFB® 1.3% Nd:YAG / Cr4+:YAG Disk | 11.7-12mm dia x 3.74mm L

SPECIFICATIONS Consisting of 1.3% Nd:YAG, 11.7-12mm dia. x 1.51mm L, with Cr4+:YAG of 11.7-12mm dia. x 2.23mm L bonded to one 11.7-12mm surface

Dopant Type, Concentration 1.3% Nd:YAG; Cr4+:YAG [100] (6.0cm-1)

Cross-Section 11.7-12mm dia.

Cr4+:YAG Thickness 2.23mm

Nd:YAG Thickness 1.51mm

End-Face Configuration Unfinished, please specify

Side Specifications Fine Ground

Quantity 4

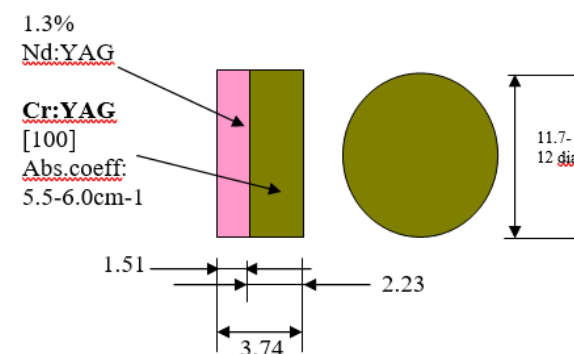

COATING None

PART #050184 AFB® 5% Yb:YAG Disk | 19.75mm dia x 1.4mm L

SPECIFICATIONS Consisting of 5% Yb:YAG, 19.75mm dia. x 0.4mm L, with undoped YAG of 19.75mm dia. x 1mm L bonded to one 19.75mm surface

Dopant Type, Concentration 5% Yb:YAG

Cross-Section 19.75mm dia.

Length 1.4mm L

Doped Length 0.4mm L

Undoped Length 1mm L

End-Face Configuration Flat / Flat

Side Specifications Fine Ground

Quantity 1

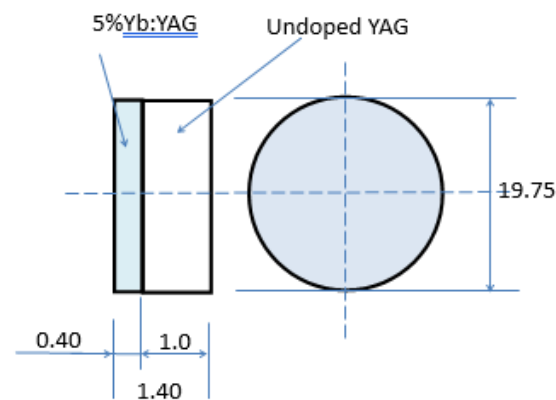

COATING None

PART #050193 AFB® 1.3% Nd:YAG / Cr4+:YAG Disk | 12.25mm dia x 1.64mm L

SPECIFICATIONS Consisting of 1.3% Nd:YAG, 12.25mm dia. x 1.23mm L, with Cr4+:YAG of 12.25mm dia. x 0.41mm L bonded to one 12.25mm surface

Dopant Type, Concentration 1.3% Nd:YAG; Cr4+:YAG (5.5-6.5cm⁻¹)

Cross-Section 12.25mm dia.

Length 1.64mm L

Nd:YAG Thickness 1.23mm L

Cr4+:YAG Thickness 0.41mm L

End-Face Configuration Flat / Flat

Side Specifications Fine Ground

Quantity 1

COATING Nd:YAG: R>99.9% @ 1064nm, T>97% @ 808nm, 0°, R-pol

Cr4+:YAG: R=85+/-2% @ 1064nm, T>95% @ 808nm, 0°, R-pol

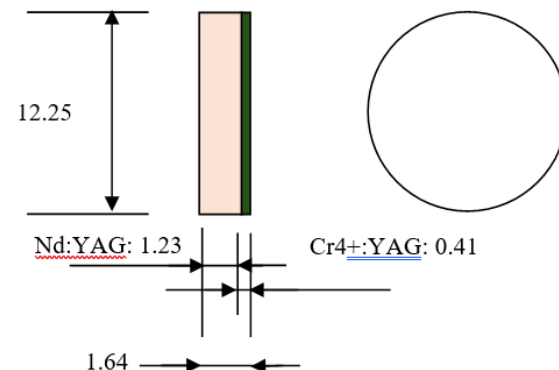

THIS PAGE INTENTIONALLY LEFT BLANK

PART #040145 AFB® 15% Yb:YAG Laser Slab | 2mm x 4mm x 28mm L

SPECIFICATIONS Consisting of 15.0% Yb:YAG, 4mm x 4mm x 2mm, with undoped YAG of 2mm x 4mm x 12mm bonded to both ends

Dopant Type, Concentration 15% Yb:YAG

Cross-Section 4mm x 2mm

Length 28mm L

Doped Length 4mm L

Undoped Length 12mm L (2x)

End-Face Configuration Flat / Flat with anti-parallel wedge

Side Specifications Fine Ground

Quantity 1

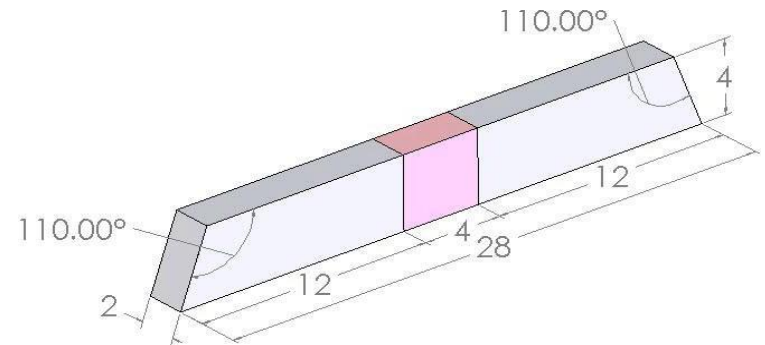

COATING None

PART #040151 AFB® 0.6% Nd:YAG Laser Slab | 2mm x 6mm x 12mm L

SPECIFICATIONS Consisting of 0.6% Nd:YAG, 2mm x 2mm x 12mm, with undoped YAG of 2mm x 2mm x 12mm bonded to both sides

Dopant Type, Concentration 0.6% Nd:YAG

Cross-Section 2mm x 6mm

Length 12mm L

Doped Length 2mm W

Undoped Length 2mm W (2x)

End-Face Configuration Flat / Flat

Side Specifications Inspection Polished

Quantity 1

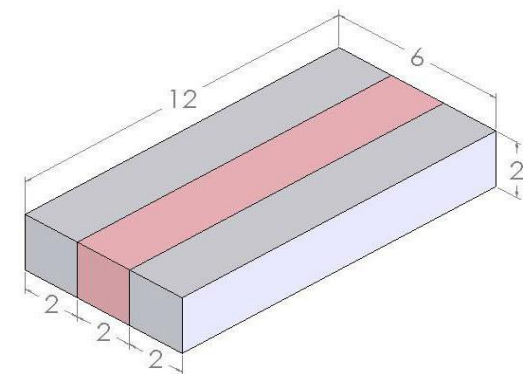

COATING None

PART #040169 AFB® Undoped YAG / 3% Yb:YAG Laser Slab | 3mm x 10mm x 21.2mm L

SPECIFICATIONS Consisting of 3.0% Yb:YAG, 1.5 mm x 10 mm x 10.8 mm, with undoped YAG of the same dimensions bonded to one 10 mm x 10.8 mm surface; structure has undoped YAG of 3 mm x 10 mm x 5.2mm bonded to each end

Dopant Type, Concentration 3% Yb:YAG

Cross-Section 3mm x 10mm

Length 21.2mm L

Doped Length 10.8mm L

Undoped Length 5.2mm L (2x)

End-Face Configuration Flat / Flat

Side Specifications 10mm x 21.2mm polished, 3mm x 21.2mm ground

Quantity 1

COATING None

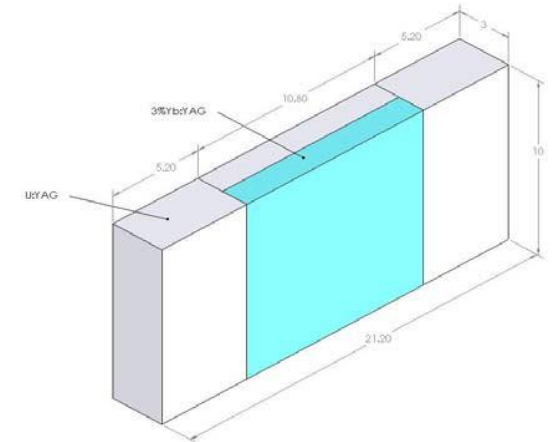

PART #040217 AFB® 1% Nd:YAG Laser Slab | 2mm x 3mm x 6mm L

SPECIFICATIONS Consisting of 1% Nd:YAG, 2mm x 3mm x 2mm L, with undoped YAG of 2mm x 3mm x 2mm L bonded to both sides

Dopant Type, Concentration 1% Nd:YAG

Cross-Section 2mm x 3mm

Length 6mm L

Doped Length 2mm L

Undoped Length 2mm L (2x)

End-Face Configuration Flat / Flat

Side Specifications 2mm x 6mm sides fine ground;
3mm x 6mm sides inspection polished

Quantity 8

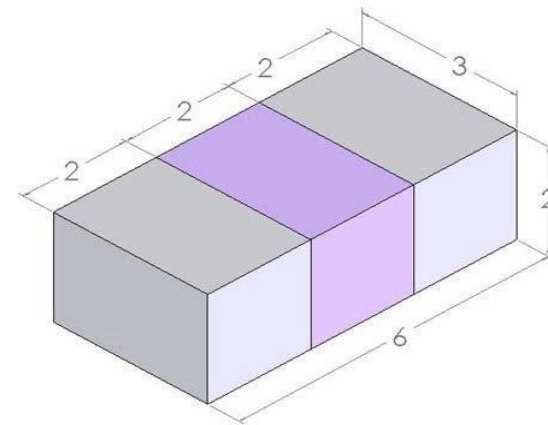

COATING None

PART #040226 AFB® 1.5% Yb:YAG Laser Slab | 2mm x 2.5mm x 17.4mm L

SPECIFICATIONS Consisting of 1.5% Yb:YAG, 10.8x2.5x2mm with undoped YAG of 3.3x2.5x2mm bonded to each end

Dopant Type, Concentration 1.5% Yb:YAG
Cross-Section 2mm x 2.5mm
Length 17.4mm L
Doped Length 10.8mm L
Undoped Length 3.3mm L (2x)
End-Face Configuration Flat / Flat
Side Specifications see drawing
Quantity 1

COATING None

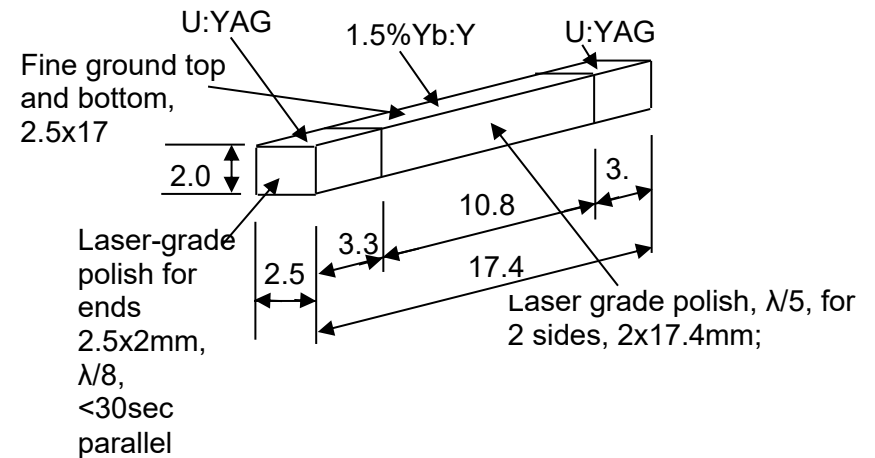

PART #040179 AFB® 1.3% Nd:YAG Clad Slab | 3mm x 9mm x 64mm L

SPECIFICATIONS Consisting of 1.3% Nd:YAG, 3mm x 9mm x 64mm L, with undoped YAG of 3mm x 9mm x 2mm L bonded to both ends

Dopant Type, Concentration 1.3% Nd:YAG
Cross-Section 3mm x 9mm
Length 64mm L
Doped Length 60mm L
Undoped Length 2mm L (2x)
End-Face Configuration Flat / Flat
Side Specifications Precision Polished
Quantity 1

COATING None

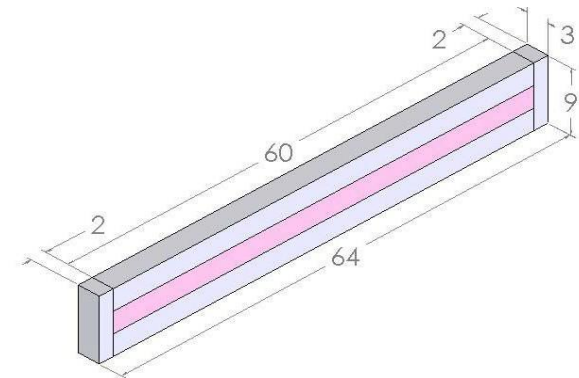

PART #040245 AFB® 1% Ho:YAG / Sapphire Laser Slab | 1mm x 4.4mm x 15mm L

SPECIFICATIONS Consisting of 1% Ho:YAG, 1mm x 0.42mm x 15mm, with sapphire of 1mm x 2mm x 15mm bonded to both sides

Dopant Type, Concentration 1% Ho:YAG
Cross-Section 1mm x 4.4mm
Length 15mm L
Doped Length 15mm L
Sapphire Length 15mm L
End-Face Configuration Flat / Flat
Side Specifications Inspection Polished
Quantity 1

COATING None

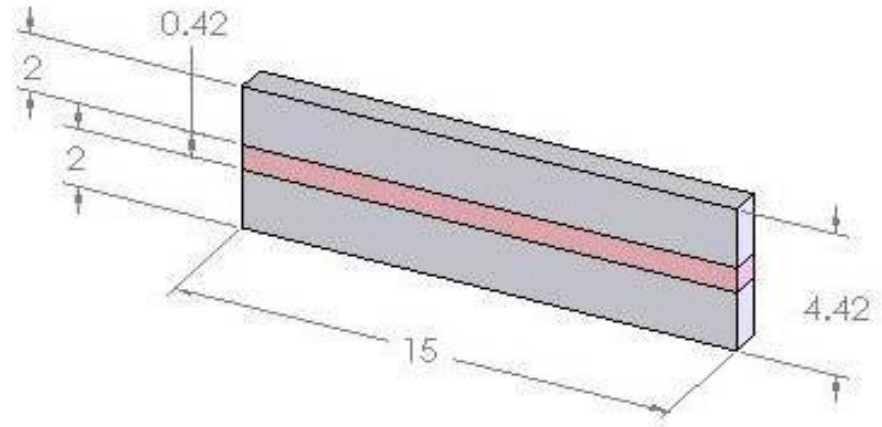

PART #040253 AFB® Sapphire/U:YAG/1%Nd:YAG/U:YAG/Sapphire Laser Slab | 2mm x 3mm x 6mm L

SPECIFICATIONS Consisting of 1% Nd:YAG, 2mm x 3mm x 2mm L, with undoped YAG of 2mm x 3mm x 2mm L bonded to both sides

Dopant Type, Concentration 1% Nd:YAG
Cross-Section 5mm x 9.5mm
Length 15mm L
Quantity 1
 -both 9.5mm x 5mm end faces laser polished flat/flat and parallel
 -both 5mm x 15mm faces laser polished flat/flat and parallel
 -both 9.5mm x 15mm top and bottom surfaces fine ground

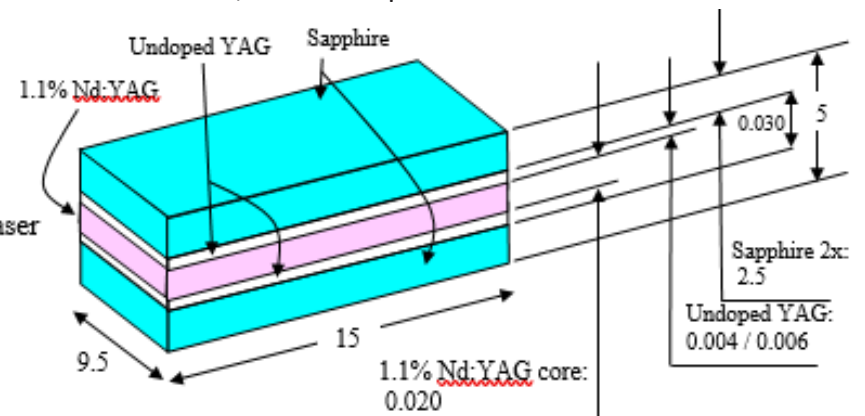

COATING None

PART #040268 AFB® Undoped YAG / 1% Nd:YAG / Cr4+:YAG / 1% Nd:YAG / Undoped YAG Laser Slab | 2mm x 2mm x 16.2mm L

SPECIFICATIONS Consisting of Cr4+:YAG, 2mm x 2mm x 5.1mm L, with 1% Nd:YAG of 2mm x 2mm x 2.95mm L and 4.05mm L bonded to both ends; above has undoped YAG of 2mm x 2mm x 2.05mm L bonded to both ends

Dopant Type, Concentration Cr4+:YAG; 1% Nd:YAG

Cross-Section 2mm x 2mm

Length 16.2mm L

Doped Length 5.1mm L (Cr); 2.95mm L and 4.05mm L (Nd)

Undoped Length 2.05mm L (2x)

End-Face Configuration Flat / Flat

Side Specifications Fine ground

Quantity 5

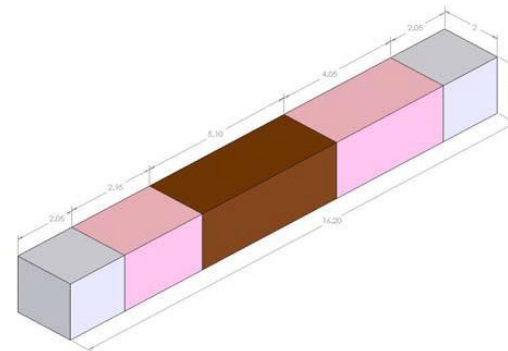

COATING One end: T>95% @ 808nm, T>95% @ 885nm, R>99.9% @ 1064nm

One end: T>95% @ 808nm, T>85% @ 885nm, R=40% @ 1064nm

PART #050159 AFB® 0.7% Nd:YAG / Cr4+:YAG Laser Slab | 10mm x 10mm x 40mm L

SPECIFICATIONS Consisting of 0.7% Nd:YAG, 10mm x 10mm x 36.5mm L, with Cr4+:YAG of 10mm x 10mm x 3.5mm L bonded to one end

Dopant Type, Concentration 0.7% Nd:YAG

Cross-Section 10mm x 10mm

Length 40mm L

Doped Length 36.5mm L

Cr4+:YAG Length 3.5mm L (OD 0.33+/-2%)

End-Face Configuration Flat / Flat

Side Specifications Fine ground;

Quantity 1

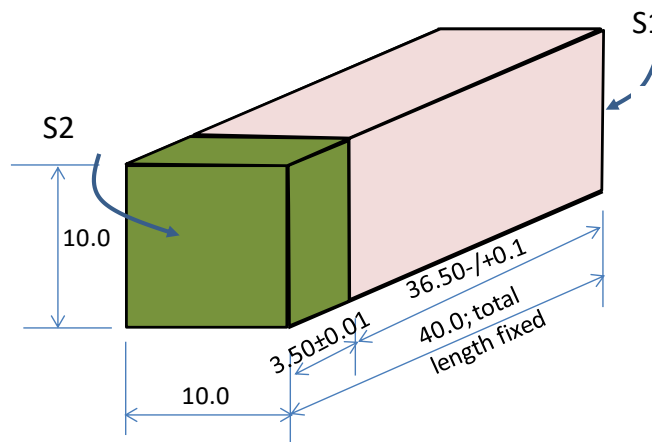

COATING None

PART #040266 AFB® Cr4+:YAG / Nd:YAG Slab | 1.6mm x 1.6mm x 17.09mm L

SPECIFICATIONS Consisting of 1% Nd:YAG, 1.6mm x 1.6mm x 14.85mm, with Cr4+:YAG of 1.6mm x 1.6mm x 2.24mm bonded to one end

Dopant Type, Concentration Cr4+:YAG; 1% Nd:YAG

Cross-Section 1.6mm x 1.6mm

Length 17.09mm LNd Length (mm) 14.85 mm Cr4+ Length 2.24mm

End-Face Configuration One end face has 18" wedge

Side Specifications Fine ground, one side polished

Quantity 2

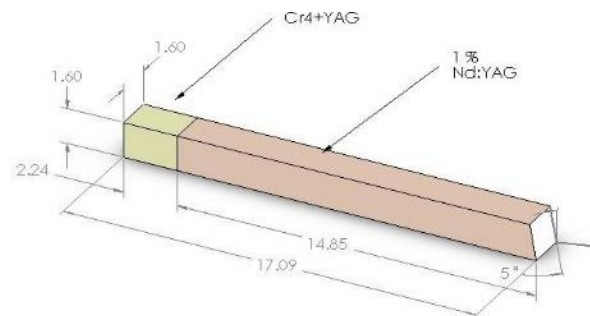

COATING Cr4+:YAG end (1.6 mm x 1.6 mm): R = 60% +/-3% @ 1064nm

Nd:YAG end (1.6 mm x 1.6 mm): R = >99.5% @ 1064nm

Top surface (1.6 mm x 17.09 mm): R<0.25% @ 808nm

PART #050160 AFB® 0.3% Ceramic Nd:YAG Laser Slab | 4mm x 20mm x 102mm L

SPECIFICATIONS Consisting of 0.3% Ceramic Nd:YAG, 0.3mm x 20mm x 102mm L, with undoped YAG of 1.85mm x 20 mm x 102mm L bonded to both sides

Dopant Type, Concentration 0.3% Ceramic Nd:YAG

Cross-Section 4mm x 20mm

Length 102mm L

Doped Thickness 0.3mm L

Undoped Thickness 1.85mm L (2x)

End-Face Configuration Flat / Flat

Side Specifications Inspection Polished

Quantity 1

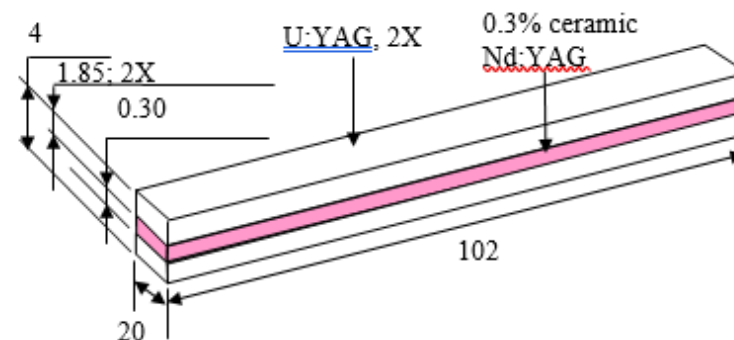

COATING None

PART #050165 AFB® 1% Nd+:YAG Slab | 3mm x 3mm x 75mm L

SPECIFICATIONS Consisting of 1% Nd:YAG, 3mm x 0.75mm x 75mm, with Cr4+:YAG of 3mm x 2.25mm x 75mm bonded to one face

Dopant Type, Concentration 1% Nd:YAG

Cross-Section 3mm x 3mm

Length 75mm L

Doped Thickness 0.75mm

Undoped Thickness 2.25mm

End-Face Configuration Polished, 5.1 degree anti-parallel wedges

Bottom Surface Polished

Top and Long Side Specifications Fine ground

Quantity 2

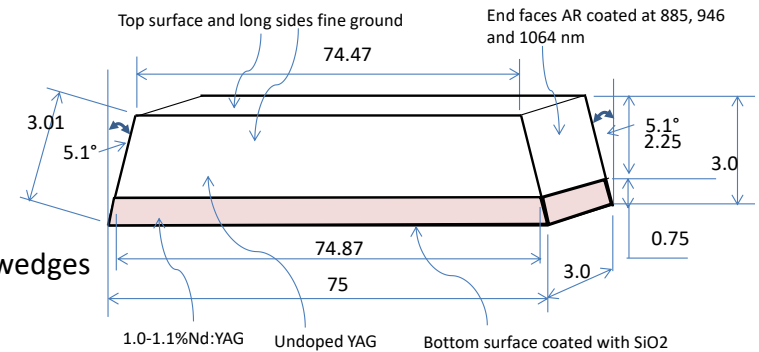

COATING Both wedged end faces AR coated at 885 nm , 946 and 1064 nm, 5.1° AOI
Bottom surface coated with 1-3 µm layer of SiO2.

PART #050166 AFB® 5% Ceramic Sm:YAG / 0.5% Ceramic Nd:YAG / 5% Ceramic Sm:YAG Laser Slab | 4mm x 12mm x 106.71mm L

SPECIFICATIONS Consisting of 0.5% Ceramic Nd:YAG, 4mm x 4mm x 106.71mm L, with 5% Ceramic Sm:YAG YAG of 4mm x 4mm x 106.71mm L bonded to both sides

Dopant Type, Concentration 5% Ceramic Sm:YAG /
0.5% Ceramic Nd:YAG

Cross-Section 4mm x 12mm

Length 100/106.71mm L

Sm:YAG Width 4mm L (2x)

Nd:YAG Width 4mm L

End-Face Configuration 50 degree anti-parallel wedges

Surface Specifications All surfaces polished

Quantity 1

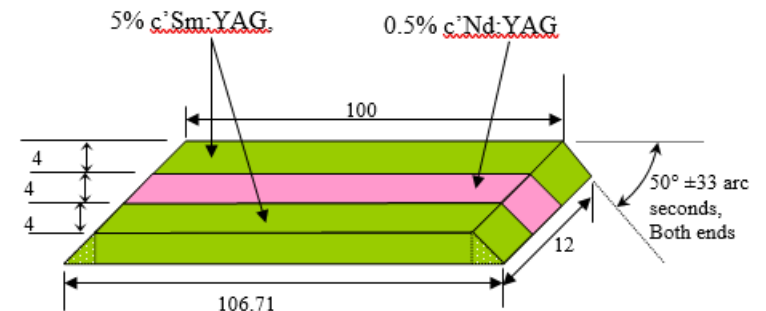

PART #050172 AFB® 5% Sm:YAG/0.35%Nd:YAG/5%Sm:YAG Laser Slab | 3.5mm x 9.8mm x 35mm L

SPECIFICATIONS Consisting of single crystal 0.35% Nd:YAG, 3.5mm x 3.5mm x 35mm, with ceramic 5% Sm:YAG of 3.15mm x 3.5mm x 35mm, bonded on both 3.5mm x 35mm sides

Dopant Type, Concentration 5% Sm:YAG; 0.35%Nd:YAG

Cross-Section 3.5mm x 9.8mm

Length 35mm L

Sm:YAG Width 3.15mm L (2x)

Nd:YAG Width 3.5mm L

Surface Specifications All surfaces polished, except Nd:YAG fine ground on 9.8mm x 35mm surfaces;

1° anti-parallel wedge on endfaces

Quantity 1

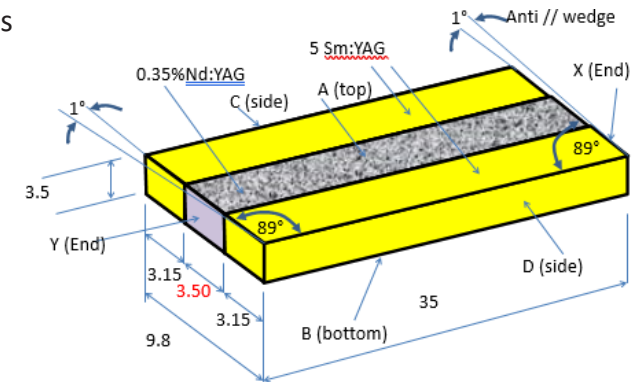

COATING

# Surf	Side/Face Dimension (mm)	$\lambda 1$ (nm)	Coating	AOI (Degree)	$\lambda 2$ (nm)	Coating	AOI (Deg)
X&Y (end faces)	2.5mm x 7mm	940-1070nm	R<0.2 %	0-20°			
C and D	35x3.5 mm	808±10 nm	R<0.5 %	0-20	808±10 nm	R<1%	20-30

PART #050175 AFB® 0.9% Nd:YAG Laser Slab | 4mm x 9mm x 13mm L

SPECIFICATIONS Consisting of 0.9% Nd:YAG, 4mm x 9mm x 2mm L, with undoped YAG of 4mm x 9mm x 11mm L bonded to one end

Dopant Type, Concentration 0.9% Nd:YAG

Cross-Section 4mm x 9mm

Length 13mm L

Doped Length 11mm L

Undoped Length 2mm L

End-Face Configuration Flat / Flat

Side Specifications Sides fine ground; ends inspection polished

Quantity 2

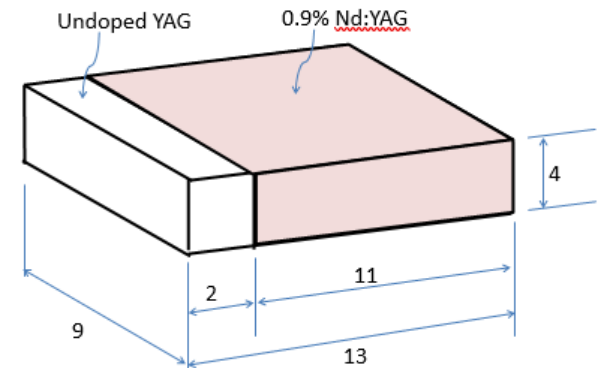

COATING None

PART #050177 AFB® 1% Nd:YAG / 3% Sm:YAG Laser Slab | 2mm x 7mm x 15mm L

SPECIFICATIONS Consisting of 1% Nd:YAG, 1mm x 7mm x 15mm L, with 3% Sm:YAG of ~1mm x 7mm x 15mm L, bonded on one large 7mm x 15mm face

Dopant Type, Concentration 1% Nd:YAG; 3% Sm:YAG

Cross-Section 2mm x 7mm

Length 15mm L

Sm:YAG Thickness ~1mm

Nd:YAG Thickness 1mm L

Surface Specifications Both 7mm x 15mm surfaces polished; both 2mm x 7mm surfaces fine ground; both 2mm x 15mm surfaces polished

Quantity 1

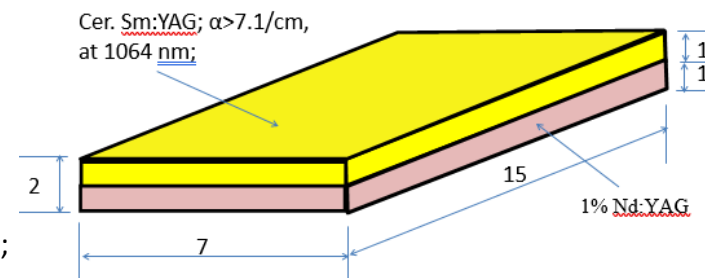

COATING Both 2mm x 15mm surfaces AR/AR R<0.2% at both 1064 and 1340 nm; AR/AR 808 R<1%; LIDT >10 J/cm² at 1064nm; 10 ns, 10Hz

PART #050178 AFB® 1% Nd:YAG / Cr4+:YAG Laser Slab | 1mm x 7mm x 15mm L

SPECIFICATIONS Consisting of 1% Nd:YAG, 1mm x 5mm x 15mm L, with Cr4+:YAG of 1mm x 1mm x 15mm L bonded to both sides

Dopant Type, Concentration 1% Nd:YAG; Orientation of Cr:YAG, <100>.absorption coefficient of Cr:YAG (3.5 ±0.5)/cm

Cross-Section 1mm x 7mm

Length 15mm L

Nd:YAG Width 5mm L

Cr4+:YAG Width 1mm L (2x)

End-Face Configuration Flat / Flat

Surface Specifications Both 7mm x 15mm surfaces polished; both 1mm x 7mm surfaces fine ground; both 1mm x 15mm surfaces polished

Quantity 1

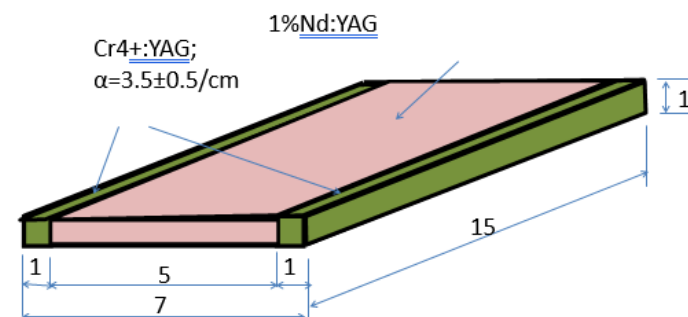

COATING Both 1mm x 15mm surfaces AR/AR R<0.2% at both 1064 and 1340 nm; AR/AR 808 R<1%; LIDT >10 J/cm² at 1064nm; 10 ns, 10Hz.

PART #050179 AFB® Ceramic 1.5% Nd:YAG Laser Slab | 1.1mm x 10mm x 60mm L

SPECIFICATIONS Consisting of ceramic 1.5% Nd:YAG, 0.11mm x 10mm x 60mm L, with undoped YAG of 0.42mm and 0.56mm x 60mm L, bonded on both large faces and undoped YAG of 1.1mm x 10mm x 5mm L bonded to both ends

Dopant Type, Concentration Ceramic 1.5% I

Cross-Section 1.1mm x 10mm

Length 60mm L

Doped Thickness 0.11mm L

Undoped Thickness 0.42mm L / 0.56mm L

End-Face Configuration Flat / Flat

Side Specifications Inspection Polished

Top/Bottom surfaces 10/5

Quantity 1

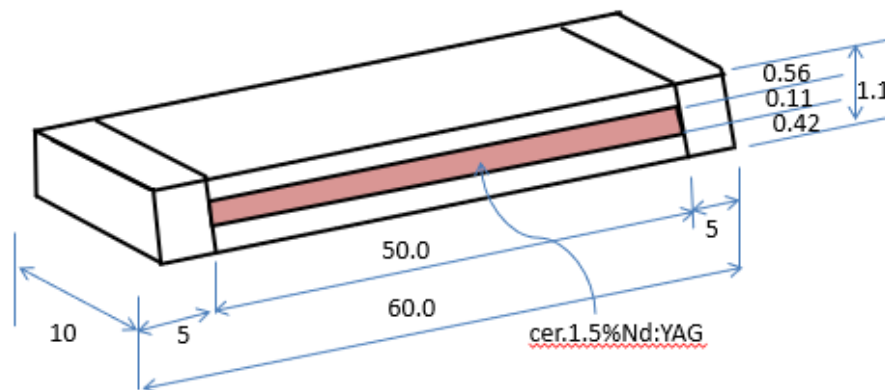

COATING None

PART #050180 AFB® 1% Er:YAG Laser Slab | 2mm x 2mm x 79.9mm L

SPECIFICATIONS Consisting of 1% Er:YAG, 2mm x 2mm x 46mm L, with undoped YAG of 2mm x 2mm x 16.9/17.0mm L bonded to both ends

Dopant Type, Concentration 1% Er:YAG

Cross-Section 2mm x 2mm

Length 79.9mm L

Doped Length 46mm L

Undoped Length 16.9 / 17.0mm L

End-Face Configuration Unfinished, please specify

Side Specifications Laser polished

Quantity 1

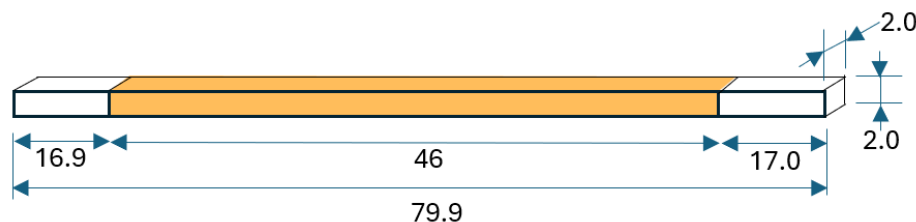

COATING None

PART #050182 AFB® 1% Nd:YAG Laser Slab | 10mm x 10mm x 40mm L

SPECIFICATIONS Consisting of 1% Nd:YAG, 4mm x 10mm x 40mm L, with undoped YAG of 3 mm x 10mm x 40mm, bonded on both 10mm x 40mm sides

Dopant Type, Concentration 1% Nd:YAG
Cross-Section 10mm x 10mm
Length 40mm L
Doped Thickness 4mm L
Undoped Thickness 3mm L (2x)
End-Face Configuration Flat / Flat (one end had edge chips)
Side Specifications Sides fine ground; 10mm x 40mm surfaces polished
Quantity 1

COATING Both 10mm x 10mm end faces R<0.1% @ 1064nm

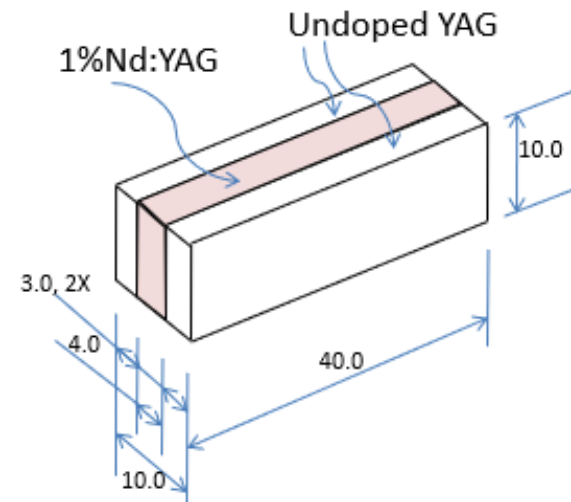

SOLD PART #050187 AFB® 0.6% Nd:YAG Laser Slab | 1.8mm x 5mm x ~50mm L

SPECIFICATIONS Consisting of 0.6% Nd:YAG, 0.6mm x 5mm x ~49mm L, with undoped YAG of 0.6mm x 5mm x ~49mm L bonded to both large faces

Dopant Type, Concentration 0.6% Nd:YAG
Cross-Section 1.8mm x 5mm
Length ~49mm L
Doped Length 0.6mm L
Undoped Length 0.6mm L (2x)
End-Face Configuration Flat/flat
Side Specifications 1.8mm x 50mm sides fine ground; 5mm x 50mm surfaces precision polished
Quantity 2

COATING None

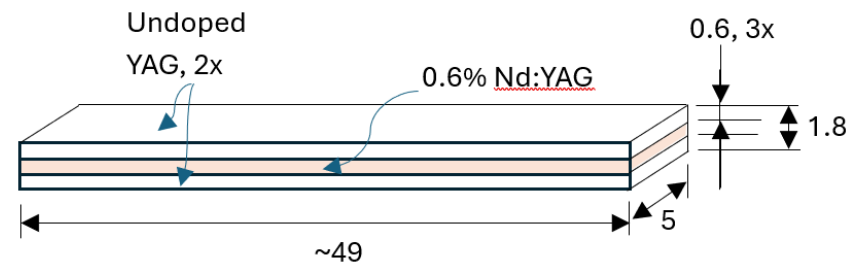

(Part 050183 is still available, ends are unfinished; L = ~49mm)

PART #050188 AFB® Cr3+(0.7%),Nd(0.5%) YAG Laser Slab | 5mm x 5mm x 36mm L

SPECIFICATIONS Consisting of Cr,Nd YAG, 5mm x 5mm x 30mm, with undoped YAG of 5mm x 3.5mm x 6mm, bonded on one end

Dopant Type, Concentration Cr3+(0.7%),Nd(0.5%)

Cross-Section 5mm x 5mm

Length 36mm L

Doped Length 30mm L

Undoped Length 6mm L

End-Face Configuration Doped end: 2° wedge;
undoped end: 2° wedge (anti-parallel)

Side Specifications Fine ground

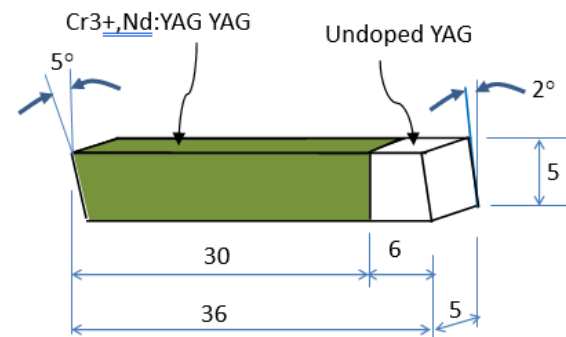

Quantity 4

COATING

# Surf	Side/Face Dimension (mm)	$\lambda 1$ (nm)	Coating	AOI (Degree)	$\lambda 2$ (nm)	Coating	AOI (Degree)
S1 and S2	5x5	1064	AR (R<0.1%)		885	AR (R<0.1%)	0 to 10°
Damage thresholds		20J/cm ² ; 10ns, 400 KHz	300W, 1mm dia		350W CW, 1.5 mm dia		

PART #050189 AFB® 0.5% Nd:YAG Laser Slab | 1mm x 1mm x 60mm L

SPECIFICATIONS Consisting of 0.5% Nd:YAG, 1mm x 1mm x 50mm L, with undoped YAG of 1mm x 1mm x 5mm L bonded to both sides

Dopant Type, Concentration 0.5% Nd:YAG

Cross-Section 1mm x 1mm

Length 60mm L

Doped Length 50mm L

Undoped Length 10mm L (2x)

End-Face Configuration Flat / Flat

Side Specifications Side surfaces 20/10

Quantity 2

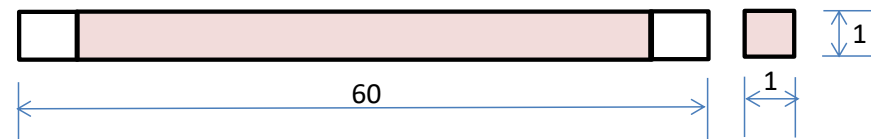

<input checked="" type="checkbox"/> Check here if none							
# Surf	Side/Face Dimension (mm)	$\lambda 1$ (nm)	Coating	AOI (Degree)	$\lambda 2$ (nm)	Coating	AOI (Degree)
Endface 1&2	1x1	1064	T>99.9%	0	885	T>98%	0

COATING

PART #050190 AFB® 0.4% Yb:YAG Laser Slab | 2.5mm x 15.7mm x 129mm L

SPECIFICATIONS Consisting of 0.4% Yb:YAG, 2.5mm x 15.7mm x 100mm L, with undoped YAG of 2.5mm x 15.7mm x 14.5mm L, bonded on both ends

Dopant Type, Concentration 0.4% Yb:YAG

Cross-Section 2.5mm x 15.7mm

Length 129mm L

Doped Length 100mm L

Undoped Length 14.5mm L (2x)

End-Face Configuration Unfinished, please specify

Side Specifications Unfinished, please specify

Quantity 1

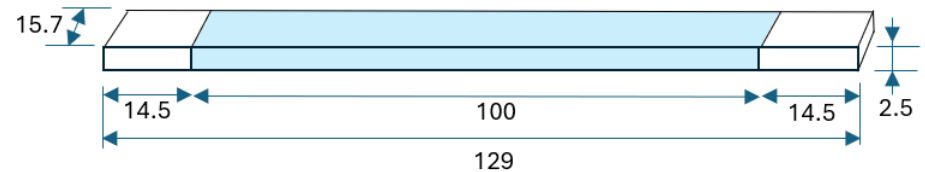

COATING None

PART #050191 AFB® 2% Yb:YAG Laser Slab | 2.5mm x 31.1mm x 32mm L

SPECIFICATIONS Consisting of 2% Yb:YAG, 2.5mm x 12.5mm x 32mm L, with undoped YAG of 2.5mm x 9.3mm x 32mm L bonded to both sides

Dopant Type, Concentration 2% Yb:YAG

Cross-Section 2.5mm x 31mm

Length 32mm L

Doped Width 12.5mm L

Undoped Width 9.3mm L (2x)

End-Face Configuration Unfinished, please specify

Side Specifications Unfinished, please specify

Quantity 3

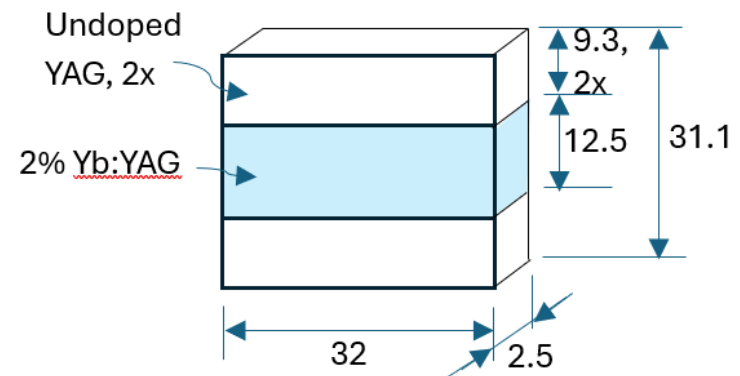

COATING None

PART #050194 AFB® 0.5% Yb:YAG Laser Slab | 3mm x 4mm x 88mm L

SPECIFICATIONS Consisting of 0.5% Yb:YAG, 3mm x 4mm x 88mm L, with undoped YAG of 3mm x 4mm x 16.5mm L, bonded on both ends

Dopant Type, Concentration 0.4% Yb:YAG
Cross-Section 3mm x 4mm
Length 88mm L
Doped Length 55mm L
Undoped Length 16.5mm L (2x)
End-Face Configuration Unfinished, please specify
Side Specifications Precision polished
Quantity 2

COATING None

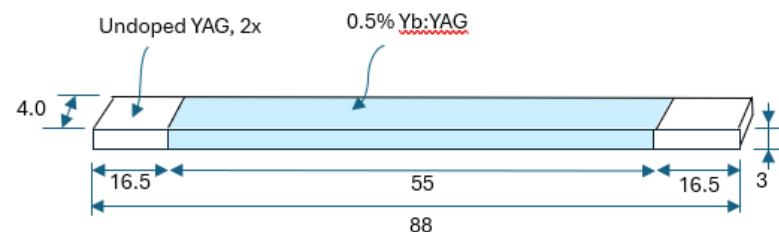

PART #050201 AFB® Sapphire / 0.6% Nd:YAG / Sapphire Laser Slab | 2.1mm x 10mm x <28mm L

SPECIFICATIONS Consisting of 0.6% Nd:YAG, 0.115mm x 10mm x <28mm L, with sapphire of 1.0mm x 10mm x <28mm L bonded to both sides

Dopant Type, Concentration 0.6% Nd:YAG
Cross-Section 2.1mm x 10mm
Length <28mm L
Doped Thickness 0.115mm L
Sapphire Thickness 1.0mm L (2x)
End-Face Configuration Unfinished, please specify
Top/Bottom Specifications Fine ground
Side Specifications Inspection polished
Quantity 1

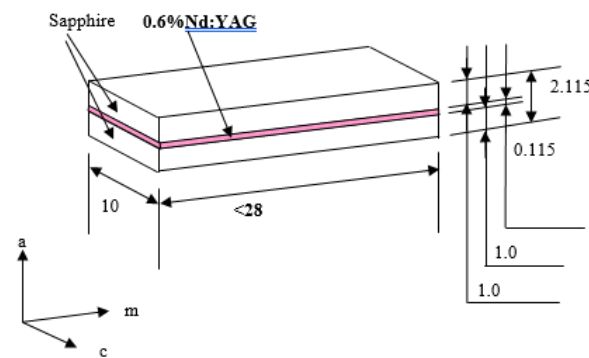

COATING None

PART #050203 AFB® 1% Nd:YAG Laser Slab | <6.1mm x <9mm x <54mm L

SPECIFICATIONS Consisting of 1% Nd:YAG, 0.10mm x <9mm x <54mm L, with undoped YAG of <3mm x <9mm x <54mm L, bonded on both ends

Dopant Type, Concentration 1% Nd:YAG

Cross-Section <6.1mm x <9mm

Length <54

Doped Thickness 0.100mm

Undoped Length <3mm (2x) (please specify)

End-Face Configuration Unfinished, please specify

Side Specifications Unfinished, please specify

Quantity 1

COATING None

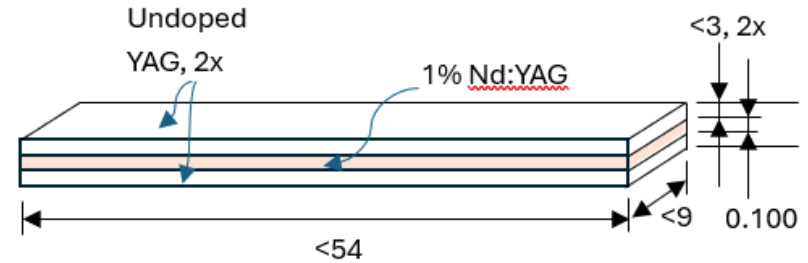

PART #050212 AFB® 2% Ho:YAG Laser Slab | 1.8mm x 5.5mm x 33mm L

SPECIFICATIONS Consisting of 2% Ho:YAG with undoped YAG cladding on 4 sides

Dopant Type, Concentration 2% Ho:YAG

Cross-Section 1.8mm x 5.5mm

Length 42.53 (tip to tip)

End-Face Configuration Polished

Side Specifications Polished

Quantity 1

COATING None

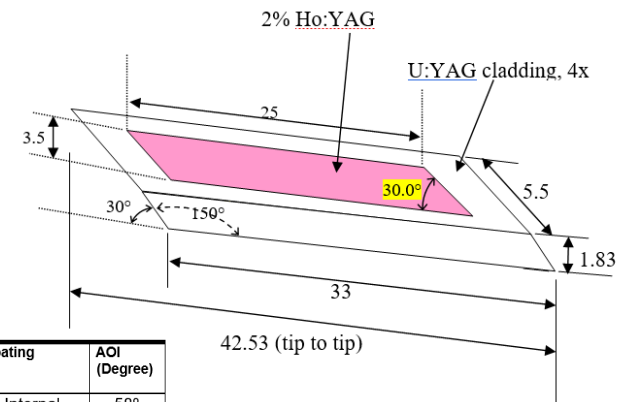

# Surface #1 and #2	Side/Face Dimension (mm)	λ1 (nm)	Coating	AOI (Degree)	λ2 (nm)	Coating	AOI (Degree)
Both wedged ends	5.5mm x 2.0mm	1900-1960nm	External Rs,p<0.5% (Rave<0.25%)	15° (+/-10°)	2050-2150nm	Internal Rs,p>99.5%	58° (+/-5°)

PART #050213 AFB® 1% Nd:YAG Laser Slab | 8mm x 8mm x 73.6mm L

SPECIFICATIONS Consisting of 1% Nd:YAG, 4.5mm x 4.5mm x 73.6mm L, with undoped YAG claddings of 1.75mm thick bonded to all four side surfaces

Dopant Type, Concentration 1% Nd:YAG

Cross-Section 8mm x 8mm

Length 73.6

Doped Thickness 4.5mm x 4.5mm

Undoped Length 1.75mm, 4x

End-Face Configuration Polished

Side Specifications Fine ground

Quantity 1

COATING None

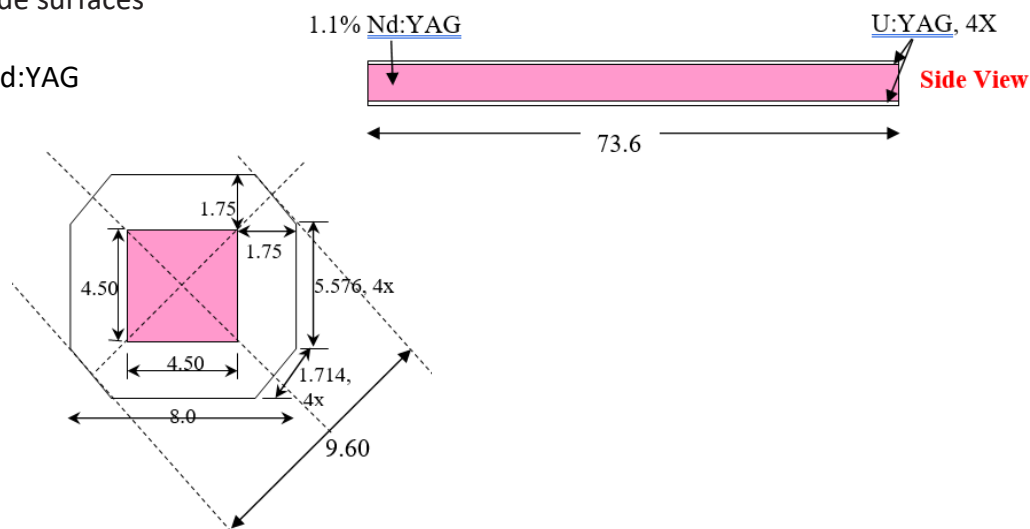

PART #050215 AFB® 50% Er:YAG Laser Slab | 3.5mm x 6.5mm x 3mm Th

SPECIFICATIONS Consisting of 50% Er:YAG, 3.5mm x 6.5mm x 2mm th with undoped YAG, 3.5mm x 6.5mm x 1mm th, bonded on one 3.5mm x 6.5mm face

Dopant Type, Concentration 50% Er:YAG

Cross-Section 3.5mm x 6.5mm

Thickness 3

End-Face Configuration Polished

Side Specifications Fine Ground

Quantity 3

COATING None

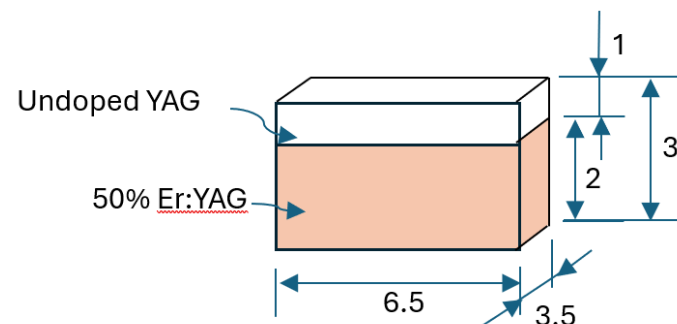

THIS PAGE INTENTIONALLY LEFT BLANK

PART #040133 AFB® 1% Nd:YVO4 Laser Slab | 3mm x 3mm x 7.5mm L

SPECIFICATIONS Consisting of 1% Nd:YVO4, 3mm x 3mm x 1.5mm L, with undoped YVO4 3mm x 3mm x 3mm L bonded to both ends

Dopant Type, Concentration 1% Nd:YVO4

Cross-Section 3mm x 3mm

Length 7.5mm L

Doped Length 1.5mm L

Undoped Length 3mm L (2x)

End-Face Configuration Flat/Flat

Side Specifications Fine Ground

Quantity 2

COATING None

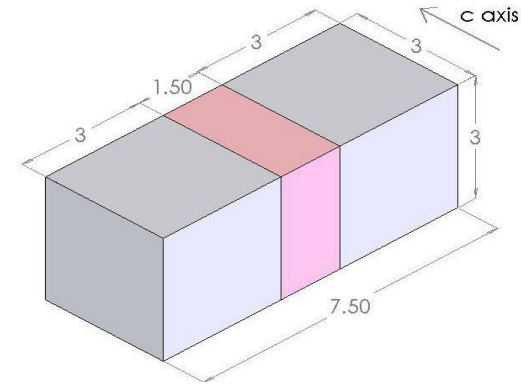

PART #040135 AFB® 0.3% Nd:YVO4 Laser Slab | 3mm x 3mm x 7mm L

SPECIFICATIONS Consisting of 0.3% Nd:YVO4, 3mm x 3mm x 1.0mm L, with undoped YVO4 3mm x 3mm x 3mm L bonded to both ends

Dopant Type, Concentration 0.3% Nd:YVO4

Cross-Section 3mm x 3mm

Length 7mm L

Doped Length 1mm L

Undoped Length 3mm L (2x)

End-Face Configuration Flat/Flat

Side Specifications Fine Ground

Quantity 2

COATING None

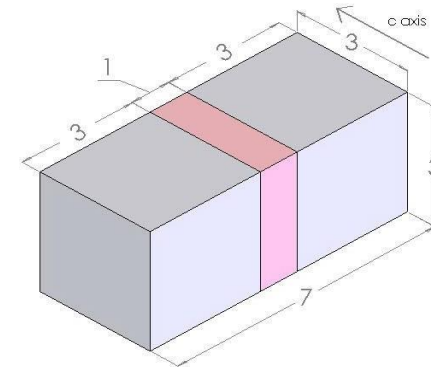

PART #040137 AFB® 0.3% Nd:YVO4 Laser Slab | 3mm x 3mm x 7mm L

SPECIFICATIONS Consisting of 0.3% Nd:YVO4, 3mm x 3mm x 1mm L, with undoped YVO4 3mm x 3mm x 3mm L bonded to both ends

Dopant Type, Concentration 0.3% Nd:YVO4

Cross-Section 3mm x 3mm

Length 7mm L

Doped Length 1mm L

Undoped Length 3mm L (2x)

End-Face Configuration Flat/Flat

Side Specifications Fine Ground

Quantity 1

COATING None

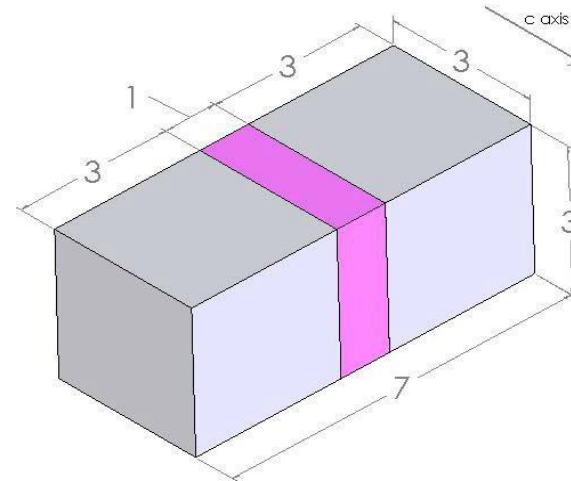

PART #040157 AFB® 2% Nd:YVO4 Laser Slab | 3mm x 3mm x 7.8mm L

SPECIFICATIONS Consisting of 2% Nd:YVO4, 3mm x 3mm x 0.3mm L, with undoped YVO4 3mm x 3mm x 7.5mm L bonded to one end

Dopant Type, Concentration 2% Nd:YVO4

Cross-Section 3mm x 3mm

Length 7.8mm L

Doped Length 0.3mm L

Undoped Length 7.5mm L

End-Face Configuration Flat/Flat

Side Specifications Fine Ground

Quantity 1

COATING None

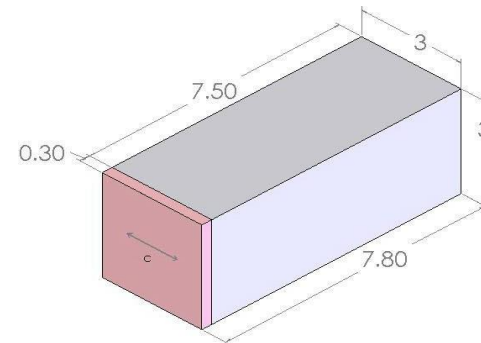

PART #040159 AFB® 1% Nd:YVO4 Laser Slab | 3mm x 3.5mm x 6.5mm L

SPECIFICATIONS Consisting of 1% Nd:YVO4, 3mm x 3.25mm x 3.25mm L, with undoped YVO4 3mm x 3.25mm x 3.25mm L bonded to one end

Dopant Type, Concentration 1% Nd:YVO4

Cross-Section 3mm x 3.5mm

Length 6.5mm L

Doped Length 3.25mm L

Undoped Length 3.25mm L

End-Face Configuration 2 degree parallel wedge

Side Specifications Fine Ground

Quantity 1

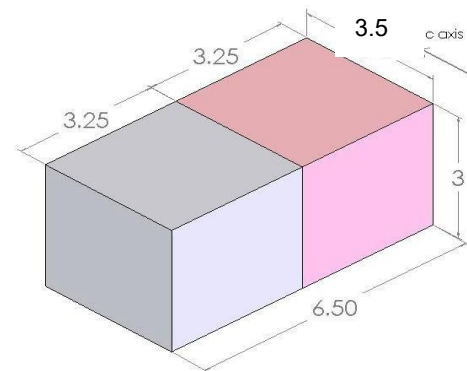

COATING None

PART #040171 AFB® 1% Nd:YVO4 Laser Slab | 3mm x 3mm x 10.5mm L

SPECIFICATIONS Consisting of 1% Nd:YVO4, 3mm x 3mm x 0.5mm L, with undoped YVO4 of 3mm x 3mm x 5mm bonded to both ends

Dopant Type, Concentration 1% Nd:YVO4

Cross-Section 3mm x 3mm

Length 10.5mm L

Doped Length 0.5mm L

Undoped Length 5mm L

End-Face Configuration Flat/Flat

Side Specifications Fine Ground

Quantity 1

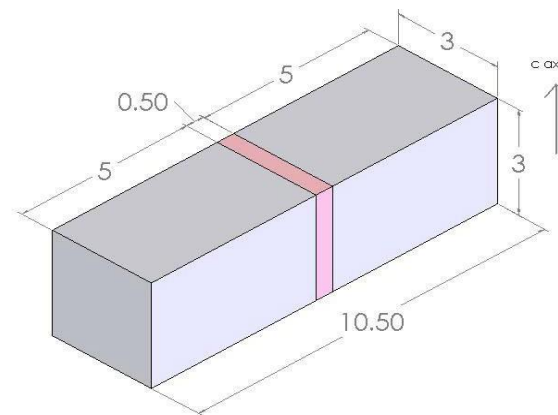

COATING None

PART #040183 AFB® 0.3% Nd:YVO4 Laser Slab | 3mm x 3mm x 14mm L

SPECIFICATIONS Consisting of 0.3% Nd:YVO4, 3mm x 0.5mm x 14mm L, with undoped YVO4 3mm x 1.25mm x 14mm L bonded to both ends

Dopant Type, Concentration 0.3% Nd:YVO4
Cross-Section 3mm x 3mm
Length 14mm L
Doped Length 0.5mm H
Undoped Length 1.25mm H (2x)
End-Face Configuration Flat/Flat
Side Specifications Fine Ground & Inspection Polished
Quantity 1

COATING None

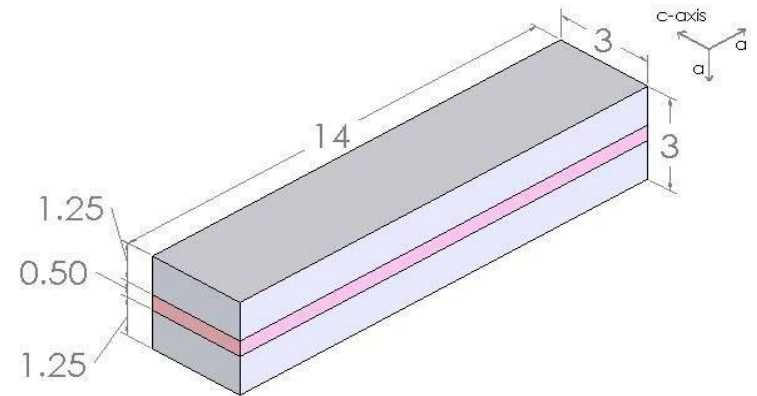

PART #040188 AFB® 0.5% Nd:YVO4 Laser Slab | 3mm x 3.5mm x 6.5mm L

SPECIFICATIONS Consisting of 0.5% Nd:YVO4, 3mm x 3.5mm x 3.5mm L, with undoped YVO4 of 3mm x 3.5mm x 3mm bonded to one end

Dopant Type, Concentration 0.5% Nd:YVO4
Cross-Section 3mm x 3.5mm
Length 3.5mm L
Doped Length 15mm L
Undoped Length 3mm L
End-Face Configuration Flat/Flat
Side Specifications Fine Ground
Quantity 3

COATING None

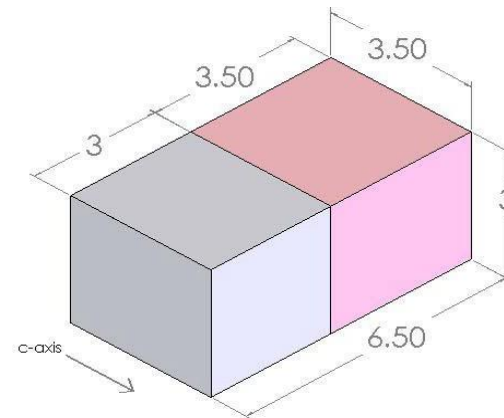

PART #040193 AFB® 1% Nd:YVO4 Laser Slab | 3mm x 3mm x 25mm L

SPECIFICATIONS Consisting of 1% Nd:YVO4, 3mm x 3mm x 15mm L, with undoped YVO4 of 3mm x 3mm x 5mm bonded to both ends

Dopant Type, Concentration 1% Nd:YVO4

Cross-Section 3mm x 3mm

Length 25mm L

Doped Length 15mm L

Undoped Length 5mm L (2x)

End-Face Configuration Flat/Flat

Side Specifications Fine Ground

Quantity 2

COATING None

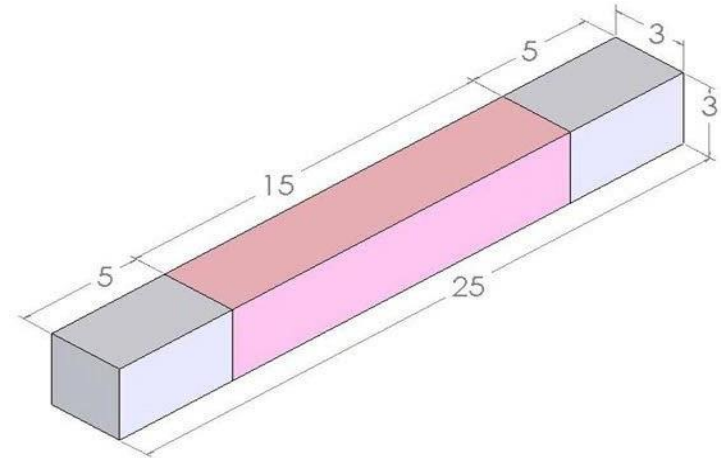

PART #040218 AFB® 0.5% Nd:YVO4 Laser Slab | 3.4mm x 11.5mm x 11.5mm L

SPECIFICATIONS Consisting of 0.5% Nd:YVO4, 1.5mm x 11.5mm x 11.5mm L, with undoped YVO4 of 1.9mm x 11.5mm x 11.5mm bonded to one large surface

Dopant Type, Concentration 0.5% Nd:YVO4

Cross-Section 3.4mm x 11.5mm

Length 11.5mm L

Doped Length 1.5mm L

Undoped Length 1.9mm L

End-Face Configuration Flat/Flat

Side Specifications Fine Ground

Quantity 1

COATING None

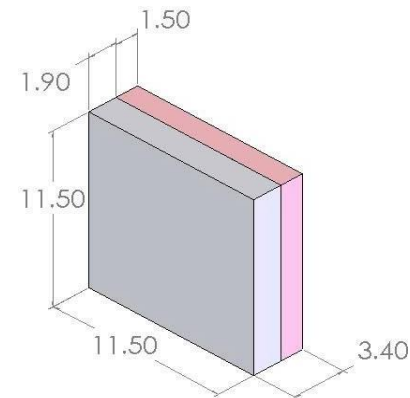

PART #040219 AFB® 1% Nd:YVO4 Laser Slab | 3.55mm x 11.5mm x 11.5mm L

SPECIFICATIONS Consisting of 1% Nd:YVO4, 1.5mm x 11.5mm x 11.5mm L, with undoped YVO4 of 2.05mm x 11.5mm x 11.5mm bonded to one large surface

Dopant Type, Concentration 1% Nd:YVO4

Cross-Section 3.55mm x 11.5mm

Length 11.5mm L

Doped Length 1.5mm L

Undoped Length 2.05mm L

End-Face Configuration Flat/Flat

Side Specifications Fine Ground

Quantity 1

COATING None

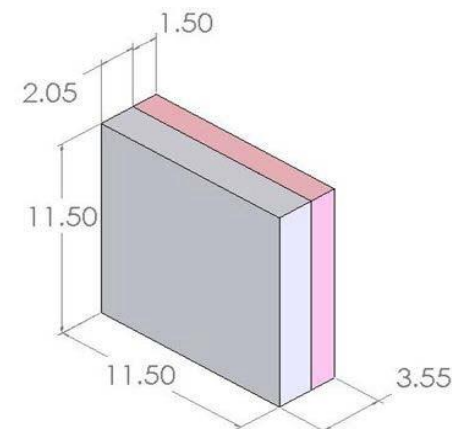

PART #040231 AFB® 0.2% Nd:YVO4 Laser Slab | 2.5mm x 6mm x 8mm L

SPECIFICATIONS Consisting of 0.2% Nd:YVO4, 2.5mm x 6mm x 5mm, with undoped YVO4 of 2.5mm x 6.0mm x 3mm bonded to one end.

Dopant Type, Concentration 0.2% Nd:YVO4

Cross-Section 2.5mm x 6mm

Length 8mm L

Doped Length 5mm L

Undoped Length 3mm L

End-Face Configuration Flat/Flat

Side Specifications Fine Ground

Quantity 7

COATING None

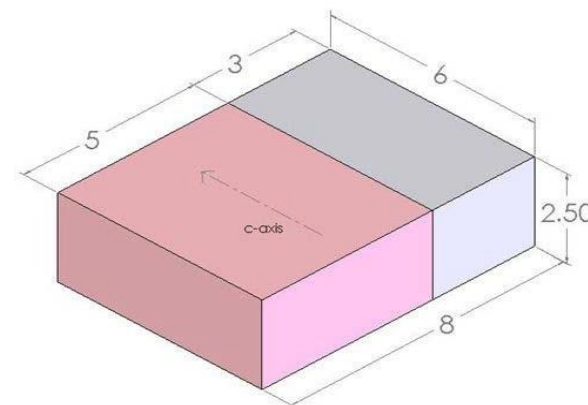

PART #040233 AFB® 0.3% Nd:YVO4 Laser Slab | 2.5mm x 2.5mm x 14mm L

SPECIFICATIONS Consisting of 0.3% Nd:YVO4, 2.5mm x 2.5mm x 8mm L, with undoped YVO4 of 2.5mm x 2.5mm x 3mm L bonded to both ends

Dopant Type, Concentration 0.3% Nd:YVO4

Cross-Section 2.5mm x 2.5mm

Length 14mm L

Doped Length 8mm L

Undoped Length 3mm L

End-Face Configuration Flat/Flat

Side Specifications Fine Ground

Quantity 3

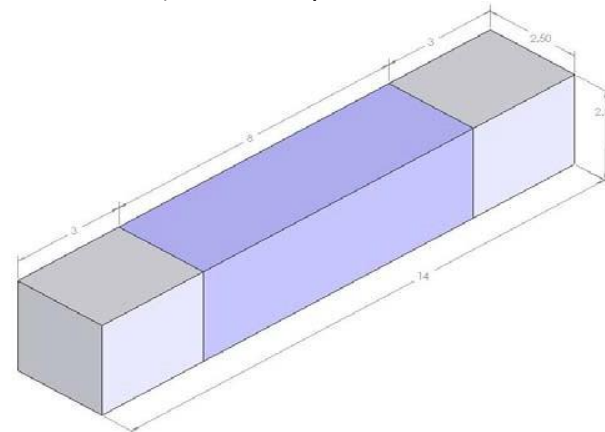

COATING Both 2.5mm x 2.5mm end faces AR @ 1064nm and 808

PART #040241 AFB® 0.3% Nd:YVO4 Laser Slab | 2mm x 2mm x 10mm L

SPECIFICATIONS Consisting of 0.3% Nd:YVO4, 2mm x 2mm x 6mm L, with undoped YVO4 of 2mm x 2mm x 2mm L bonded to both ends

Dopant Type, Concentration 0.3% Nd:YVO4

Cross-Section 2mm x 2mm

Length 10mm L

Doped Length 6mm L

Undoped Length 2mm L (2x)

End-Face Configuration Flat/Flat

Side Specifications Fine Ground

Quantity 5

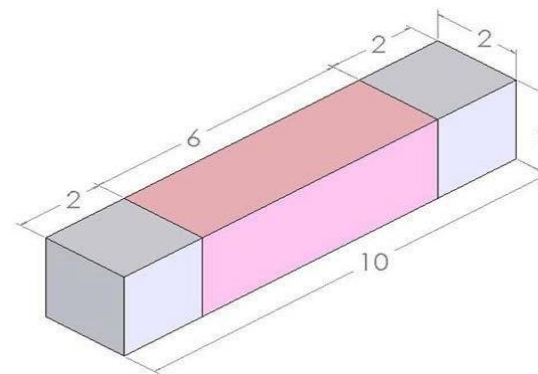

COATING Both ends R<0.1% @ 1064nm, R<3.0% @ 808nm

PART #040248 AFB® 0.3% Nd:YVO4 Laser Slab | 5mm x 5mm x 10mm L

SPECIFICATIONS Consisting of 0.3% Nd:YVO4, 5mm x 5mm x 6mm, with undoped YVO4 of 5mm x 5mm x 2mm bonded to both ends

Dopant Type, Concentration 0.3% Nd:YVO4

Cross-Section 5mm x 5mm

Length 10mm L

Doped Length 6mm L

Undoped Length 2mm L (2x)

End-Face Configuration Flat/Flat

Side Specifications Fine Ground

Quantity 1

COATING None

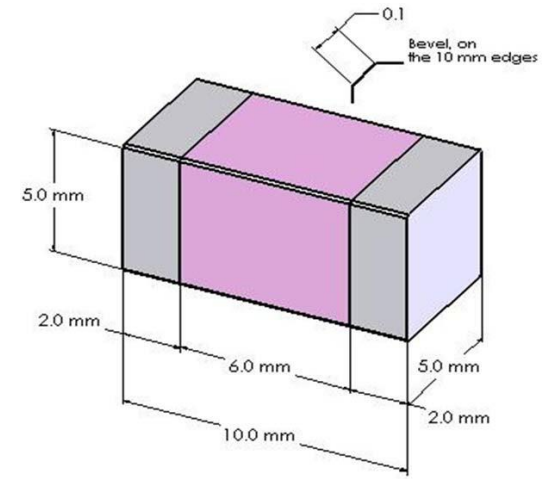

PART #040317 AFB® 0.3% Nd:YVO4 Laser Slab | 3mm x 3mm x 10mm L

SPECIFICATIONS Consisting of 0.3% Nd:YVO4, 3mm x 3mm x 8mm L, with undoped YVO4 of 3mm x 3mm x 2mm L bonded to one end

Dopant Type, Concentration 0.3% Nd:YVO4

Cross-Section 3mm x 3mm

Length 10mm L

Doped Length 8mm L

Undoped Length 2mm L

End-Face Configuration Flat/Flat

Side Specifications Fine Ground

Quantity 3

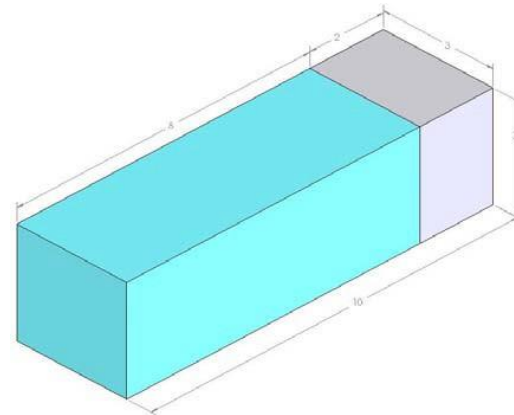

COATING Both ends R<0.1% @ 1064nm and 808nm

PART #040313 AFB® 0.3% Nd:YVO4 Laser Slab | 3mm x 3mm x 8mm L

SPECIFICATIONS Consisting of 0.3% Nd:YVO4, 3mm x 3mm x 8mm L, with undoped YVO4 of 3mm x 3mm x 2mm L bonded to one end

Dopant Type, Concentration 0.3% Nd:YVO4

Cross-Section 3mm x 3mm

Length 10mm L

Doped Length 8mm L

Undoped Length 2mm L

End-Face Configuration Flat/Flat

Side Specifications Fine Ground

Quantity 2

COATING Nd:YVO4 end: $R < 0.2\%$ @ 1064nm

U:YVO4 end: $R < 0.2\%$ @ 1064nm and $R < 0.5\%$ @ 808nm

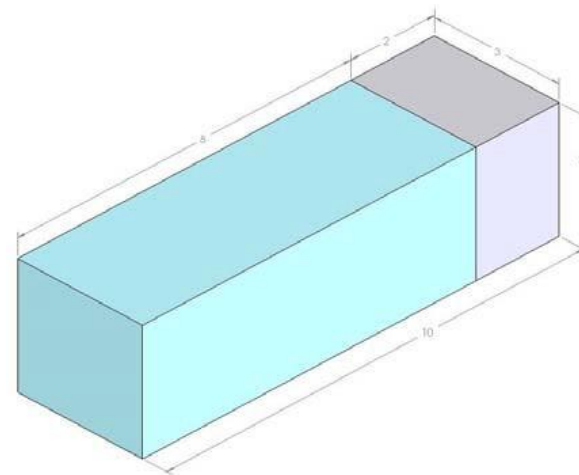

PART #050155 AFB® 0.3% Nd:YVO4 Laser Slab | 4mm x 4mm x 21mm L

SPECIFICATIONS Consisting of 0.3% Nd:YVO4, 4mm x 4mm x 15mm, with undoped YVO4 of 4mm x 4mm x 3mm bonded to both ends (1 degree anti-parallel wedge)

Dopant Type, Concentration 0.3% Nd:YVO4

Cross-Section 4mm x 4mm

Length 21mm L

Doped Length 15mm L

Undoped Length 3mm L (2x)

End-Face Configuration 1 degree anti-parallel wedge

Side Specifications Fine Ground

Quantity 1

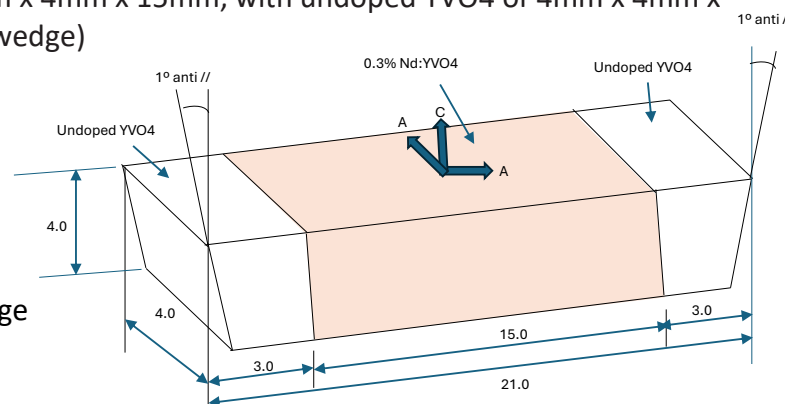

COATING AR at 1064nm and 878nm

PART #050156 AFB® 0.3% Nd:YVO4 Laser Slab | 3mm x 3mm x 25mm L

SPECIFICATIONS Consisting of 0.3% Nd:YVO4, 3mm x 3mm x 8mm L, with undoped YVO4 of 3mm x 3mm x 2mm bonded to one end

Dopant Type, Concentration 0.3% Nd:YVO4

Cross-Section 3mm x 3mm

Length 10mm L

Doped Length 8mm L

Undoped Length 2mm L

End-Face Configuration Flat/Flat

Side Specifications Fine Ground

Quantity 1

COATING AR coated at 880nm and 1064nm

PART #050158 is available with 0.5% Nd concentration

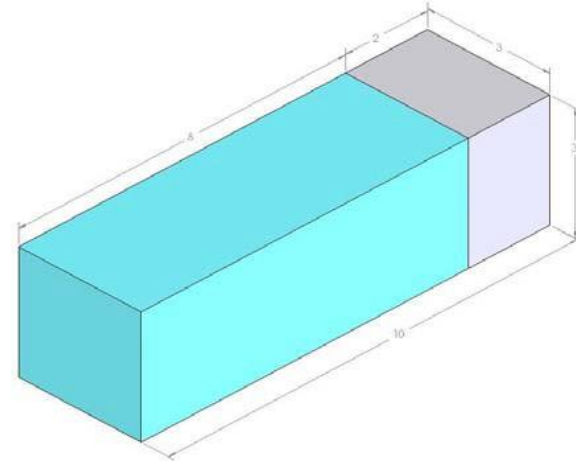

PART #050161 AFB® 0.5% Nd:YVO4 Laser Slab | 4mm x 4mm x 30mm L

SPECIFICATIONS Consisting of 0.5% Nd:YVO4, 4mm x 4mm x 24mm L, with undoped YVO4 of 4mm x 4mm x 3mm bonded to both ends

Dopant Type, Concentration 0.5% Nd:YVO4

Cross-Section 4mm x 4mm

Length 30mm L

Doped Length 24mm L

Undoped Length 3mm L

End-Face Configuration Flat/Flat

Side Specifications Fine Ground

Quantity 1

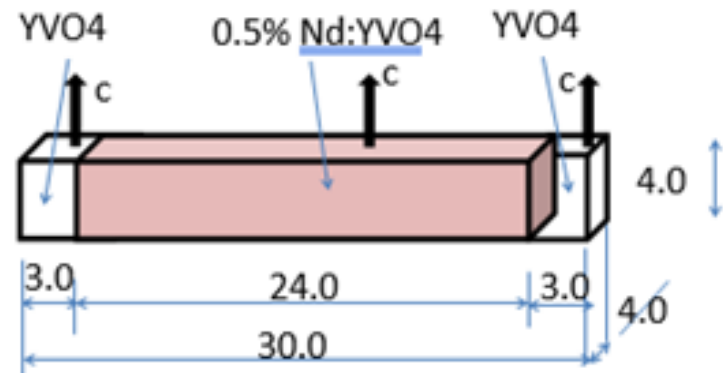

COATING None

PART #050162 AFB® 0.7% Nd:YVO4 Laser Slab | 4mm x 4mm x 30mm L

SPECIFICATIONS Consisting of 0.7% Nd:YVO4, 4mm x 4mm x 24mm L, with undoped YVO4 of 4mm x 4mm x 3mm bonded to both ends

Dopant Type, Concentration 0.7% Nd:YVO4

Cross-Section 4mm x 4mm

Length 30mm L

Doped Length 24mm L

Undoped Length 3mm L (2x)

End-Face Configuration Flat/Flat

Side Specifications Fine Ground

Quantity 1

COATING None

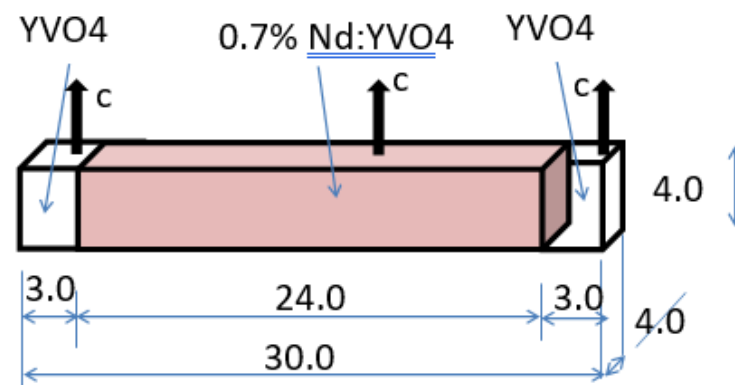

PART #050173 AFB® 0.7% Nd:YVO4 Laser Slab | 4mm x 4mm x 30mm L

SPECIFICATIONS Consisting of 0.7% Nd:YVO4, 4mm x 4mm x 18mm L, with undoped YVO4 of 4mm x 4mm x 6mm bonded to both ends

Dopant Type, Concentration 0.7% Nd:YVO4

Cross-Section 4mm x 4mm

Length 30mm L

Doped Length 18mm L

Undoped Length 6mm L (2x)

End-Face Configuration Flat/Flat

Side Specifications Fine Ground

Quantity 1

COATING None

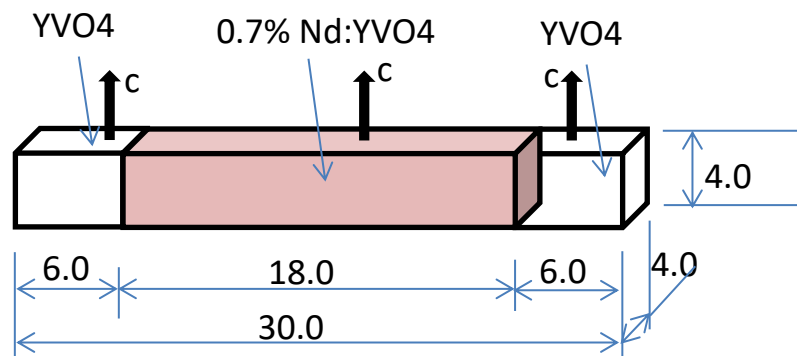

PART #050211 AFB® 0.7% Nd:YVO4 Laser Slab | 6.8mm x 11.4mm x 25.4mm L

SPECIFICATIONS Consisting of 0.7% Nd:YVO4, 6.8mm x 11.4mm x 22.2mm L, with undoped YVO4 of 6.8mm x 11.4mm x 3.2mm bonded to one end

Dopant Type, Concentration 0.7% Nd:YVO4

Cross-Section 6.8mm x 11.4mm

Length 25.4mm L

Doped Length 22.2mm L

Undoped Length 3.2mm L

End-Face Configuration unfinished

Side Specifications Fine Ground

Quantity 1

COATING None

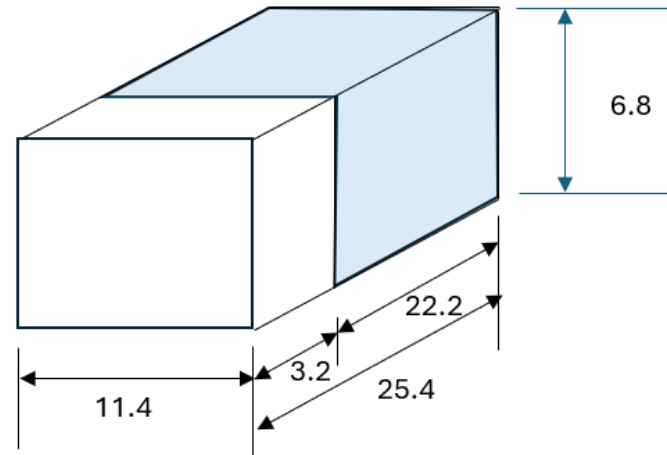

PART #050214 AFB® 0.3% Nd:YVO4 Laser Slab | 2.5mm x 2.5mm x 10.9mm L

SPECIFICATIONS Consisting of 0.3% Nd:YVO4, 2.5mm x 2.5mm x 7.9mm L, with undoped YVO4 of 2.5mm x 2.5mm x 3mm bonded to one end

Dopant Type, Concentration 0.3% Nd:YVO4

Cross-Section 2.5mm x 2.5mm

Length 10.9mm L

Doped Length 7.9mm L

Undoped Length 3mm L

End-Face Configuration Flat/Flat

Side Specifications Fine Ground

Quantity 3

COATING None

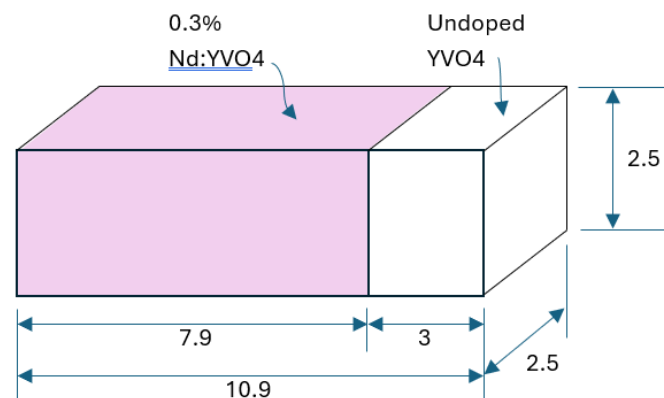

40%

Dopant Type, Concentration 0.7% Nd:YVO4

Length 25.4mm L

Doped Length 22.2mm L

Undoped Length 3.2mm L

End-Face Configuration unfinished

Side Specifications Fine Ground

Quantity 1

COATING None

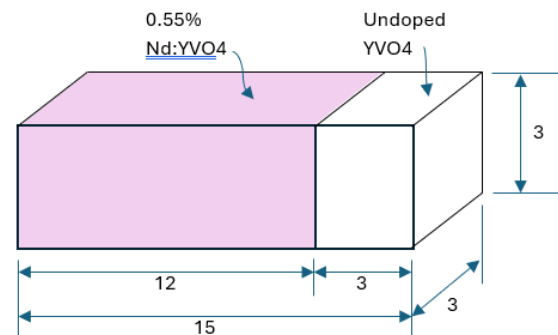

# Surface	Side/Face Dimension (mm)	λ1 (nm)	Coating	AOI (Degree)	λ2 (nm)	Coating	AOI (Degree)
Both ends	3mm x 3mm	1064nm	AR R<0.15%	0	880nm	AR R<3.0%	0

THIS PAGE INTENTIONALLY LEFT BLANK

PART #040249 AFB® 0.5% Nd:YVO4 Laser Slab | 4mm dia x 9.8mm L

SPECIFICATIONS Consisting of 0.5% Nd:YVO4, 5mm x 5mm x 6mm L, with undoped YVO4 of 5mm x 5mm x 2mm L bonded to both ends

Dopant Type, Concentration 0.5% Nd:YVO4

Cross-Section 4mm dia

Length 9.8mm L

Doped Length 8mm L

Undoped Length 0.9mm L (2x)

End-Face Configuration Flat/Flat

Side Specifications Fine Ground

Quantity 1

COATING None

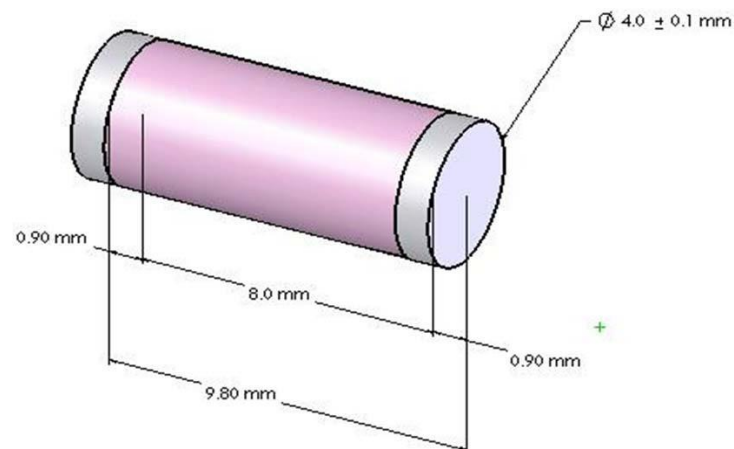

PART #040252 AFB® 0.2% Nd:YVO4 Laser Slab | 3mm dia x 30mm L

SPECIFICATIONS Consisting of 0.5% Nd:YVO4, 3mm dia x 20mm L, with undoped YVO4 of 3mm x 5mm L bonded to both ends

Dopant Type, Concentration 0.2% Nd:YVO4

Cross-Section 3mm dia

Length 30mm L

Doped Length 20mm L

Undoped Length 5mm L (2x)

End-Face Configuration Flat/Flat

Side Specifications Fine Ground

Quantity 2

COATING None

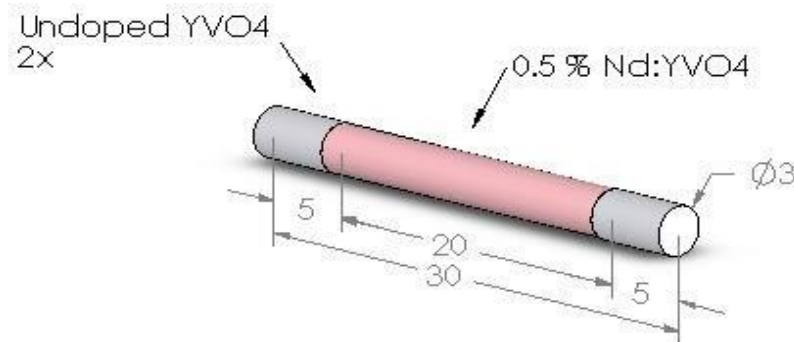

THIS PAGE INTENTIONALLY LEFT BLANK

PART #040182 AFB® TH:YLF Laser Rod | 4mm x 3.5mm x 52mm L

SPECIFICATIONS Consisting of Th:YLF, 4mm dia. x 20mm L, with undoped YLF of 4mm dia. x 16 mm L bonded to both ends

Dopant Type, Concentration 6% Tm, 0.4% Ho

Cross-Section 4mm dia

Length 52mm L

Doped Length 20mm L

Undoped Length 16mm L (x2)

End-Face Configuration Flat/Flat

Side Specifications Inspection Polished

Quantity 1

COATING None

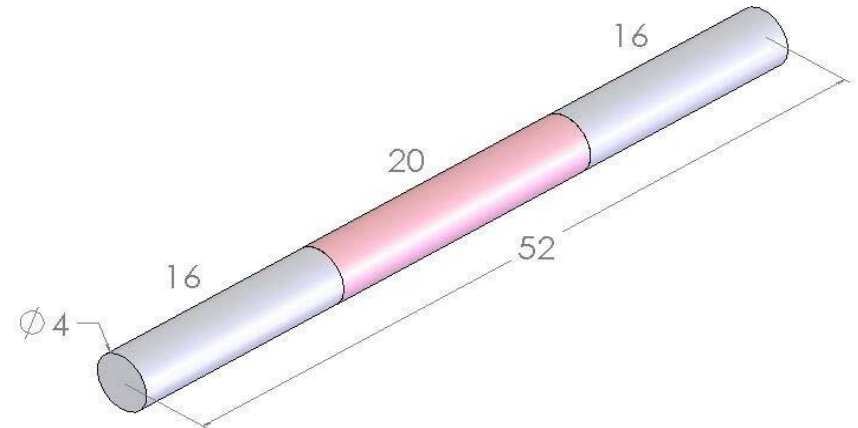

PART #040222 AFB® 0.5% Nd:YLF Laser Rod | 6.35mm dia x 20mm L

SPECIFICATIONS Consisting of 0.5% Nd:YLF, 6.35 mm dia. x 14 mm L, with undoped YLF of 4.0 mm dia. x 6 mm L bonded to one end

Dopant Type, Concentration 0.5% Nd:YLF

Cross-Section 6.35mm dia

Length 20mm L

Doped Length 14mm L

Undoped Length 6mm L

End-Face Configuration Flat/Flat

Side Specifications Fine Ground

Quantity 1

COATING None

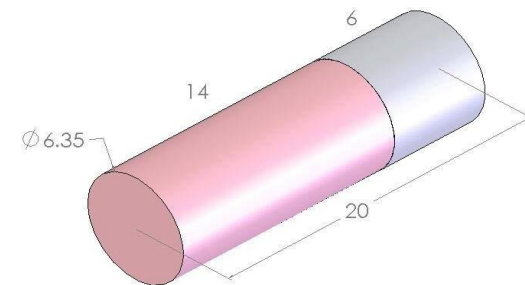

PART #040255 AFB® 3% Tm:YLF Laser Rod | 2.5mm dia x 34mm L

SPECIFICATIONS Consisting of 3% Tm:YLF, 2.5mm dia. x 30mm L, with undoped YLF of 2.5mm dia. x 2mm L bonded to both ends

Dopant Type, Concentration 3% Tm:YLF

Cross-Section 2.5mm dia

Length 34mm L

Doped Length 30mm L

Undoped Length 2mm L (2x)

End-Face Configuration Flat/Flat

Side Specifications Inspection Polished

Quantity 1

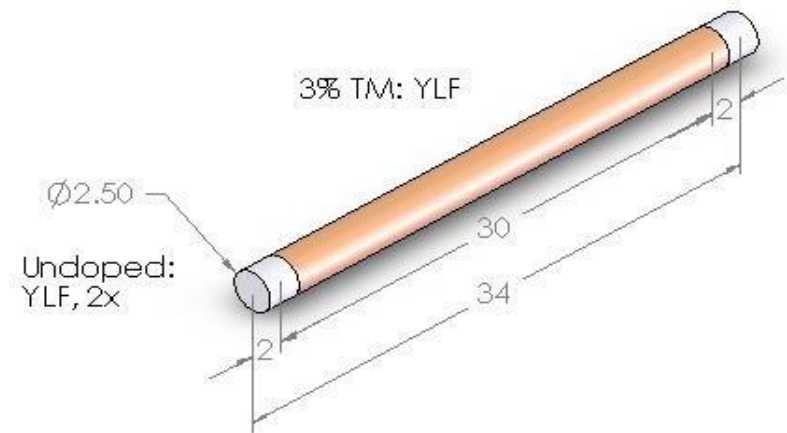

COATING None

PART #050186 AFB® 0.3% Nd:YLF Laser Rod | 4mm dia x 59mm L

SPECIFICATIONS Consisting of 0.3% Nd:YLF, 4mm dia x 45mm L, with undoped YLF of 4mm dia x 7mm L bonded to both ends

Dopant Type, Concentration 0.3% Nd:YLF

Cross-Section 4mm dia

Length 59mm L

Doped Length 45mm L

Undoped Length 7mm L (2x)

End-Face Configuration Flat/Flat

Side Specifications Fine Ground

Quantity 1

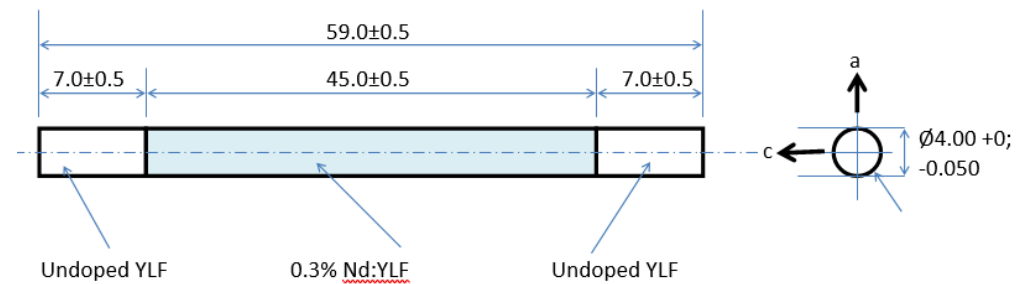

COATING None

PART #050170 AFB® 1% Yb:YLF Laser Slab | 4mm x 10mm x 13mm L

SPECIFICATIONS Consisting of 1% Yb:YLF, 4mm x 10 x 10mm L, with undoped YLF of 4mm x 10mm x 3mm L bonded to one end

Dopant Type, Concentration 1% Yb:YLF

Cross-Section 4mm x 10mm

Length 13mm L

Doped Length 10mm L

Undoped Length 3mm L

End-Face Configuration 0.5° wedge on doped end

Side Specifications Fine Ground

Quantity 1

COATING None

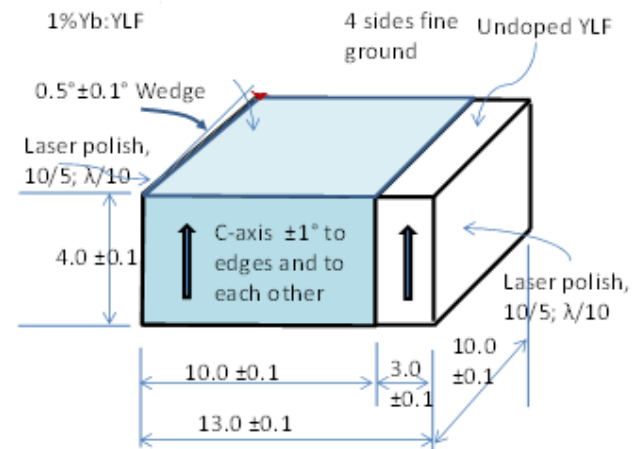

PART #050185 AFB® 1% Nd:YLF Laser Rod | 4mm dia x 79mm L

SPECIFICATIONS Consisting of 1% Nd:YLF, 4mm dia x 65mm L, with undoped YLF of 4mm dia x 7mm L bonded to both ends

Dopant Type, Concentration 1% Nd:YLF

Cross-Section 4mm dia

Length 79mm L

Doped Length 65mm L

Undoped Length 7mm L (2x)

End-Face Configuration Flat/Flat

Side Specifications Fine Ground

Quantity 2

COATING None

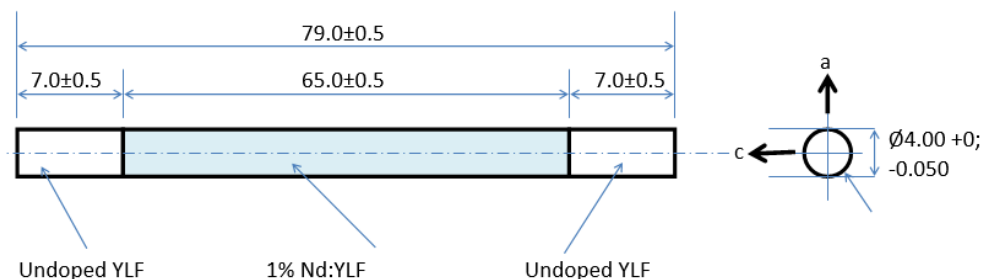

THIS PAGE INTENTIONALLY LEFT BLANK

PART #040240 AFB® 3% Tm:YALO Laser Rod | 2.4mm x 14.5mm L

SPECIFICATIONS Consisting of 3.0% Tm:YALO, 2.4mm dia. x 9.5mm L, with undoped YALO of 2.4mm dia. x 2.5mm L bonded to both ends.

Dopant Type, Concentration 3% Tm:YALO

Cross-Section 2.4mm dia

Length 14.5mm L

Doped Length 9.5mm L

Undoped Length 2.5mm L (x2)

End-Face Configuration Flat/Flat

Side Specifications Fine Ground

Quantity 1

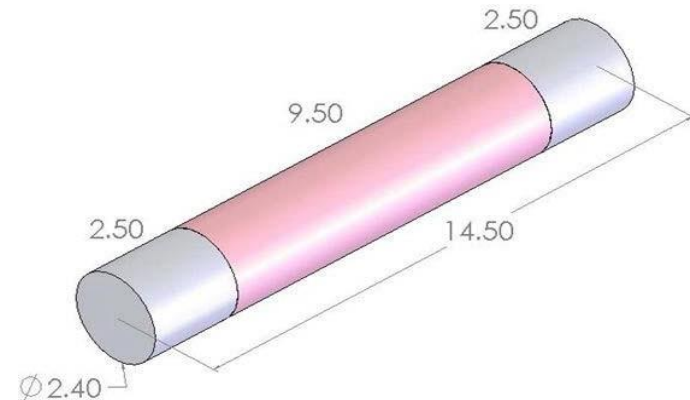

COATING Both ends $R < 0.1\%$ @ 1990nm, $\text{AOI} = 0^\circ$, $R < 1.0\%$ @ 795nm, $\text{AOI} = 0.0^\circ \pm 12.5^\circ$

THIS PAGE INTENTIONALLY LEFT BLANK

PART #040287 AFB® 15% Yb:YAG Laser Slab | 3mm dia x 8mm L

SPECIFICATIONS Consisting of KTP, 5mm x 5mm x 10mm, with KTP of 5mm x 5mm x 10mm bonded to each 5mm x 5mm face.

Dopant Type, Concentration KTP, $\theta = 51.4^\circ \pm 0.5^\circ$, $\Phi = 0^\circ \pm 0.5^\circ$

Cross-Section 5mm x 5mm

Length 20mm L

Doped Length 10mm L (2x)

Undoped Length N/A

End-Face Configuration Flat / Flat

Side Specifications Fine Ground

Quantity 2

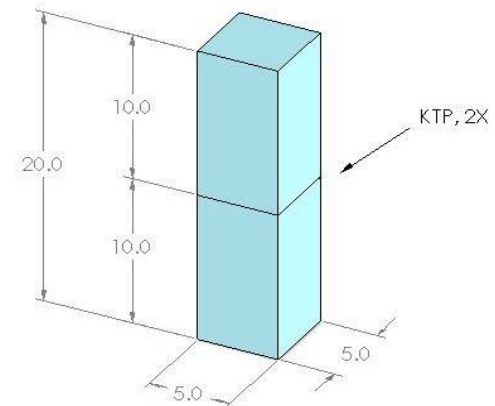

COATING R<0.2% @ 1064nm and 2128nm

PART #040306 Fused Silica Pentagon Prism | 5-10mm x 5-10mm x ~12mm L

SPECIFICATIONS Consisting of a fused silica pentagon prism, 5-10 mm x 5-10 mm x ~12 mm; prism angles 20.33°

Dopant Type, Concentration Fused Silica

Two angled & back surfaces Polished

Remaining surfaces Fine Ground

Quantity 1

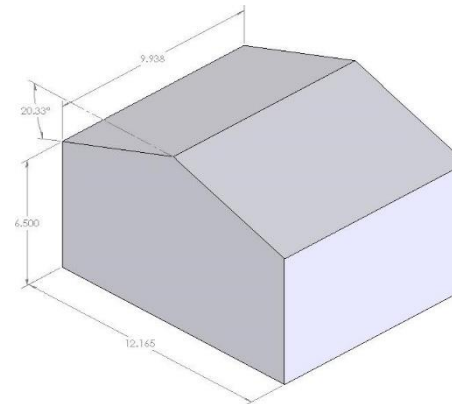

COATING Wedged surfaces: AR @ 1064nm, 30° AOI

Hypotenuse: R=90% @ 1064nm, 0° AOI

PART #040307 Fused Silica Pentagon Prism | 5-10 mm x 5-10 mm x ~12 mm

SPECIFICATIONS Consisting of a fused silica pentagon prism, 5-10mm x 5-10mm x ~12mm; prism angles 13.77°.

Dopant Type, Concentration Fused Silica
Two angled & back surfaces Polished
Remaining surfaces Fine Ground
Quantity 1

COATING Wedged surfaces: AR @ 1064nm, 30° AOI
 Hypotenuse: R=90% @ 1064nm, 0° AOI

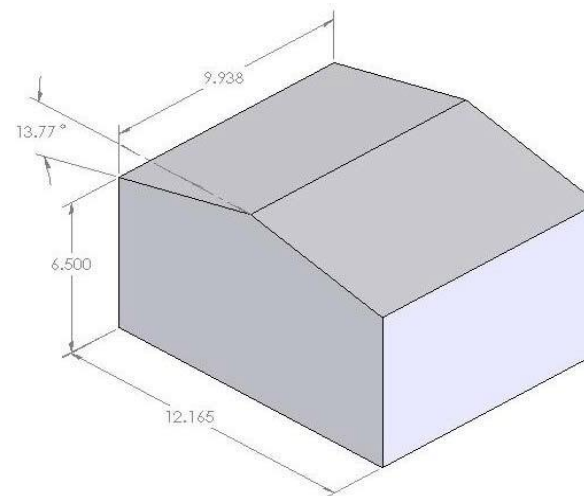

PART #050164 AFB® 25% Yb:LuLiF Laser Slab | 5.25mm x 6mm x 8mm L

SPECIFICATIONS Consisting of 25% Yb:LuLiF, 1.75mm x 6mm x 8mm L, with undoped LuLiF of 1.75mm x 6mm x 8mm bonded to both sides

Dopant Type, Concentration 25% Yb:LuLiF
Cross-Section 6mm x 8mm
Length 5.25mm L
Doped Length 0.75mm L
Undoped Length 0.75mm L (2x)
End-Face Configuration Flat/Flat
Side Specifications Fine Ground
Quantity 1

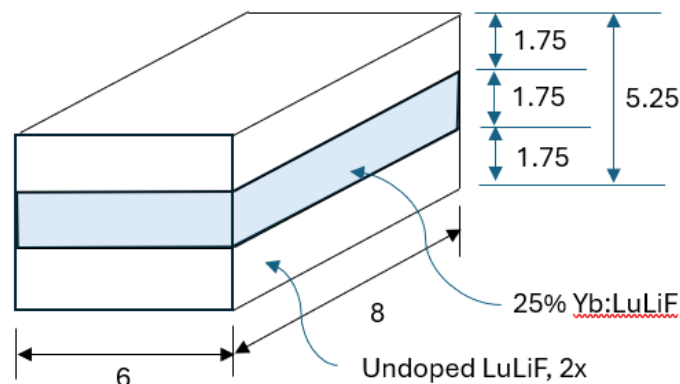

COATING Both 6mm x 8mm surfaces R≤0.5% @ 960nm, R≤0.25% @ 1060nm, 0°

PART #050169 Ti:Sapphire Laser Element | 6mm x 11mm x 17mm

SPECIFICATIONS Consisting of Ti:Sapphire laser element, 6mm x 11mm x 17mm

Absorption 92-96% at 532nm (conc. about 0.1 wt%)

Cross-Section 6mm x 11mm

Length 17mm L

End-Face Configuration Brewster / Brewster

Side Specifications Fine ground

Quantity 1

COATING None

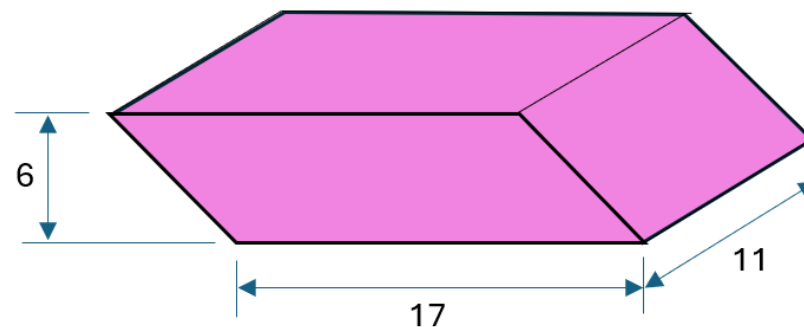

PART #050176 LBO Slab | 6mm x 12mm x 44mm L

SPECIFICATIONS Consisting of 6mm x 12mm x 44mm bulk LBO material, with orientation $\theta=90$ and $\phi=19.3$, for SHG from 946nm to 473nm

Orientation $\theta=90$ and $\phi=19.3$, for SHG from 946nm to 473nm

Cross-Section 6mm x 12mm

Length 44mm L

All Surface Specifications Fine Ground

Quantity 1

COATING None

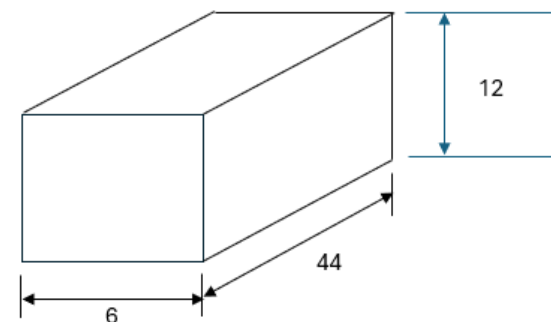

PART #050192 25% Yb:YAG | 3mm dia x 3mm L

SPECIFICATIONS Consisting of 25% Yb:YAG, 3mm dia. x 3mm L

Dopant Type, Concentration 25% Yb:YAG
Cross-Section 3mm dia
Length 3mm L
Doped Length 3mm L
End-Face Configuration Flat/Flat
Side Specifications Fine ground
Quantity 3

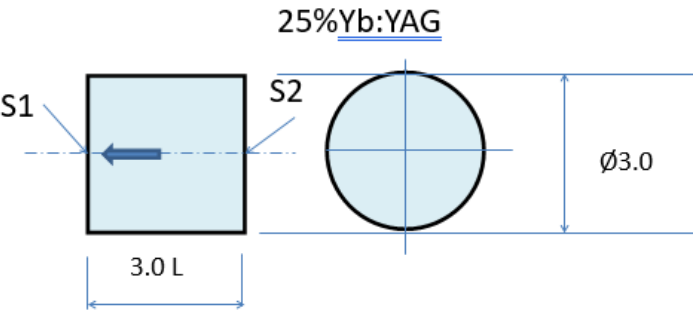

COATING

Damage threshold: 2 W/mm2 as best effort

# Surf	Side/Face Dimension (mm)	λ_1 (nm)	Coating	AOI (Degree)	λ_2 (nm)	Coating	AOI (Degree)
S1	3mm dia	1030	R>98%	0	940 nm	T>95%	
S2	3mm dia	1030	R<0.1%	0			0

PART #040309 Fused Silica Tube | 7.85 mm dia. x 14.5 mm L

SPECIFICATIONS Consisting of fused silica, 7.85mm dia. (6mm inner dia.) x 14.5mm L.

Material Fused Silica
Diameter 7.85mm outer diameter; 6mm inner diameter
Length 14.5mm L
End-Face Configuration Polished
Barrel Specifications Inspection polished
Quantity 1

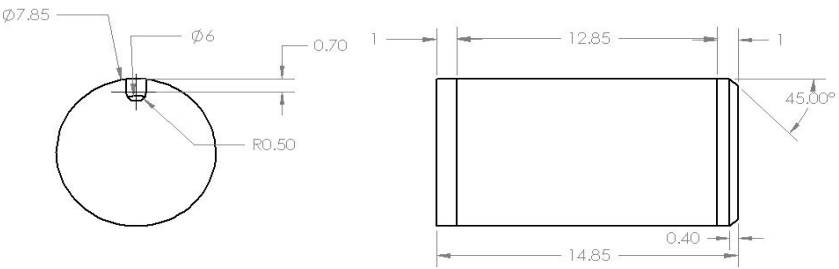

COATING None

THIS PAGE INTENTIONALLY LEFT BLANK

PART #050195 4% Tm:YAG Double-Clad Waveguide | 8.4mm x 16.4mm x 98.9mm L

Core: 4% Tm:YAG, 0.040x0.040 mm

Inner Cladding: Undoped YAG, 0.10mm; 4X

Outer Cladding: Sapphire, 8.4mm x 16.4mm

End faces: precision polished flat and parallel
(length can be reduced)

Sides: Fine ground

Quantity 1

COATING AR/AR on 12.7mm dia x 1mm thick disk
that is optically contactable onto end faces

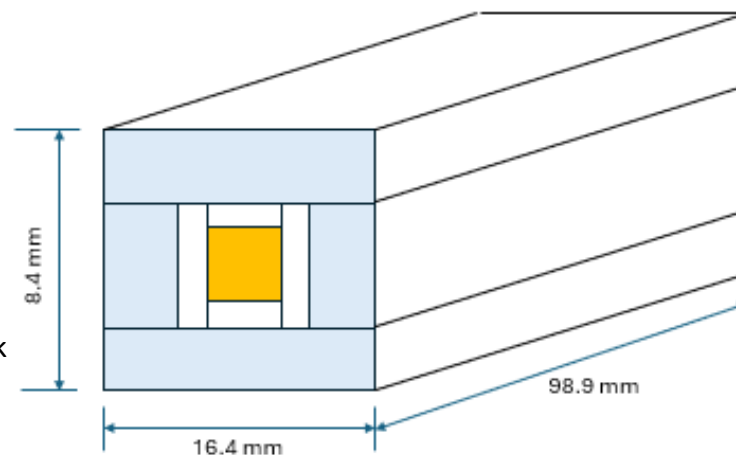
**PART #050196** 4% Tm:YAG Double-Clad Waveguide | 10.7mm x 13.1mm x 133mm L

Core: 4% Tm:YAG, 0.041mm x 0.035mm

Inner Cladding: Undoped YAG, 0.13mm; 4X

Outer Cladding: Sapphire, 13.11mm x 10.66mm

End faces: precision polished flat and parallel
(length can be reduced)

Sides: Fine ground

Quantity 1

COATING None

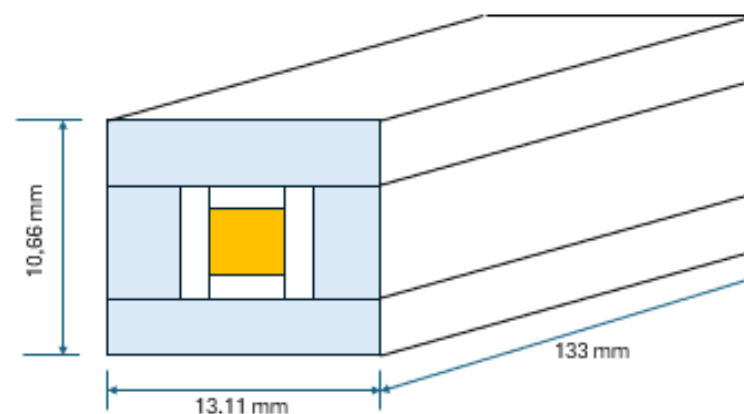

PART #050197 4% Tm:YAG Double-Clad Waveguide | 10.7mm x 12.1mm x 132mm L

Core: 4% Tm:YAG, 0.040mm x 0.038mm

Inner Cladding: Undoped YAG, 0.122mm x 0.140mm

Outer Cladding: Sapphire, 12.1mm x 16.7mm

End faces: precision polished flat and parallel
(length can be reduced)

Sides: Fine ground

Quantity 1

COATING None

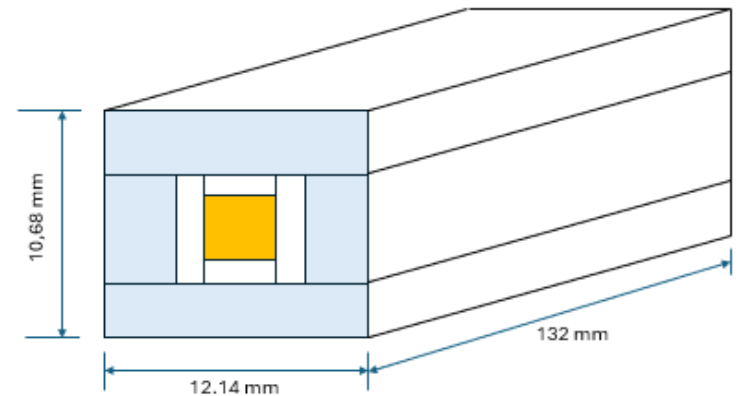
**PART #050198** 4% Tm:YAG Double-Clad Waveguide | 10.3mm x 13.7mm x 120mm L

Core: 4% Tm:YAG, 0.040mm x 0.035mm

Inner Cladding: Undoped YAG, 0.100mm x 0.157mm

Outer Cladding: Sapphire, 13.7mm x 10.3mm

End faces: precision polished flat and parallel
(length can be reduced)

Sides: Fine ground

Quantity 1

COATING None

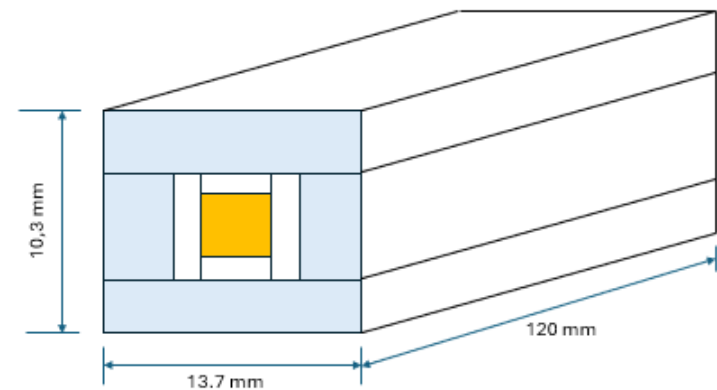

PART #050199 4% Tm:YAG Double-Clad Waveguide | 8.6mm x 14.3mm x 132mm L

Core: 4% Tm:YAG, 0.038mm x 0.039mm
Inner Cladding: Undoped YAG, 0.140mm x 0.160mm
Outer Cladding: Sapphire, 14.25mm x 8.64mm
End faces: precision polished flat and parallel
(length can be reduced)
Sides: Fine ground
Quantity 1

COATING None

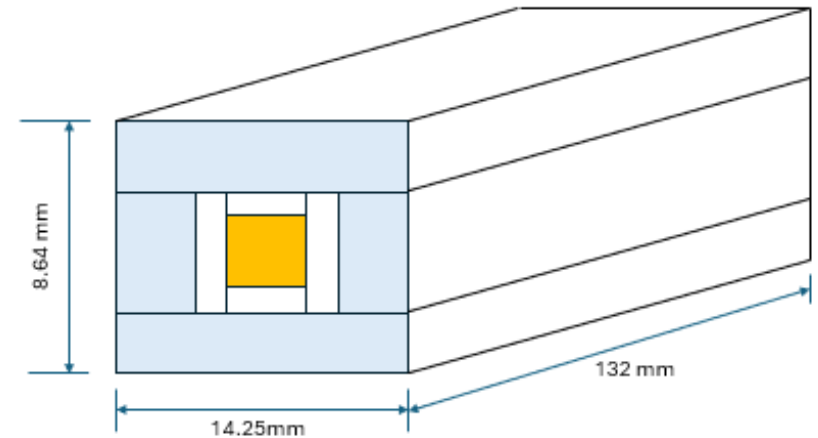
**PART #050204** 1% Yb:YAG/YAG/Single Crystal Spinel Waveguide | 5.5mm x 6.8mm x 79.8mm L

Core: 1% Yb:YAG, 0.027mm x 0.06mm
Inner Cladding: Undoped YAG, 0.032mm x 0.036mm
End faces: precision polished flat and parallel
(length can be reduced)
Sides: Fine ground
Quantity 1

COATING None

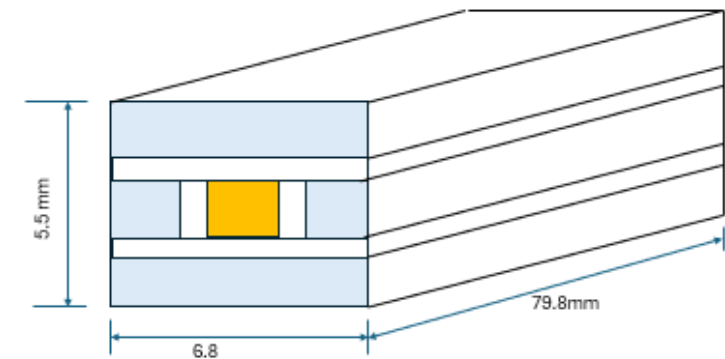

PART #050205 1% Yb:YAG Planar Waveguide Single Layer on C-Plane Sapphire | 9.41mm x 10mm x 210mm L

Dopant: 1% Yb:YAG

Core Thickness: 0.126mm, ready to bond cladding side 2

Cladding: Sapphire, 9.29mm th

End faces: Unfinished, please specify

Sides: Unfinished, please specify

Quantity 1

COATING None

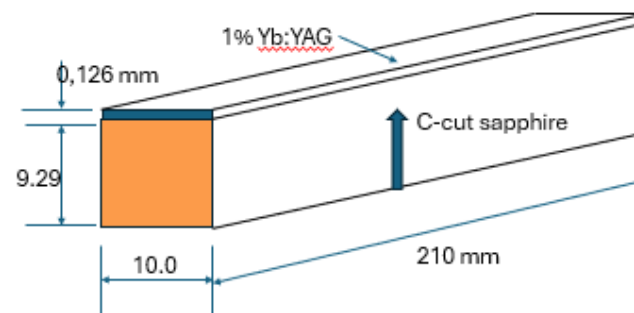

PART #050206 2.5% Ceramic Yb:YAG/YAG/Single Crystal Spinel Waveguide | 8.4mm x 16.4mm x 76mm L

Core: 2.5% Ceramic Yb:YAG, 0.04mm x 0.04mm

Inner Cladding: Undoped YAG, 0.10mm x 0.10mm

Outer Cladding: Spinel, 13.7mm x 10.3mm

End faces: precision polished flat and parallel
(length can be reduced)

Sides: Fine ground

Quantity 1

COATING None

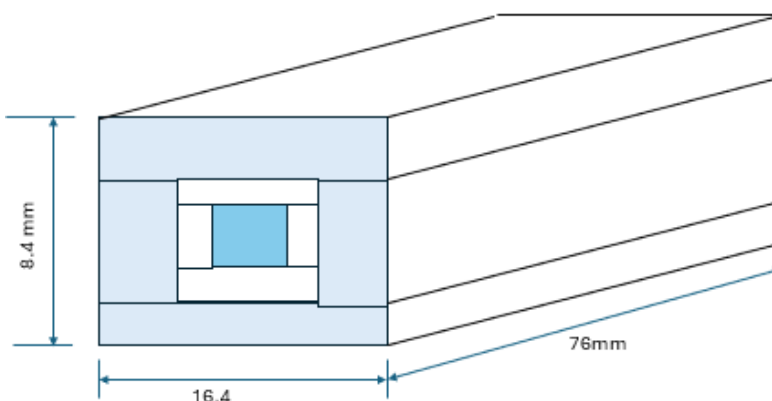

PART #050207 2.5% Ceramic Yb:YAG Double-Clad Waveguide | 7.6mm x 17.8mm x 145mm L

Core: 2.5% Ceramic Yb:YAG, 0.039mm x 0.043mm
Inner Cladding: Undoped YAG, 0.14mm x 0.195mm
Outer Cladding: Sapphire, 17.8mm x 7.6mm
End faces: precision polished flat and parallel
(length can be reduced)
Sides: Fine ground
Quantity 1

COATING None

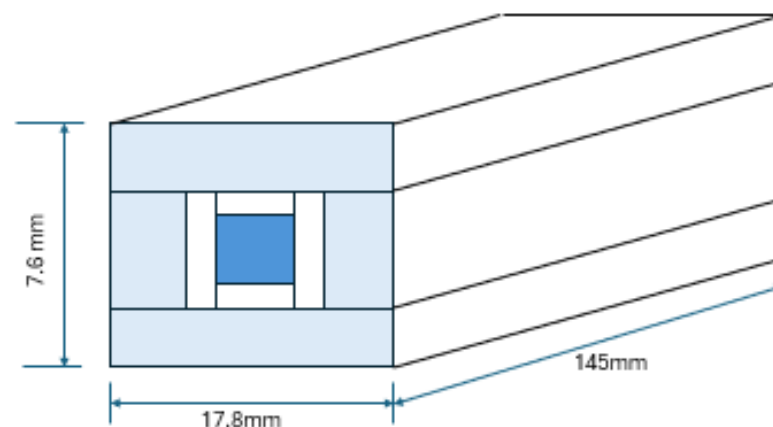
**PART #050208** 2.5% Ceramic Yb:YAG Double-Clad Waveguide | 7.5mm x 17.6mm x 178mm L

Core: 2.5% Ceramic Yb:YAG, 0.039mm x 0.036mm
Inner Cladding: Undoped YAG, 0.14mm x 0.14mm
Outer Cladding: Sapphire, 17.6mm x 7.5mm
End faces: precision polished flat and parallel
(length can be reduced)
Sides: Fine ground
Quantity 1

COATING None

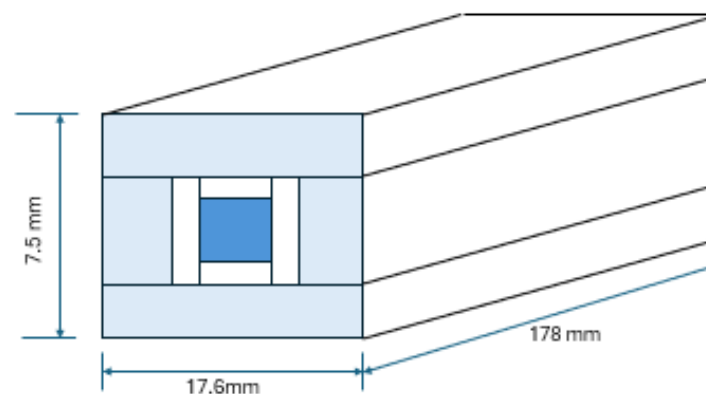

PART #050209 1% Nd:YAG / 1% Er:YAG / Sapphire Double-Clad Waveguide | 8.36mm x 15.9mm x 18.7mm L

Core: 1% Nd:YAG, 0.063mm x 0.063mm
Inner Cladding: 1% Er:YAG, ~0.2mm x 0.2mm
Outer Cladding: Sapphire, 15.9mm x 8.36mm
End faces: precision polished flat and parallel (length can be reduced)
Sides: Fine ground
Quantity 1

COATING None

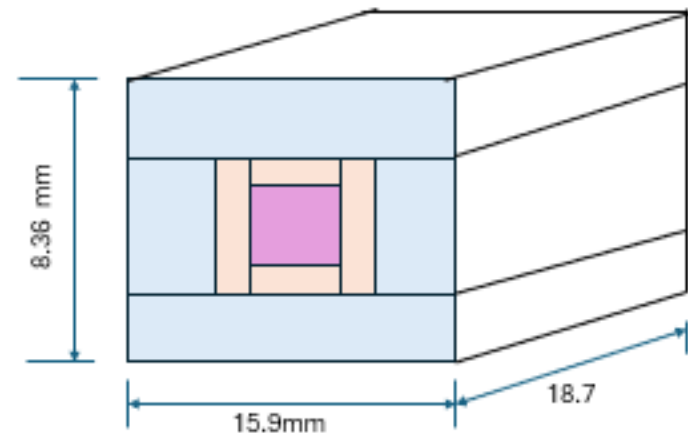

PART #050210 1% Nd:YAG / 1% Er:YAG / Sapphire Double-Clad Waveguide | 8.36mm x 13.37mm x 18.7mm L

Core: 1% Nd:YAG, 0.063mm x 0.074mm
Inner Cladding: 1% Er:YAG, ~0.12mm x 0.14mm
Outer Cladding: Sapphire, 8.36mm x 13.37mm
End faces: precision polished flat and parallel (length can be reduced)
Sides: Fine ground
Quantity 1

COATING None

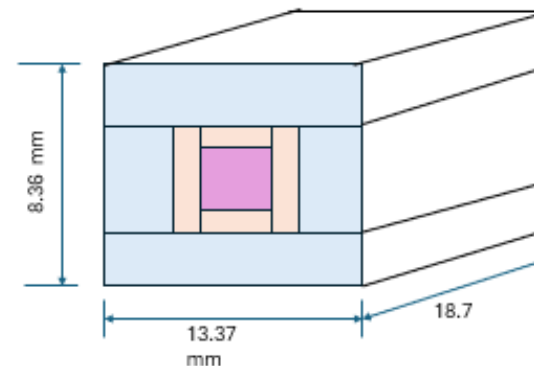

THIS PAGE INTENTIONALLY LEFT BLANK