

Healow App

Download App

Enter Practice Code
ICGACD

Login Using Patient Portal
Username and Password

Already have the Healow App?
Click the I am a first time user
with this device link.

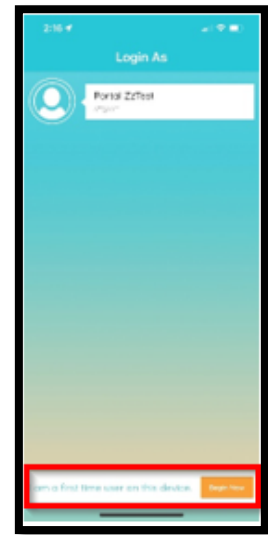
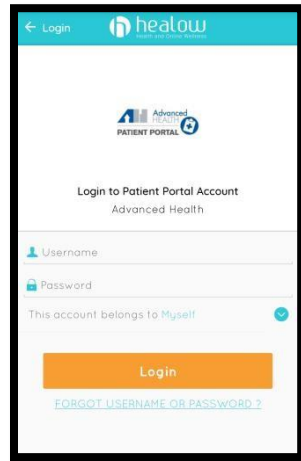

Click Get Started to
add a new practice.

Enter Name and DOB.
Click Continue.

Click Yes, I have Practice
Code.

Enter Practice Code **ICGACD**.
Click Next.

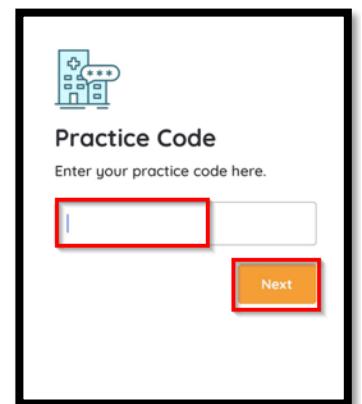
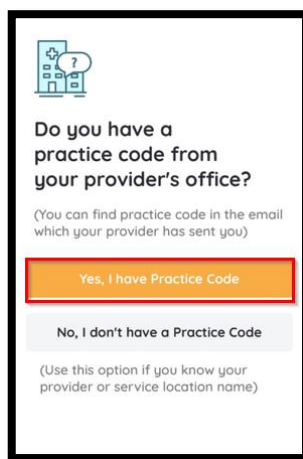
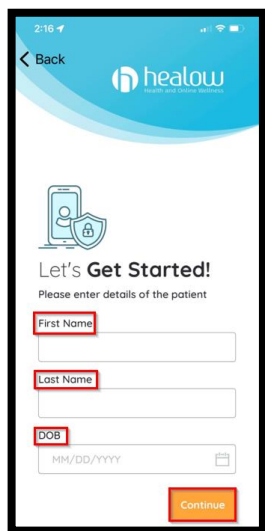

Healow App

Verify your Practice.

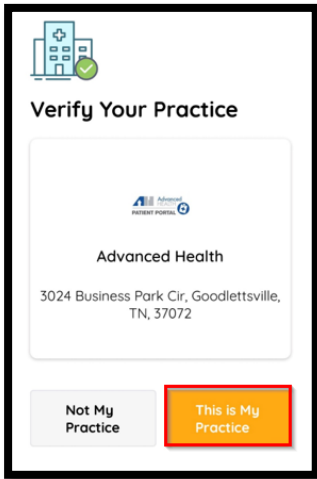

Retrieve Verification Code or Use Patient Portal login.

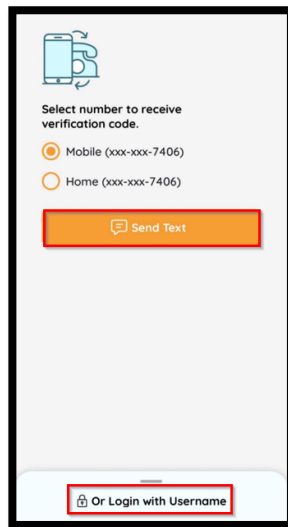

Enter Verification Code.

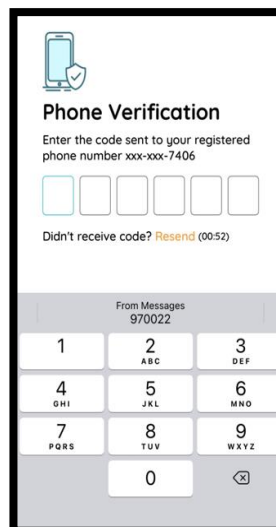

Review Terms of Use Agreement.

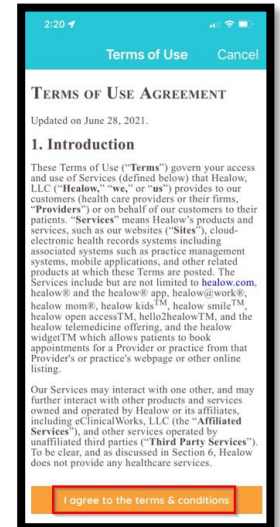

Create PIN

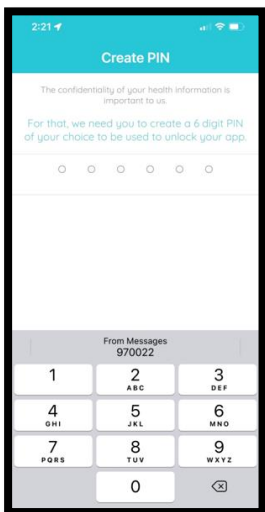

Complete Enrollment

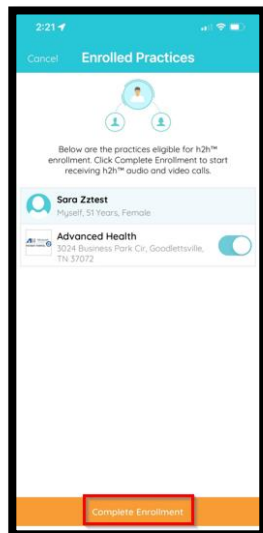

My Records
Select Correct Practice.

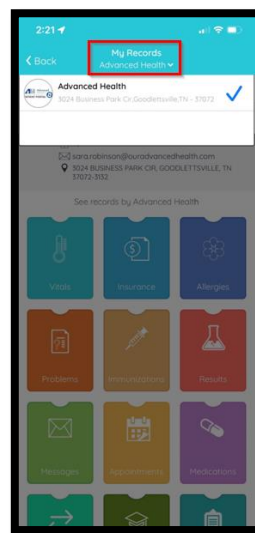

Compose Message
Select Correct Facility
and Provider.

