

Mars 2.0

The Mars 2.0 lounge sofa is the ideal product for collaborative spaces, informal meetings or elegant waiting areas. Optional privacy panels provide visual and acoustic insulation. The system has a wide variety of configuration options that will create high performance attractive spaces.

INFINITE POSSIBILITIES



ERGONOMIC
EXECUTIVE
CONFERENCE ROOM
MULTI-PURPOSE
LOUNGE AND ✓
WAITING ROOM
INTENSIVE USE
BARIATRIC



Mars 2.0

TECHNICAL SPECIFICATIONS

- Infinite configuration possibilities with :
 - 4 single seat models including one with backrest
 - 3 table models
- Frames made of Baltic birch plywood with clear varnish or seat matching upholstered edge
- Seats, backrest and modular armrest made of plywood upholstered with high resilience polyurethane foam
- Modular back and lateral panels made of plywood upholstered with polyurethane foam
- Steel modular legs equipped with adjustable nylon glides and available in many finishes
- Tops made of particle board or plywood (5/8") with choice of high pressure laminate finishes
- Optional connectivity module with power and USB outlets

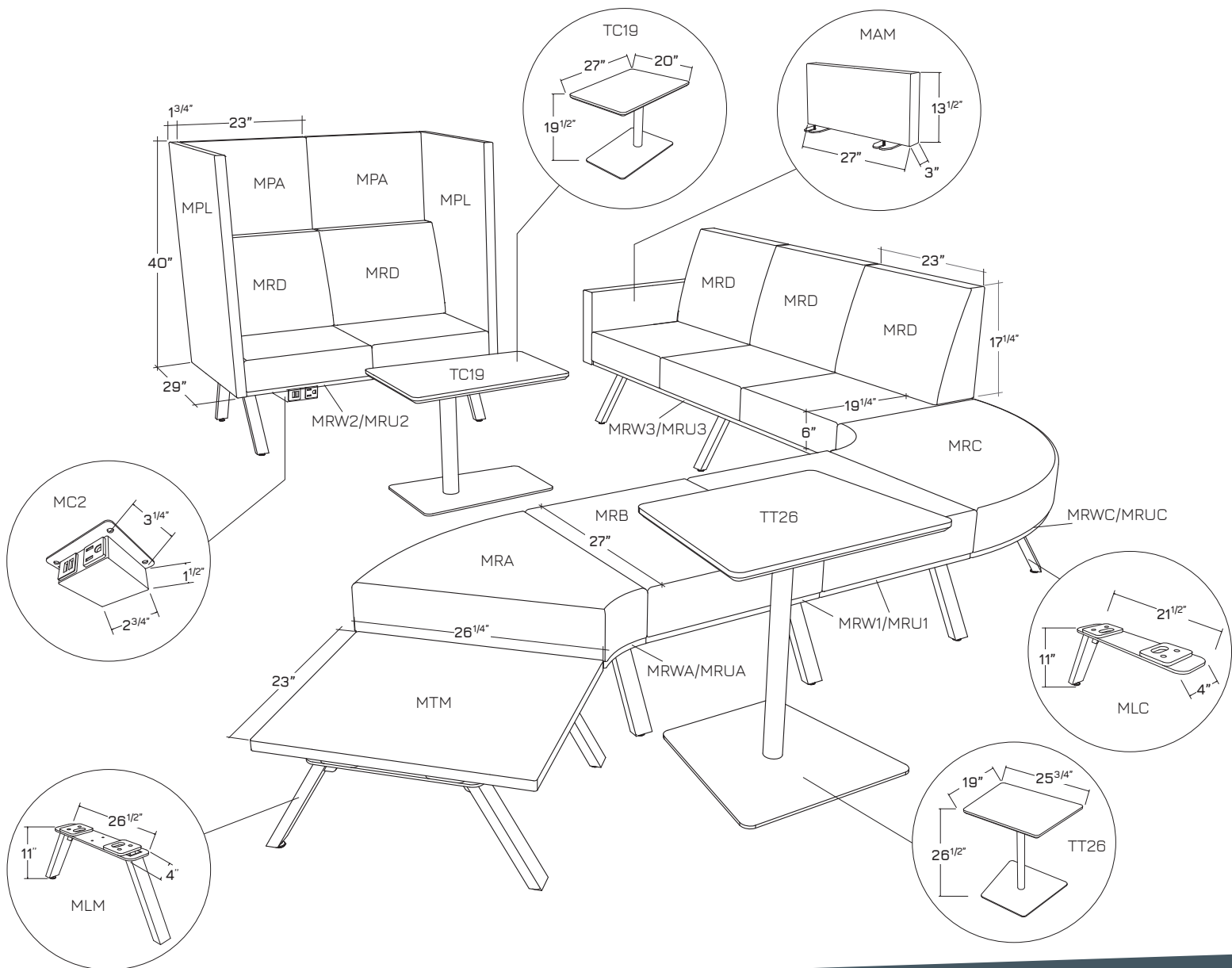
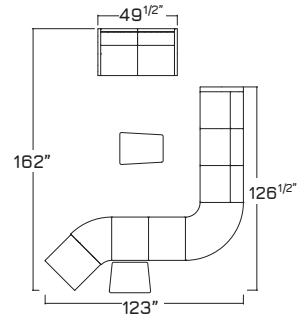

3450, 1re Rue
St-Hubert (Québec) J3Y 8Y5 Canada
T 450.926.1004 / 800.663.6794
F 450.926.0013

adi-artdesign.com

ADI
ART DESIGN INTERNATIONAL